

For Residential and Commercial Applications

Job Name		Engineer / Architect	
Job Location		Wholesaler	
Submittal Date		Contractor	

R1901/ R3901/ R3903 Multi-Turn Dual Outlet Stop – Sweat Inlet

Use: For use in potable water distribution systems. Not intended for recirculating water systems that produce continuous use temperatures above 115° F. For those applications, use our KT™ series ball stops

Design Features:

- **Machined, one-piece brass body** provides strength, durability, and long-lasting performance
- **Knurled oval handle** provides a secure grip and smooth on/off operation
- **Easy-to-remove handle** with screw attachment protects accidental stop operation during rough-ins
-  **No Lead**

Operating Specifications:

Temperature: 40° - 140° F

Pressure: 125 PSI maximum

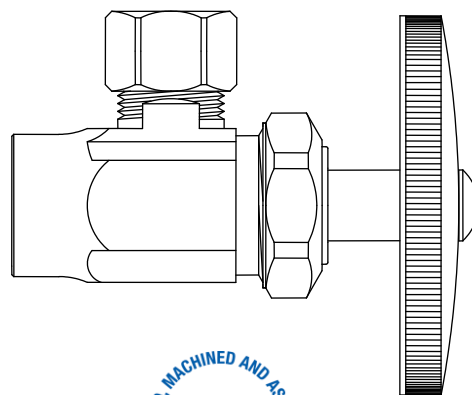

STOP MATERIAL SPECIFICATIONS

Body	Brass or brass, chrome plated
Stem	Brass or brass, chrome plated
Bib & Packing Washers	Rubber
Packing Nut	Brass or brass, chrome plated
Handle	Zinc, die cast or zinc, die cast plated
Handle Screw	Steel, zinc plated
Compression Sleeve	Brass
Compression Nut	Brass or brass, chrome plated

Part Listing:

- | | |
|--------------------------------------|---|
| <input type="checkbox"/> R1901LRX C1 | 1/2" nom sweat x 3/8" OD compression x 3/8" OD compression, chrome plated, window tray |
| <input type="checkbox"/> R1901LRX R1 | 1/2" nom sweat x 3/8" OD compression x 3/8" OD compression, rough brass, window tray |
| <input type="checkbox"/> R3901LX C1 | 1/2" nom sweat x 1/2" OD compression (left side) x 3/8" OD compression, chrome plated, window tray |
| <input type="checkbox"/> R3901RX C1 | 1/2" nom sweat x 1/2" OD compression (right side) x 3/8" OD compression, chrome plated, window tray |
| <input type="checkbox"/> R3901RX R1 | 1/2" nom sweat x 1/2" OD compression (right side) x 3/8" OD compression, rough brass, window tray |
| <input type="checkbox"/> R3903LR R1 | 1/2" nom sweat x 1/2" OD compression x 1/2" OD compression, rough brass, window tray |

This specification and all information contained herein is the confidential and exclusive property of BrassCraft Manufacturing, and shall not be disclosed to others without the written consent of BrassCraft Mfg. This specification must be returned to BrassCraft Mfg. if requested.

BrassCraft®

R1901 / R3901/ R3903 Multi-Turn Dual Outlet Stop – Sweat Inlet

Right Side Outlets

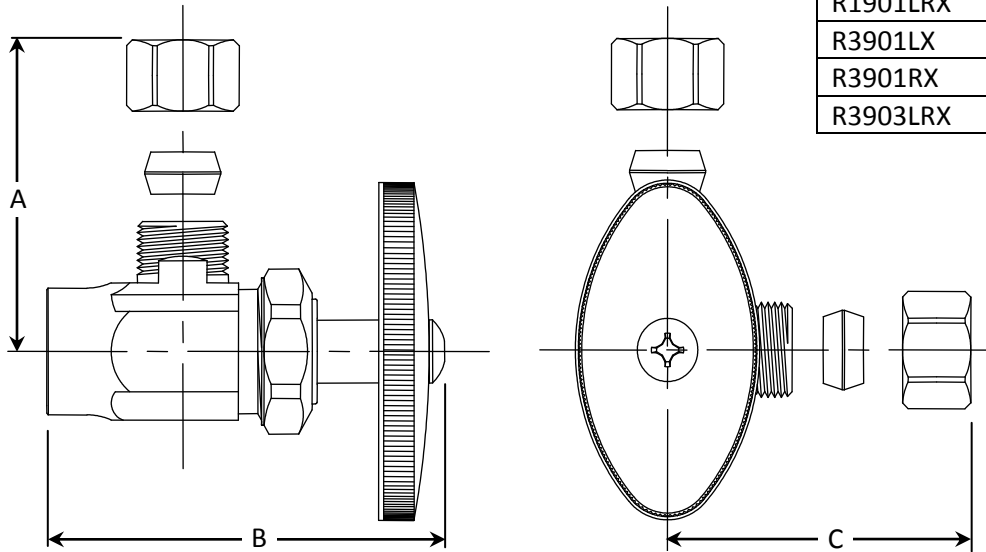

PART DIMENSIONS (Inches)			
Model	DIM. A	DIM. B	DIM. C
R1901LRX	1.06	2.46	1.06
R3901LX	1.06	2.46	1.15
R3901RX	1.06	2.46	1.15
R3903LRX	1.15	2.46	1.15

Left Side Outlets

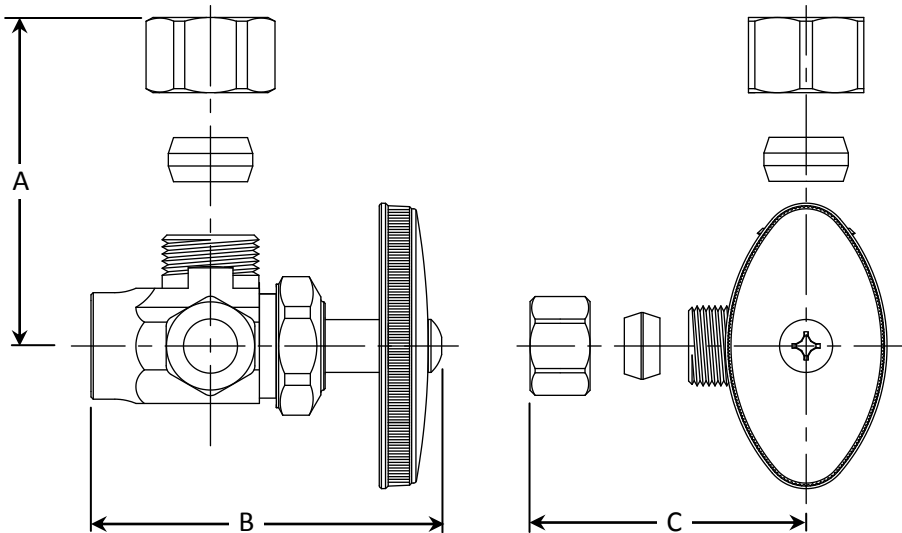

Listings & Certifications:

- IAPMO listed to ASME A112.18.1 / CSA B125.1 (File # 0645)
- CSA listed to ASME A112.18.1 / CSA B125.1 (File # 204593)
- No-Lead product CSA listed to Low-Lead Content Certification Program – Plumbing Products Class 6853-01



This specification and all information contained herein is the confidential and exclusive property of BrassCraft Manufacturing, and shall not be disclosed to others without the written consent of BrassCraft Mfg. This specification must be returned to BrassCraft Mfg. if requested.

400.79 R1901/R3901/R3903 Multi-Turn Dual Outlet Stop - Sweat Inlet REV 09/14

BrassCraft

© 2014 BrassCraft Mfg.