

# DWV SOLUTIONS

Continued

## G-O-N®

Code	G-O-N kit	Qty.
82700	2 in.	1
82703	3 in.	1
82706	4 in.	1
82708	6 in.	1
82710	8 in.	1
82713	10 in.	1
82715	12 in.	1

Code	Dura G-O-N kit	Qty.
82763	3 in.	1
82764	4 in.	1
82766	6 in.	1

Code	Bird Screen*	Qty.
82720	2 in.	1
82723	3 in.	1
82725	4 in.	1
82727	6 in.	1
82730	8 in.	1
82733	10 in.	1
82735	12 in.	1

\*Fits both G-O-N and Dura G-O-N

**WARNING:** This product can expose you to chemicals including Lead, which is known to the State of California to cause cancer, birth defects or other reproductive harm. For more information, go to [www.P65Warnings.ca.gov](http://www.P65Warnings.ca.gov).

### SPECIFICATIONS

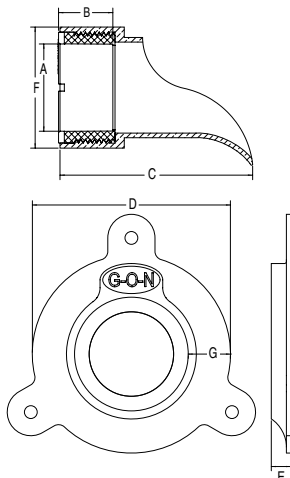

G-O-N	Approx. weight in lbs.	A Inside diameter	B Hub depth	C Nozzle depth	D Escutcheon width	E Escutcheon depth	F Overall dimension	G Escutcheon width
2"	3	2.39"	1.5"	5.25"	5.75"	.50"	3.25"	1.25"
3"	5	3.52"	1.5"	5.37"	7.00"	.57"	4.50"	1.25"
4"	7	4.52"	1.5"	5.37"	8.00"	.57"	5.50"	1.25"
6"	10	6.65"	1.5"	5.62"	10.25"	.57"	7.50"	1.25"
8"	13	8.65"	1.5"	5.62"	12.37"	.57"	10.00"	1.25"
10"	21	10.78"	2.5"	6.50"	14.50"	.57"	12.00"	1.25"
12"	26	12.78"	2.5"	7.50"	16.50"	.50"	14.00"	1.25"

### Glue-on nozzle installs directly onto PVC drain pipe

**APPLICATION** • G-O-N provides easier installation of downspout nozzle • PVC insert allows quick gluing.  
• Eliminates the need for coordinating additional site work with masonry or stucco crews.



Caulk wall opening.



Anchor escutcheon.



Measure/cut pipe.



Solvent weld nozzle onto pipe and into escutcheon. *Dura G-O-N requires the mounting notch in the escutcheon and the nozzle be aligned for proper contact.*