

BRISTOL

PTF Series



FEATURES & OPTIONS

Door Preparation

Cross Bore: 2-1/8", Edge: 1"

Latch Backset

Exterior: Adjustable deadlatch standard
Interior: Adjustable plainlatch standard
(other options available)

Faceplate

1" x 2-1/4" round corner standard
(other options available)

Bolt

1/2" throw

Door Thickness

Fit 1-3/8" to 1-3/4" standard

Cylinder

5-pin KW keyway solid brass cylinder standard

Strike Plate

2-1/4" x 1-3/4" round corner full lip standard
(other options available)

Handing

Non-Handed

Material

Zinc die-cast lever

ANSI/BHMA

A 156.2 Grade 3

FINISHES

(other finishes available upon request with lead-time)

- ☐ **US12P – 716 – Dark Bronze**
- ☐ **US15 – 619 – Satin Nickel**
- ☐ **US15A – 620 – Antique Nickel**

WARRANTY

- ☐ **25-year mechanical warranty**
- ☐ **Five years finish warranty**

FUNCTIONS

Entry – F109 (PTF00)

Both levers locked or unlocked by key outside or turn-piece inside.

Passage – F75 (PTF30)

Both levers always free.

Privacy – F76 (PTF10)

Both levers locked or unlocked by turn-piece inside. Outside lever unlocked by coin or screwdriver.

Half Dummy (PTF40)

For doors where only pull is required.

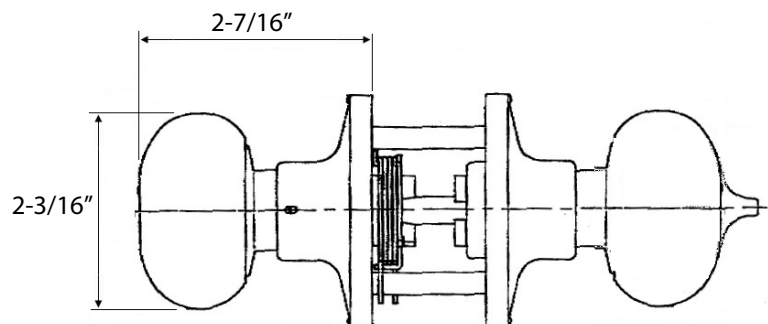

** Entry Function Knobset **