

JOB:
REPRESENTATIVE:

 UNIT TAG:
 ENGINEER:
 CONTRACTOR:

 ORDER NUMBER:
 SUBMITTED BY:
 APPROVED BY:

 DATE:
 DATE:
 DATE:

Check-Trol™

Isolation Flow Control Flange

DESCRIPTION

The Check-Trol flange is a combination of isolation valve, flow control valve, and companion flange for circulators. The ball valve allows the circulator to be removed from the system without draining the system. The internal spring check prevents gravity circulation. Free floating companion flange makes pump installation a snap.

The Check-Trol flange is packaged with an isolation flange of the same size to create a pair. Capscrews and nuts are included.

CONSTRUCTION

Valve Body: Lead-Free† Brass

Flange: Chrome Plated Steel

Ball: Chrome Plated Lead-Free† Brass

Packing: PTFE

Seat Ring: PTFE

Stem: Lead-Free† Brass

Spring Check: Nitrile, Acetal, Stainless Steel

MAXIMUM WORKING PRESSURE

150 psig (10 bar)

TEMPERATURE RANGE

200°F (93°C)

†CSA certified to NSF/ANSI 372 that product contains less than 0.25% lead content by weight on wetted surface.

SCHEDULE

Part No.	Size Inches	Model	Use With Following B&G Circulators	Tagging	Quantity
101231LF	3/4" NPT x Flange	CTF-3/4	NRF/NBF/SSF, Series PL-30, PL-36, PL-55, Series 100, PR, LR, ecocirc 20-18 and ecocirc+ 20-18		
101232LF	1" NPT x Flange	CTF-1			
101233LF	1-1/4" NPT x Flange	CTF-1-1/4			
101245LF	1-1/2" NPT x Flange	CTF-1-1/2			
101236LF	3/4" SWT x Flange	CTFS-3/4	NRF/NBF/SSF, Series PL-30, PL-36, PL-55, Series 100, PR, LR, ecocirc 20-18 and ecocirc+ 20-18		
101237LF	1" SWT x Flange	CTFS-1			
101238LF	1-1/4" SWT x Flange	CTFS-1-1/4			
101247LF	1-1/2" SWT x Flange	CTFS-1-1/2			

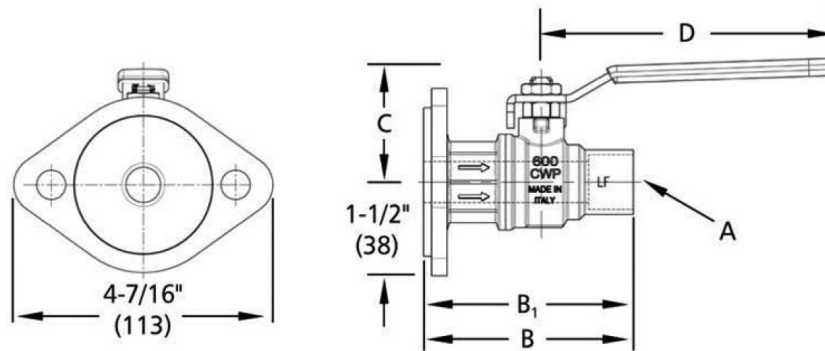

NOTE: THIS IS THE DEFAULT MODEL IF NO ADDITIONAL PT PORTS OR BYPASS IS REQUIRED.

Part No.	Dimensions-Inches (mm)					Approx. Shpg. Wt. Lbs (Kg)
	A	B	B1**	C	D	
101231LF	3/4" NPT	3-7/64" (79.0)	2-27/64" (61.5)	2" (50.5)	4-23/32" (120.0)	3.4 (1.5)
101232LF	1" NPT	3-15/16" (100.0)	2-57/64" (73.3)	2-5/32" (54.7)	4-23/32" (120.0)	4.4 (2.0)
101233LF	1-1/4" NPT	4-25/32" (121.4)	3-19/64" (84.0)	3" (75.9)	6-7/32" (158.0)	6.3 (2.8)
101245LF	1-1/2" NPT	4-27/32" (122.9)	3-23/64" (85.5)	3" (75.9)	6-7/32" (158.0)	6.6 (3.0)
101236LF	3/4" SWT	3-21/64" (84.5)	2-41/64" (67.0)	2" (50.5)	4-23/32" (120.0)	3.4 (1.5)
101237LF	1" SWT	4-1/64" (102.0)	3.000" (75.3)	2-5/32" (54.7)	4-23/32" (120.0)	4.2 (1.9)
101238LF	1-1/4" SWT	4-55/64" (123.4)	3-25/64" (86.0)	3" (75.9)	6-7/32" (158.0)	5.9 (2.7)
101247LF	1-1/2" SWT	5-1/64" (127.4)	3-35/64" (90.0)	3" (75.9)	6-7/32" (158.0)	6.5 (3.0)

Dimensions and weights are approximate and subject to change. Contact factory for certified dimensions. Check-Trol Flange is sold with an Isolation Flange as a pair.

** Dimension B is for the Check-Trol only. Dimension B1 is for the Isolation Flange only. Dimensions A, C, and D apply to both Check-Trol and Isolation Flange.

The part numbers and shipping weights are for one Check-Trol Flanges and one Isolation flange, capscrews and nuts.

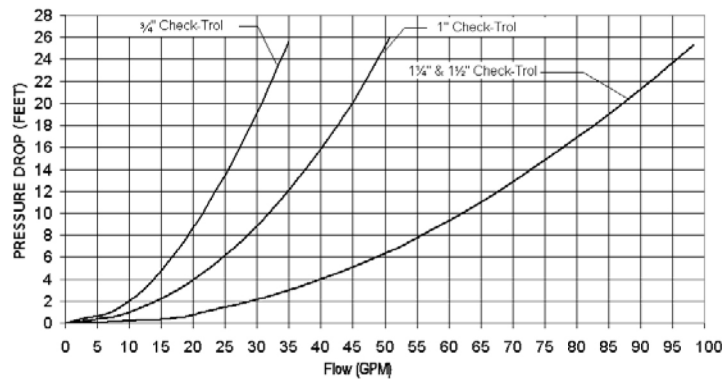

TYPICAL SPECIFICATIONS

Furnish and install on plans _____ inches NPT/Sweat x Flange Check-Trol Flange on the pump discharge. The Check-Trol Flange will prevent gravity circulation and flow in the wrong direction. When closed, it will provide positive shut-off. The mating flange shall be free floating allowing it to rotate eliminating the need to align the bolt holes of the flanges when installing to the piping system. The Check-Trol Flange shall be constructed with a brass body, chrome plated brass ball, chrome plated steel flange and handle, and PTFE packing and seat ring and a non-ferrous check. The Check-Trol Flange shall be manufactured by Xylem – Bell & Gossett or equal.



Xylem Inc.
8200 N. Austin Avenue
Morton Grove, IL 60053
Tel: (847) 966-3700 Fax: (847) 965-8379
www.xylem.com/bellgossett

Xylem and Bell & Gossett are registered trademarks of Xylem Inc. or one of its subsidiaries. All other trademarks or registered trademarks are property of their respective owners.
© 2023 Xylem Inc. A-129F March 2023