

Add-A-Line™

Full-Slip Valve Tee

ALL-BRASS DESIGN
NEW
ICE MAKER KIT

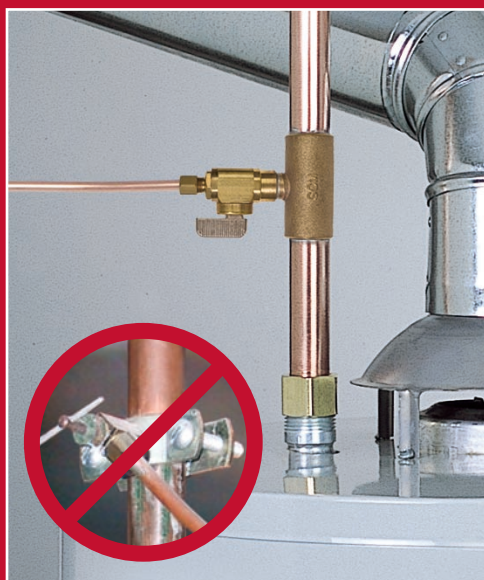

QUALITY

- Brass ball valve replaces cheap saddle valves that leak and clog

SIMPLE

- Easily add humidifiers, dishwashers, ice makers, or any new water line

EASY

- Reduce the amount of time that the water lines need to be shut off to the rest of the house



Supply • Drainage • Support • Testing • Specialties • Tools • Access

**Sioux
Chief** 
MANUFACTURING SINCE 1957

Compression Trunks

1/4" O.D. Compression Ball Valve



601-20CV

5/8" O.D. full-slip
compression trunk



601-30CV

7/8" O.D. full-slip
compression trunk

3/8" O.D. Compression Ball Valve



601-21CV

5/8" O.D. full-slip
compression trunk



601-31CV

7/8" O.D. full-slip
compression trunk

1/2" Female Sweat/MIP Ball Valve



601-22CVM

5/8" O.D. full-slip
compression trunk



601-32CVM

7/8" O.D. full-slip
compression trunk

1/2" PEX Barb Ball Valve



601-22CVX

5/8" O.D. full-slip
compression trunk



601-32CVX

7/8" O.D. full-slip
compression trunk

Compression Installation

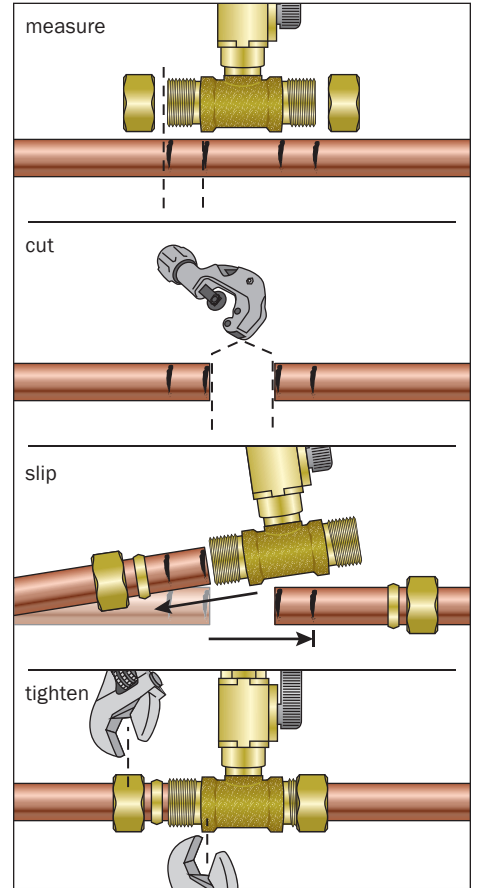

Compression trunks are perfect for adding lines near HVAC or plastic drainage pipe that might get damaged by a soldering torch.



Our PEX barb ball valve model is perfect for adding a bathroom, laundry sink, bar sink or replacing a damaged sillcock.

Female Sweat Trunks

Sweat Installation

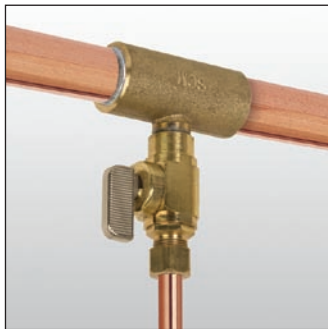
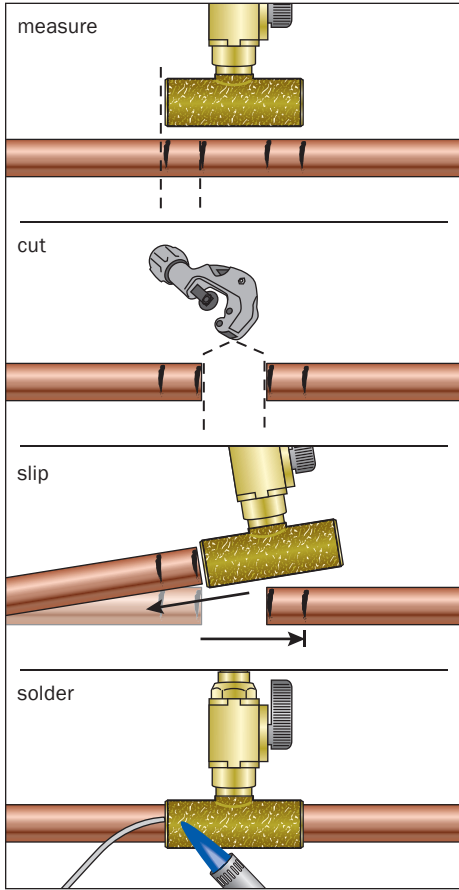

Our 3/8" O.D. compression ball valve model is perfect for adding a dishwasher.

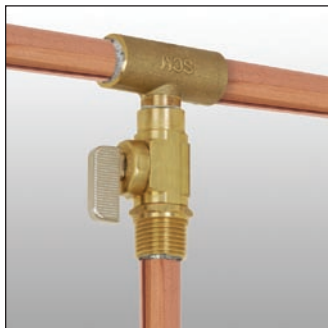

Use either the 1/2" MIP threads or the 1/2" Female sweat connection on our Female sweat/MIP ball valve model.

1/4" O.D. Compression Ball Valve



601-20V
1/2" female sweat full-slip trunk



601-30V
3/4" female sweat full-slip trunk

3/8" O.D. Compression Ball Valve



601-21V
1/2" female sweat full-slip trunk



601-31V
3/4" female sweat full-slip trunk

1/2" Female Sweat/MIP Ball Valve



601-22VM
1/2" female sweat full-slip trunk



601-32VM
3/4" female sweat full-slip trunk

1/2" PEX Barb Ball Valve



601-22VX
1/2" female sweat full-slip trunk



601-32VX
3/4" female sweat full-slip trunk

Female Sweat Tees

1/2" Male Sweat Branch



601-22

1/2" female sweat
full-slip trunk



601-32

3/4" female sweat
full-slip trunk



Full-slip sweat tees are a great way to add new water lines off existing branches. Perfect for adding new fixtures.

Clamshells



Item No.	Description (Trunk x Tee)	Min. Qty	Case Qty
COMPRESSION TRUNK			
601-20CV	5/8" O.D. compression x 1/4" O.D. compression, clamshell	6	6
601-30CV	7/8" O.D. compression x 1/4" O.D. compression, clamshell	6	6
601-21CV	5/8" O.D. compression x 3/8" O.D. compression, clamshell	6	6
601-31CV	7/8" O.D. compression x 3/8" O.D. compression, clamshell	6	6
601-22CVM	5/8" O.D. compression x 1/2" female sweat/MIP thread, clamshell	6	6
601-32CVM	7/8" O.D. compression x 1/2" female sweat/MIP thread, clamshell	6	6
601-22CVX	5/8" O.D. compression x 1/2" PEX barb, clamshell	6	6
601-32CVX	7/8" O.D. compression x 1/2" PEX barb, clamshell	6	6
SWEAT TRUNK			
601-20V	1/2" female sweat x 1/4" O.D. compression, clamshell	6	6
601-30V	3/4" female sweat x 1/4" O.D. compression, clamshell	6	6
601-21V	1/2" female sweat x 3/8" O.D. compression, clamshell	6	6
601-31V	3/4" female sweat x 3/8" O.D. compression, clamshell	6	6
601-22VM	1/2" female sweat x 1/2" female sweat/MIP thread, clamshell	6	6
601-32VM	3/4" female sweat x 1/2" female sweat/MIP thread, clamshell	6	6
601-22VX	1/2" female sweat x 1/2" PEX barb, clamshell	6	6
601-32VX	3/4" female sweat x 1/2" PEX barb, clamshell	6	6
601-22	1/2" female sweat x 1/2" male sweat	10	10
601-32	3/4" female sweat x 1/2" male sweat	10	10

NEW Ice Maker Kits

Item No.	Description (Trunk x Tee)	Min. Qty	Case Qty
601-20CVPK	5/8" O.D. compression x 1/4" O.D. compression, 25 ft of 1/4" O.D. plastic tube, clamshell	5	5
601-30CVPK	7/8" O.D. compression x 1/4" O.D. compression, 25 ft of 1/4" O.D. plastic tube, clamshell	5	5

Visit www.siouxchief.com/index for current pricing and our Product Index.

DISTRIBUTED BY

tel: 1-800-821-3944
 fax: 1-800-758-5950
www.siouxchief.com
 P.O. Box 397
 24110 South Peculiar Drive
 Peculiar, Missouri 64078 USA

