

Product

**CS-2 Condensate Safety Overflow Switch (Pipe Mounted)**

Plenum Rated

Purpose

DiversiTech Flood Prevention Switches are simple to install, easy to service, and extremely reliable. As water level in the auxiliary or main drainpipe rises due to a clogged air conditioning condensate drain, the switch shuts off the system, thus preventing water from over-flowing and causing damage to doors, walls, and ceilings.

Features

- Small size for serviceability
- Has a pull-to-test lever for verifying correct installation
- Constructed of materials that will not rust or stick
- Switch operates smoothly every time
- Integrated LED light indicator notifies homeowners and technicians activation has occurred
- Internal surge protector eliminating the risk of inadvertent shutdowns
- Comes with 6 feet of wire for easy installation
- Plenum rated

General Specifications

- Voltage: 24 volts
- Amperage: 1.5 amps
- Operates via a reed switch
- ETL Listed
- Conforms to UL 508 and UL 2043

General Characteristics

Part Number	Type	Switch Type	Order Multiple
CS-2	Tee	Magnetic Reed	10
CS-2-BULK50	Tee	Magnetic Reed	50

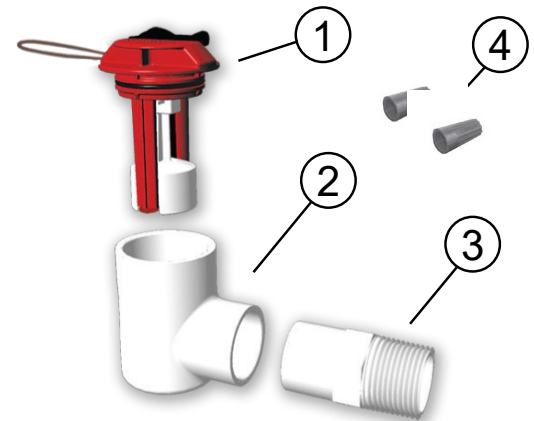

- ① Sensor Assembly
- ② Pipe Elbow
- ③ 3/4" Threaded Fitting
- ④ Wire Nuts

