

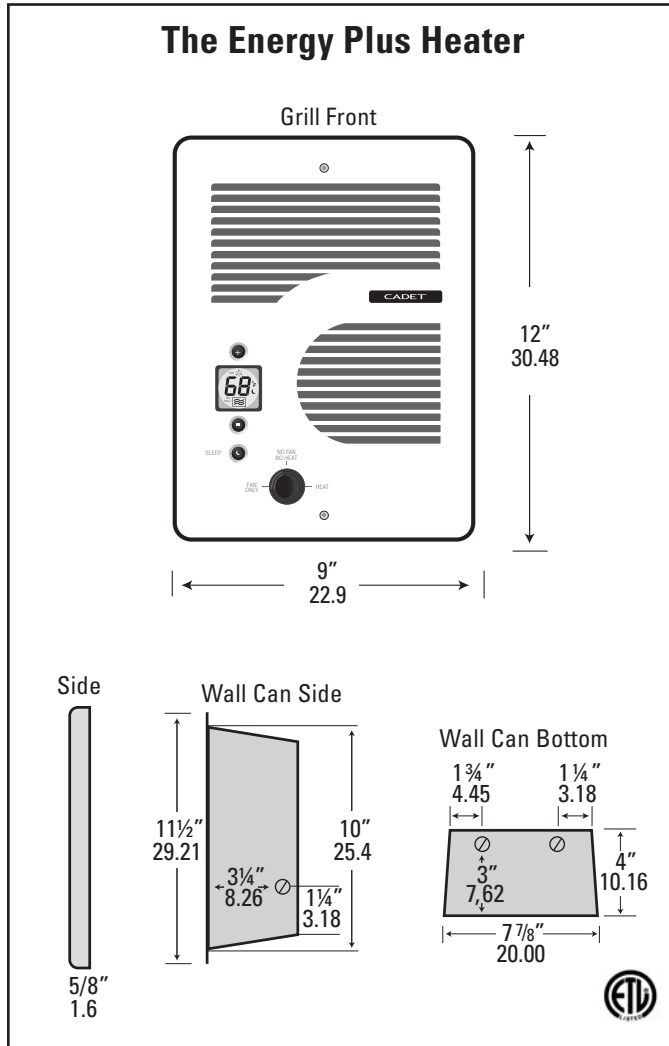

less energy  
**Energy Plus**  
more comfort

# The Energy Plus Heater

## OWNER'S GUIDE



**TOOLS REQUIRED:**

- Phillips Screwdriver
- Straight Screwdriver
- Wire Strippers
- Utility Knife
- (4) 1 1/2" Wood Screws
- (3) Insulated Wire Connectors
- (1) Strain Relief Connector

**Models: CE163T, CE083T**  
**PATENT PENDING**



### Features & Benefits

- **Unique proportional power output:** Delivers only the heat needed, for maximum efficiency and quiet performance
- **Auto adjusting fan speed:** Efficiently regulates heat output based on your desired room temperature
- **Built in controls help save energy and deliver precise, consistent temperature control**
  - Digital backlit display shows temperature, fan operation, and heating mode
  - Precise, digital push button thermostat
  - Night/Away one touch button for ease of use
  - Three modes: Heat/No Heat/Fan Only
  - Maximum and minimum temperature lock
- **Thermal Safeguard:** High temperature manual reset turns off heater if normal operating temperatures are exceeded
- **Fan only mode circulates air in off season:** 3 fan speeds for optimum comfort
- **120 or 240 Volt:** Factory set at 240 Volt, the sensor detects incoming power supply for easy installation. Simple "key" included to switch heater to 120 Volt if needed for your existing circuit.
- **Multi-Watt**

Model	at 240 Volts	at 208 Volts	at 120 Volts
CE163T	1600 watts	1500 watts	1000 watts
CE083T	800 watts	750 watts	500 watts
- **Small, space saving design** installs in 3 easy steps
- **Heavy duty sealed element**
- **Replacement:** Easily replace your Com-Pak Series heaters and enjoy greater energy savings and better comfort. Fits pre-existing vertically mounted wall cans for the following models: C, CB, CM, CS, FX, X. Pre-existing FW or RB wall cans must be replaced with new wall can (included).

## Less Energy, More Comfort!

### SAVE THESE INSTRUCTIONS

# IMPORTANT INSTRUCTIONS

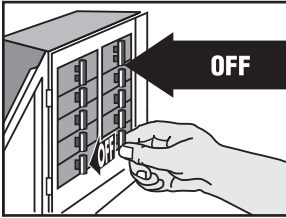

## **⚠ WARNING**

Turn the electrical power off at the electrical panel board (circuit breaker or fuse box) and lock or tag the panel board door to prevent someone from turning on power while you are working on the heater. Failure to do so could result in serious electrical shock, burns, or possible death.

1. Read all instructions before installing or using this heater.
2. Read all information labels. **Verify that the electrical supply wires are the same voltage as the heater.**
3. All electrical work and materials must comply with the National Electric Code (NEC), the Occupational Safety and Health Act (OSHA), and all state and local codes.
4. Connect the grounding screw provided in the wall can to the supply ground wire.
5. If you need to install a new circuit or need additional wiring information, consult a qualified electrician.
6. Protect electrical supply from kinks, sharp objects, oil, grease, hot surfaces or chemicals.
7. **⚠ WARNING**  
**Overheating or fire may occur. DO NOT** install the heater in a floor, in the ceiling, below a towel bar, behind a door, or anywhere the air discharge may be blocked in any manner.
8. **⚠ WARNING**  
**Fire or explosion may occur. DO NOT** install heater in any area where combustible vapors, gases, gasoline, liquids, or excessive lint or dust are present. A heater has hot and arcing or sparking parts inside.
9. **⚠ WARNING**  
**DO NOT** install where heater is likely to get wet. Do not use outdoors.
10. **⚠ WARNING**  
**Burn Hazard.** This heater is hot when in use. To avoid burns, do not let bare skin touch hot surfaces. Use extreme caution when any heater is used by or near children or invalids, and whenever the heater is left operating and unattended.
11. **⚠ WARNING**  
**Risk of Electrical Shock. DO NOT** install the heater directly above bathtub or sink. **DO NOT** install in shower stall area (Manufacturer recommends a minimum 2 foot clearance).
12. **⚠ WARNING**  
**Risk of Electrical Shock.** Connect grounding lead to grounding screw provided. Keep all foreign objects out of heater.
13. **⚠ WARNING**  
**Risk of Electrical Shock.** Never place a switch where it can be reached from the tub or shower enclosure.
14. **⚠ WARNING**  
**Risk of Fire. Do not block heater.** Heater must be kept clear of all obstructions: Keep combustible materials, such as furniture, pillows, bedding, papers, clothes, etc. and curtains at least 3 feet from the front of the heater and 6 inches above and on both sides.
15. **⚠ WARNING**  
**Risk of Electrical Shock.** Do not operate any heater after it malfunctions. Disconnect power at service panel and have heater inspected by a reputable electrician before reusing.
16. **⚠ WARNING**  
Use this heater only as described in this manual. Any other use not recommended by the manufacturer may cause fire, electric shock, or injury to persons.
17. **⚠ WARNING**  
**Risk of Fire.** This heater includes a visual alarm on the digital display to warn that parts of the heater are getting excessively hot. If code F7 appears on the display, immediately turn the heater off and inspect for any objects on or adjacent to the heater that may have blocked the airflow or otherwise caused high temperatures to have occurred. **DO NOT OPERATE THE HEATER WITH THE ALARM ACTIVATED.**

## SAVE THESE INSTRUCTIONS

# BEFORE YOU BEGIN, YOU SHOULD KNOW:

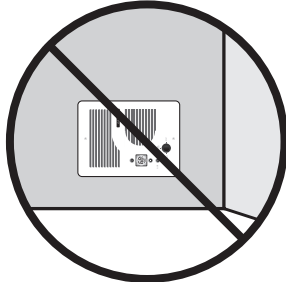
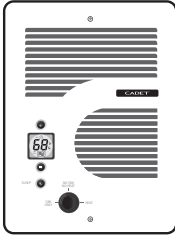

**DO NOT INSTALL THE HEATER HORIZONTALLY.**



**DO NOT INSTALL THE HEATER IN THE CEILING.**

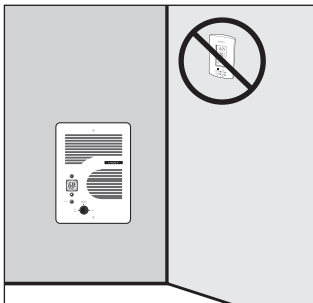

**DO NOT USE WITH A WALL THERMOSTAT**

## About The Cadet Energy Plus Heater

The Cadet Energy Plus Heater provides zonal heat to a room by using an efficient, variable speed fan to circulate the warm air, and an intelligent thermostat to deliver precise temperature control.

The Cadet Energy Plus heater is designed to **save energy and run at a low speed** and heat output once the desired room temperature is reached. This is normal operation for maintaining and regulating desired room temperature. This low speed fan movement also provides better air mixing within the room, and fewer on/off cycles.

Safety is Cadet's first priority. All CE-Series heaters feature an oversized high temperature limit switch that shuts the heater off when excessive operating temperatures are detected.

For effective and safe operation, and to prolong the life of the heater, read all instructions and safety information, and follow the maintenance instructions in this Owner's Guide.

## New Installation & Replacement Facts

- For new installation, you should be prepared to run wire or electrical conduit to your desired location for your heater.
- A qualified or dedicated circuit from circuit breaker panel is required.
- An in-wall electric fan heater is a permanent, safe, hard wired solution that requires a cut out in your wall to recess the heater, unless a Cadet surface mount adapter is used.
- The Cadet Energy Plus heater must only be installed vertically in a wall.
- The heater must not be installed in the floor or ceiling, even if you are replacing an existing heater that was installed in either of these locations.
- Installation on an inside wall is recommended.
- For better comfort, do not install where air is likely to continuously blow directly onto you or another person.
- The recommended height from the floor is 12 inches for easy access to the digital thermostat. It will function properly in lower positions, but must not be lower than 4½ inches above the floor.
- If you are replacing a heater, the Cadet Energy Plus heater must only be installed with a Com-Pak style wall can model FXC/XC/CC. Check the label in the existing wall can to make sure this is the type you are replacing.
- Be sure that your existing or new wall can is mounted flush with the outside of the sheetrock.

## General

- The heater has a **cool down feature** that will run the fan for up to 10 minutes after switching to NO HEAT mode or if set point is reached and mild outdoor temperatures create low demand. **This is normal.** The air being discharged may feel cool, but is actually room temperature residual heat moving into the room.
- Because the digital thermostat is onboard the Energy Plus Heater, it is very important to conduct proper maintenance (See Page 8) of the heater to maintain peak performance and safety.
- The Cadet Energy Plus heater's unique variable speed blower will auto adjust, based on the room requirements and heat output. **It may quietly deliver heat at a low speed, for optimum performance and energy savings once desired temperature setpoint is reached.**

## Wall Thermostat

- **A wall thermostat may not be used to control this heater.** The Energy Plus heater is equipped with a unique onboard thermostat that both regulates the heater output and provides precise temperature control. If replacing a heater controlled by an existing wall thermostat, remove wall thermostat from the heater circuit and cover hole with a faceplate.

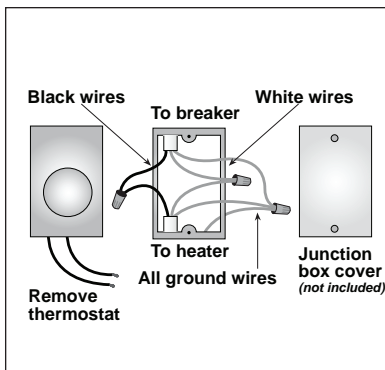

### TO REMOVE AN EXISTING WALL THERMOSTAT FROM HEATER CIRCUIT

1. Make sure power is off at the circuit breaker.
2. Remove wall thermostat mounting screws.
3. Pull the thermostat away from the wall and count the wires.
4. A. If you count 2 black supply wires and 2 white supply wires in the box, disconnect thermostat and connect the 2 black wires together with one connector. Connect the 2 white wires together with another connector. Connect all ground wires together.  
B. If you have 1 black supply wire and 1 white supply wire, disconnect thermostat and connect the black and white wires together with a connector. Connect all ground wires together.  
C. If you have more than 2 black or 2 white wires, please consult a qualified electrician.
5. If you have a metal junction box, it must be grounded. (Use a grounding screw or clip.)
6. Install a blank faceplate (not provided) over the exposed junction box.

**READ ALL INSTRUCTIONS AND SAFETY INFORMATION**

**CAUTION:** High temperature, risk of fire, keep electrical cords, drapery, furnishings, and other combustibles at least 3 feet (0.9m) from the front of the heater and 6 inches above and on both sides.

**IMPORTANT!** The Energy Plus heater is factory configured at 240 volts, but can be switched to 120 volts using the supplied key. If replacing an existing heater, check labels of the old heater and replace using the same voltage.

**WARNING** Risk of Electrical Shock. Connect grounding lead to grounding screw provided. Keep all foreign objects out of heater.

Warranty is void if any material is sprayed on the element or blower.

# Installation Instructions

## Part One

All electrical work and materials must comply with the National Electric Code (NEC), the Occupational Safety and Health Act (OSHA), and all state and local codes.

**WARNING.** Fire or explosion may occur. **DO NOT** install heater in any area where combustible vapors, gases, gasoline, liquids, or excessive lint or dust are present. A heater has hot and arcing or sparking parts inside.

**REPLACEMENT:** If you are replacing an existing Com-Pak Model, proceed to **PART TWO**, page 5. Note: can replace vertical mounted wall cans only, not ceiling or horizontal mounted. Confirm that your existing wall can is mounted flush with outside of sheetrock. Adjust if required. May not be used with a wall thermostat.

**PLACEMENT:** Install vertically. Heater is not approved for horizontal or ceiling mount applications.

**CONTROLS:** A built-in digital thermostat is included.

### How do I install for new construction?

#### STEP 1 Mount The Wall Can

The CE Series heater **REQUIRES A MINIMUM** distance of 6 inches from adjacent surfaces and 4½ inches from the floor. However, Cadet **RECOMMENDS** 12 inches from all adjacent surfaces and 12 inches above the floor for longer and cleaner performance. Heaters must be spaced at least 3 feet apart.

Secure the wall can to the stud with 2 screws (See Figures 1 & 2). As an option, the rubber shim provided may be attached to side of wall can to square the wall can to the stud.

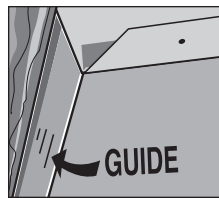

**Figure 1**  
Face of wall can must extend ½ or 5/8 inch from face of stud to allow for thickness of sheetrock.

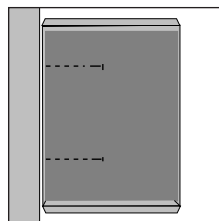

**Figure 2**  
Attach wall can to stud with screws through holes provided in wall can. **IMPORTANT:** wall can should be mounted flush with outside of sheetrock.

#### STEP 2 Connect Supply Wires

Route the supply wire from circuit breaker to heater. Remove a knockout and attach the supply wire with a strain relief connector leaving enough wire length to reach ground screw. Connect supply ground wire to grounding screw in wall can (See Figure 3). Proceed to **PART TWO**.

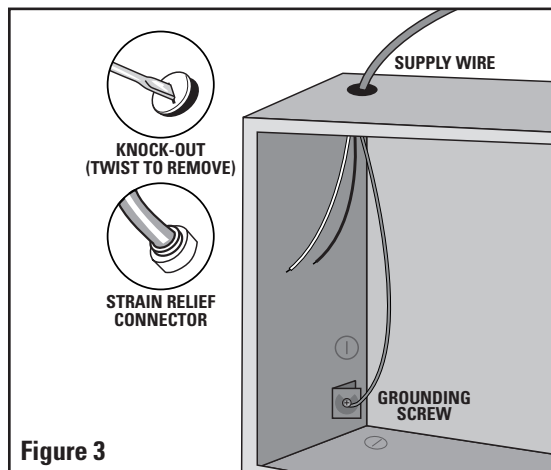
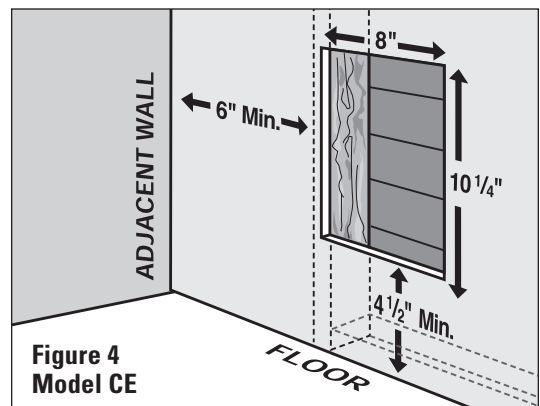

**Figure 3**

### How do I install in an existing wall?

#### STEP 1 Cut Hole In Wall

Cut a hole 8 inches wide by 10¼ inches high next to a wall stud. This heater **REQUIRES A MINIMUM** distance of 6 inches from adjacent wall surfaces and 4½ inches from the floor. However, Cadet **RECOMMENDS** 12 inches from all adjacent wall surfaces and 12 inches from the floor (See Figure 4).



**Figure 4**  
**Model CE**

#### STEP 2 Connect Supply Wires

Route supply wire from circuit breaker directly to heater. Remove a knockout and attach the supply wire with a strain relief connector, leaving 10 inch wire lead for later use (See Figure 3). Connect supply ground wire to grounding screw supplied in wall can.

#### STEP 3 Mount The Wall Can

Insert wall can into opening; keeping wall can flush with wall surface. Secure can to wall stud with 2 screws through holes provided in can. **IMPORTANT:** wall can should be mounted flush with outside of sheetrock.

Proceed to **PART TWO**

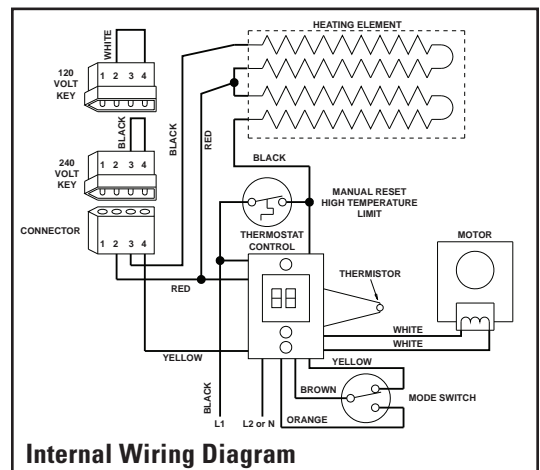

**Internal Wiring Diagram**

**Proceed to Part Two**

# INSTALLATION INSTRUCTIONS (CONTINUED)

## Part Two

### STEP 1 Determine Supply Voltage A qualified or dedicated circuit from circuit breaker panel is required.

Before operating, verify that the heater is configured for correct supply voltage and circuit load. The Energy Plus heater is configured for 240-Volt operation by default. For 120-Volt installation, you must switch the supplied "keys" (see Step 2) to easily configure the heater to the same voltage as the supply wires. The volt sensor can assist you in confirming correct installation, after installing the heater assembly (Step 3). Don't worry: if you install incorrectly, you can safely reconfigure the heater using the Fault Code Chart on page 7 without damaging the heater.

### STEP 2 Select Proper Heater Voltage

#### For 240-Volt configuration:

The Energy Plus Heater is factory configured for 240-Volt operation with a "black key" (Figure 5). Proceed to STEP 3.

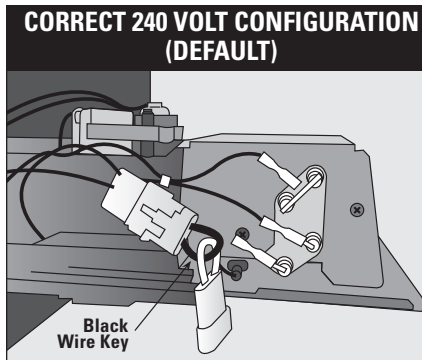

Figure 5

#### For 120-Volt configuration:

Remove the supplied "black key" (FIGURE 6) located on the side of the heater. Replace with the provided "white key" as shown in Figure 7.

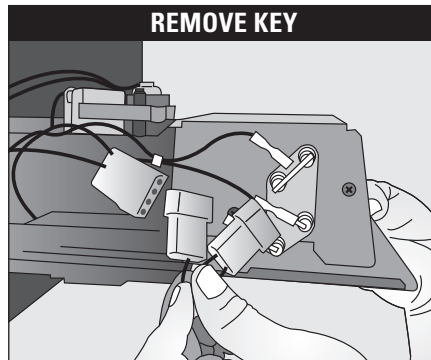

Figure 6

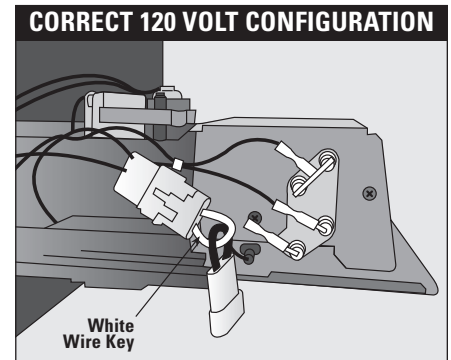

Figure 7

### How do I insert the heater assembly into the wall can?

### STEP 3 Install Heater Assembly

Turn heater assembly so that the front of it is facing the floor (element down with motor facing you). You can then rest bottom edge of the heater assembly on the bottom of the wall can while supporting the edge closest to you. (See Figure 8).

Connect the supply wires to the heater wires with connectors (See Figure 9 or Figure 9a).

Now rotate heater assembly into wall can so that the bottom edge drops into the half round slots in bottom lip of wall can (See Figure 10).

**IMPORTANT:** Push wires into bottom and left side of wall can during insertion. Be sure supply wires are not caught between motor and wall can. After confirming that the bottom edge of heater is positioned in the slots in bottom lip of wall can, attach assembly at top with screw provided.

### STEP 4 Install Grill

Align push buttons and digital display with grill cutouts before tightening with grill screws provided. Do not overtighten (See Figure 11).

### STEP 5 Confirm your Supply Voltage and Proper Installation

Turn electrical power back on at the circuit breaker or fuse box. **WAIT 10-15 seconds for heater to power-up before pushing any buttons.**

The Energy Plus heater is equipped with a smart sensor that will indicate if the voltage does not match your key configuration. Review the digital display to confirm if you have configured the heater to match the supply voltage. The heater will not operate if it is not configured correctly.

#### If the heater has been configured to the correct circuit:

Display backlight will come on and read "88" for a moment; then will display actual temperature if in NO HEAT mode; flash the temperature set point if in HEAT mode; or 1,2,3 if in FAN ONLY mode.

After 10 seconds, room temperature will be displayed.

Proceed to **OPERATING YOUR HEATER.**

**If the heater has been configured to the incorrect circuit or improperly installed, a code will display. See FAULT CODES, page 7.**

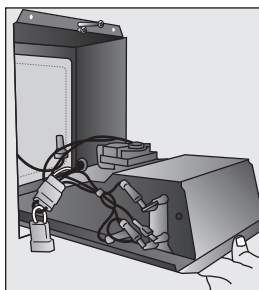

Figure 8

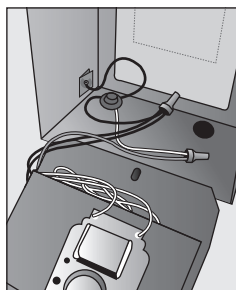

Figure 9  
(Single Heater  
120/208/240V)

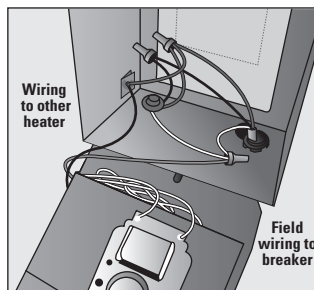

Figure 9a  
(Multiple heaters on a branch  
circuit, 208 or 240V ONLY)

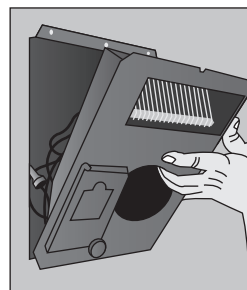

Figure 10

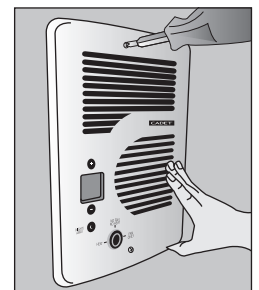

Figure 11



# OPERATING YOUR HEATER

**WARNING: HEATER MUST BE PROPERLY INSTALLED BEFORE IT IS ENERGIZED OR OPERATED.**

## Digital Display

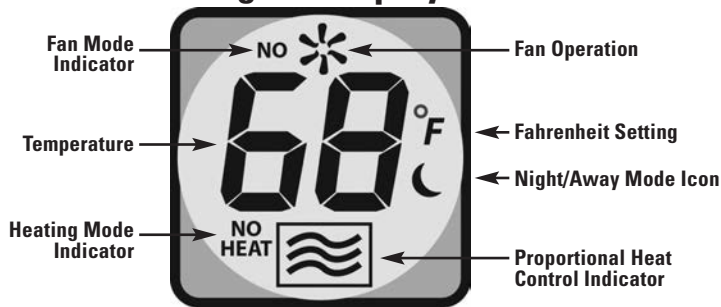

## Control Buttons

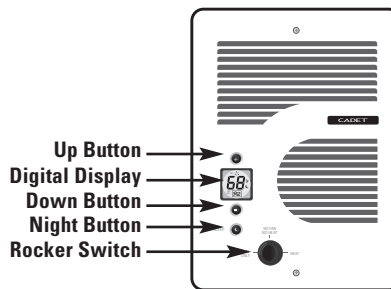

## Heater Modes

Using the rocker switch, you can move the switch to three modes.

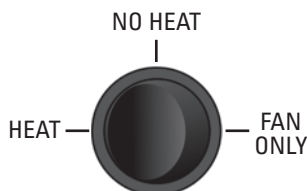

Rocker Switch

### CENTER POSITION: NO HEAT MODE

After a brief cool down period (up to 4 minutes), the heater will shut down. It will not resume heating until the rocker switch is flipped to the HEATING (left) position.

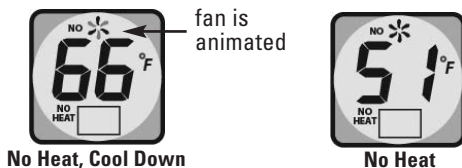

### LEFT POSITION: HEAT MODE

Your ComPak Energy Plus heater has a unique variable speed blower that auto adjusts the heat output based on the room's requirements. Once you set the thermostat to your desired temperature, the heater will vary the wattage output for maximum efficiency.

The digital display will show the level of heat being output to maintain the room's temperature.

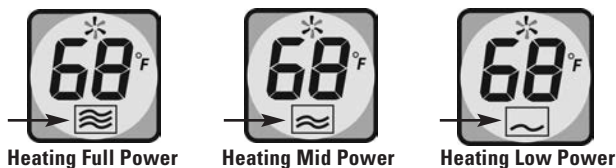

### RIGHT POSITION: FAN ONLY MODE

The FAN ONLY mode can circulate air but will not supply heat. Three fan speeds are available. To adjust the fan speed: With rocker switch in the RIGHT position, push top (+) or bottom (-) digital buttons up or down. Display will read "1" for low speed, "2" for medium speed, or "3" for high speed during the set up process, then resume to temperature display.



## Setting Desired Heating Temperature

- Turn rocker switch to HEAT mode.
- Touch the up (+) button or the down (-) button to set your desired temperature.

Temperature Setpoint Range: 40°F - 90°F

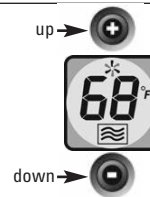

## Program Your Night/Away Button

You can preset a night or away temperature set point, for quick and easy "one-touch" energy savings.

- Turn rocker switch to HEAT mode.
- Push Night (moon icon) button to activate. The moon icon will show in display screen. The "night/away" setpoint temperature will flash for 5 seconds.
- Push the Up (+) or Down (-) button to change your desired night/away set point.
- To return to your previous HEAT set point when you awake or return, push the Night (moon icon) again. The setpoint temperature will flash for 5 seconds. The moon icon will no longer be in display screen.
- To return to your previous night/away setpoint, simply push the Night (moon icon) button.



Night/Away Button



Night/Away Mode

## Max/Min Temperature Lock

You can preset a maximum and/or minimum set point as a child safety or tamper proof option. To preset a **maximum** setpoint:

- Move rocker switch to NO HEAT mode.
- Press and hold both the Night (moon icon) button and the Up (+) button at the same time, for at least 5 seconds, until the "HL" (high limit) is displayed.
- Release buttons: temperature setpoint will flash and alternate with "HL" on the display.
- Using the Up (+) or Down (-) button, set your **maximum** desired set point.
- Turn rocker switch back to HEAT mode.
- To remove the lock, follow same instructions, and set to maximum of 90 degrees.
- To preset a **minimum** set point, follow same steps, but press and hold both the Night (moon icon) and Down (-) buttons until the "LL" (low limit) is displayed.

## Energy Saving Tips

- Set your Night/Away (moon icon) set point to as low as you are comfortable, for a cooler nighttime temperature.
- When you exit the room or leave your home, push the Night (moon icon) button to drop the temperature set point.
- If your heater is positioned in a drafty area or exposed to direct sunlight, temperature reading will be affected. Set temperature to desired comfort level, not a "number" on the digital display.
- If you will be away for an extended period of time (and have no concerns about freezing conditions), turn the rocker switch to NO HEAT for even greater energy savings.

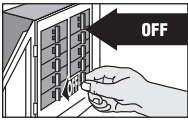

## ⚠ WARNING

Turn the electrical power off at the electrical panel board (circuit breaker or fuse box) and lock or tag the panel board door to prevent someone from turning on power while you are working on the heater. Failure to do so could result in serious electrical shock, burns, or possible death.

## FAULT CODES

CONSULT LOCAL ELECTRICAL CODES TO DETERMINE WHAT WORK MUST BE PERFORMED BY QUALIFIED ELECTRICAL SERVICE PERSONNEL.

DIGITAL DISPLAY READS:	PROBLEM	SOLUTION
No Display	1.No power, internal fuse blown, internal control faulty	1. Check that power is being supplied to heater; if operating on generator power, make sure line frequency is correct; if display still doesn't turn on then control is defective and heater assembly must be replaced.
F1	1.Grill is interfering with buttons	1. Turn power off at circuit breaker, realign grill so buttons can push freely. Turn power back on at circuit breaker.
F2	1.Wrong voltage selector key	1. Turn power off at the circuit breaker, remove 120V white key, install 240V black key, turn power back on at circuit breaker.
F3	1.Wrong voltage selector key	1. Turn power off at the circuit breaker, remove 240V black key, install 120V white key, turn power back on at circuit breaker.
F4	1. Line voltage is too low 2. Loose wire connections, or black/white key is not fully engaged	1. Clears automatically when line voltage returns to normal. 2. Check wire connections and that black or white key is securely in place.
F6	1. Line voltage is too high	1. Clears automatically when line voltage returns to normal.
F7	1. Thermal limit (temperature limiting control) tripped	1. Inspect heater for blockage, obstruction, and/or proper clearance. Move rocker switch to center (NO HEAT) position and wait for heater to cool. Push manual reset limit button per the MAINTAINING YOUR HEATER instructions (Page 8).
F8	1. Internal control fault	1. Disconnect power, reconnect power. If F8 code returns, control is faulty. Replace heater assembly.
12	1.No voltage selector key installed	1.Turn power off at the circuit breaker, install 120V white key, turn power back on at circuit breaker.
24	1.No voltage selector key installed	1.Turn power off at the circuit breaker, install 240V black key, turn power back on at circuit breaker.

## Troubleshooting Chart

SYMPTOM	PROBLEM	SOLUTION
Heater is working, but room does not reach desired temperature.	1. Heat loss from room is greater than heater capacity. 2. Furniture or other surfaces may be too close to the heater.  3. Verify if temperature lock has been set. Thermostat setpoint is 40-90 degrees.	1. Close doors and windows. Provide additional insulation, or install a higher wattage heater or multiple heaters if necessary. (If your circuit is rated for more capacity.) 2. Remove furniture or other surfaces to appropriate clearances, so air can flow freely throughout room. Maintain a minimum distance of 6 inches from adjacent surfaces, 4.5 inches from the floor, and 3 feet from furniture or other objects placed directly in front of the heater. 3. See "Maximum Temperature Lock" on page 6.
Breaker trips immediately upon energizing heater.	1. Overloaded circuit.  2. A short circuit exists in the supply or heater wiring.  3. Defective circuit breaker. 4. Thermostat malfunction.	1. The total amperage of all heaters on a branch circuit must not be more than 80% of the amperage rating of the circuit breaker and supply wire ratings. Use a lower wattage heater, or reduce the number of heaters on the circuit. 2. Shorted supply or heater wires may be accompanied by severe sparking. Inspect all supply and heater wiring insulation for damage. Do not reset the circuit breaker until all electrical shorts have been repaired. 3. Replace the circuit breaker. 4. Replace heater assembly.
Heater fan operates, but does not discharge warm air.	1. Rocker switch is not set to HEAT mode. 2. Element has failed.	1. Turn rocker switch to HEAT mode. 2. Replace element.
Heater will not shut off.	1. Heater continues to run at low speed 2. Heat loss from room is greater than heater capacity.  3. Thermostat is not functioning properly.	1. If room temperature is being regulated and maintained, a low fan speed and low heat output is normal for this energy saving heater. 2. Close doors and windows. Provide additional insulation, or install a higher wattage heater or multiple heaters if necessary. (If your circuit is rated for more capacity.) 3. Replace heater assembly.
Heater discharges smoke or emits a burnt odor.	1. Dust, lint or other matter has accumulated inside heater. 2. Poor or loose electrical connections	1. Clean heater (See "Maintaining Your Heater" section for instructions).  2. Turn off power at circuit breaker. Inspect all supply and heater wires for loose or poor connections. Secure or reconnect all loose connections. Do not reset circuit breaker until all connections have been checked or repaired.
Element heats for a moment without the fan turning, then immediately stops heating.	1. Defective motor or internal connection. 2. Fan is jammed.	1. Heater or fan motor requires replacement. 2. Remove obstruction and confirm that fan is spinning freely. Press reset button per the "Maintaining Your Heater" section.
Heater does not run.	1. Thermostat is set too low.  2. Rocker switch is set to "NO HEAT" 3. Heater has tripped the manual high-temperature reset switch. 4. Power not on at the circuit breaker. 5. Broken or poorly connected wire(s) to heater. 6. Defective thermostat. 7. Circuit breaker not installed correctly.	1. Adjust thermostat to a higher temperature until heater operates (See Problem #5 if the problem persists). 2. Switch rocker switch to "HEAT" mode. 3. Press the manual reset button (See "Maintaining Your Heater" section for instructions).  4. Turn on the correct circuit breaker in the main panel. 5. Turn off power at circuit breaker. Check supply wire continuity and proper connection to heater wires. 6. Repair or replace the heater assembly. 7. Correct the circuit breaker installation.
Heater continually trips the manual reset temperature limit control.	1. Dust, lint or other matter has accumulated inside heater. 2. Airflow is blocked.  3. Fan or motor is jammed.  4. None of the above.	1. Clean heater (See "Maintaining Your Heater" section for instructions).  2. Remove obstruction. Maintain a minimum distance of 6 inches from adjacent surfaces, 4.5 inches from the floor, and 3 feet from furniture or other objects placed directly in front of the heater. 3. Remove obstruction, and press heater manual reset button (See "Maintaining Your Heater" section for instructions). 4. Replace heater assembly.

# MAINTAINING YOUR HEATER

## Maintenance

As needed, or every six months minimum.

1. **⚠️ WARNING! Before removing grill, turn the electrical power off at the electrical panel board (circuit breaker or fuse box). Lock or tag the panel board door to prevent someone from accidentally turning the power on while you are working on the heater. Failure to do so could result in serious electrical shock, burns, or possible death.**
2. Allow the heater to cool for 20 minutes before proceeding.
3. It is important that you verify power has been turned off and no power is going to the heater before proceeding. Circuit breakers are often not marked correctly and turning the wrong breaker off could mean electricity is flowing to the heater, even if the heater does not appear to be working. If you are uncomfortable working with electrical appliances, unable to follow these guidelines, or do not have the necessary equipment, consult a qualified electrician.
4. Once you verify the power has been turned off correctly, proceed to the next step.
5. Remove screws and take off grill.
6. Wash grill with hot soapy water and dry immediately.
7. While holding fan (to avoid damage or bending), use a hair dryer or vacuum on blow cycle to blow debris through the top element (Do not touch element).
8. Do not use or spray any liquid cleaning products on your heater.
9. Do not lubricate the motor.
10. Vacuum fan area without touching the elements.
11. Replace grill and secure with screws.
12. Turn power back on at the electrical panel board.
13. Set temperature to desired setting.

## About the Manual Reset Temperature Limit Control

The heater is protected by a temperature-limiting control. The manual reset temperature limit control is designed to open the heater circuit when excessive operating temperatures are detected. The problem must be assessed (typically the heater is blocked or needs cleaning) and the limit must be reset to resume operation.

## Resetting the Manual Reset Temperature Limit Control

If the manual reset limit control has opened the heater circuit due to excessive operating temperatures, the heater will not work until the manual reset limit button is pressed.

The “manual reset limit button” is the red button located on the upper left side of your heater, behind the grill louvers located just above the digital temperature display.

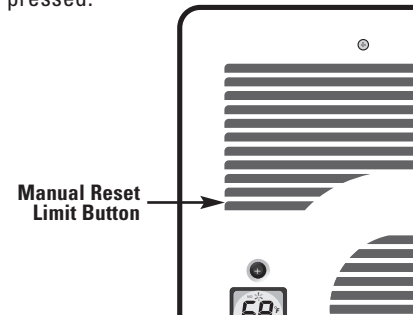

After allowing the unit to cool for at least 10 minutes and resolving the problem causing the limit to trip (typically the heater is blocked or needs cleaning); use a narrow object such as a ball-point pen to access the manual reset button through the upper-left center section of the heater grill. Press **FIRMLY** and be sure to listen and feel for a click, indicating it has been reset.

## Warranty

**LIMITED ONE-YEAR WARRANTY:** Cadet will repair or replace any Cadet product, including thermostats and electronic controls, found to be defective within one year after the date of purchase.

### Extended Product Warranty

**LIMITED FIVE-YEAR WARRANTY:** Cadet will repair or replace any Energy Plus (CE) series heater found to be defective or malfunctioning from first date of purchase through the fifth year.

### These warranties do not apply:

1. Damage occurs to the product through improper installation or incorrect supply voltage;
2. Damage occurs to the product through improper maintenance, misuse, abuse, accident, or alteration;
3. The product is serviced by anyone other than Cadet;
4. If the date of manufacture of the product cannot be determined;
5. If the product is damaged during shipping through no fault of Cadet.
6. CADET'S WARRANTY IS LIMITED TO REPAIR OR REPLACEMENT AS SET OUT HEREIN. CADET SHALL NOT BE LIABLE FOR DAMAGES SUCH AS PROPERTY DAMAGE OR FOR CONSEQUENTIAL DAMAGES AND/OR INCIDENTAL EXPENSES RESULTING FROM BREACH OF THESE WRITTEN WARRANTIES OR ANY EXPRESS OR IMPLIED WARRANTY.
7. IN THE EVENT CADET ELECTS TO REPLACE ANY PART OF YOUR CADET PRODUCT, THE REPLACEMENT PARTS ARE SUBJECT TO THE SAME WARRANTIES AS THE PRODUCT. THE INSTALLATION OF REPLACEMENT PARTS DOES NOT MODIFY OR EXTEND THE UNDERLYING WARRANTIES. REPLACEMENT OR REPAIR OF ANY CADET PRODUCT OR PART DOES NOT CREATE ANY NEW WARRANTIES.

8. These warranties give you specific legal rights, and you may also have other rights which vary from state to state. Cadet neither assumes, nor authorizes anyone to assume for it, any other obligation or liability in connection with its products other than as set out herein.

If you believe your Cadet product is defective, please contact Cadet Manufacturing Co. at 360-693-2505, during the warranty period, for instructions on how to have the repair or replacement processed. Warranty claims made after the warranty period has expired will be denied. Products returned without authorization will be refused.

### Parts and Service

Visit <http://support.cadetco.com> for information on where to obtain Parts and Service.



### Reduce-Reuse-Recycle

This product is made primarily of recyclable materials. You can reduce your carbon footprint by recycling this product at the end of its useful life. Contact your local recycling support center for further recycling instructions.