

Leviton QuickPlate™ Wallplates



5EA20-XXX

APPLICATION

Leviton's QuickPlate wallplates are designed to distribute data, phone and TV connections. They facilitate a variety of connectivity solutions for both residential and office applications. This unique preassembled wallplate design provides quick and easy installation.

SPECIFICATION

The QuickPlate shall meet all applicable standards: cULus Listed; TIA/EIA-568A, FCC Part 68 and SCTE compliant. The units shall have a port label and each jack shall be labeled with appropriated wiring scheme. The Category 5e connector shall have the ability to support high megabit and shared-sheath applications. The voice grade connector shall accept all telephone applications and meet all applicable FCC requirements. The F-type bulkhead connector shall accept all video applications. The wallplates shall be offered in two sizes and four colors. The manufacturer shall provide a two-year limited product warranty.

STANDARDS COMPLIANCE

Meets TIA/EIA-568-A for Category 5e requirements
Meets FCC part 68
cULus Listed
Society of Cable Telecommunications Engineers (SCTE) Compliant
Made in China

PHYSICAL SPECIFICATION

Dimensions: See second page
Materials: Wallplate, ABS plastic
Connector Type and Rating: Data - Category 5e
Phone - USOC voice grade
Video - F-81 style Bulkhead, 2.5GHz, Nickel Plated

DESIGN CONSIDERATIONS



- Offers essential telephone, data and video distribution
- Robust one-piece lead-frame and wallplate design
- Offered in standard size and mid-way size
- Data port accepts T568A Category 5e wiring
- Phone port accepts USOC wiring
- F-connector accepts video applications
- 110 IDC punchdown for voice and data jacks
- Includes port labels
- Includes wiring labels for data and phone jacks
- Includes plastic punchdown tool
- Available in white, ivory, almond and light almond

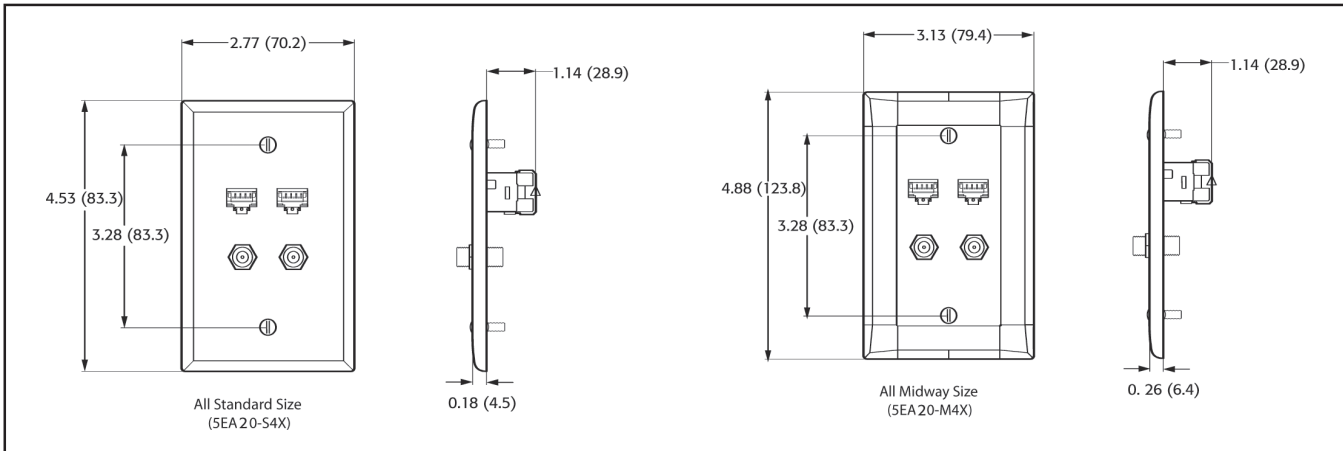

Back of plate,
5EA20-S3W

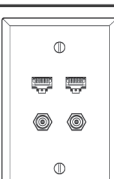

5EA20-XXX

Configuration	Color	Standard Size	Mid-Way Size
1 DATA 	IVORY	5EA20-S1I	5EA20-M1I
	WHITE	5EA20-S1W	5EA20-M1W
	ALMOND	5EA20-S1A	5EA20-M1A
	LIGHT ALMOND	5EA20-S1T	5EA20-M1T
1 DATA, 1-F 	IVORY	5EA20-S2I	5EA20-M2I
	WHITE	5EA20-S2W	5EA20-M2W
	ALMOND	5EA20-S2A	5EA20-M2A
	LIGHT ALMOND	5EA20-S2T	5EA20-M2T
1-DATA 1-PHONE 1-F 	IVORY	5EA20-S3I	5EA20-M3I
	WHITE	5EA20-S3W	5EA20-M3W
	ALMOND	5EA20-S3A	5EA20-M3A
	LIGHT ALMOND	5EA20-S3T	5EA20-M3T
2-DATA, 2-F 	IVORY	5EA20-S4I	5EA20-M4I
	WHITE	5EA20-S4W	5EA20-M4W
	ALMOND	5EA20-S4A	5EA20-M4A
	LIGHT ALMOND	5EA20-S4T	5EA20-M4T

WARRANTY INFORMATION

Two -year limited product warranty

