

Job Name:	
Job Location:	
Engineer:	
Contractor:	
Tag:	
PO#:	
Rep:	
Wholesale Dist.:	

DESCRIPTION

The Lead Free* Apollo Model DUCLF4N (4NLF-300) Dual Check Valve prevents backflow by either backpressure or back-siphonage from a cross-connection between potable water lines and substances that are objectionable, but not health hazards. **Proudly made in the USA.**

FEATURES

- Lead Free* AB 1953 certified
- Corrosion Resistant
- Replaceable Check Modules
- Available In Standard And Swivel Connections
- **100% Manufactured in USA**

APPROVALS

- ASSE 1024 and CSA B64.6
- ANSI 3rd party approval to AB 1953 0.25% lead max

STANDARD MATERIALS LIST

BODY	Lead Free* Bronze C89836
TAILPIECE	Lead Free* Brass C27450
UNION NUT	Brass C36000
CHECK MODULES	Glass-Filled Noryl* (3/8"-1/2") Acetal (3/4"-1")
SPRINGS	Stainless Steel
SEAT DISCS	EPDM (3/8"-1/2") Buna-N (3/4"-1")

PERFORMANCE RATING

- Maximum Working Pressure: 175 psi
- Temperature Range: 33°F - 180°F

DIMENSIONS

SIZE (IN.)	DIMENSIONS (IN.)		WT. (LB.)
	A	B	
3/8" & 1/2"	3.32	1.88	0.70
3/4"	4.38	2.00	1.40
3/4" Meter Swivel	4.75	2.00	1.60
1"	4.38	2.00	1.40
1" Meter Swivel	4.75	2.00	1.75

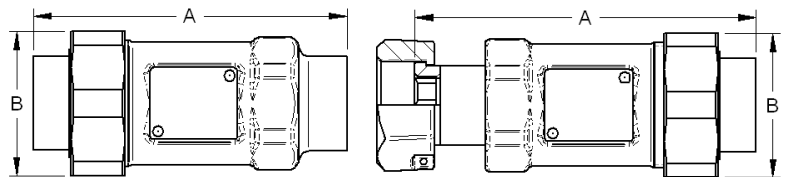

PART NUMBER MATRIX

4NLF	3X	XX	X
	INLET CONNECTION	SIZE	OUTLET CONNECTION
4NLF - LEAD FREE	A - FNPT	2 - 3/8"	A - FNPT
	B - MNPT	3 - 1/2"	B - MNPT
	C - FEMALE METER THREAD	4 - 3/4"	C - FEMALE METER THREAD
		5 - 1"	E - MALE METER THREAD
		6 - 1-1/4"	F - FEMALE BSPP

EXAMPLE: 4NLF-3S5-4A = 1" female meter swivel inlet (for connection to a 3/4" water meter) x 3/4" FNPT outlet.
 For meter threads, order one size larger than meter size.
 1-1/4" is only available for the Female Meter Swivel Connection.
 Not all inlet and outlet combinations are available. Please contact Conbraco Customer Service for availability.

FLOW CURVES

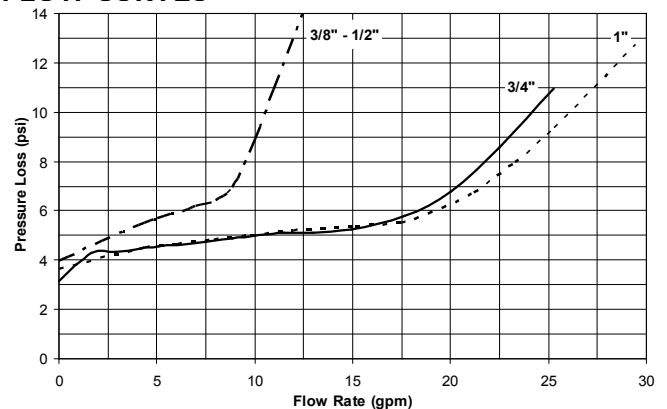

*LEAD FREE: The wetted surfaces of this product shall contain no more than 0.25% lead by weighted average. Complies with Federal Public Law 111-380. ANSI 3rd party approved and listed.