

60" x 30" BRADENTON

ACRYLIC ALCOVE SOAKING TUB

SKU: 948256



FEATURES

- Product Finish: Biscuit
- Overflow Hole: Yes
- Shape: Rectangle
- Material: Acrylic
- Length: 59-3/4"
- Width: 30"
- Height: 18-7/8"
- Tub Interior Length: 41-3/4"
- Tub Interior Width: 19"
- Water Depth To Overflow: 14-1/4"
- Drain Included: Optional
- Drain Placement: End
- Faucet Included: No
- Water Capacity (Gallons): 48
- Tub Weight Uncrated (lbs): 87
- Tub Weight Crated (lbs): 197
- All dimensions (± 1/2").
- Integral arm rests.
- Textured slip-resistant bottom.
- Pre-leveled base.

CONTENTS

AIR & WHIRLPOOL TUB	PAGE 2
60" X 30" TUB	PAGE 3

SIGNATURE HARDWARE Lifetime Warranty

See website for detailed warranty information.

REVISED 01/15/2020

CODE: SHBDS6030LWH/SHBDS6030RWH/SHBDS6030LBS/SHBDS6030RBS

AIR TUB AND WHIRLPOOL TUB

COMPONENTS LIST

- Powerful whirlpool pump with variable flow device
- Heated blower for air bath system

INSTALLATION

- Whirlpool and Total Massage units require dedicated 20 Amp, 120V service
- You must provide a receptacle with a 20 Amp configuration
- Electrical outlet must be mounted 4" (101mm) above the floor line and 12" max (305mm) inside from the edge of the bathtub, or in accordance with local building and electrical codes

INTEGRATED CONTROL PANEL

- Whirlpool Baths: Equipped with on/off switch actuator. Each depression of the switch will activate the pump
- Air Baths: Equipped with a 3-speed air switch actuator. Each depression of the switch will change the flow of air
- Total Massage Baths: Equipped with both an on/off air switch actuator for whirlpool function and 3-speed air switch actuator for air function

INSIDE OF BATH

- (8) HIGH-FLOW DIRECTIONAL AND VOLUME-ADJUSTABLE WHIRLPOOL JETS
- (65) CHANNEL-FED AIRJETS (air bath and total massage)



WHIRLPOOL JET

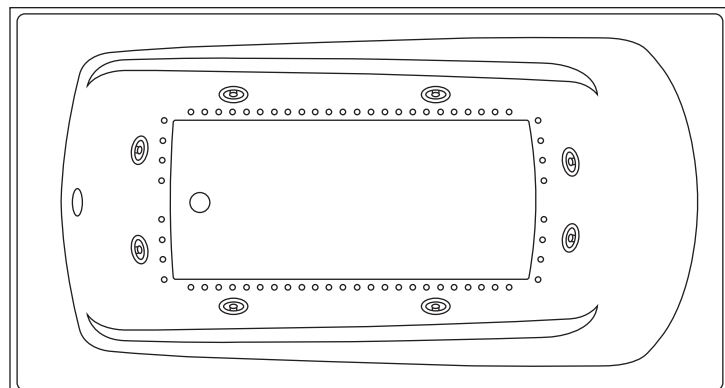

ELECTRICAL CONFIGURATIONS

WHIRLPOOL WITH INSTALLED AIR SWITCH

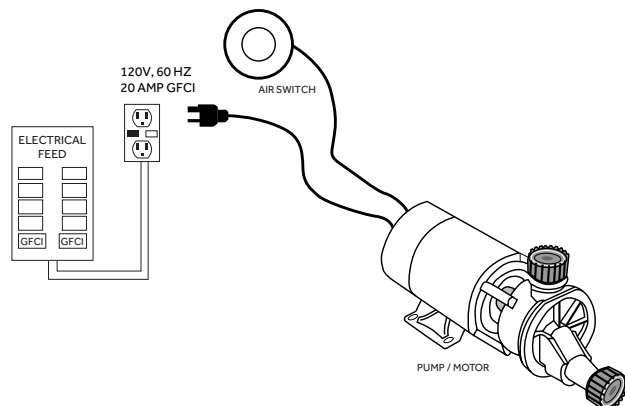

TOTAL MASSAGE CIRCUIT WITH OPTIONAL HEATER

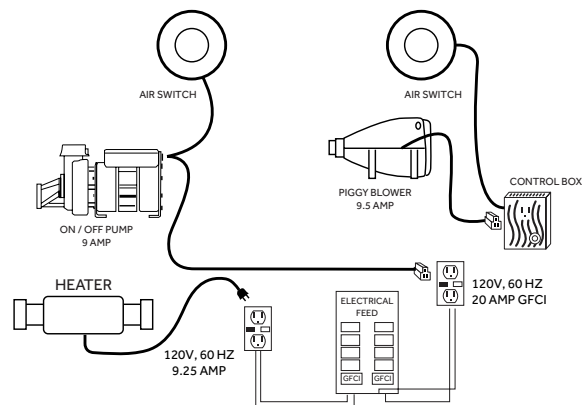

AIR BATH CIRCUIT

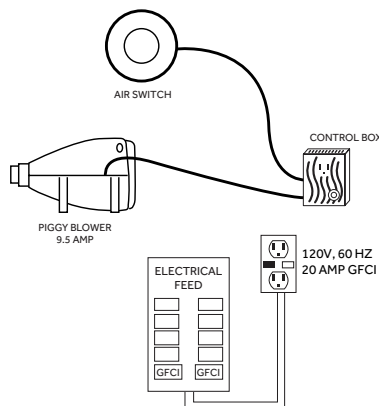

60" x 30" BRADENTON

ACRYLIC ALCOVE SOAKING TUB

SKU: 948256

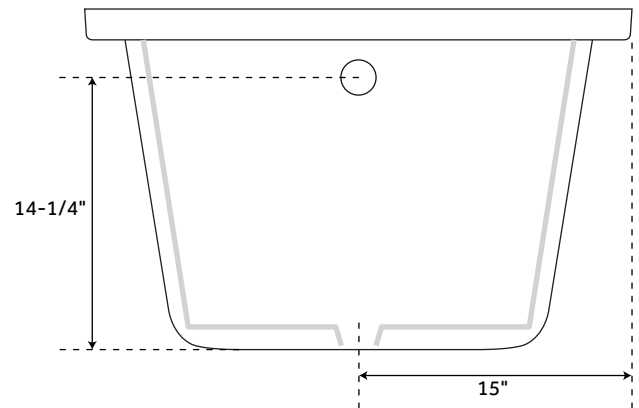
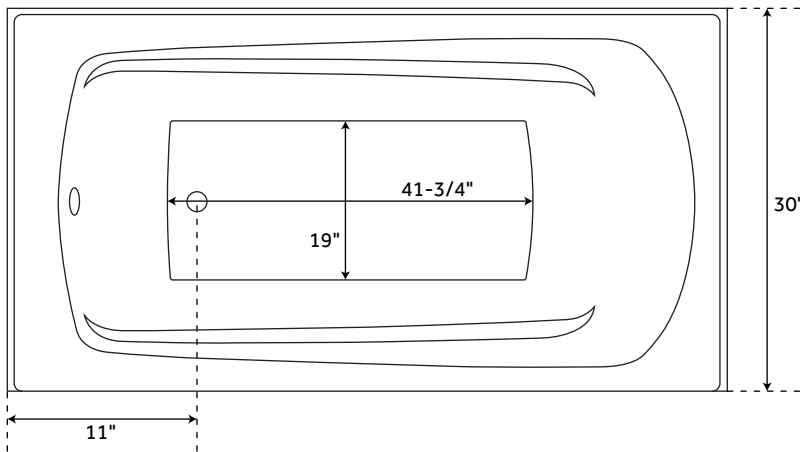
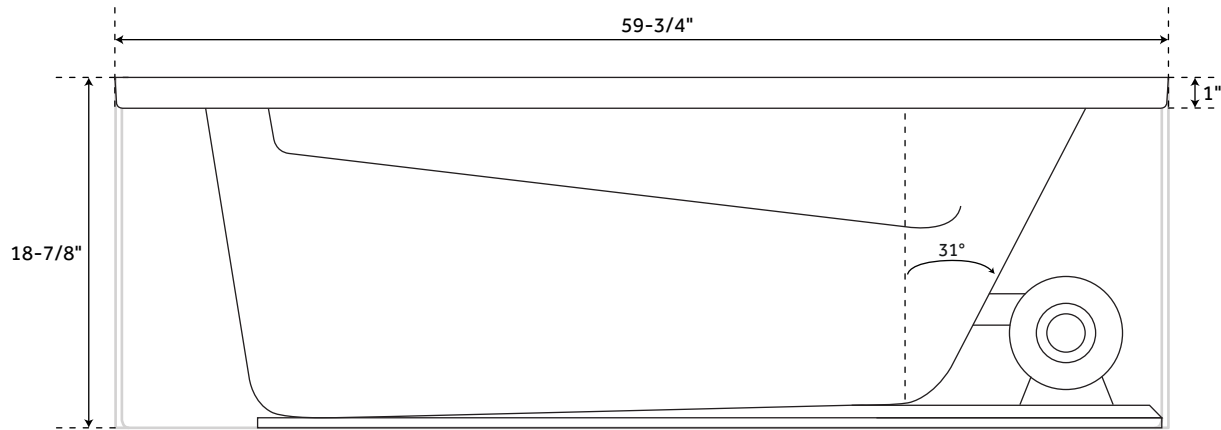

FEATURES

Product Finish: Biscuit
Overflow Hole: Yes
Shape: Rectangle
Material: Acrylic
Length: 59-3/4"
Width: 30"
Height: 18-7/8"
Tub Interior Length: 41-3/4"
Tub Interior Width: 19"
Water Depth To Overflow: 14-1/4"
Drain Included: Optional
Drain Placement: End
Faucet Included: No
Water Capacity (Gallons): 48
Tub Weight Uncrated (lbs): 87
Tub Weight Crated (lbs): 197
All dimensions ($\pm 1/2"$).

SIGNATURE HARDWARE LIFETIME WARRANTY

See website for warranty information



All dimensions and specifications are nominal and may vary. Use actual products for accuracy in critical situations.

PAGE 3