

7-210-CK

Maxline

Specification Submittal

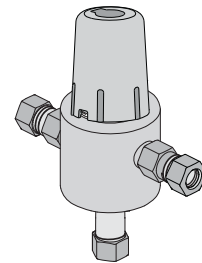

Model Numbers		Specification
<input type="checkbox"/> 7-210-CK <i>Connections: 3/8" compression fittings</i>		<p>Water temperature limiting valve including integral checks and dual stainless steel strainers for double protection against suspended particulate in supply lines. Valve made from lead free* metal components (see table 1 for flow rates).</p> <p>Temperature control range: 59°F - 113°F (15°C - 45°C)</p> <p>Minimum supply pressure: 20 psi (138 kPa) Maximum supply pressure: 125 psi (1034 kPa) Inlet to outlet temperature differential: 10°F (5.55°C)</p>
Modifications		
<input type="checkbox"/> -B <i>Wall cabinet in white enamel finish including wall mounting bracket</i>		
<p>Note: Append appropriate -suffix to model number.</p>		
Compliance		<p>*According to US Senate bill S.3874, the term "lead free" is defined as follows: "not more than a weighted average of 0.25 percent lead when used with respect to the wetted surfaces of pipes, pipe fittings, plumbing fittings, and fixtures"</p>
<p>-ASME A112.18.1/CSA B125.1</p> <p>-ASME A112.18.3/CSA B125.3</p> <p>-ASSE 1070</p> <p>-CA 116875 (AB 1953)</p> <p>-NSF 372</p> <p>-US S.3874</p> <div></div>		
		Warranty
		<p>5 Years - for commercial installations.</p> <p>Refer to www.symmons.com/warranty for complete warranty information.</p>

Table 1: Flow Rate - gpm (L/min)								
Valve Model	Size Connection	Min. Flow Rate	Pressure Differential - psi (kPa)					
			5 psi (34 kPa)	10 psi (69 kPa)	20 psi (138 kPa)	25 psi (172 kPa)	30 psi (207 kPa)	45 psi (310 kPa)
7-210-CK	3/8" Compression (10 mm)	0.5 gpm (1.9 L/min)	1.0 gpm (3.8 L/min)	2.0 gpm (7.6 L/min)	3.0 gpm (11.4 L/min)	3.5 gpm (13.3 L/min)	4.0 gpm (15.2 L/min)	5.0 gpm (19.0 L/min)

7-210-CK

Maxline

Specification Submittal

Dimensions

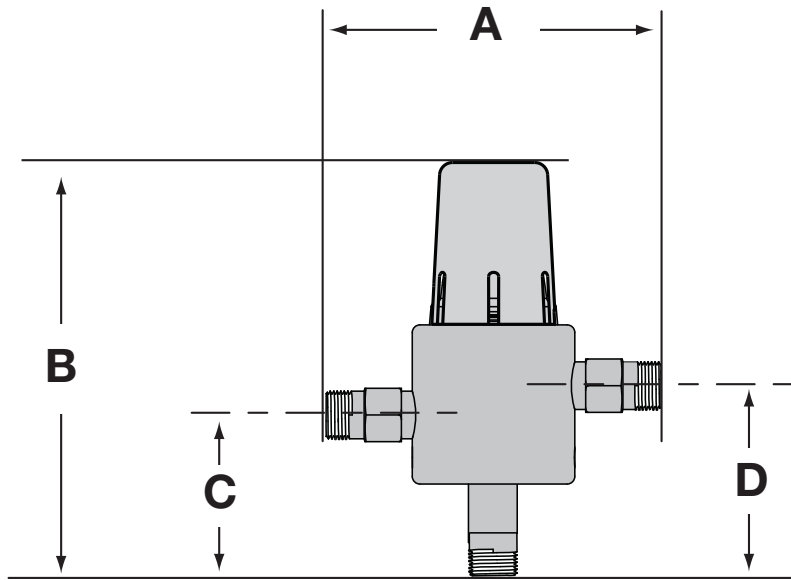

Measurements	
A	4 1/2", 114 mm
B	5 1/4", 133 mm
C	2", 50 mm
D	2 1/2", 64 mm

Note: Dimensions are subject to change without notice.