

Installation Instructions

SELECTRONIC™ Proximity ICU Faucet

MODEL NUMBERS

6055.193

6056.193



6055 / 6056 ICU Faucet shown Installed on
American Standard 9118.111 ICU Sink

Certified to comply with ASME A112.18.1M
© 2011 American Standard

M965119 REV. 1.1

Product No.'s & Options	1
Specifications	2
How to Install	2-3
Electrical Hook-up	4-6
Maintenance	7-8
FAQ,s	9
Replacement Parts	10

American Standard

NOTE TO INSTALLER: Please give this manual to the customer after installation.

To learn more about American Standard Faucets visit our website at: www.us.amstd.com or U.S. customer's e-mail us at: faucetsupport@amstd.com

For Parts, Service, Warranty or other Assistance,
please call **1-800-442-1902 (In Canada: 1-800-387-0369)**
(In Toronto Area only: 1-905-3061093)

Thank you for selecting American-Standard...the benchmark of fine quality for over 100 years. To ensure that your installation proceeds smoothly--please read these instructions carefully before you begin.

UNPACKING

All American Standard Faucets Are Water Tested At Our Factory. Some Residual Water May Remain In The Faucet During Shipping.

1. Remove the fitting and loose items from the carton. The illustration below shows the fitting and all loose items after they have been removed from the carton. Some items may be packaged partially assembled to other items.

- | | |
|---------------------------------------|---|
| 1. Selectronic Spout Assembly | 6. Circuit board |
| 2. Mounting Kit | 7. 4" Deck plate (optional must be ordered separately) |
| 3. Electrical Enclosure | 8. 8" Deck plate (optional must be ordered separately) |
| 4. Supply Hose | 9. Mixing Valve (optional must be ordered separately) |
| 5a. DC Power Supply (for 6055 series) | 10. Installation Instructions |
| 5b. AC Power Supply (for 6056 series) | |

5" GN Spout

PRODUCT No.s

6055.193

6056.193

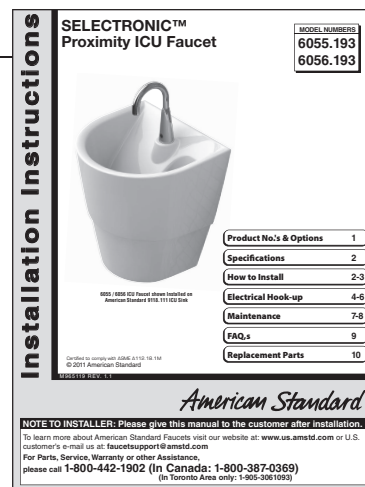
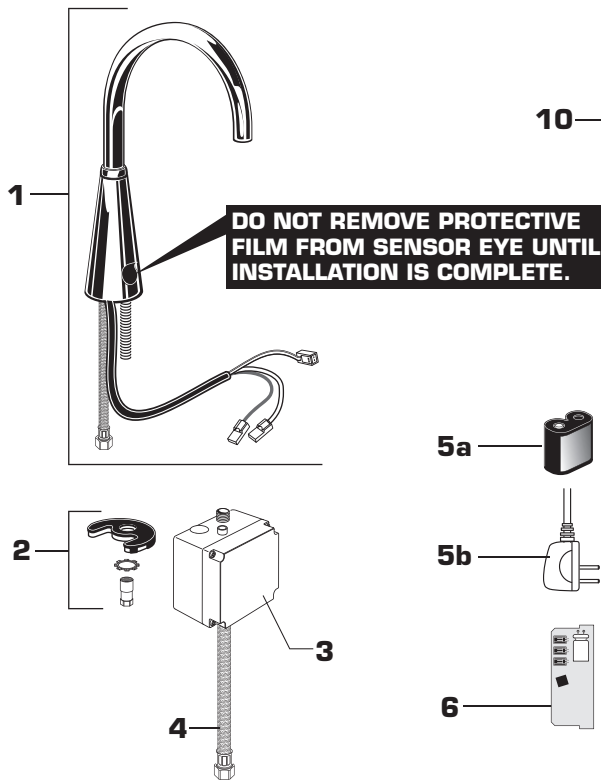

B a s e P r o d u c t

Deck Plate

Mixing Valve

605P400

605P800

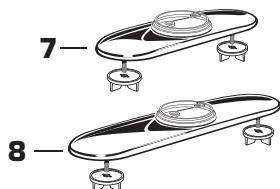

605XTMV

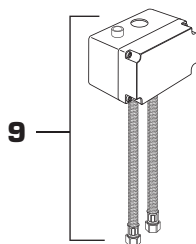

How to order the Selectronic Product
1. Choose Power Supply
2. Choose Desired Spout

Base Product



Deck Plate (optional)



Mixing Valve (optional)

- Single Hole Sink
- Single Inlet

- 1 and 3 Hole Sinks
- Single Inlet

- 1 and 3 Hole Sinks
- Hot and Cold Inlets

Roughing-in Dimensions

GENERAL DESCRIPTION:

Electronic faucet with proximity operation. Vandal resistant solid brass construction single post mounting. Operates on DC (battery) or AC permanent power. In-line strainer for solenoid is integral. Single inlet 3/8 compression, built-in checks, and flexible stainless steel 16-1/4" reach inlet hose for spout connection.

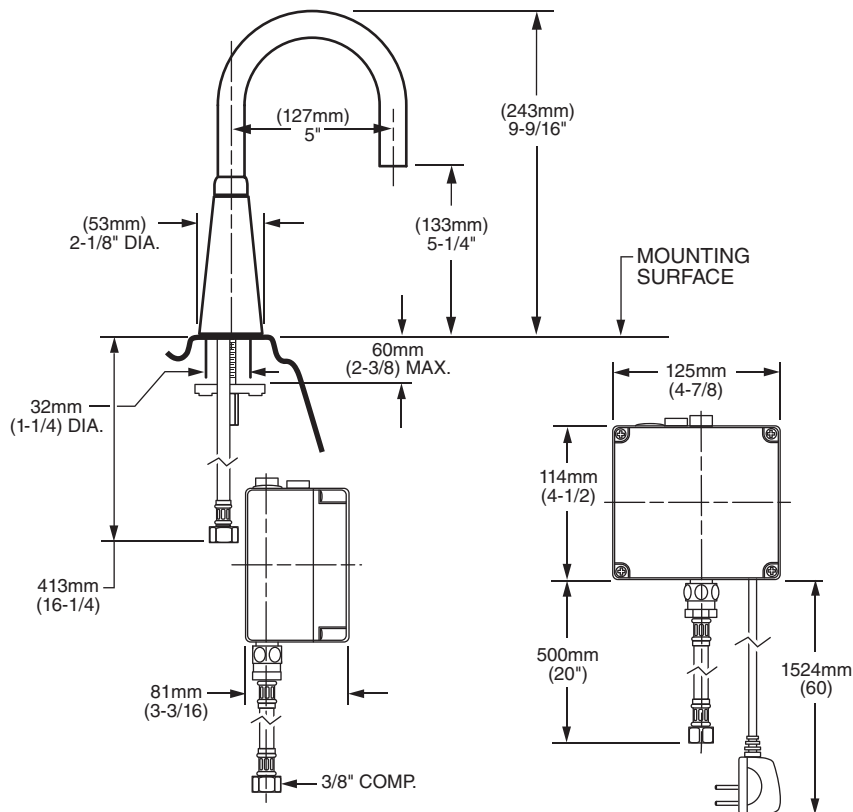

RECOMMENDED TOOLS

- 1 Channel Locks
- 2 Adjustable Wrench
- 3 Plumbers' Putty or Caulking
- 4 Phillips Screwdriver
- 5 Flat Blade Screwdriver
- 6 Electric Drill & 1/4" Drill Bit
- 7 Tape Measure

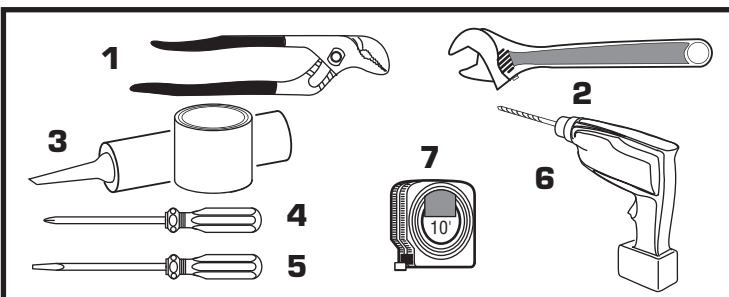

INSTALLATION

1 INSTALL SPOUT ASSEMBLY; Fig. 1

CAUTION Turn off hot and cold water supplies before beginning

1. Insert WIRES (1), FLEX HOSE (2) and SPOUT SHANK (3) through center hole of mounting surface. Fig. 1.

2. Assemble "C" WASHER (4), STAR WASHER (5) and LOCKNUT (6) onto threads of SPOUT SHANK (3) from underside of mounting surface. Fig. 1a.

3. Align FAUCET and tighten LOCKNUT (6). Fig. 1a.

Note: 4" and 8" Deck Plates are available for other installations, see page one for information.

Fig. 1

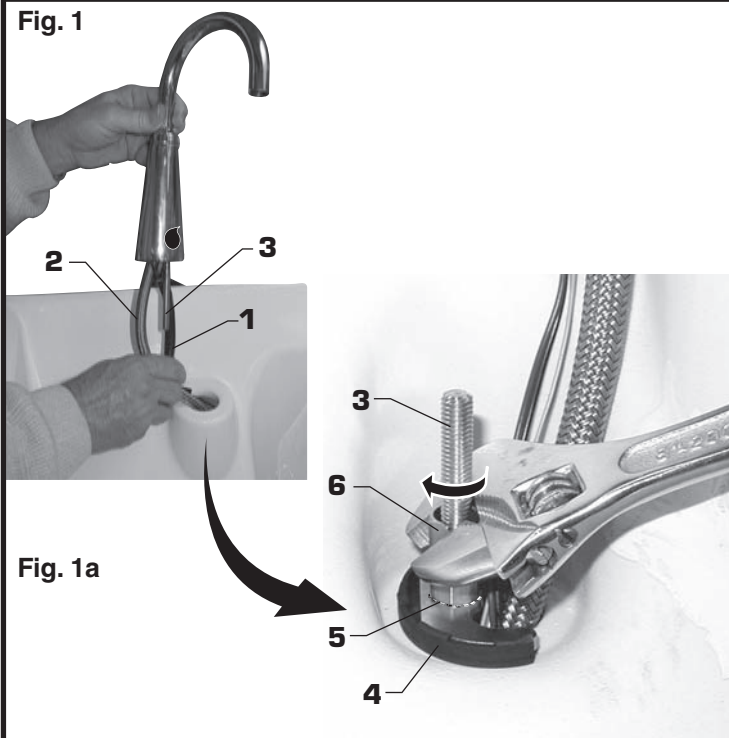

Fig. 1a

2 MOUNT ENCLOSURE; Fig. 2

NOTE. The illustration shows the ICU FAUCET mounted on the American Standard ICU Sink. Faucet can be installed on almost any sink or countertop. For Faucet installation on the American Standard ICU Sink, see instruction sheet No. 7301793-100 (ICU Sink System) supplied with Sink for more detailed information.

1. For installation on ICU Sink mount ENCLOSURE (1) on MOUNTING BRACKET (2) with SCREWS (3).

2. For all other sinks or countertops determine location of ENCLOSURE (1). It must be located within the 14" (356mm) by 21" (533mm) shaded area shown in **Figure 2** in order for electrical connections from the spout assembly to be completed.

NOTE: ENCLOSURE SUPPLY HOSE is 20". Distance between wall supply and ENCLOSURE (1) must be taken into consideration.

3. Remove 4 screws from COVER (6) and pull off COVER (6). Hold the ENCLOSURE (1) in desired location and mark the four mounting hole locations as shown. **Fig. 2.**

4. The ENCLOSURE (1) works best if secured to a wall stud or cross brace within the wall, using the SCREWS (4) supplied. If the ENCLOSURE (1) is to be installed on a tile or plaster wall the ANCHORS (5) and SCREWS (4) should be used. **Fig. 2.**

5. For installations on drywall or tiled walls; use ANCHORS (5) and SCREWS (4) for securing ENCLOSURE (1) to finished wall. Drill four 1/4" dia. holes a minimum of 1-3/4" deep. Insert the four ANCHORS (5) flush with face of the finished wall. Align the ENCLOSURE (1) and install the MOUNTING SCREWS (4). Tighten to secure ENCLOSURE (1) to mounting surface.

3 CONNECT SPOUT HOSE TO ENCLOSURE; Fig. 3

1. Connect SUPPLY NUT (1) from spout assembly to nipple on top of ENCLOSURE (2). Tighten with adjustable wrench to make a water tight connection. **Fig. 3.**

4 CONNECT WATER SUPPLY TO ENCLOSURE AND WALL SUPPLY; Fig. 4

NOTE; If using the optional Mixing Valve See Sheet #M968808 for installation instructions.

1. Insert FIBER WASHER (4) into SUPPLY NUT (1) on ENCLOSURE (2).

2. Connect SUPPLY NUT (1) on ENCLOSURE (2) to FLEXIBLE SUPPLY HOSE (3). Tighten to make a water tight connection. Use two wrenches to tighten if necessary. **Fig. 4.**

3. Connect FLEXIBLE SUPPLY (3) directly to wall supply. Connection on FLEXIBLE SUPPLY (3) is 3/8" compression. Use adjustable wrench to tighten connection. Do not over tighten. **Fig. 4a.**

Note: FLEXIBLE SUPPLY (3) measures 20" from the bottom of the ENCLOSURE (1) base. If additional supply length is required, installer must purchase parts separately. **Important:** If FLEXIBLE SUPPLY (3) is too long, loop to avoid kinking.

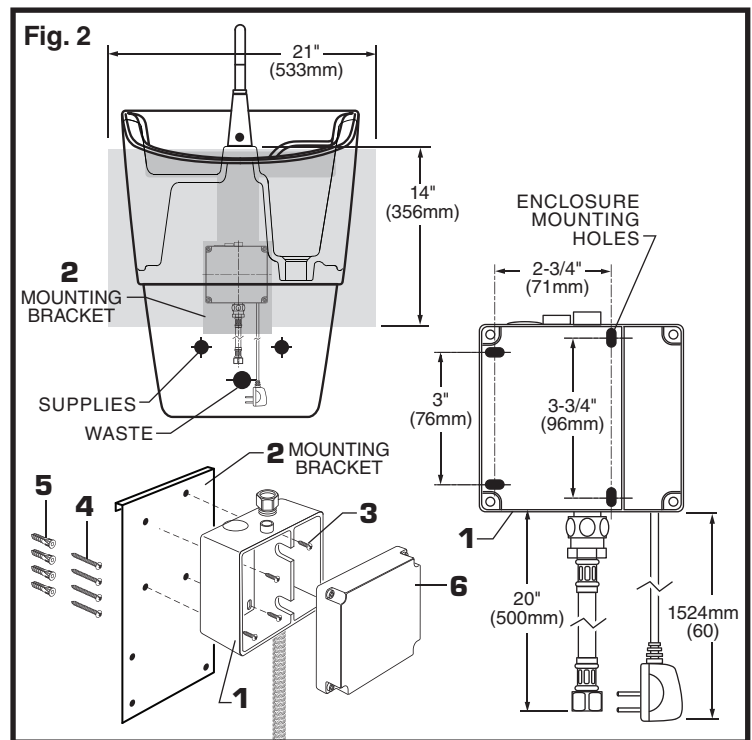

NOTE: If using Mixing Valve (optional) See Sheet #M968808 for installation instructions.

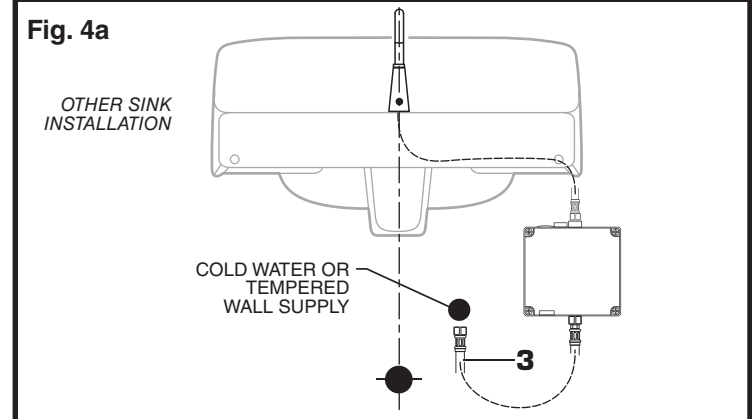
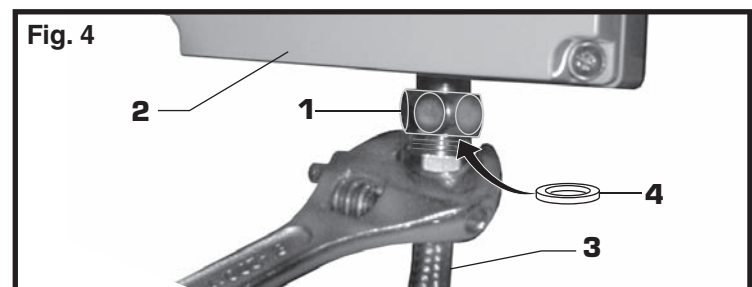
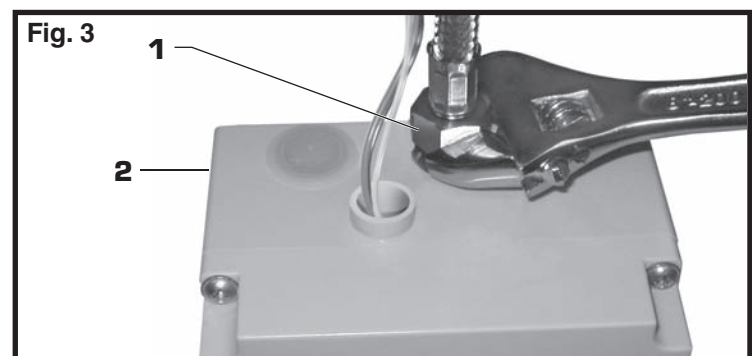

ELECTRICAL INSTALLATION

1 DC VERSION (BATTERY); Fig. 1

1. Remove ENCLOSURE COVER (1). Fig. 1.
2. Feed the WIRE CONNECTORS (2) through the top of ENCLOSURE (5). Fig. 1a.
3. Remove GROMMET (4) from ENCLOSURE (5). Fig. 1.
4. Feed the gray SENSOR WIRE (7) through GROMMET (4), 4" from CONNECTOR. Fig. 1b & 1d
Insert gray SENSOR WIRE (7) into SPLIT PLUG (9). Push SPLIT PLUG (9) into GROMMET (4) to seal. Fig. 1d.
5. Insert GROMMET (4) back into ENCLOSURE (5). Fig. 1c.
6. Install BATTERY (11) onto DC circuit board. Fig. 1e.
Note: For BATTERY PACK installation see "Install Battery" page 7.
7. Install CIRCUIT BOARD (3) into ENCLOSURE (5) with SENSOR WIRE (7) under BOARD. Fig. 1c.
8. Insert SENSOR WIRE CONNECTOR (8) into CIRCUIT BOARD RECEPTOR (10). Fig. 1e.
9. Connect wires from SENSOR to SOLENOID VALVE (6) (Red to +, Black to -). Fig. 1c.
10. Replace ENCLOSURE COVER (1). Tighten cover screws firmly.

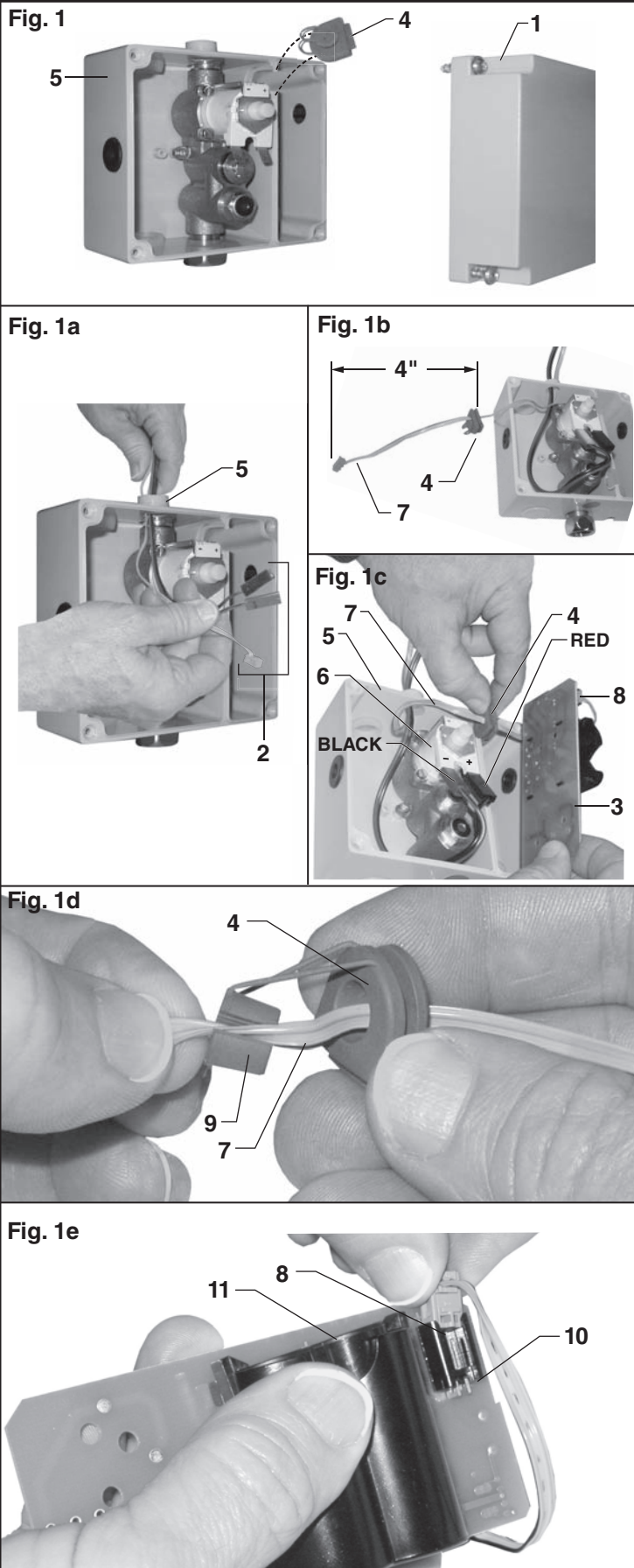

2 AC VERSION; Fig. 2

CAUTION Before opening ENCLOSURE disconnect AC power supply.

1. Remove ENCLOSURE COVER (1). **Fig. 2.**
2. Feed the WIRE CONNECTORS (2) through the top of ENCLOSURE (5). **Fig. 2a.**
3. Remove GROMMET (4) from ENCLOSURE (5). **Fig. 2.**
4. Feed the gray SENSOR WIRE (7) through GROMMET (4), 4" from CONNECTOR. **Fig. 2b.** Insert gray SENSOR WIRE (7) into SPLIT PLUG (9). Push SPLIT PLUG (9) into GROMMET (4) to seal. **Fig. 2e.**
5. Insert GROMMET (4) back into ENCLOSURE (5). **Fig. 2d.**
6. Remove SPLIT PLUG (11) from POWER SUPPLY GROMMET (12). Insert POWER CORD CONNECTOR (13) through POWER SUPPLY GROMMET (12). Insert POWER CORD (14) into SPLIT PLUG (11). Push SPLIT PLUG (11) into POWER SUPPLY GROMMET (12) to seal. **Fig. 2g.**
7. Insert POWER SUPPLY CONNECTOR (13) into RECEPTOR (15) on the CIRCUIT BOARD (3). **Fig. 2c.**
8. Install CIRCUIT BOARD (3) into ENCLOSURE (5) with SENSOR WIRE (7) under BOARD. **Fig. 2d.**
9. Insert SENSOR WIRE CONNECTOR (8) into CIRCUIT BOARD RECEPTOR (10) slot. **Fig. 2f.**
10. Connect wires from SENSOR to SOLENOID VALVE (6) (Red to +, Black to -). **Fig. 2d.**
11. Replace ENCLOSURE COVER (1). Tighten cover screws firmly.

Fig. 2

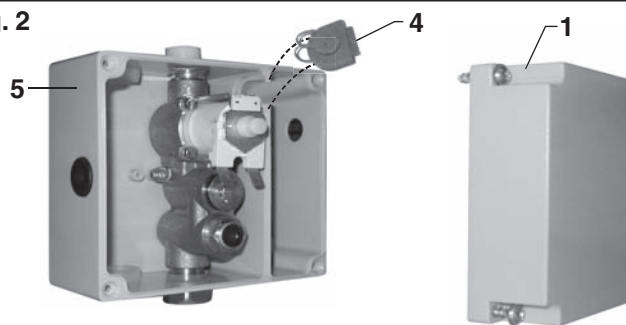

Fig. 2a

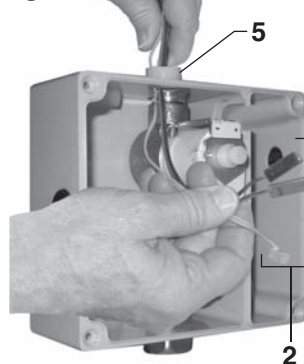

Fig. 2b

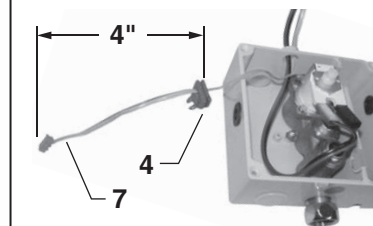

Fig. 2c

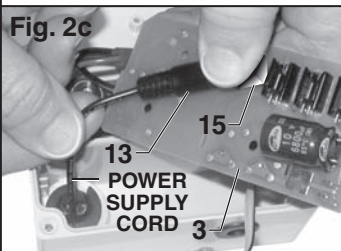

Fig. 2d

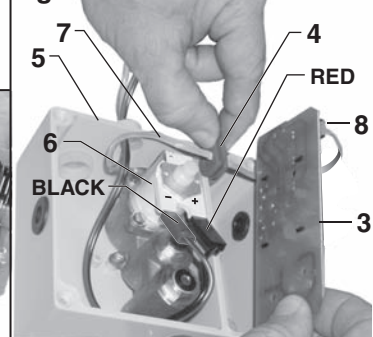

Fig. 2e

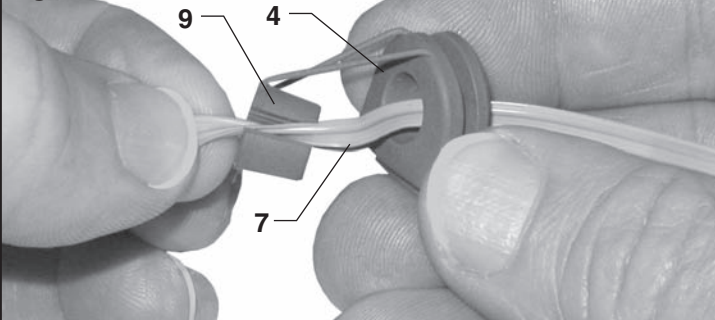

Fig. 2f

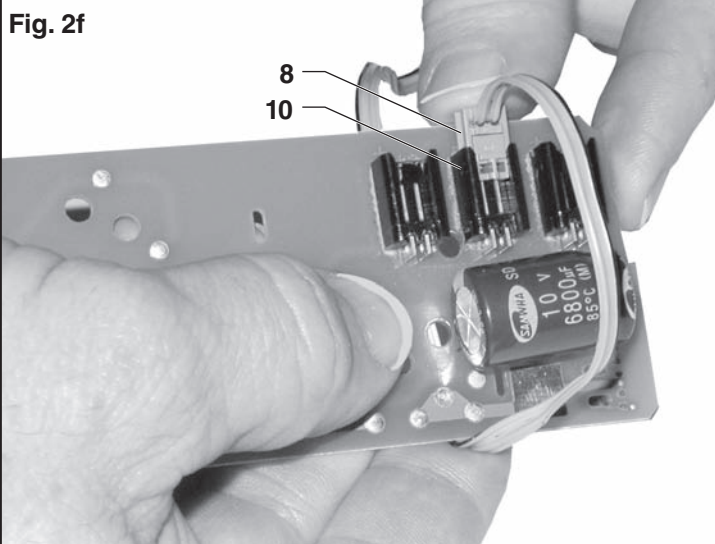
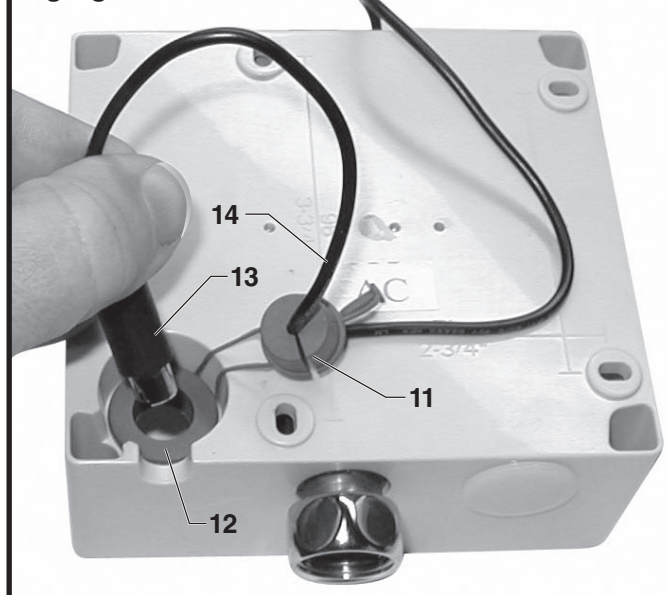

Fig. 2g



TEST INSTALLED FAUCET

TO ENSURE A LAMINAR WATER FLOW the air must be slowly purged from the spout. To do so, cover the **SENSOR (1)** while slowly opening the water supply valves. When the water flows as a solid, smooth, steady stream, uncover the **SENSOR (1)** and fully open the water supply valve. **Fig. 1.**

MAINTENANCE

1 HOW TO CHANGE SENSOR RANGE; (Factory set at 6") Fig. 2

1. Setting the Detection Zone (Distance): **Fig. 1.**

Detection Zone: 2" - 10" (50mm - 250mm)

Default: Set at Factory 6" (150mm)

Remove cover from ENCLOSURE. Disconnect **GRAY SENSOR WIRE (1)** from circuit board, then reconnect. **Fig. 2.**

2. While the **SENSOR CONTROL LED (2)** is blinking slowly, place your hand 1 - 2 in. (30-50mm) in front of the sensor. **Fig. 2a.**

3. When the LED stops blinking and stays "ON", move your hand to the desired position and hold in place until the LED begins to blink again. **Fig. 2a.**

4. Once the **SENSOR CONTROL LED (2)** begins to blink again, remove your hand from the detection zone. When the flashing stops, the detection distance is set. **Fig. 2a.**

2 HAND WASH SENSOR OPERATION;

When the Sensor detects a user, the water immediately starts to flow. Water flow will stop Two seconds after user is out of sensor range. The off delay allows the user to comfortably move his hands without the flow cycling on to off. As a precaution, a safety timer will turn off the water, after the sensor has been blocked for 59 seconds. The water will stay off until the blockage is removed from the detection zone.

3 HOW TO INSTALL AND CHANGE BATTERY; Fig. 3

1. To install New **BATTERY (1)** align and press down **BATTERY (1)** (contacts facing downward) into position until tabs lock into place.

2. To remove the **BATTERY (1)** spread the two tabs on the **HOLDER (2)** with your thumbs. The **BATTERY (1)** will release.

3. Remove the **OLD BATTERY (1)**.

4. Install **NEW BATTERY (1)** (contacts facing downward) into **HOLDER (2)** and press down into position until tabs lock into place.

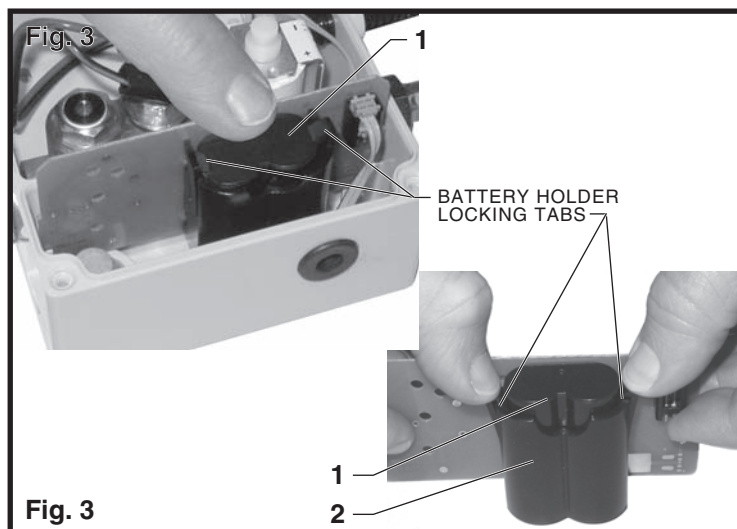
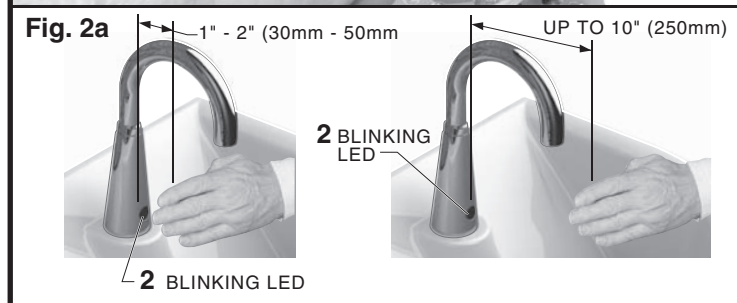
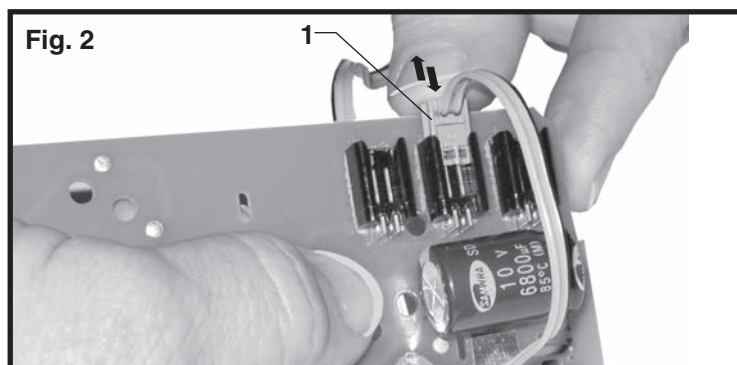
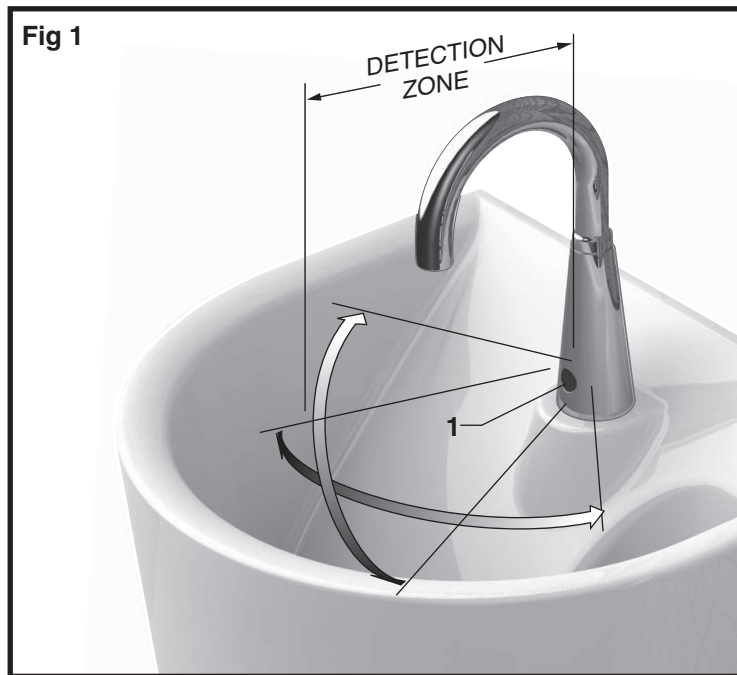

4 HOW TO CLEAN FILTER; Fig. 4

CAUTION

Before opening ENCLOSURE disconnect AC power supply.

1. Remove ENCLOSURE COVER.
2. Close SUPPLY STOP (5) with 4mm Hex wrench.
Note: Keep water flowing out of faucet while shutting off.
3. Pull off Red (1) and Black (2) CONNECTORS from SOLENOID VALVE (3).
4. Unthread STRAINER (4) using a 7/16" socket.
5. Pull out the STRAINER (4) and clean with an old toothbrush. Rinse thoroughly with water.
6. Install the STRAINER (4) back in its place and tighten with a 7/16" socket.
Caution: do not over tighten strainer.
Note: It is recommended to clean strainer every 6 months.
7. Replace ENCLOSURE COVER. Tighten cover screws firmly.

Fig.4

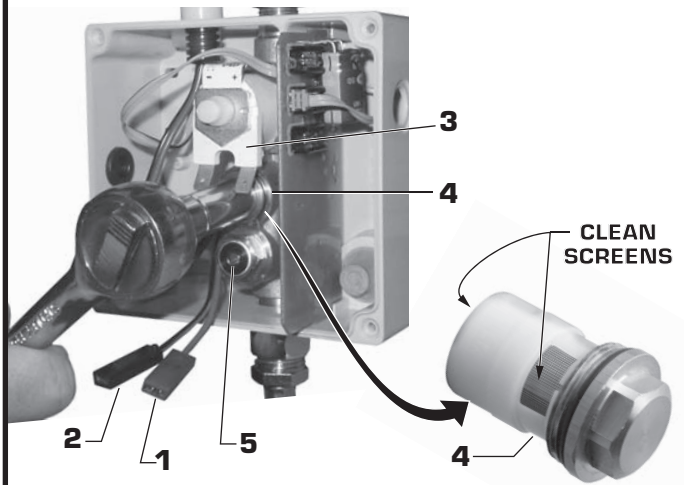

5 HOW TO CLEAN AND REMOVE THE FLOW RESTRICTOR; Fig. 5

1. Remove SET SCREW (1) with FLAT BLADE SCREWDRIVER (2). Pull off SPOUT (3) from faucet base. Fig. 5 & 5a.
2. Remove HOUSING (4) and remove FLOW RESTRICTOR (5). Fig. 5b.
3. Rinse clean FLOW RESTRICTOR (5). Reassemble and install into SPOUT BASE (6). Reassemble SPOUT (3) onto SPOUT BASE (6) and tighten SET SCREW (1). Fig. 5.

Fig.5

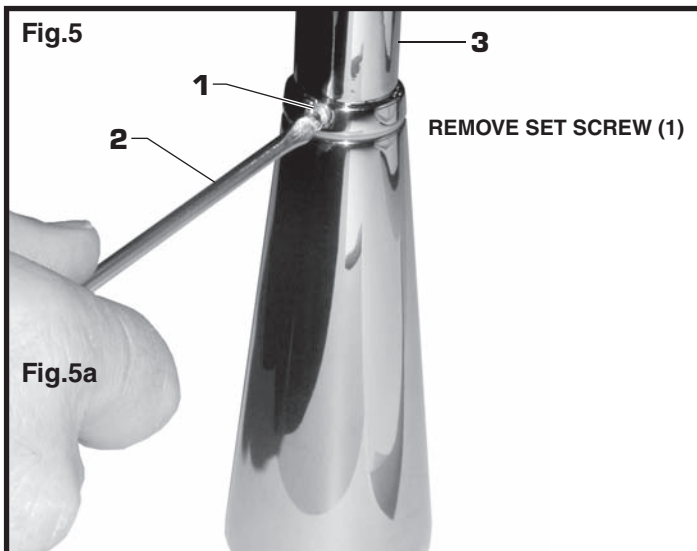

Fig.5a

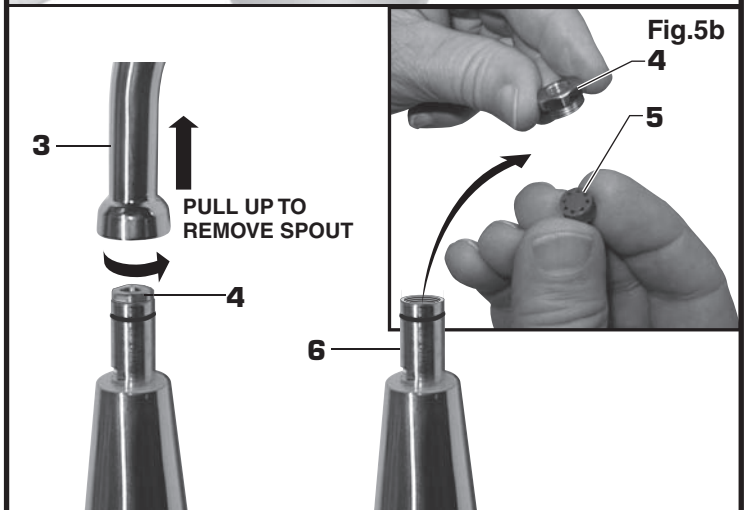

Fig.5b

6 GENERAL CLEANING; Fig. 6

1. For general cleaning use a damp, soft cloth to clean the spout and the sensor.
2. For cleaning dirt use a soft cloth with diluted dish washing detergent. Wipe the area using a wet cloth and dry using a soft cloth.

CAUTION

Do not scratch the sensor when cleaning.

Avoid using anything that may scratch the spout surface. Never use polishing power, detergent or a nylon scrub brush. They will damage the surface of the spout or Sensor.

Fig.6



FAQ'S

Q: How will I know if battery needs to be replaced?

A: Valve does not open and sensor blinks 2 times interrupted by pause for up to 7 days.

Q: Why has the flow rate of the faucet reduced significantly?

A: Check and clean aerator and strainer.

Q: There is no flow out of faucet when I'm in the sensor range?

A: Check sensor. If sensor blinks 2 times interrupted by pause, replace battery, or call 1800-442-1902.

Q: Why does the faucet operate the opposite of expected-Turns On when not in sensor range, but turns off when in sensor range?

A: Sensor wires to solenoid are reversed. Black to - & Red to + is correct.

Q: What is the normal operating pressure range?

A: Faucet will operate with supply pressures ranging from 20-80 psi.