



# HILLSIDE™

## 20" APRON FRONT KITCHEN SINK



**D20100000.415**

### FEATURES

---

- Fine fire clay construction
- Reversible series fire clay sink with smooth front apron one side and detailed transitional front apron design on opposite side
- Sink is finished on all four sides
- 3-1/2" center drain
- Bottom sink rack and strainer included
- Sink rack and strainer included

### DIMENSIONS

---

#### NOMINAL DIMENSIONS

20-1/8" x 18" x 10-1/8" (511 x 456 x 257 mm)

#### BOWL INSIDE DIMENSIONS

18-1/2" (471 mm) wide

16-1/2" (419 mm) front to back

8-1/2" (215 mm) depth

### COLORS/FINISHES

---

Canvas White (415)

### COMPONENTS

---

7301838-402.0750A Sink Rack

7301839-201-0020A Drain with Strainer

### COMPLIANCE CERTIFICATIONS

Meets or Exceeds ASME A112.19.2 / CSA B45.1

ROUGH-IN DIAGRAM SHOWN  
ON NEXT PAGE



# HILLSIDE™

## 20" APRON FRONT KITCHEN SINK

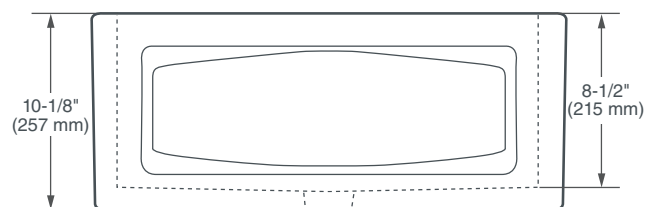
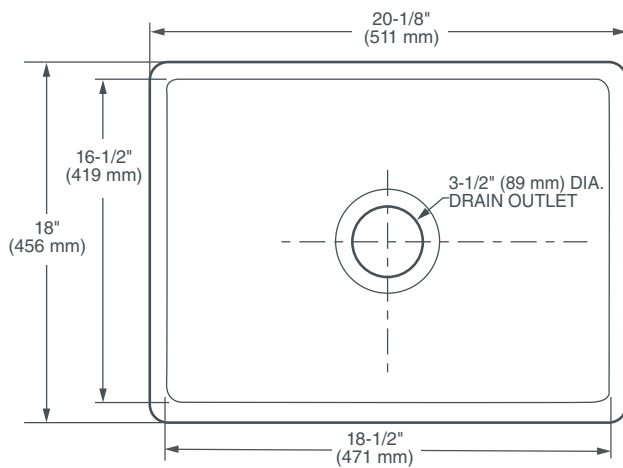

### NOTES:

Refer to installation instructions supplied with kitchen sink for undermount, countertop or above counter custom installations.

**Due to the fireclay process, dimensions may vary. Please use the actual sink that you will be installing in order to determine the cutout dimensions for your countertop.**

**CAUTION:** Sink is heavy! Installer must provide adequate reinforcement for all load-bearing supports in accordance with installation instructions supplied with kitchen sink.

Fittings not included with fixture and must be ordered separately.

### IMPORTANT:

Dimensions of fixtures are nominal and may vary within the range of tolerance established by ANSI standards. These measurements are subject to change or cancellation. No responsibility is assumed for use of superseded or voided pages.