

# Thermoflo

---

# PMP

Series 2

## Ratings

168,000 to 210,000 Btuh Input

1.20 to 1.50 GPH #2 Fuel Oil

## Packaged Multi-Position Oil Furnace



- ▣ AFUE's to 84.3%
- ▣ Multi-position installation
  - Up flow (High Boy)
  - Horizontal - left or right

### Heat exchanger

- Front flue
  - Heavy gauge stainless steel primary heat exchanger
  - Tube style aluminized steel secondary heat exchanger with removable baffles.
  - Large front access clean-out secured with studs and nuts
  - Spring-loaded observation port with test port
- ▣ Blower
    - Multi-speed direct drive
    - Slide-out blower/motor – easily removed for service
  - ▣ Cabinet
    - Appliance finish powder coat paint
    - Heavy gauge with “Seal-Tite” construction
    - Foil-faced insulation for hand-cool surface
  - ▣ Burner and controls
    - Factory-wired
    - PSC motor
    - Solid state ignitor



# Thermoflo

# RATINGS

Model	Input	Output	Firing rate	Installed nozzle	AFUE	Blower size	Blower motor hp	Maximum cooling capacity	Ship wt.	Blower CFM	
	(Btuh)	(Btuh)	(GPH)					(tons)		(pounds)	@ 0.25° WC
<b>Direct-drive units</b>											
PMP-210	168,000	142,000	1.20		84.3	GT12-10	¾	5	250	2200	2150
	189,000	158,000	1.35		83.6	GT12-10	¾	5	250	2200	2150
	210,000	175,000	1.50	✓	82.9	GT12-10	¾	5	250	2300	2150

**NOTE: Filter size required: PMP-210 - (1) 20" x 30"**

# DIMENSIONS

ALL DIMENSIONS IN INCHES

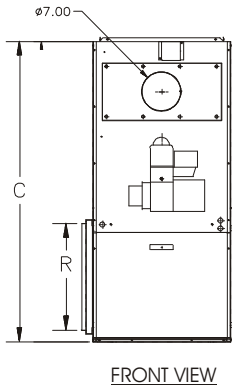
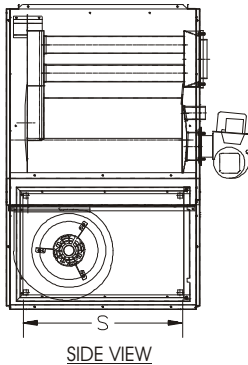
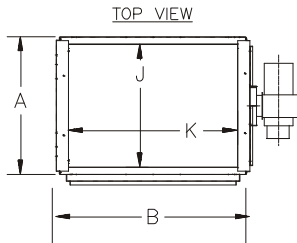

Model	Furnace casing			Warm air supply		Return air		Flue pipe diam.
	Width A	Depth B	Height C	Width J	Depth K	Width R	Depth S	
PMP-210	24	34	53	22	30	18	28	7

**Note:** PMP furnaces are approved for 1" clearance to combustible construction. For horizontal installations when installing on combustible floor, provide noncombustible spacer. Refer to installation manual for details and proper installation.

# EQUIPMENT

- Factory-assembled
- Heat exchanger pressure tested to assure leak-tight construction
- Heavy 14-gauge 430 stainless steel primary heat exchanger
- Aluminized steel secondary heat exchanger and flue collectors
- Rugged 20-gauge cabinet with powder coat finish
- Air conditioning fan center
- Controls mounted in blower compartment
- External filter rack provided
- Barometric damper provided
- High-efficiency flame retention burner (Beckett, Carlin, Riello)
- Optional two-stage fuel unit
- Dual spot limit controls

# ORDER CODE

# WARRANTY

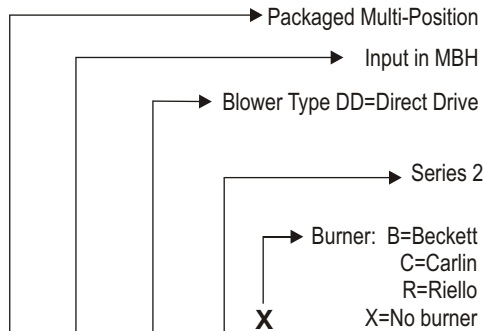

PMP - 210 - DD - S2 - B- T

### Residential Use:

- Limited lifetime warranty on heat exchanger
- 5-year limited warranty on parts
- Optional 5- or 10-year parts and labor warranty

### Commercial or Industrial Use:

- 5-year limited warranty on heat exchanger
- 3-year limited warranty on other components
- Optional 5- or 10- year parts and labor warranty



# Thermoflo

8201 West Calumet Road • Milwaukee, WI 53223

www.williamson-thermoflo.com

Form No. T-609(0903)

