

REZNOR®

Replacement Parts

Applies to: **Model UEAS,
High-Efficiency,
Low-Static Unit Heater**

IMPORTANT

1. Always include complete heater model and serial number so that any specification change can be considered for parts replacement. It can save time and expense.
2. In keeping with our policy of continuous product improvement, we reserve the right to alter any information shown here. Specifications are subject to change without notice.
3. We reserve the right to substitute functional replacements
4. Order by P/N; not Heater Option Designation.



INDEX by page

Bird Guard	6	Venter Housing Gasket	4	Top Panel	7
Bird Screen	6	Flue Wrapper Gaskets	4	Vent Panel	7
Circuit Board	3	Top/Bottom Header Gaskets	6	Pressure Switch	3
Bottom Pan	7	Hanger Kit	7	4" PVC Cap	6
Burner and Components	5	Primary Heat Exchanger	6	Rain Collar	6
Burner Body	5	Secondary Heat Exchanger	6	Rating Plate	2
Cabinet Parts	7	Heat Exchangers	6	Time Delay Relay	3
Capacitor	3	High Temperature Limit Switch	3	Ring Guard	6
Combustion Air Inlet	6	Isolator	5	Silicone Sealing Ring	6
Concentric Adapter Box	6	Horizontal Vent/Combustion Air Terminal Kit	6	Serial No.	2
Conversion Kits (Nat to LP)	5	Vertical Vent/Combustion Air Terminal Kit	6	Shaft Protector	4
Disconnect Switch	3	Logo	7	Spacers	6
Door	7	Louvers	7	Static Pressure Tap	4
Door Switch	3	Vertical Louvers	8	Swivel Connector	7
DSI Integrated Control Module	3	Louver Spring	7	Terminal Board	3
Electrical Components - Location	3	Fan Motor	5	Thermostats	8
Electrode	5	Venter Motor	4	Transformer	3
Fan and Motor Components	5	Motor Plate	4	Manual Shutoff Valve	5
Fan Blade	5	Downturn Nozzles	8	Vent / Combustion Air Component	6
Fan Guard	5	Orifice	5	Venter Components	4
Flame Sensor	5	Paint	7	Venter Housing	4
Flue Wrapper	4	Access Panel	7	Venter Motor and Wheel Assembly	4
Collection Box Gasket	6	Fan Panel	7	Venter Wheel	4
Motor Plate Gasket	4	Left Panel	7	Vent Pipe Cover	7
Secondary Heat Exchanger Header Gasket	6	Front Panel	7	Vent Temperature Limit Switch	3

References

Printed Forms	Form	P/N
Installation/Operation/Maintenance Manual	I-UEAS	221232
Replacement Valves	P-VALVES	
Website: www.RezSpec.com (Downloadable files of all printed forms are on the Website)		

Rating Plate and Serial No.

Serial No. Decoding

Serial No. Sample: **BGG 79 Z7 N 00000**

Elements of No.: **1 | 2 | 3 | 4 | 5**

Key: 1 = Date of Manufacture Code (See table below.)
 2 = Ignition Code (See Form P-Valves.)
 3 = Valve Code (See Form P-Valves.)
 4 = Type of Gas (N = Natural; L = Propane)
 5 = Consecutive number

Prefix to Serial No. **Prefix Key:** E = E3 (409) Stainless Steel Heat Exchanger

Serial No. Date of Manufacture

Year	Jan	Feb	Mar	Apr	May	June	July	Aug	Sept	Oct	Nov	Dec
2007	BGA	BGB	BGC	BGD	BGE	BGF	BGG	BGH	BGI	BGJ	BGK	BGL
2008	BHA	BHB	BHC	BHD	BHE	BHF	BHG	BHH	BHI	BHJ	BHK	BHL
2009	BIA	BIB	BIC	BID	BIE	BIF	BIG	BIH	BII	BIJ	BIK	BIL
2010	BJA	BJB	BJC	BJD	BJE	BJF	BJG	BJH	BJI	BJJ	BJK	BJL
2011	BKA	BKB	BKC	BKD	BKE	BKF	BKG	BKH	BKI	BKJ	BKK	BKL
2012	BLA	BLB	BLC	BLD	BLE	BLF	BLG	BLH	BLI	BLJ	BLK	BLL
2013	BMA	BMB	BMC	BMD	BME	BMF	BMG	BMH	BMI	BMJ	BMK	BML
2014	BNA	BNB	BNC	BND	BNE	BNF	BNG	BNH	BNI	BNJ	BNK	BNL
2015	BOA	BOB	BOC	BOD	BOE	BOF	BOG	BOH	BOI	BOJ	BOK	BOL
2016	BPA	BPB	BPC	BPD	BPE	BPF	BPG	BPH	BPI	BPJ	BPK	BPL
2017	BQA	BQB	BQC	BQD	BQE	BQF	BQG	BQH	BQI	BQJ	BQK	BQL
2018	BRA	BRB	BRC	BRD	BRE	BRF	BRG	BRH	BRI	BRJ	BRK	BRL
2019	BSA	BSB	BSC	BSD	BSE	BSF	BSG	BSH	BSI	BSJ	BSK	BSL
2020	BTA	BTB	BTC	BDT	BTE	BTG	BTH	BTI	BTJ	BTK	BTL	

Sample of Model UEAS Rating Plate

REZNOR
MERCER, PA. USA 16137

MADE IN MEXICO
SEPARATED COMBUSTION SYSTEM UNIT HEATER
CATEGORY IV
 ANSI Z83.8-2006 CSA 2.6-2006 UNIT HEATER
MODEL [B] [C]
SERIAL NO.
 [D] VOLTS [D] PH [D] HZ. MAXIMUM TOTAL INPUT [D] AMPS
 TYPE OF GAS: [E]
 FOR USE AT 0-2000 FEET, 0-610 METERS OF ALTITUDE.
 ORIFICE SIZE [F] DRILL

SEA LEVEL

NORMAL INPUT [J] BTU/HR
 THERMAL OUTPUT CAPACITY [L] BTU/HR
 MINIMUM INPUT [M] BTU/HR
 NORMAL MANIFOLD PRESSURE [G] IN.W.C.
 MIN. PERMISSIBLE GAS SUPPLY PRESSURE
 FOR PURPOSE OF INPUT ADJUSTMENT. [H] IN.W.C.

CLEARANCES TO COMBUSTIBLE CONSTRUCTION: TOP-4", FLUE CONNECTION-0", CONTROL SIDE-18", OPP. SIDE-2", BOTTOM-1", FRONT-36"
 FOR ALTERNATE INSTALLATIONS USE THE LATEST EDITIONS OF THE APPROPRIATE STANDARD LISTED BELOW:
 FOR AIRCRAFT HANGARS USE STANDARD ANSI/NFPA 409
 FOR PARKING STRUCTURES USE STANDARD ANSI/NFPA 88A
 FOR REPAIR GARAGES USE STANDARD ANSI/NFPA 88B

THIS UNIT IS NOT FOR USE WITH DUCTS.
 THIS UNIT IS NOT FOR USE WITH FILTERS.
 CONSTRUCTION WALL THICKNESS FOR PURPOSE OF VENTING:
 1" MIN., 48" MAX.
 In the event the vent temperature limit switch causes the heater to shut off. Determine and correct the cause. Failure to do so could result in personal injury or death. To reset, depress the button on the sensor located on the side of the venter housing.

Rating Plate Key:

- B = Model No.**
- C = Date of Manufacture (Month & Year)**
- D = Volts; Phase; Hertz; Input Amps**
- E = Fuel Type (natural gas or propane)**
- F = Orifice Size**
- G = Normal Manifold Pressure (inches w.c.)**
- H = Minimum Gas Supply Pressure (inches w.c.)**
- J = Normal BTUH Input (sea level)**
- L = Thermal Output BTUH (sea level)**
- M = Minimum BTUH Input (sea level)**

Electrical Components - Locations and P/N's

CODE	Description	130	180	260	310
1	Disconnect Switch	101902			
2	Door Switch	217262			
3	Vent Temperature Limit Switch, Thermodisc	221158, Opens 145°F, manual reset			
4	High Temperature Limit Control	45602, 180°	85449, 200°, Yellow	45602, 180°	
5	Pressure Switch	221251, Yellow		221228, Blue	
6	Time Delay Relay	221388			
7	Venter Motor Capacitor	195643			
8	Fan Motor Capacitor	195643			
9	Transformer	175265			
10	DSI Integrated Control Module (Circuit Board)	195265			
11	Terminal Board	196813			
12	Terminal Board Gasket	196327			

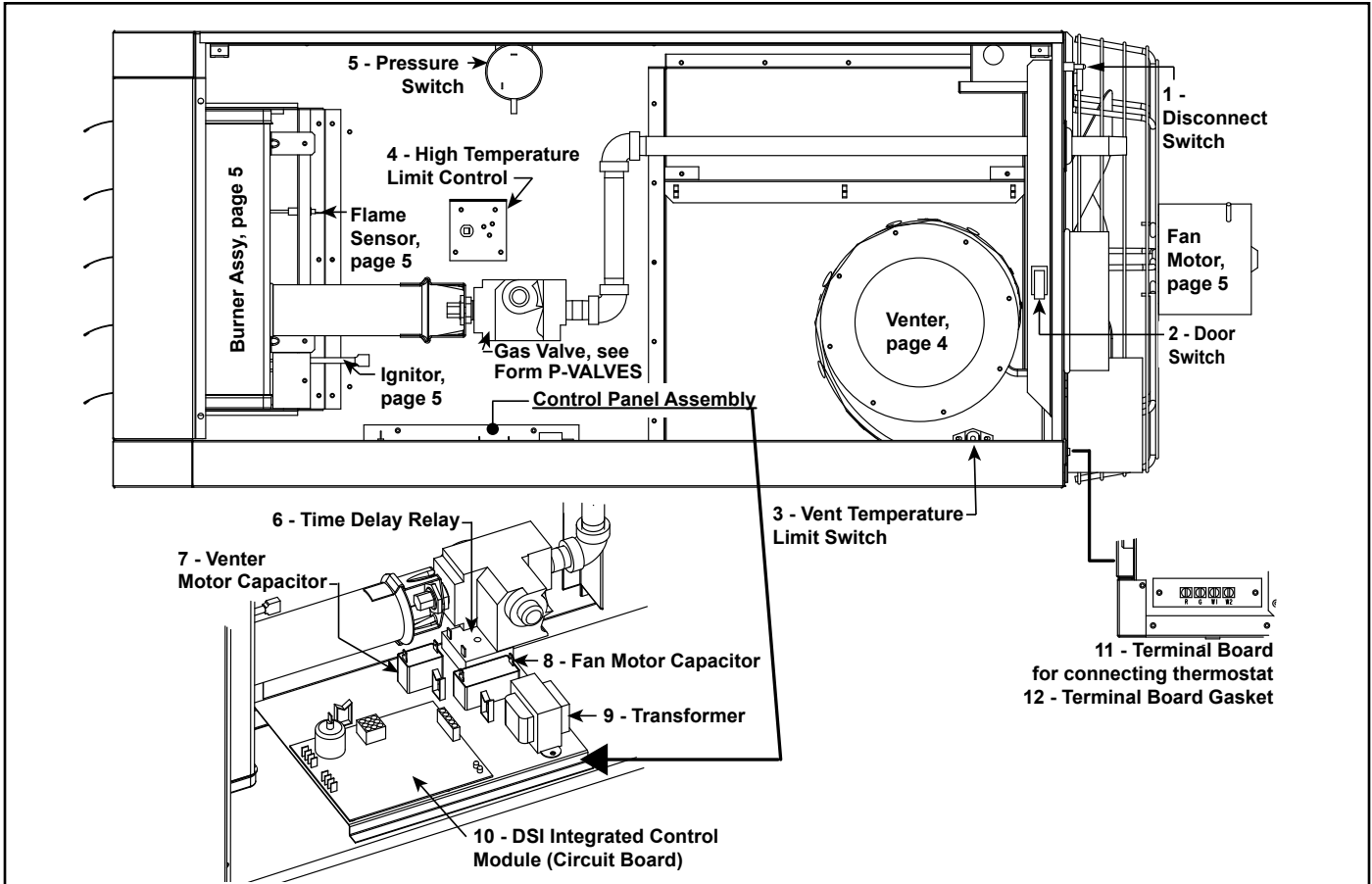

<p>CODE 1 - On/Off Disconnect Switch, P/N 101902</p> 	<p>CODE 2 - Safety Door Switch, Carling #TA22B-TLB-B, P/N 217262</p> 	<p>CODE 3 - Vent Temperature Limit Switch, Thermodisc 36T26 73DD, P/N 221158</p> 	<p>CODE 4 - High Temperature Limit Switch, See P/N by Size</p> 	<p>CODE 5 - Pressure Switch, Honeywell, See P/N by Size</p> 
<p>CODE 6 - Time Delay Relay, Airotronics, 24VAC, P/N 221388</p> 	<p>CODES 7 & 8 - Capacitor, 7.5mfd, 400VAC, P/N 195643</p> 	<p>CODE 9 - Transformer, 120/24 volts, P/N 175265</p> 	<p>CODE 10 - DSI Integrated Control Module, P/N 195265</p> 	

Flue Wrapper and Venter Components

CODE	Description	130	180	260	310
20	Flue Wrapper Side Gaskets	(2) 221198		(2) 221199	
21	Flue Wrapper Top/Bottom Gaskets	(2) 221200			
22	Flue Wrapper	220823		220824	
23	Venter Housing Gasket	221164			
24	Venter Housing Assembly (includes CODE 24A and CODE 3, Vent Temperature Limit)	221520			
24A	Static Pressure Tap	116043			
25	Venter Motor and Wheel Assembly	222648	221240		
25A	Venter Motor, A.O. Smith F48Y67A13	221159			
25B	Flat Washer	(4) 204323			
25C	Motor Plate	221162			
25D	Motor Plate Gasket	221163			
25E	Slinger (smooth side must be flush against the motor plate)	221861			
25F	Blower Wheel, Revcor B743-200HS	221172			
25G	Shaft Protector Gasket	221161			
25H	Shaft Protector	221160			
25J	Setscrew	222077			

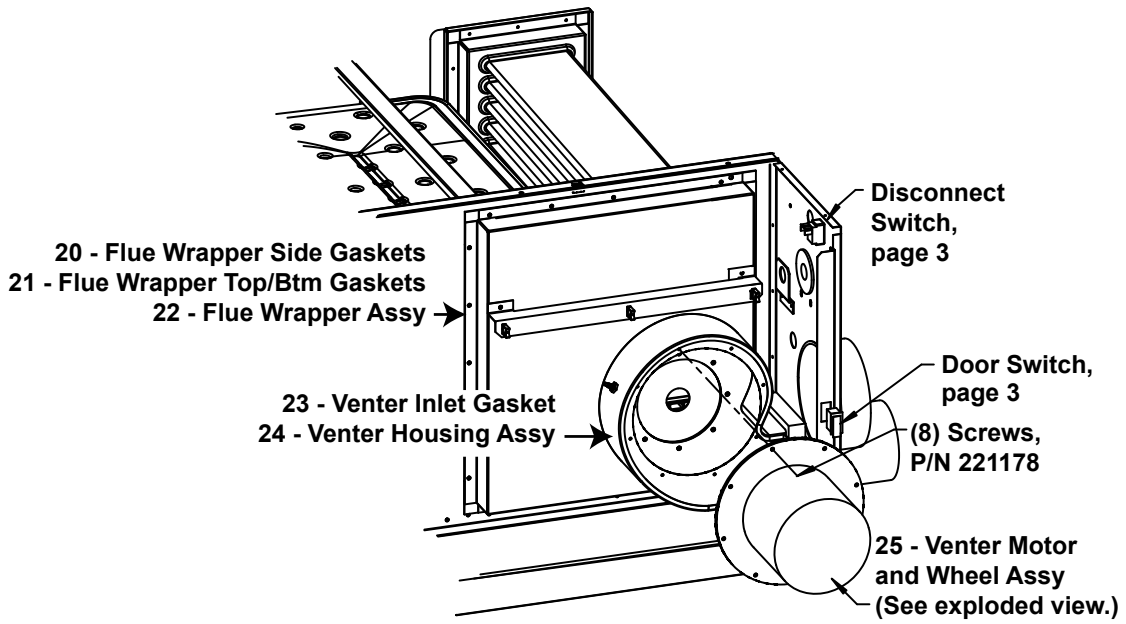

**Exploded View of
CODE 25 - Venter Motor
and Wheel Assy**

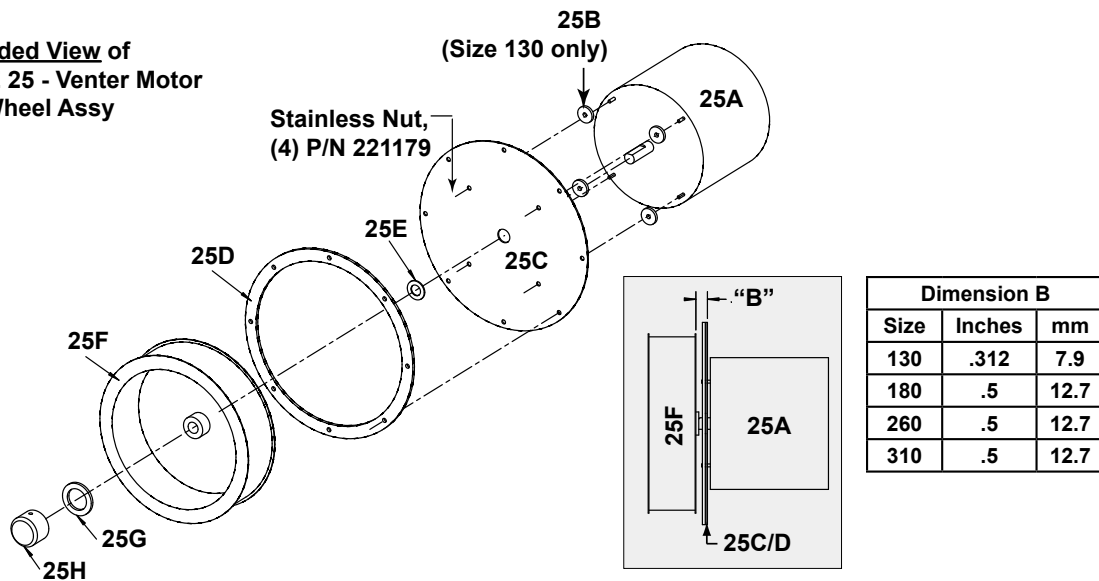

Fan and Motor Components

CODE	Description	130	180	260	310
30	Fan Motor	115V		196246	196247
		115V, AL14 (enclosed)		196824	196825
31	Fan Blade (Setscrew torque 130±10 in/lbs)	195680	195683	209121	
32	Fan Guard	170084		170086	
33	Isolator	(4) 196348			
34	Motor Spacer	N/A		204321	
35	Flat Washer	(4) 204323			
36	Nut	(4) 216942			

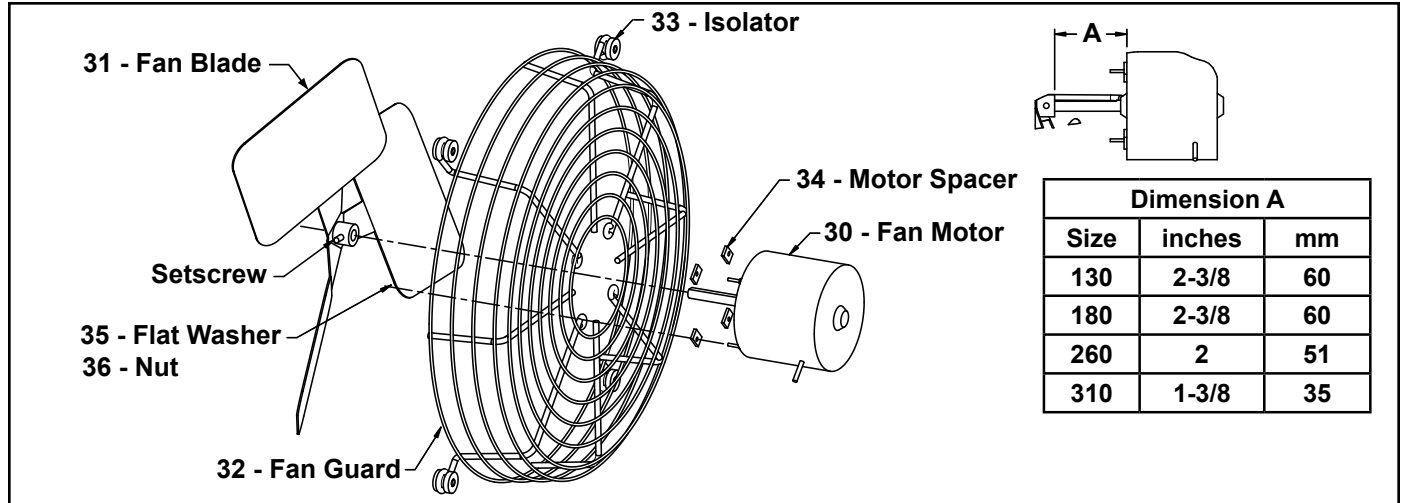

Burner and Components and Conversion Kits

CODE	Description	130	180	260	310	
40	DSI Electrode	175272				
41	Flame Sensor	195292				
42	Burner Inlet Plate	221165	221166	221167	221168	
43	Burner Body Assembly	221476	195238	195241	195243	
44	Burner Shield Assembly	195528	195529	195532	195534	
45	Burner Supports	(4) 196598				
46	Burner Baffle	(2) 197238			N/A	
47	Natural Gas Orifice	P/N	211851	221263	196894	221264
		Marking	#3	6.2MM	7.6MM	0
	Propane Orifice	P/N	120415	221265	196902	196903
		Marking	3.3MM	25	14	8
48	Pipe Nut, 1/2"	165702				
49	Natural to Propane Conversion Kit	221442	221443	221444	221445	

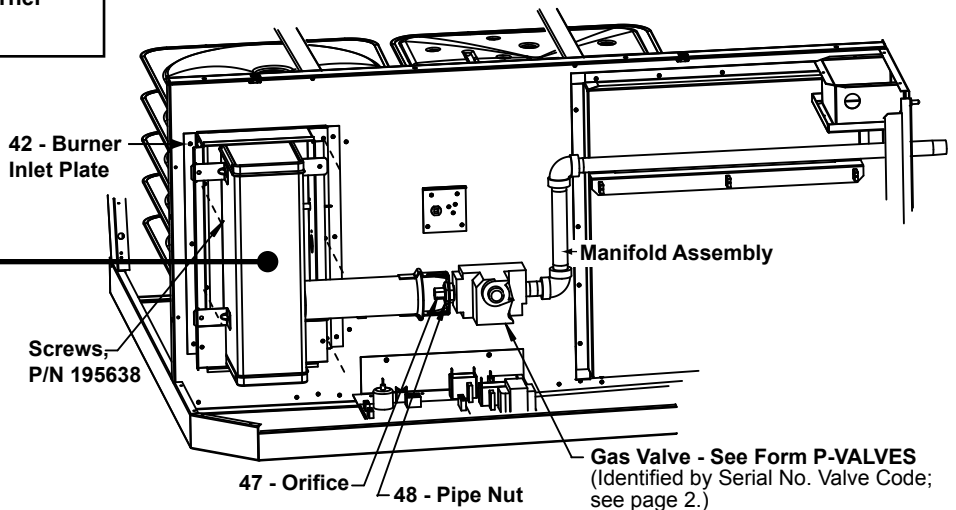
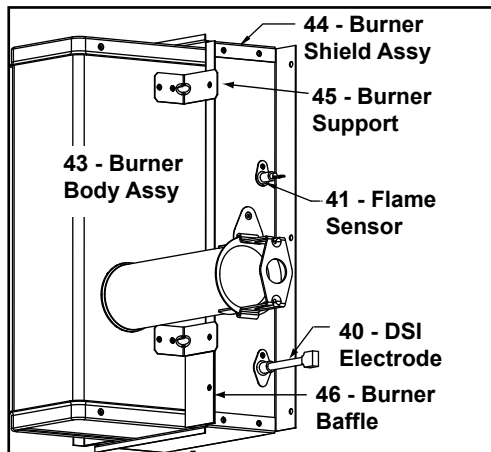

CODE 50 - Manual Shutoff Valve (Same as Option CE1)



Size	130, 180	260, 310
Option Pkg	15971	15972
Manual Shutoff Valve	196910, 1/2"	196911, 3/4"
Union	1224, 1/2"	1101, 3/4"

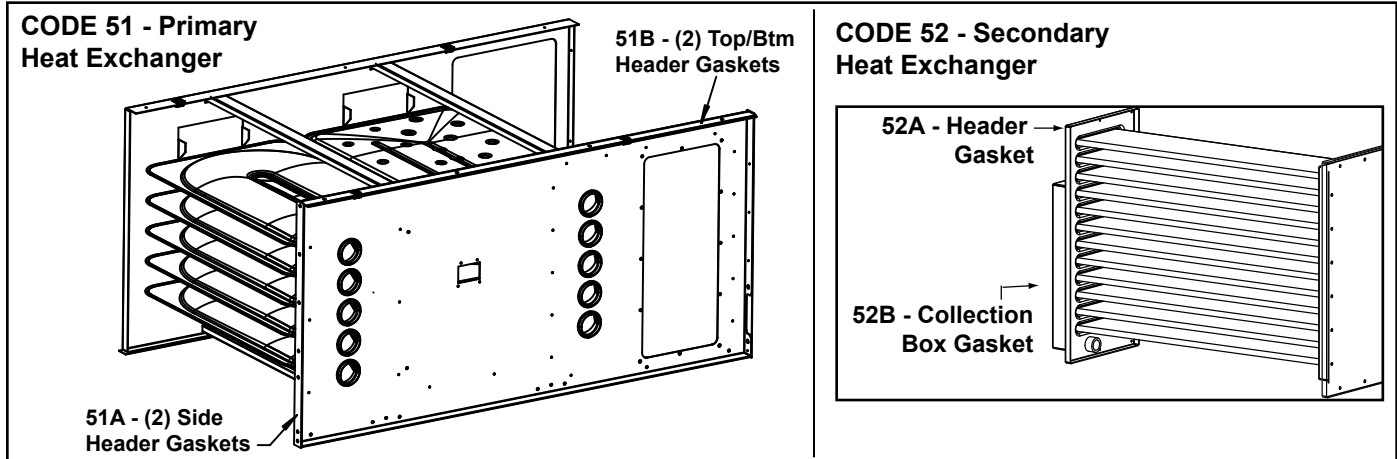

Replacement Heat Exchangers

CODE	Description	130	180	260	310	
51	Primary Heat Exchanger Assembly	Aluminized	221252	221253	221254	221255
		409 Stainless	221318	221319	221320	221321
51A	Top/Bottom Header Gaskets	(2) 221201		(2) 221202		
51B	Side Header Gaskets	(2) 221203		(2) 221204		
52	Secondary Heat Exchanger Assembly	221256	221257	221258	221259	
52A	Secondary Heat Exchanger Header Gasket	220804		220805		
52B	Collection Box Gasket	221187				

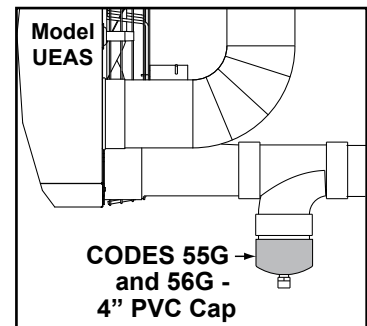
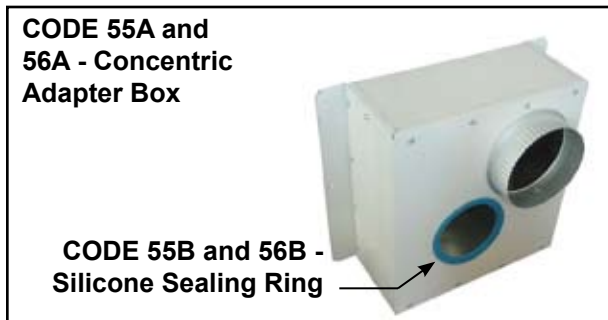

Vent / Combustion Air Components for Separated Combustion

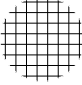

CODE 55 - Complete Horizontal Vent/Combustion Air Terminal Kit (Same as Option CC6), P/N 221247			
CODE	Qty	P/N	Description
55A/B	1	221069	Concentric Adapter Box with Silicone Sealing Ring (above)
55C	1	221089	Bird Screen for Exhaust Outlet 
55D	1	124940	Ring Guard for Air Inlet 
55E	4	37661	#10-16x1/2" lg Screws to attach the inlet air guard
55F	4	221186	Spacers for inlet air guard
55G	1	221091	4" PVC Cap for Vent Condensate Drain Connection (above)

CODE 56 - Complete Vertical Vent/Combustion Air Kit (Same as Option CC2), P/N 221248			
CODE	Qty	P/N	Description
56A/B	1	221069	Concentric Adapter Box with Silicone Sealing Ring (above)
56C	1	221215	Bird Guard 
56D	2	37661	Screws for Bird Guard. #10x1/2" self-drilling
56E	1	221250	Combustion Air Inlet 
56F	1	221185	Rain Collar 
56G	1	221091	4" PVC Cap for Vent Condensate Drain Connection (above)

Cabinet Parts

CODE	Description	130	180	260	310
60	Door Assembly	220833		220834	
61	Access Panel (above the door)	N/A		220822	
62	Vent Panel Assy	220825		220826	
63	Vent Pipe Cover Assembly	221519			
64	Fan Panel	220759		220760	
65	Front Panel	201692		201694	
66	Left Panel	220753		220754	
67	Bottom Pan	220827		220828	
68	Louvers	(5) 195578		(10) 195578	
69	Louver Spring	(5) 195046		(10) 195046	
70	Top Panel	220755		220756	
71	T-CORE ³ Logo	(see illustration on front cover)		221183	
72	Reznor Logo			196689	196692
73	Cabinet Touchup Paint	201805, 11 oz spray can, White			
74	Horizontal Louver Paint	207432, 12 oz aerosol can, Maroon			

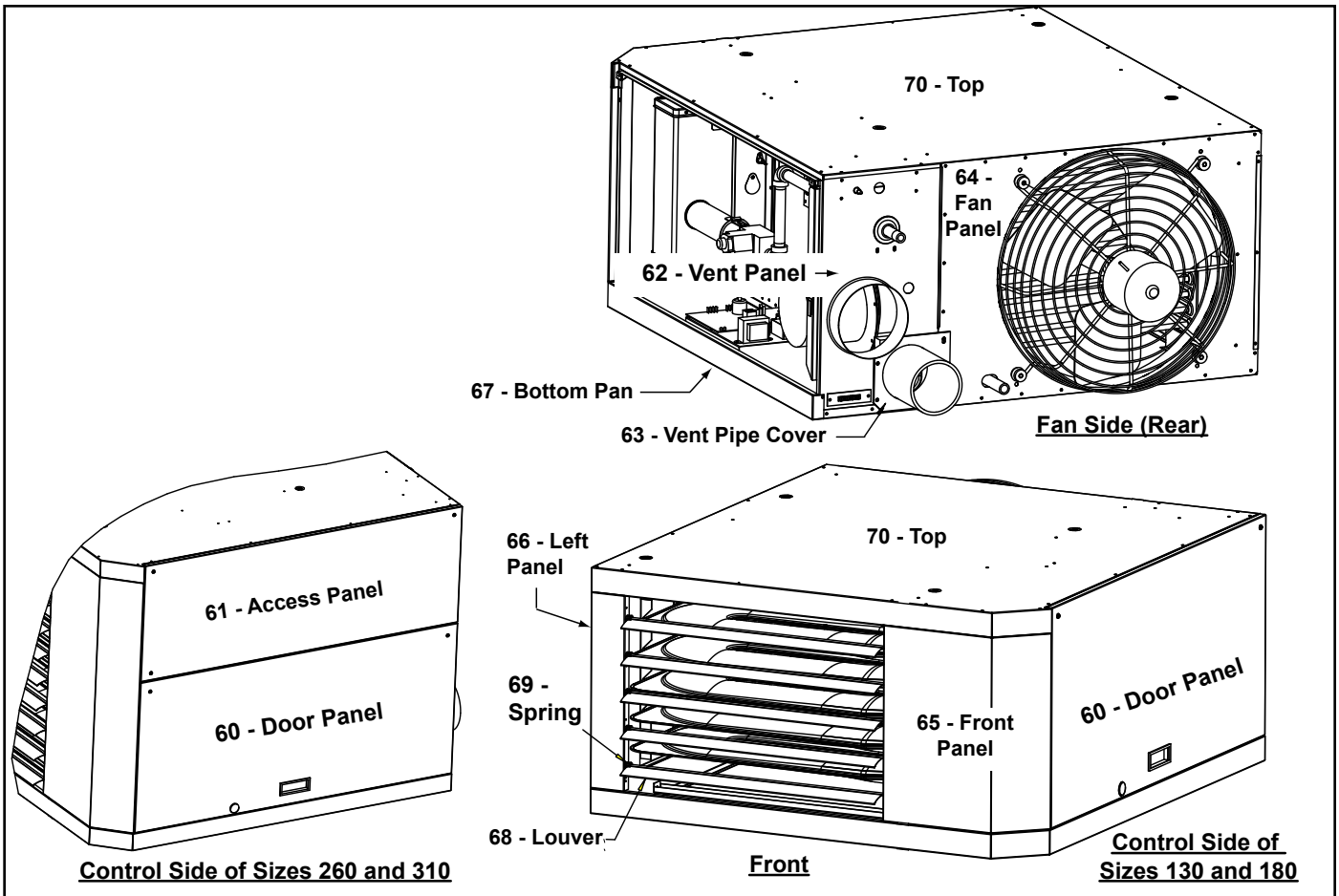

CODE 80 - Hanger Kit (Same as Option CK10)

Option CK10 - Four-point Suspension



Size	All
Option CK10 Pkg P/N	98511
Swivel Connector Assembly	(4) 17627
3/8" Lock Washer	(8) 5197
3/8" Hex Nuts	(4) 1438

CODE 90 - Vertical Louvers (Same as Option CD1)

Size	130, 180	260, 310
Option Pkg P/N	201199	201201
<i>Components</i>		
Louver Frame Top & Bottom	(2) 197189	(2) 197190
Louver Frame Sides	(2) 197186	(2) 197188
Screws, #8-18 x 3/8" long, AB point, slotted indented serrated hex washer head	(20) 195638	
Louvers	(8) 196572	(8) 195315
Compression Springs	(8) 195046	

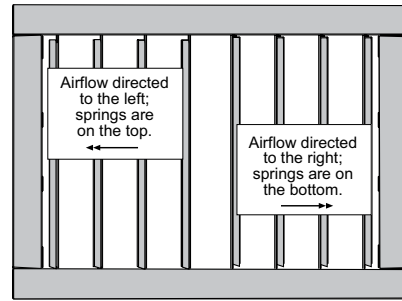



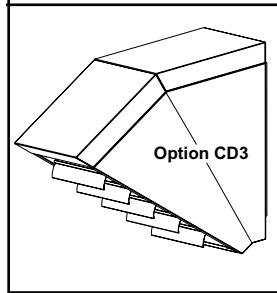
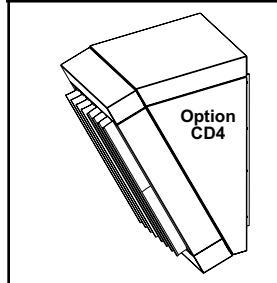
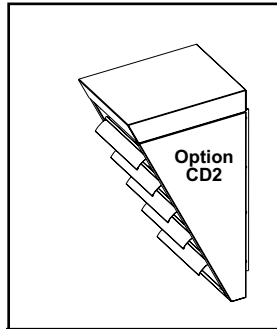

CODE 91 - Downturn Nozzles (Same as Option CD2, CD3, and CD4)



Size	130, 180	260,310
Option CD2 Pkg P/N	201202	201204
Nozzle Section Right Side	(1) 197173	(1) 197175
Nozzle Section Left Side	(1) 197176	(1) 197178
Nozzle Section Top	(1) 197170	(1) 197172
Nozzle Bracket	(2) 201708	(2) 201709
Nozzle Section Bottom	(1) 196997	(1) 197179
Screws, #8-18 x 3/8" long AB point, slotted indented serrated hex washer head	(16) 195638	
Option CD4 Pkg P/N	201208	201210
Same components as Option CD2 above PLUS		
Vertical Louver	(8) 196572	(8) 195315
Compression Spring	(8) 195046	
Louver Top and Bottom Support	(2) 197189	(2) 197190
Louver Frame Side	(2) 197186	(2) 197188
Screws, #8-18 x 3/8" long AB point, slotted indented serrated hex washer head	(28) 195638	
Option CD3 Pkg P/N	201205	201207
Nozzle Section Right Side	(2) 197173	(2) 197175
Nozzle Section Left Side	(2) 197176	(2) 197178
Nozzle Section Top	(2) 197170	(2) 197172
Nozzle Bracket	(2) 201708	(2) 201709
Nozzle Section Bottom	(2) 196997	(2) 197179
Screws, #8-18 x 3/8" long AB point, slotted indented serrated hex washer head	(30) 195638	

CODE 92 - Thermostats and Accessories (Same as Option CL1, CL2, CL3, and CM1)

<p>Option CL1, 1-stage, 40-80°F Thermostat, P/N 91919</p> <p>-----</p> <p>(Alternate for Option CL1, 1-Stage Thermostat, M/H T822D2717, 24 volt, P/N 221039 (Available fall 2007; check with your distributor.)</p>	 	<p>Option CL3, 1-Stage Thermostat, M/H T87K10075, 24V, 40-90°F, P/N 220631 (replaces P/N 39581)</p> 
<p>Option CL2, 1-stage, 40-80°F, P/N 194236 [includes thermostat, P/N 91919 (CL1 above), with auto/on subbase, P/N 91920 (right)]</p>		<p>P/N 91926, Clear Plastic, Locking, Thermostat Cover, W/R 29-0143, Mounts horizontal or vertical</p> 

www.RezSpec.com; (800) 695-1901

©2007 Thomas & Betts Corporation, All rights reserved.

Trademark Note: Reznor® is registered in the United States and other countries.

8/07 Form P-UEAS