



Touchless Toilet Flush Kit K-1954

Features

- Retrofits a standard toilet to touchless flush.
- Flush is activated by a no-touch sensor mounted inside the tank.
- Powered by 4 AA batteries (included).
- Works with most canister and flapper toilets.
- Not compatible with dual-flush, top-mount flush, pressure-assist, or ballcock valve toilets.
- Simple installation taking most people less than 20 minutes.
- Trip lever hole cover included.
- Optional hand indicator decal included (indicates where the touchless module is located inside of tank).
- When batteries are low, the unit will beep five times at half-second intervals when activated to indicate it's time to replace them.

Technology

- Touchless module projects a field through the top of the tank lid that senses your hand, causing the toilet to flush.
- Touchless is compatible with a variety of water usage rates.

Recommended Products/Accessories

K-23729 Stainless steel cleaner



Codes/Standards

None Applicable

KOHLER® One-Year Limited Warranty

See website for detailed warranty information.

Available Colors/Finishes

Color tiles intended for reference only.

Color	Code	Description
-------	------	-------------

	0	White
--	---	-------



Touchless Toilet Flush Kit K-1954

Required Clearances

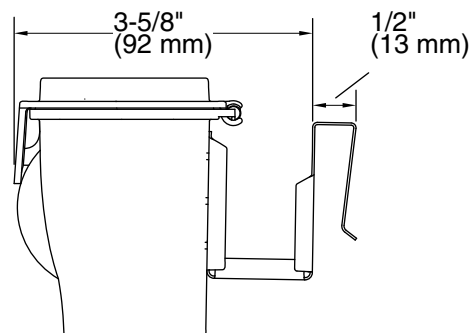
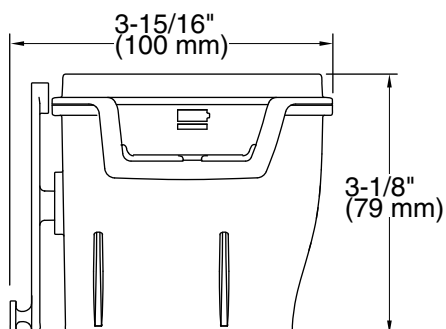
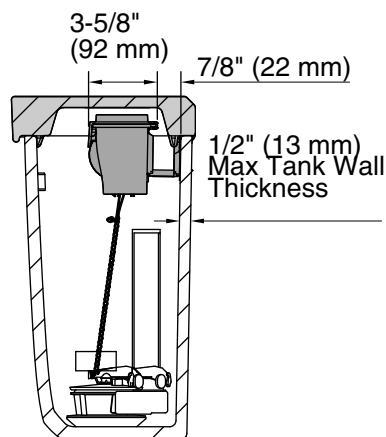
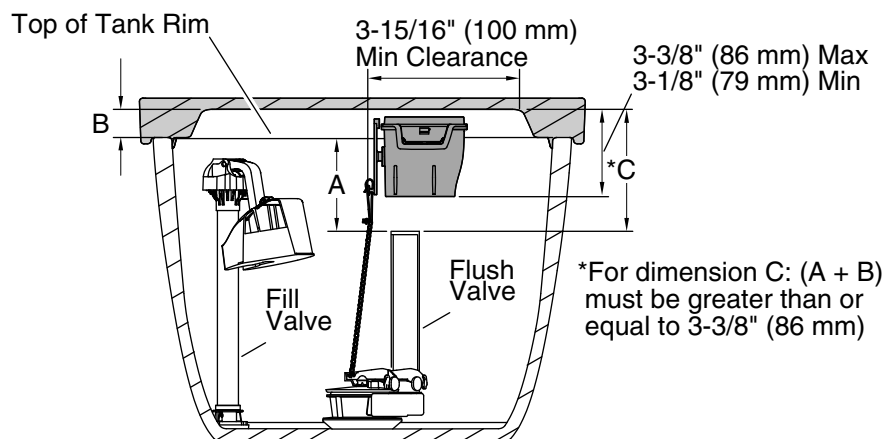

Technical Information

All product dimensions are nominal.

Material: Stainless Steel, Plastic

Notes

CAUTION: Risk of property damage: Do not use lithium ion batteries with this product. Exposing lithium ion batteries to water can result in a fire.

The touchless toilet flush kit is not compatible with the following types of toilets: dual flush, ballcock valve, top actuator, and pressure assist.

To confirm that a flapper style flush valve is compatible, verify there are adequate clearances for the tank and lid as illustrated.

To confirm that a canister style flush valve is compatible, view the compatibility list of toilets found on kohler.com, K-1954 product detail page.