

BOM			
ITEM	PART NUMBER	DESCRIPTION	QTY
1	408211	SOCKET HEAD SCREW M5 X 16MM A2 SS	4
2	408165	FLAT HEAD SCREW M6 X 20MM SOCKET A2 SS	1
3	408880	PAN HEAD SCREW M3 X 20 mm SLOTTED	2
4	419085	LOCK WASHER M3 SPLIT A2 SS	2
5	423510	DRIVE COUPLER	1
6	408237	FLAT HEAD SCREW M5 X 30MM SOCKET A2 SS	4
7	446073	BRACKET MTG	1

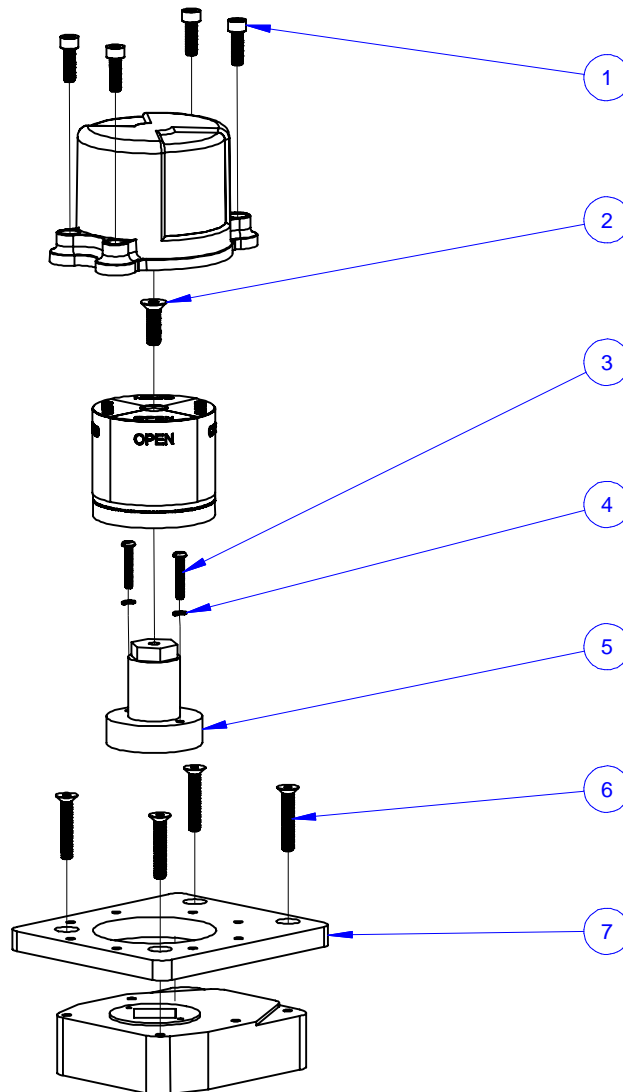

NOTE:
1) SEE BOM FOR PART # AND DESCRIPTION

REVISIONS					<div>CONFIDENTIAL</div> <div>THIS DRAWING AND ALL INFORMATION CONTAINED HEREIN IS THE PROPERTY OF AND IS SUBJECT TO CHANGE BY STONEL. DRAWING IS NOT TO BE REPRODUCED OR REVEALED TO ANY OTHER PARTY UNLESS AUTHORIZED BY STONEL.</div> <div><div>Stonel[®]</div><div>METSO AUTOMATION, FERGUS FALLS, MN U.S.A.</div></div>			
	B	13333	8-14-17	BL				
	A	4352	10-3-07	MB				
	REVISION	ECO	DATE	BY				
TOLERANCES (UNLESS OTHERWISE SPECIFIED):				DR. MB	TITLE JAMESBURY M5 & M7 SA VI MTG			
X.XXX ± .005 ANGLES ± 0° 30'				CHK. BL	SCALE 1:3.5	SHEET 1 OF 1	DRAWING NO.	REV.
X.XX ± .010 FINISH f 125 RMS				APPD. RK	SIZE A	DATE 8/14/2017	795813	B
X/X ± .015								