

Position	Count	Description
	1	<p><b>UP 10-16 A PM B5/LC</b></p>  <p style="text-align: center;">Product photo could vary from the actual product</p> <p>Product No.: <a href="#">98420222</a></p> <p>The high-efficiency Grundfos Comfort PM range is a product for domestic hotwater re-circulation with lead free drinking water suitable pump housing for single- and two-family houses powered by a high efficiency single-phase, 12-pole, permanent-magnet motor.</p> <p>Features and benefits:</p> <ul style="list-style-type: none"> <li>* Quick and simple electrical installation due to the highly reliable ALPHA plug</li> <li>* dry running detection</li> <li>* Easy-to-clean and lime-insensitive spheric rotor</li> <li>* Wearless operation due to liquid lubricated bearing</li> <li>* No leakage risk due to a static seal</li> <li>* Easy maintenance and cleaning through the easy-to-separate pump head fitting almost all competitor pump housings</li> <li>* Corrosion resistant lead free brass pump housing</li> <li>* No additional motor protection necessary due to integrated motor electronics</li> </ul> <p><b>Liquid:</b></p> <p>Pumped liquid: Water</p> <p>Liquid temperature range: 35.6 .. 203 °F</p> <p>Liquid temp: 140 °F</p> <p>Density: 61.35 lb/ft<sup>3</sup></p> <p><b>Technical:</b></p> <p>TF class: 95</p> <p>Approvals on nameplate: UL, CSA</p> <p><b>Materials:</b></p> <p>Pump housing: Brass MS 68</p> <p>Impeller: Stainless steel, EPDM, PPO, PTFE, Graphit</p> <p><b>Installation:</b></p> <p>Maximum operating pressure: 145 psi</p> <p>Flange standard: USA Sweat</p> <p>Pipe connection: 1/2" Sweat</p> <p>Pressure stage: 10</p> <p>Port-to-port length: 3 1/8 in</p> <p><b>Electrical data:</b></p> <p>C run: 0.6 µF</p> <p>Max. power input: 6 W</p> <p>Main frequency: 60 Hz</p>



Company name:

Created by:

Phone:

Date:

5/2/2016

Position	Count	Description
		<p data-bbox="343 340 997 548">Rated voltage: 1 x 115-230 V Current in speed 3: 0,10/0,07 A Capacitor size - run: 0.6 µF Enclosure class (IEC 34-5): IP44 Insulation class (IEC 85): F Cable type: Connecting cord with plug Type of cable plug: NEMA 5-15P</p> <p data-bbox="343 577 790 638"><b>Others:</b> Shipping volume: 0.12 ft³</p>



Company name:

Created by:

Phone:

Date:

5/2/2016

### 98420222 UP 10-16 A PM B5/LC 60 Hz

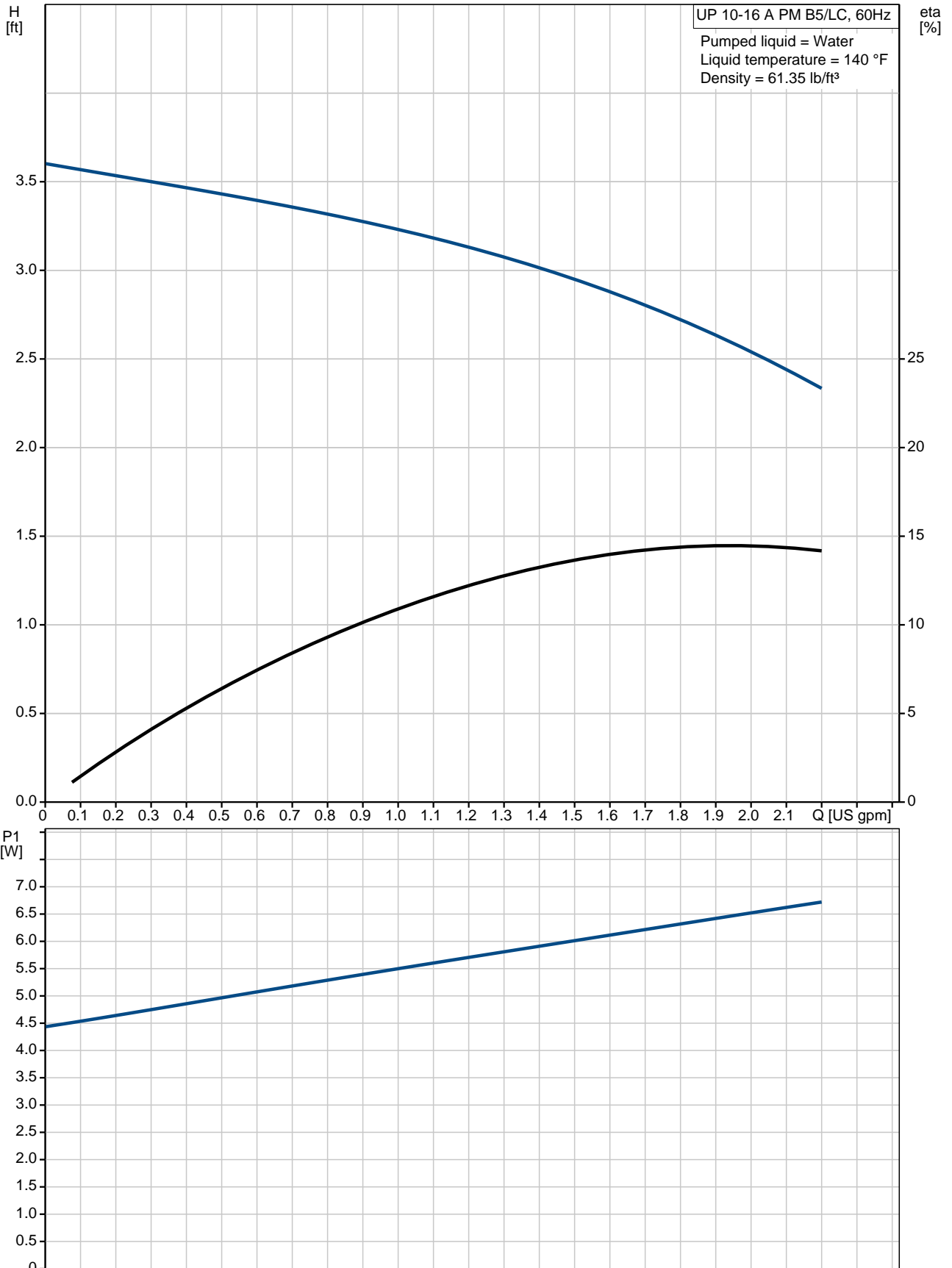

Description	Value
-------------	-------

**General information:**

Product name:	UP 10-16 A PM B5/LC
Product No.:	98420222
EAN:	5711494712878
Price:	On request

**Technical:**

Speed Number:	1
Head max:	5.25 ft
TF class:	95
Approvals on nameplate:	UL,CSA

**Materials:**

Pump housing:	Brass MS 68
Impeller:	Stainless steel, EPDM, PPO, PTFE, Graphit

**Installation:**

Maximum operating pressure:	145 psi
Flange standard:	USA Sweat
Pipe connection:	1/2" Sweat
Pressure stage:	10
Port-to-port length:	3 1/8 in

**Liquid:**

Pumped liquid:	Water
Liquid temperature range:	35.6 .. 203 °F
Liquid temp:	140 °F
Density:	61.35 lb/ft <sup>3</sup>

**Electrical data:**

C run:	0.6 μF
Max. power input:	6 W
Main frequency:	60 Hz
Rated voltage:	1 x 115-230 V
Current in speed 3:	0,10/0,07 A
Capacitor size - run:	0.6 μF
Enclosure class (IEC 34-5):	IP44
Insulation class (IEC 85):	F
Motor protection:	NONE
Thermal protec:	IMPE
Cable type:	Connecting cord with plug
Type of cable plug:	NEMA 5-15P

**Others:**

Shipping volume:	0.12 ft <sup>3</sup>
------------------	----------------------

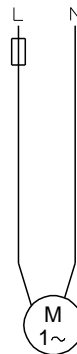
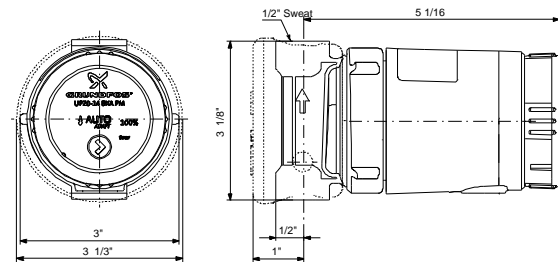
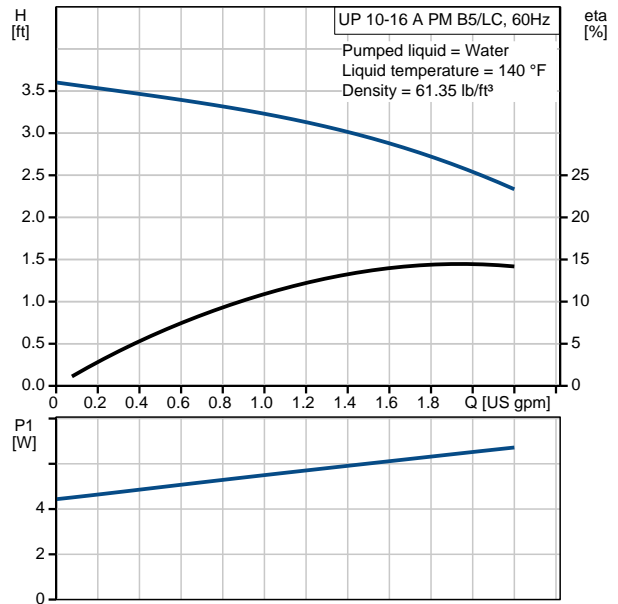

## 98420222 UP 10-16 A PM B5/LC 60 Hz

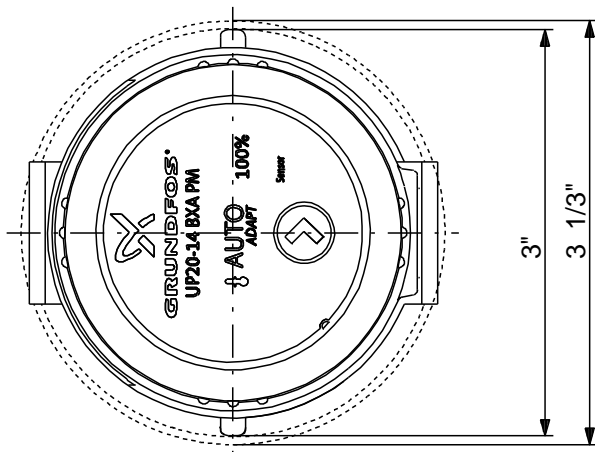
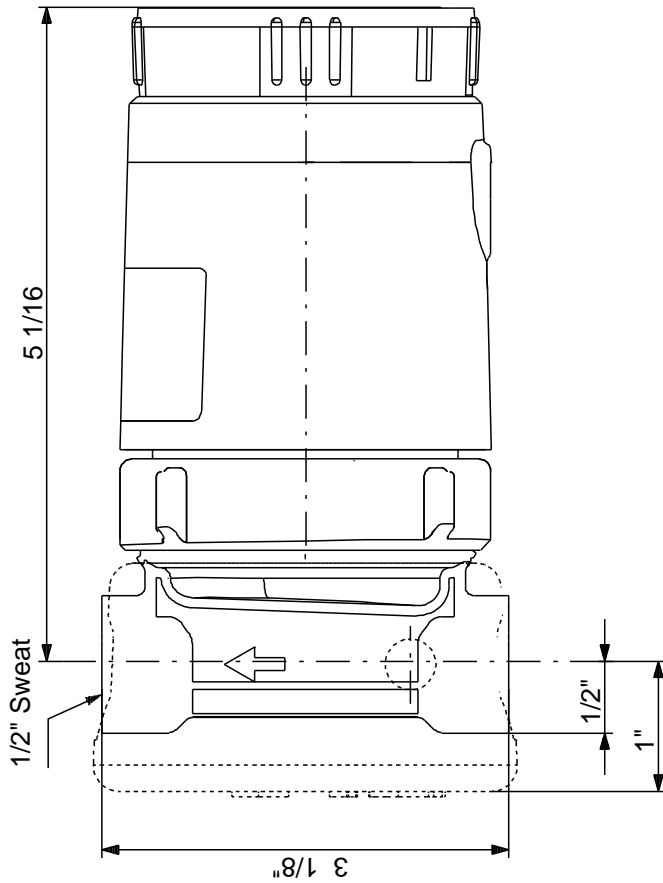

Note! All units are in [mm] unless otherwise stated.  
Disclaimer: This simplified dimensional drawing does not show all details.

**98420222 UP 10-16 A PM B5/LC 60 Hz**

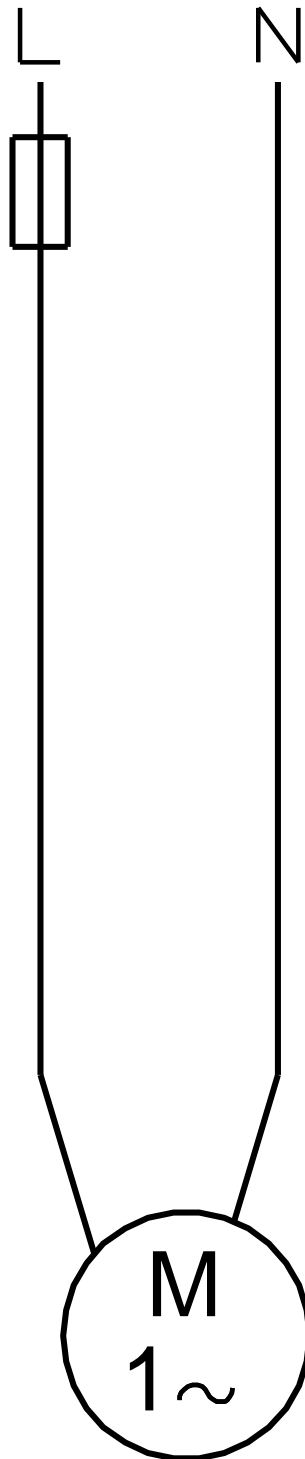

All units are [mm] unless otherwise presented.