

AQUATIC

Designed for luxury. Engineered for life.



OWNER'S MANUAL & INSTALLATION GUIDE

Note: Read all instructions before proceeding with installation.
All specifications are $\pm 1/4"$ and are subject to change without notice.

LUXURY SERIES

AQUATIC

Designed for luxury. Engineered for life.

TABLE OF CONTENTS

PRODUCT REGISTRATION	3
CONGRATULATIONS!	4
SAFETY INSTRUCTIONS	5
 INSTALLATION INSTRUCTIONS	
Pre-Installation Procedures	6
Structural Preparation	7
Plumbing	8
Rough-In Measurements	9
Electrical Installation	10
<i>Electrical Wiring Schematics--</i>	
Whirlpool and Heater	11
Optional Inline Heater Operating Instructions	12
On/Off Timer Control Instructions	12
Troubleshooting On/Off Timer Control	13
Optional Chromatherapy LED Light Instructions	13
Troubleshooting Chromatherapy LED Light	14
Integrally Skirted Whirlpool	14-15
 OPERATION	
Bathside Control Systems	16
Optional Chromatherapy LED Light	16
Jet Operations	17-19
User Information	20
FCC Information	20
 MAINTENANCE AND CARE	
Initial Cleaning	21
Whirlpool System Cleaning	21
Surface Cleaning	21
Jet Cleaning	21
Surface Scratch Removal	22
Repair Information	22
Water Quality Issues	22-24
 TROUBLESHOOTING GUIDE	
Symptoms/Possible Problems/Solutions	25
Serial Number - How to Locate	25
 PARTS ORDER FORM/PARTS MAPS/PARTS LIST	
Parts Order Form	26
Parts Maps	27-28
Parts List	29-30
 AQUATIC LIMITED WARRANTY	31

AQUATIC INDUSTRIES, INC.

Product Registration Information

Your product warranty is registered and confirmed with Aquatic through the Serial Number on your unit. You do not need to contact Aquatic to confirm registration. Please fill out the information below and reference when contacting the distributor to expedite warranty claims.

OWNER INFORMATION:

Model Name

Serial Number

(See Table of Contents for Location)

Purchase Date

Distributor

AQUATIC

P.O. Box 889 • Leander, TX 78646-0889
Phone (800) 928-3707 • Fax (888) 296-7450

CONGRATULATIONS!

You have chosen one of the finest bath products in the world! Aquatic Industries supports your purchase with strong commitments to quality and customer satisfaction.

Please read and follow all of the instructions contained in this Owner's Manual before installing, operating or maintaining your whirlpool. In addition, you should continually refer to these instructions during the life of your whirlpool. Failure to comply with these instructions may invalidate your warranty. If you have any questions concerning installation, operation, maintenance or any other aspect of your whirlpool, please contact:

AQUATIC INDUSTRIES CUSTOMER SERVICE CENTER: 800-928-3707
(The Troubleshooting Guide on page 25 may be helpful in answering some of your questions.)

NOTE:

The installation and service of your whirlpool should be performed **ONLY** by a qualified electrician, technician or plumber.

IMPORTANT!

This product **MUST BE WATER-TESTED** and inspected prior to installation or warranty will be voided. See page 6 for instructions.

PLEASE CHECK ENTIRE UNIT FOR ANY DAMAGE.

If it appears damaged, contact your Aquatic Distributor **immediately**.
Aquatic Industries, Inc. warranty does not cover damage that occurs in transit.

IMPORTANT SAFETY INSTRUCTIONS

WARNING: WHEN USING THIS UNIT, THESE BASIC PRECAUTIONS SHOULD BE FOLLOWED.

This manual contains information and instructions for proper operation and maintenance of your whirlpool. Failure to follow these instructions could result in personal injury, electrical shock or fire.

READ AND FOLLOW ALL INSTRUCTIONS

DANGER! TO REDUCE THE RISK OF INJURY:

- A. Do not permit children to use this unit unless they are closely supervised by an adult at all times. Supervision is also required when whirlpool bath is used by an elderly or handicapped individual.
- B. Use this unit only for its intended use as described in this manual. Do not use attachments not recommended by the manufacturer.
- C. Do not operate this unit without guard over the suction fitting.
- D. The water in a whirlpool should never exceed 40°C (104°F). Water temperatures between 38°C (100°F) and 40°C (104°F) are considered safe for a healthy adult. Use time should be limited to approximately 30 minutes, followed by a shower to cool down. Longer exposures may result in hyperthermia. The symptoms of this condition are nausea, dizziness and fainting, which can be fatal. Lower water temperatures are recommended for extended use (exceeding 10-15 minutes) and for young children.
- E. Since excessive water temperatures have a high potential for causing fetal damage during the early months of pregnancy, pregnant or possibly pregnant women should limit whirlpool water temperatures to 38°C (100°F).
- F. The use of drugs or alcoholic beverages before or during whirlpool use may lead to unconsciousness with the possibility of drowning. Never use the whirlpool while under the influence of alcohol, anticoagulants, stimulants, antihistamines, vasoconstrictors, vasodilators, hypnotics, narcotics or tranquilizers.
- G. Persons with a medical history of heart disease, low or high blood pressure, circulatory system problems, or diabetes should consult a physician before using a whirlpool.
- H. Persons using medication should consult a physician before using a whirlpool since medication may induce drowsiness while other medication may affect heart rate, blood pressure and circulation.

DANGER: To reduce the risk of injury, enter and exit the bath slowly.

WARNING: Never operate electrically connected devices in or near the bath. Never drop or insert any object into any opening within the whirlpool.

This unit must be connected to a supply circuit that is protected by a Ground Fault Circuit Interrupter (GFCI). Such a device should be installed by a licensed electrician and should be tested on a regular basis (at least monthly). To test the GFCI push the **TEST** button. The GFCI should interrupt the power. Push the **RESET** button and the power should be restored. If the GFCI fails to operate in this manner there is the possibility of an electric shock. **DO NOT USE.** Disconnect the unit and have the problem corrected by a qualified service technician. To avoid the possibility of personal injury and discoloration of the acrylic surface, the inlet water temperature should not exceed 60°C (140°F). The bath should be drained after each use. Each bather should start their bath with fresh water.

CAUTION: DO NOT USE HARSH ABRASIVES OR SOLVENTS FOR CLEANING THIS UNIT.

INSTALLER/OWNER BEARS ALL RESPONSIBILITY TO COMPLY WITH ALL STATE AND LOCAL CODES WHEN INSTALLING THIS PRODUCT.

SAVE THESE INSTRUCTIONS

INSTALLATION INSTRUCTIONS / GUIDELINES

READ ALL INSTRUCTIONS CAREFULLY BEFORE INSTALLATION

PRE-INSTALLATION PROCEDURES:

PLEASE NOTE: THE MANUFACTURER ACCEPTS A 1/4" VARIANCE. THERE ARE VARIATIONS ON EACH TUB AND SPECIFICATIONS ARE SUBJECT TO CHANGE AS WE IMPROVE UPON OUR PRODUCT AS REQUIRED.

THE DIMENSIONS NEEDED FOR SITE PREPARATION AND STRUCTURE BUILDINGS SHOULD BE MEASURED FROM THE TUB; AQUATIC INDUSTRIES, INC. ASSUMES NO RESPONSIBILITY FOR PREPARATORY WORK.

Note: A good knowledge of construction techniques, plumbing and electrical installation according to codes are required for proper installation. We recommend that a qualified licensed contractor perform the installation of all Aquatic products. Our warranty does not cover improper installation related problems.

WARNING: All units are shipped with loose unions. Before attempting to test, install, or use your whirlpool, all pump and heater unions and "O" rings must be repositioned and tightened.

1. Immediately upon receiving your Aquatic Industries, Inc. whirlpool bath inspect it thoroughly for freight damage. If necessary, contact your distributor immediately (your distributor must contact Aquatic Industries, Inc. within 24 hours of receiving unit to file a claim.) Should inspection indicate any damage, do not install the bath.

Damage or defect to the finish claimed after the bath is installed is not covered under the warranty.

2. Remove packing material between tub and pump/heater (on some models).
3. All baths are filled with water and operated in our manufacturing facility prior to shipment. Inspectors ensure watertight operation, however rough handling may cause leaks which may be detected prior to installation.

TO INSPECT:

4. Place the tub in an area where it may be drained after testing.
5. Fill the tub with hot water (approx. 100° F) to the overflow and allow to stand for a few minutes.
6. Plug in pump cord and run pump for 10 minutes.
7. Inspect the tub completely. Any defect must be reported to Aquatic Industries, Inc. prior to installation in order to have it covered by warranty. Should inspection indicate any damage or leaks, do not install the bath.

Damage or leaks claimed after the bath is installed are not covered under the warranty.

8. Check to ensure that your installation will conform to all applicable codes and secure necessary permits. All electrical and plumbing connections should be made by qualified electricians and plumbers.

WARNING: FAILURE TO FOLLOW THESE INSTRUCTIONS DURING INSTALLATION WILL RESULT IN TERMINATION OF THE WARRANTY:

Do not lift the tub by any portion of the plumbing or pump.

Do not stand in the tub during construction.

DO NOT MAKE ANY ALTERATIONS, ADDITIONS, OR DELETIONS TO THE WHIRLPOOL SYSTEM PUMP OR BATH.

WARNING: Whirlpool pump and piping are factory assembled. Relocation of pump or other modifications could adversely affect the performance and safe operation of this whirlpool. Aquatic Industries, Inc. shall not be liable under its warranty or otherwise for personal injury or damage caused by any such unauthorized modification.

QUIETNESS OF OPERATION: Aquatic has engineered their whirlpool baths from base to lip to ensure quality, value, functional design, and maximum bathing comfort. However installation is accountable for as much as 50% of a tub's operating quietness. Please ensure the following:

- The floor structure is adequate to support the installation.
- For quieter operation and heat retention conservation, the walls surrounding the whirlpool may be insulated.
- Insulate the tub surround. Do not allow any insulation to come within 3 feet of the pump. The area around the pump must be clean and free of any foreign matter.
- Leave 1/8" to 3/16" gap between tub lip and surround.
- Spread a bed of cement mortar on the floor or subfloor under the whirlpool to reduce vibration and noise.

INSTALLATION INSTRUCTIONS

STRUCTURAL PREPARATION:

Note: The bath should remain in its shipping carton until time of installation.

1. Literature dimensions are for reference only. Installation dimensions should be taken directly from the tub. An unobstructed access panel of 16" x 16" minimum must be provided at the pump end of the whirlpool allowing sufficient clearance to make final connections and for servicing the pump and power panel. Access may be through the wall or platform apron at the end of the unit. In the case of sunken installations, access should be made through the ceiling below. **It is the installer's responsibility to provide sufficient service access. Make absolutely certain that access panels and/or service openings are properly placed and that all possible areas where service may be required are accessible.**
2. Install the drain fitting to the bath. THE DRAIN FITTING WILL PROTRUDE BELOW THE BASE OF THE TUB APPROXIMATELY 1 1/2". Clearance must be provided for the drain by cutting away the subfloor (where possible) or by blocking below the tub as may be required.

NOTE: Watertight installation of the drain and overflow is the installer's responsibility. Drain and/or overflow leakage is not included in the warranty of this product.

WARNING: FACTORY SKIRTS DO NOT ALLOW FOR BLOCKING UP OF THE TUB BASE. All blocking must be solid and provide uniform support to the tub base.

3. Tub must rest entirely on the base. **DO NOT SUPPORT THE WEIGHT OF THE TUB BY THE RIM.** Where leveling is required, and to reduce vibration noise, prepare a bed of wet mortar in area where tub is to be installed. Carefully level unit, ensuring that uniform support is given to all areas of the base and no portion of the lip is bearing weight.
4. Frame out under the tub rim as shown in one of the illustrations below. **NOTE:** Due to the variety of installations possible, framing procedures other than those described may be required. Plumb in selected location using a level. Level front to back and across both sides. A ledge under the rim, or an apron without a ledge, may be constructed as required (see **Diagram 1A and 1B**). Where installation will be against a wall, stud wall framing should allow for wall sheathing material to run full length to the floor (see **Diagram 1C**). Install tub firmly against sheathing as indicated, with blocking below rim to prevent deflection or movement of tub. To prevent a rocking movement of tub after installation, it is important to have rim in contact, but not supported by blocking material.
5. When placing the tub on a platform or cut out (see **Diagrams 1A and 1D**), the opening should be 1" smaller than the specified rim dimensions. Extreme care must be taken in this type of installation to ensure the tub will come to rest entirely on the base.

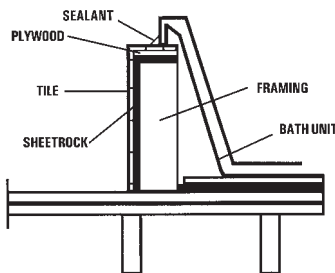

1A Ledge Installation - 1

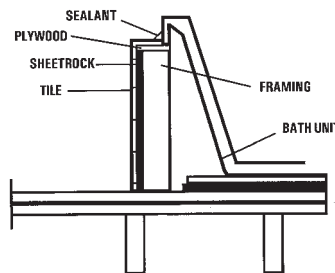

1B Ledge Installation - 2

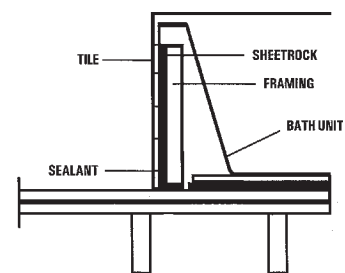

1C Apron Installation

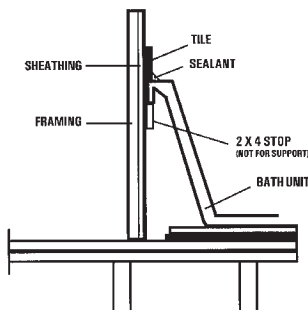

1D Wall Installation

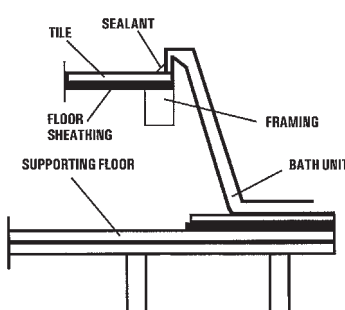

1E Sunken Installation

WARNING: ALL ELECTRICAL CONNECTIONS SHOULD BE MADE BY A LOCALLY LICENSED ELECTRICIAN/TECHNICIAN.

INSTALLATION INSTRUCTIONS

STRUCTURAL PREPARATION (continued):

6. Another installation option is that of a tile flange. Aquatic offers a factory installed tile flange for all rectangular and corner-unit whirlpools.
7. Install the whirlpool bath unit per the instructions provided in this manual.
CAUTION: THE TILE FLANGE DOES NOT SUPPORT THE TUB! A ledger board must be provided under the bath rim as indicated in the installation instructions. Take care to ensure tub is not hanging from the ledger boards, as this will void your warranty.
8. Use nails or screws to secure the flange into the studs around the bath.
9. Install water resistant drywall against the tile flange and flush to the top of the whirlpool deck. Install the tile or other finishing materials. Apply a second bead of silicone between the first course of tile and the bath deck.

NOTE: Before tub is used, the whirlpool system should be cleaned in accordance with the procedures on page 21 of this manual.

PLUMBING:

1. After securing tub in place, normal waste and overflow, water spout and valves are installed per normal plumbing procedures, in accordance with all state and local standards.
2. Install standard 1-1/2" trap to drain and overflow. Before proceeding make final operational check by filling tub with water to overflow and operate pump for 5 minutes. Check for leaks carefully both while pump is running and has been turned off. Allow water to stand in tub for at least 30 minutes before draining. **AQUATIC INDUSTRIES, INC. WILL NOT BE RESPONSIBLE FOR WATER DAMAGE OF ANY KIND IN CONNECTION WITH ONE OF OUR WHIRLPOOL BATHS.**
3. When selecting fill spout location, check to ensure that spout is long enough to clear the tub rim from its desired location. If installation is to be on the tub deck, check the back side of tub for adequate space for connection to water lines before drilling or cutting tub.
4. A service unobstructed access panel of a minimum of a 16" square must be provided adjacent to motor/pump assembly.

INSTALLATION INSTRUCTIONS

ROUGH-IN MEASUREMENTS:

See Diagram 3A, below

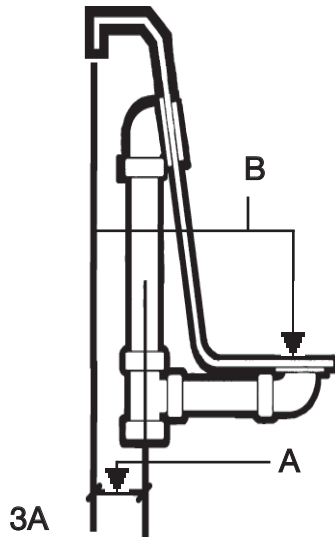

MODEL

	<u>A</u>	<u>B</u>
Cambridge	6 3/4"	12 3/8"
Camina Motif	13 1/2"	5 1/2"
Canterbury	6 3/4"	12 1/8"
Carmel	2 1/2"	9 3/16"
Castaway	5 1/2"	11 7/8"
Castaway Oval	5 3/8"	12"
Chesapeake	5"	28"
Clearwater	6 1/2"	13 1/2"
Clearwater, Jr.	6 1/2"	12 3/4"
Daytona	2 1/4"	11 1/4"
Del Ray	3"	10 7/8"
Del Ray, Jr.	1 3/4"	8 7/8"
Heart	4 1/2"	14"
Key West (Short Side)	8 7/8"	17 1/4"
Key West (Long Side)	4 3/4"	13 3/16"
Laguna	2 1/4"	11 1/4"
Mendocino	5 1/8"	11 3/4"
Oxford	6 1/4"	11 7/8"
Pagosa Motif	Please contact Aquatic	
Point Arena	6 3/4"	14"
Point Reyes	5 1/4"	16 1/4"
Point Reyes, Jr.	3 3/4"	11 1/4"
Pompano	2 1/2"	10 3/8"
Riviera Motif	12 1/4"	3 1/2"
San Simeon	2 1/2"	9 3/8"
Santa Clara	1 5/8"	9 1/4"
Santa Cruz	1 3/4"	10 3/4"
Sarasota Motif	Please contact Aquatic	
Sarita Motif	14"	6"
South Padre	2 1/4"	12"
Sunset	2 1/4"	10 1/2"
Universal Oval	6 1/2"	13 1/4"
Winchester	7"	11 3/4"

PLEASE NOTE: ALL DIMENSIONS GIVEN ARE CORRECT AS OF THIS PRINTING. AQUATIC INDUSTRIES, INC. RESERVES THE RIGHT TO CHANGE SPECIFICATIONS WITHOUT NOTICE.

INSTALLATION INSTRUCTIONS

ELECTRICAL INSTALLATION:

WARNING: ALL ELECTRICAL CONNECTIONS SHOULD BE MADE BY A LICENSED, LOCALLY CERTIFIED ELECTRICIAN, IN ACCORDANCE WITH THE REQUIREMENTS OF THE NATIONAL ELECTRICAL CODES AND PROCEDURES.

WARNING: WHEN USING ELECTRICAL PRODUCTS, BASIC PRECAUTIONS SHOULD ALWAYS BE FOLLOWED, INCLUDING THE FOLLOWING:

DANGER: RISK OF ELECTRIC SHOCK! This unit requires one dedicated circuit, two dedicated circuits for optional heater, each protected by a Ground Fault Circuit Interrupter (GFCI). A GFCI is not supplied, however we do specify its use. All known code authorities require a GFCI. Rough in wiring to pump on a dedicated 120V, 15 amp, GFCI protected circuit. If tub has the optional heater, rough in wiring to heater on a dedicated 120V, 15 amp, GFCI protected circuit.

PLEASE SEE DIAGRAMS 4A AND 4B ON PAGE 11

BONDING WIRE: Connect a #8 bare copper bonding wire from the pump motor to the heater (option) and then to the cold water plumbing or other suitable ground. Grounding is required.

For built-in and custom units, install to permit access for servicing.

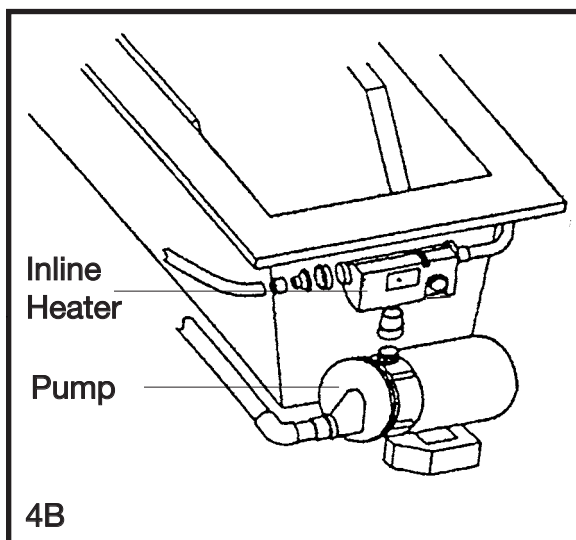
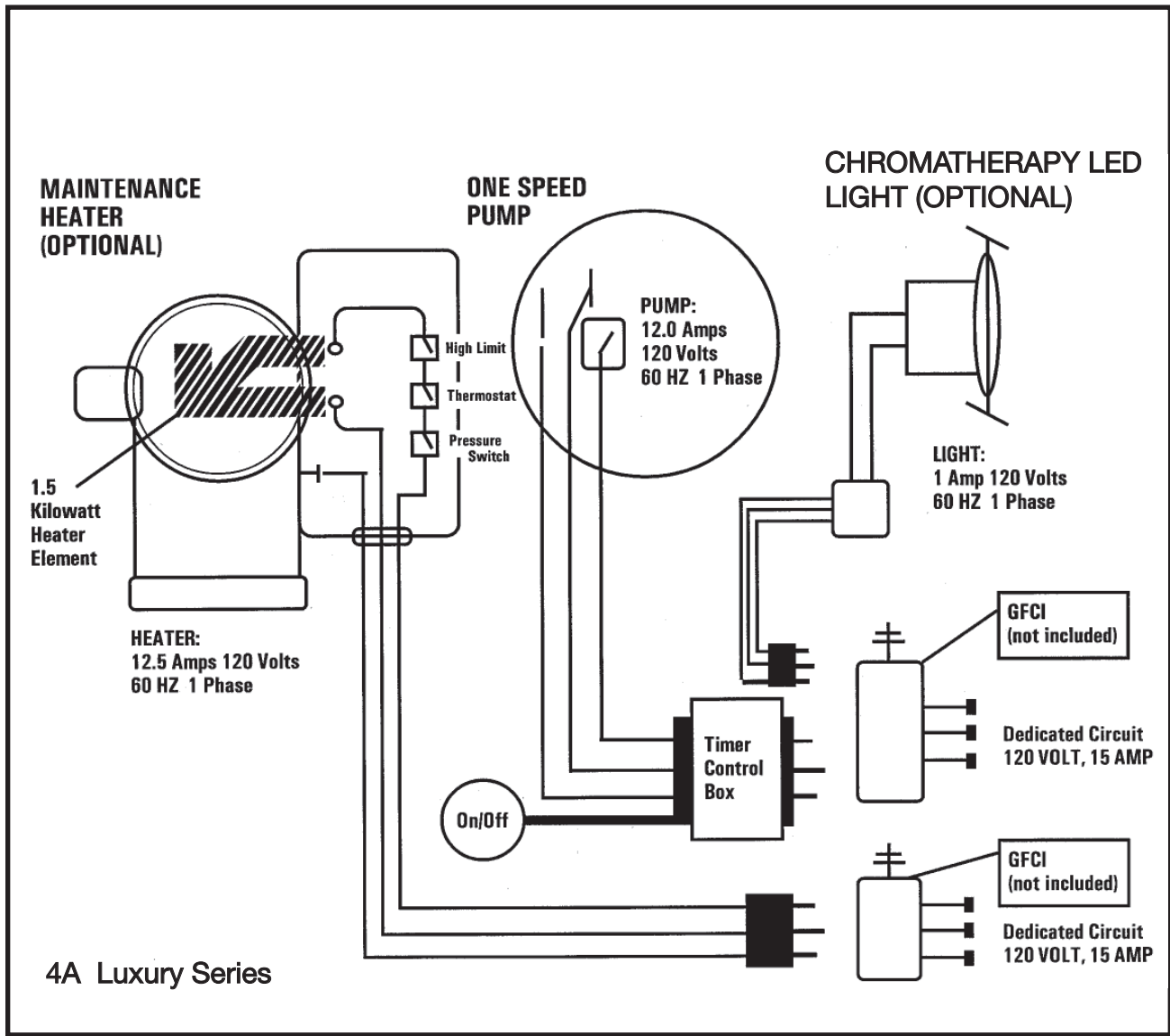

INSTALLATION INSTRUCTIONS

OPTIONAL INLINE MAINTENANCE HEATER OPERATING INSTRUCTIONS:

Operation of the inline maintenance heater is completely automatic. The heater will help maintain the temperature of the water in the whirlpool. The heater includes the following components:

THERMOSTAT: The “Smart Thermostat” requires no adjustment and will automatically maintain the water temperature at 102° F - 104° F. If the whirlpool is too warm, simply adjust by adding cold water.

HIGH LIMIT: The heater includes an exclusive “Intelligent High-Limit”. This safety circuit will not “false trip” from hot tap water. It will only turn the heater off if the thermostat fails. To reset, simply press the red button. If the high-limit trips frequently, contact Aquatic Industries, Inc.

INDICATOR LIGHT: The light on the heater turns on when the heater is operating.

PRESSURE/VACUUM SWITCH: The heater is equipped with a preset pressure or vacuum switch. The pump must be running with water flowing to the whirlpool to allow the heater to turn on.

CAUTION: Before use of the pump and heater, test the GFCI for proper operation. The pump and heater should turn off when the GFCI “Test” button is pushed.

Warning - Prolonged Immersions in Hotter Water May Induce Hyperthermia.

Hyperthermia occurs when the internal temperature of the body reaches a level several degrees above the normal body temperature of 98.6° F. The symptoms of hyperthermia include an increase in the internal temperature of the body, dizziness, lethargy, drowsiness, and fainting. The effects of hyperthermia include (1) failure to perceive heat, (2) failure to recognize the need to exit the whirlpool, (3) unawareness of impending hazard, (4) fetal damage in pregnant women, (5) physical inability to exit the whirlpool, (6) unconsciousness resulting in the danger of drowning.

WARNING - The use of alcohol, drugs, or medication can greatly increase the risk of fatal hyperthermia.

INSTALLATION OF ELECTRONIC ON/OFF TIMER CONTROL FOR LUXURY SERIES:

1. Plug the On/Off Timer Control into a dedicated 120-volt, minimum 15-amp outlet (see Diagram 5A).
2. Plug the 1.5 HP motor into the On/Off Timer Control.
3. Wait 10-20 seconds (for self-calibration) before you depress the On/Off Button (see Diagram 5B).



5A



5B

INSTALLATION INSTRUCTIONS

TROUBLESHOOTING ON/OFF TIMER CONTROL FOR LUXURY SERIES:

1. If the On/Off Button does not turn on the pump, make sure the outlet has voltage. Unplug the On/Off Timer Control and plug in a hair dryer or other electrical device to see if the outlet is active.
2. If the new device you plugged in also does not work, call your electrician.
3. If the new device you plugged in does work, try the installation procedures again.
4. If this does not work, unplug the On/Off Timer Control from the wall outlet.
5. Then unplug the motor from the On/Off Timer Control.
6. Now plug the motor cord directly into the wall outlet. If the motor turns on, the installation procedures should be tried again.
7. If the motor still does not turn on, call Aquatic Industries' Technical Service Department at (800) 928-3707.

OPTIONAL CHROMATHERAPY LED LIGHT INSTALLATION:

1. During installation, be sure that the air tube from the air switch on the top lip of the tub is correctly connected to the air switch outlet on the LED transformer box. (See Diagram 6A)
2. Check to ensure the plug from the LED is connected to the transformer box.
3. Make sure the 120 Volt plug for the LED transformer box is connected to a GFCI (Ground Fault Circuit Interrupter) protected outlet. The underwater light may be plugged into the same socket as either the pump or heater.

To replace LED light:

1. Disconnect the power to your bathtub.
2. Drain the bathtub.
3. Open the lens of the fixture using ONLY the proper tool provided for that purpose (see Diagram 6B). Do not attempt to remove the lens without the provided tool.
4. Replace your LED light (replacement LED lights can be obtained from Aquatic Industries).
5. Verify "O" ring is not damaged and is properly positioned in the groove when replacing the lens. If there is damage or lens does not seal properly, do not refill bathtub.

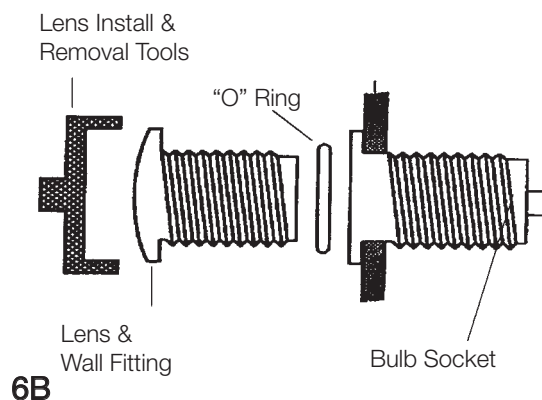
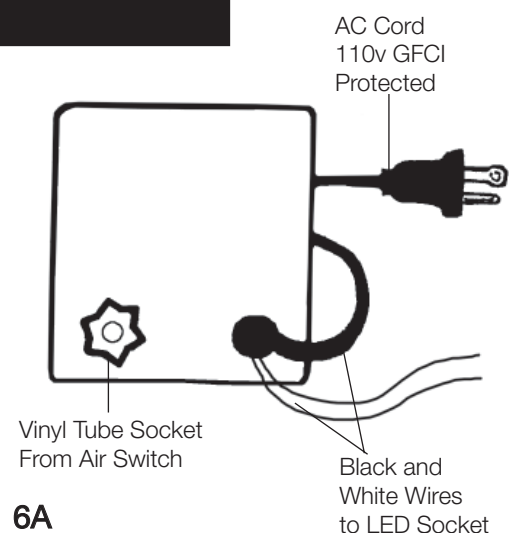

NOTE: Do not twist LED light into socket. Use gentle pressure and push LED light into place.

INSTALLATION INSTRUCTIONS

TROUBLESHOOTING GUIDE FOR CHROMATHERAPY LED LIGHT:

If light doesn't turn on:

1. Check to ensure LED light has been electrically connected and there is power to transformer.
2. Check to ensure the air switch tube is connected to both the switch on LED transformer and button.
3. Air tube should be checked to confirm there are no kinks.
4. Check LED light to ensure that it is not broken or loose from socket.

If the above has been performed and LED light is still not operational, please contact Aquatic Industries' Customer Service Department at (800) 928-3707.

SANTA CLARA & SANTA CRUZ - INTEGRALLY SKIRTED WHIRLPOOLS:

ALCOVE FRAMING AND PRE-INSTALLATION PROCEDURES:

1. Protect interior of tub throughout installation procedures.
2. Before moving unit into alcove see and follow enclosed Electrical Installation Procedures (electrical and air tube hookups will be difficult to perform if unit is installed first.)

IMPORTANT! BEFORE INSTALLATION BEGINS, MAKE SURE THAT:

1. Framed-in alcove is of proper size, square and plumb.
2. Walls and floors meet fire safety requirements of local building code and/or FHA/HUD Minimum Property Standards. Before installation of the panel, fill the unit, test the whirlpool system for proper operation and check for leaks, then drain.
3. A mortar base is prepared (this is mandatory for proper installation).

INSTALLATION INSTRUCTIONS

INSTALLATION PROCEDURES FOR INTEGRALLY SKIRTED MODELS:

1. To avoid obstructions during installation, make sure water lines, spout pipes and valve plumbing do not project into alcove.
2. **Ledger Strip:** Fasten a 1" x 3" (25mm x 75 mm) ledger strip along rear for alcove and along both sides in corner installations at Dimension LH. (see Diagram 7A)
3. Place three or four mounds of mortar away from drain hole in a line or square, approximately twice as high as the cavity under the tub bottom.
4. Place tub into alcove with front skirt firmly on floor and depress plaster mounds. Make certain that back ledge of tub rests firmly on ledger strip. (see Diagram 7A)
5. See and follow Sealing & Finishing Diagram 7B.

7A

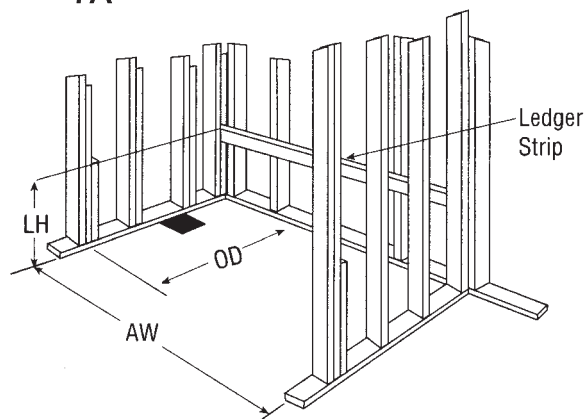

7B

Sealing & Finishing Typical methods of sealing and finishing

Make sure interior of tub is protected during finishing.

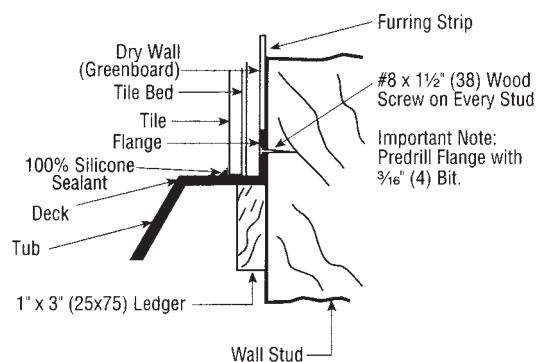

REMOVABLE SKIRT PANELS FOR INTEGRALLY SKIRTED MODELS:

These models are offered with removable panels. It provides a flush-to-wall installation (sheet rock overlaps skirt while still providing access). The skirt features a decorative removable panel enabling easy access to motor, pump and electrical hookups. Clips enable simple and quick removal of skirt access panel.

Important: Before installation of the panel, fill the unit, test the whirlpool system for proper operation and check for leaks, then drain.

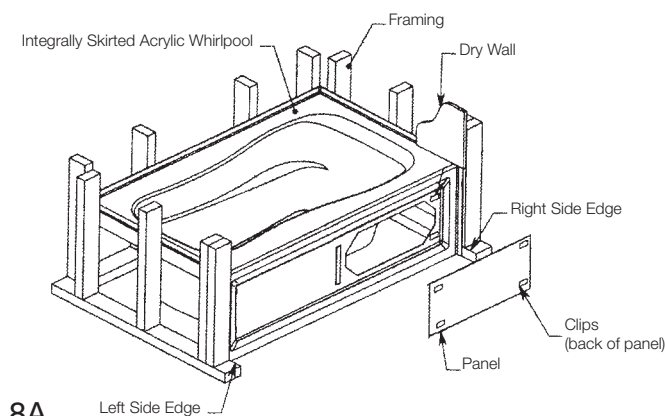

8A



OPERATION of LUXURY SERIES WHIRLPOOLS

NOTE: DO NOT START PUMP UNTIL ALL JETS ARE SUBMERGED. WATER LEVEL SHOULD BE 2" ABOVE HIGHEST JET.

BATHSIDE CONTROL SYSTEMS:

ON/OFF CONTROLS:

The On/Off Electronic Button with Timer (Diagram 9A) is the On/Off Button for the pump/jet action for the Luxury Series.

- **1.75 HP, One-Speed Pump (9A)**
 1. Make sure whirlpool has enough water in it to submerge the highest jets by about 2 inches of water.
 2. Push the On/Off Button once to turn the pump on. The whirlpool has a built-in timer and will automatically turn off in approximately 20 minutes. To restart the pump, simply push the On/Off Button.
 3. When the motor is running, push the On/Off Button to turn the pump off.
- **Optional 2 HP, Three-Speed Pump (9A)**
 1. Make sure whirlpool has enough water in it to submerge the highest jets by about 2 inches of water.
 2. Push the On/Off Button once to turn on high, a second time for medium and a third for low speed.
 3. Push the On/Off button a fourth time to turn the pump off.



9A

OPTIONAL CHROMATHERAPY LED LIGHT:

One On/Off Button operates the pump, while the additional air button (9B) operates the chromatherapy LED light. One depression of this button turns the light on, while the second turns the light off.

To Turn Your Chromatherapy Lighting System ON: Press the On/Off Button (9B) once to turn the Chromatherapy Light ON in Color Wash mode. A second press of the button will turn the lighting system OFF. Subsequent presses will move the lighting system through the seven constant color modes.

- | | |
|---|--------------------------------|
| • 1st Press
Color Wash: Random color blend | • 9th Press
Blue: Peace |
| • 2nd Press
Off | • 10th Press
Off |
| • 3rd Press
White: clarity | • 11th Press
Yellow: Hope |
| • 4th Press
Off | • 12th Press
Off |
| • 5th Press
Aqua: Calm | • 13th Press
Green: Harmony |
| • 6th Press
Off | • 14th Press
Off |
| • 7th Press
Violet: Inspiration | • 15th Press
Red: Courage |
| • 8th Press
Off | |



9B

OPERATION of LUXURY SERIES WHIRLPOOLS

JET OPERATIONS:

All Luxury Series jets are removable, and can simply be put into the dishwasher for easy cleaning.
(Note: use top rack and remove before drying cycle.)

LUXURY SERIES WHIRLPOOL JETS

The Luxury Series combines Full-Size Pressure-Flo Hydrotherapy Jets, Aquatic Rotary Massage Jets and StressEaz Neck and Shoulder Massage Jets (most models) to provide an invigorating hydrotherapy experience.

Full Size Pressure-Flo Hydrotherapy Jet:

All Full-Size Pressure-Flo Hydrotherapy Jets can be interchanged with the Hand Held Jet. **NOTE:** For operation information, please see Diagrams 12A, 12B and 12C on page 19.

Aquatic Rotary Massage Jet:

The Aquatic Rotary Massage Jet is a highly versatile, full-size jet. As with all jets in this series, the pressure and circular pattern are fully adjustable.

- ***To adjust pressure (see Diagram 10A):***
 1. Grasp the outer ring of the jet.
 2. Turn the outer ring clockwise to increase flow, counter-clockwise to shut off.
- ***To adjust circular pattern (see Diagrams 10A, 10B, and 10C):***
 1. Small circular pattern: slide the nozzle until it is positioned in the center of the jet.
 2. Medium circular pattern: slide the nozzle to the desired location for a medium pattern.
 3. Large circular pattern: slide the nozzle to the desired location for a large pattern.
- ***To remove jet (see Diagram 10D):***
 1. Grasp the outer ring of the jet.
 2. Turn the jet counter-clockwise, until the jet clicks, then pull.
- ***To replace jet (see Diagram 10D):***
 1. Insert the jet into jet housing.
 2. Turn the jet clockwise, past point of resistance, until the jet clicks.

10A



10B



10C



10D



OPERATION of LUXURY SERIES WHIRLPOOLS

JET OPERATIONS (continued):

Stress-Eaz Neck and Shoulder Jets (most models):

The Aquatic Stress-Eaz Jet is a rotating jet that concentrates water flow on the user's neck and shoulder areas.

- ***To adjust pressure (see Diagram 11A):***
 1. Grasp the outer ring of the jet.
 2. Turn the outer ring clockwise to increase flow, counter-clockwise to shut off.
- ***To adjust circular pattern (see Diagrams 11A and 11B):***
 1. Small circular pattern: slide the nozzle until it is positioned in the center of the jet.
 2. Large circular pattern: slide the nozzle to the desired location for a large pattern.
- ***To remove jet (see Diagram 11C):***
 1. Grasp the outer ring of the jet.
 2. Turn the jet counter-clockwise until the jet clicks, then pull.
- ***To reinstall jet (see Diagram 11C):***
 1. Insert the jet into jet housing. **Note: DO NOT FORCE.**
 2. Turn the jet clockwise past the point of resistance until the jet clicks.

11A



11B



11C



OPERATION of LUXURY SERIES WHIRLPOOLS

JET OPERATIONS (continued):

Full Size Pressure-Flo Hydrotherapy Jets:

All Full-Size Pressure-Flo Hydrotherapy Jets can be interchanged with the Hand Held Jet.

- ***To adjust pressure (see Diagram 12A):***

1. Grasp the outer ring of the jet.
2. Turn the jet clockwise to increase flow, counter-clockwise to shut off.

- ***To adjust direction (see Diagrams 12A and 12B):***

1. Using fingertip, move jet eye to desired location.

- ***To remove jet (see Diagram 12C):***

1. Grasp the outer ring of the jet.
 2. Turn the jet counter-clockwise, until the jet clicks, then pull.
- ***To replace or change jet (see Diagram 12C):***
 1. Insert the jet into jet housing.
 2. Turn the jet clockwise, past point of resistance, until the jet clicks.

12A



12B



12C



WHIRLPOOL USER INFORMATION

PLEASE NOTE:

The whirlpool action may cause even small amounts of bubble bath or shampoo to foam excessively. Exercise moderation in experimenting with different soap products.

No servicing of this product should be done by the user. There are no user serviceable parts. All controls are located in the control recesses on the lip of the tub. These are the only controls that should be used by the consumer. Do not change or alter any of these controls under any circumstances.

Motors are self-lubricating -- No lubrication required.

FCC CONSUMER INFORMATION

Electrical installation information listed on pages 10 and 11.

This equipment generates and uses radio frequency energy and if not installed and used properly, that is, in strict accordance with the manufacturers instruction, may cause interference to radio and television reception. It has been type tested and found to comply with the limits for a class B computing device in accordance with the specifications in subpart J of part 15 of the FCC rules, which are designed to provide reasonable protection against such interference in a residential installation. However, there is no guarantee that interference will not occur in a particular installation. If this equipment does cause interference, which can be determined by turning the equipment on and off, the user is encouraged to try to correct the interference by one or more of the following measures:

- Reorient the receiving antenna
- Relocate the receiver with respect to the bath tub.
- Move the receiver away from the bath.
- Plug the receiver into a different outlet so that the receiver and bath are on different branch circuits.
- If necessary, the user should consult the dealer or an experienced radio/television technician for additional suggestions.
- The user may find the following booklet prepared by the Federal Communications Commission helpful: "How To Identify and Resolve Radio-TV Interference Problems."

This booklet is available from the U.S. Government Printing Office, Washington, DC 20402, Stock No., 004-000-00345-4.

MAINTENANCE AND CARE

INITIAL CLEANING:

Before tub is used, the whirlpool system should be cleaned and disinfected. Remove all debris and clean tub before putting whirlpool into service. **DO NOT USE ABRASIVE CLEANERS ON THE ACRYLIC FINISH.** Use a non-abrasive detergent and rinse well after cleaning.

- Fill the tub with HOT water to a level 2" above the highest jet.
- Add 2 teaspoons of low-sudsing automatic dishwashing detergent and no more than 4 ounces of household bleach to the water.
- Operate whirlpool for 10 minutes. Drain.
- Refill with cold water and operate whirlpool for 5 minutes. Drain.

WHIRLPOOL SYSTEM CLEANING:

To remove accumulations of bath residue from the whirlpool system, we recommend that you purge it at least twice a month, or more depending on usage. To do this, follow this simple procedure. Fill the bath with hot water (not exceeding 140° F). Add to the hot water, 4 (6) tablespoons of low foaming detergent such as liquid Cascade or Calgonite and 24 (48) oz. of liquid household bleach, such as Clorox [use lesser amounts shown for 5-foot bathtubs, greater amounts in parentheses for larger bathtubs]. Run the bath for 5 to 10 minutes. Drain the bath completely and refill with cold water only. Run the whirlpool for 5 to 10 minutes, then drain the bath completely. Depending on the usage and/or the content of the local water supply, more frequent purging may be necessary.

NOTE: DO NOT USE OIL OR OIL BASED BATH ADDITIVES.

If you want to use any kind of bath additive, use only a small amount of low-foaming powder or crystal substance; the whirlpool action intensifies the foaming properties of soaps.

The use of certain bubble baths and bath additives may increase the level of accumulations of bath residue in the whirlpool system. If excess accumulations persist, you should discontinue use of these products.

If you have followed the monthly purging instructions and still have an excess accumulation of bath residue and desire an alternative cleaning mechanism, we recommend **SUPER SYSTEMS CLEAN PLUS** manufactured by Stearns Packaging Corporation to rectify this condition. This may be obtained by calling Aquatic Industries, Inc., at (800) 555-5324. It is recommended that you follow the instructions provided by the manufacturer with the product. Repeated use may be necessary. **SUPER SYSTEMS CLEAN PLUS** does not replace the necessity to purge your whirlpool system at least twice a month with a low foaming detergent and bleach.

SURFACE CLEANING:

Use common household, non-abrasive cleaners for most cleaning jobs. Rinse well and dry with a clean cloth. Never use abrasive cleaners. Do not allow your Lucite® acrylic surface to come into contact with products such as acetone (nail polish remover), nail polish, dry cleaning solution, lacquer thinners, gasoline, pine oil, etc. Remove dust with a soft, dry cloth. Clean grease, oil, paint, and ink stains with isopropyl (rubbing) alcohol.

JET CLEANING:

All Luxury Series jets are removable, and can simply be put into the dishwasher for easy cleaning. See Jet Operation Instructions for removal, pages 17-19. (Note: use top rack and remove before drying cycle.)

MAINTENANCE AND CARE

SURFACE SCRATCH REMOVAL:

Minor scratches may be removed by polishing your tub with a non-abrasive car polish, followed by buffing. Deeper scratches can be removed by:

- Sanding with wet 400 grit sandpaper.
- Sanding with wet 600 grit sandpaper.
- Sanding with wet micro-grit sandpaper.
- Buff out using car polish.

REPAIR:

The installation and service of your whirlpool bath should be performed only by a qualified service technician. Remember when contacting your dealer always have your serial number, proof of purchase and model number available. This will ensure a quick response on warranty items.

The model and serial numbers are located above the pump on the backside of the whirlpool.

NOTE: ALL WARRANTY REPAIRS MUST BE AUTHORIZED BY AQUATIC BEFORE WORK IS STARTED. FOR SERVICE, ALWAYS CONTACT YOUR DEALER.

CAUTION: Care should be taken to prevent inappropriate chemicals coming in contact with the Lucite® acrylic surface. Please read and observe all instructions and/or warnings on containers containing substances you contemplate applying to your whirlpool. Any failure to comply may void your warranty.

WATER QUALITY ISSUES:

Owners of fill and drain whirlpool bathtubs need to know basic information concerning water quality: how it affects performance and enjoyment of the operation of their tubs, and steps that can be taken by the owner to correct related problems. Important issues are the microbiological and chemical quality of the water.

1. MICROBIOLOGICAL QUALITY

Microbes are present in water supplied by individual wells or water systems and even in the air around us. These microbes are usually in amounts below what is noticeable. Microbes from the water or air or from a bather's body may settle on wetted surfaces such as a whirlpool bathtub's surface or piping systems where they can grow in numbers where we can notice them. With regards to whirlpool bathtubs, brown/black fungi/mold or pigmented (colored) bacteria can be noted.

Fungi/Mold- Fungi and mold are always present. The levels are usually such that we do not notice them. When moisture and temperature are sufficient, the organisms will grow to levels that we may smell and/or see. The best example of such growth is the very common black growth on the bottom of shower curtains. The best solution to keep these surfaces free from growth is frequent cleaning.

Pigmented Bacteria- Water utilities from all over the United States have experienced calls from consumers inquiring and complaining about pinkish substance on bathroom fixtures that is very persistent, appearing in the shower, sink and along the water line of toilet bowls. With whirlpool bathtubs, the formation of this colored substance may be particularly pronounced in white tubs. The residue is less likely a problem associated with water quality than with naturally occurring airborne bacteria. The bacteria may produce a pinkish film, and sometimes a dark gray film, on surfaces that are regularly moist, including toilet bowls, shower heads, sink drains, and tiles. The problem is more common in humid areas of the country.

MAINTENANCE AND CARE

WATER QUALITY ISSUES (continued):

Pigmented Bacteria (continued)- In any particular case, the determination of the exact species of bacteria causing the problem would require lengthy and costly laboratory testing; however, most experts believe the bacteria responsible is *Serratia marcescens*. These bacteria thrive on moisture, dust and phosphates, and are widely distributed in soil, food and also in animals. The American Water Works Association suggests that short of buying pink fixtures, the best solution to keep these surfaces free from the bacterial film is continual cleaning. The AWWA recommends a chlorine containing the compound as the best cleaner and avoiding abrasives to avoid scratching fixtures, which will make them more susceptible to bacteria.

2. CHEMICAL QUALITY

The water supplied by individual wells or water systems always contains chemicals, usually in amounts below those which the consumer would notice. Examples of such chemicals, which are of potential concern for the owners of fill and drain whirlpool bathtubs, are calcium and magnesium salts, copper, iron, manganese and sulfates. When these chemicals are present in sufficient amounts, they may cause problems in whirlpool bathtubs. You should contact your water supply or treatment company and follow their suggestions for treatment.

Calcium and Magnesium Salts- Collectively, the various compounds of calcium and/or magnesium are referred to as salts. Calcium and magnesium salts are often found in ground water supplies and cause “hardness” in water. Hard and soft water are relative terms. Hard water retards the cleaning action of soaps and detergents, causing expense in the form of extra work and cleaning agents. When hard water is heated, it will deposit a hard scale. With regard to whirlpool bathtubs, high calcium and/or magnesium levels may result in the formation of white stains and scale formation on the inside of the tubs, especially noticeable with colored tubs. If this occurs, you need to contact the water supplier to determine the calcium and/or magnesium content and/or corrosion potential of the water and follow their suggestions for treatment. If you are on an individual well, you need to contact a water treatment company to test your water and suggest solutions if a problem is present.

Iron- Iron is found in many natural waters especially from wells. Iron in water can also result from the corrosion of piping in the water supply system, such as cast iron mains or galvanized steel service lines, or galvanized piping in the home water system. High iron levels may result in the formation of brown stains in the vicinity of the faucet outlets of various fixtures in the home. With whirlpool bathtubs, the staining may be particularly pronounced because the aeration action can oxidize iron to a form that settles out on the inside of the tubs, especially noticeable in white tubs. If high iron in the water is present, you can also notice rust colored deposits in your toilet tank or dishwasher. If this occurs, you need to contact the water supplier to determine the iron content and/or corrosion potential of the water and follow their suggestions for treatment. If you are on an individual well, you need to contact a water treatment company to test your water and suggest solutions if a problem is present.

Manganese- Manganese is found in many natural waters, especially from wells. High manganese levels may result in the formation of small black particles that can stain laundry, especially noticeable with whites such as sheets or towels. With whirlpool bathtubs, the formation of small black particles may be particularly pronounced because the aeration action in the tub can oxidize manganese to an insoluble form that is especially noticeable with white tubs. If high manganese in the water is present, you may also notice black stains on white laundry. If this occurs, you need to contact the water supplier to determine the manganese content of the water and follow their suggestions for treatment. If you are on an individual well, you need to contact a water treatment company to test your water and suggest solutions if a problem is present.

MAINTENANCE AND CARE

WATER QUALITY ISSUES (continued):

3. TREATMENT

If you have contacted your water supplier and followed its instructions and you are still having problems, you need to increase the frequency of applications of low-foaming detergent/bleach starting from bi-monthly purging down to using it every other day as required to eliminate your particular problem.

The use of certain bath oils, bubble baths and bath additives may increase the level of accumulations of bath residue in the whirlpool system. More frequent cleaning may be necessary if these products are used in the whirlpool tub. If excess accumulations persist, you should discontinue use of these products.

If you have followed the monthly purging instructions and still have an excess accumulation of bath residue and desire an alternative cleaning mechanism, we recommend **SUPER SYSTEMS CLEAN PLUS** manufactured by Stearns Packaging Corporation to rectify this condition. This may be obtained by contacting Aquatic Industries at (800) 555-5324. It is recommended that you follow the instructions provided by the manufacturer with the product. Repeated use may be necessary. **SUPER SYSTEMS CLEAN PLUS** does not replace the necessity to purge your whirlpool system at least twice a month with a low foaming detergent and bleach.

TROUBLESHOOTING GUIDE

WARNING: Always turn off power at the main electrical service panel when servicing your whirlpool.

SYMPTOMS	POSSIBLE PROBLEMS	SUGGESTED SOLUTIONS
Motor does not start	<ol style="list-style-type: none"> 1) GFCI or circuit breaker in OFF position. 2) Fuses blown or thermal overload open. 3) Locked motor shaft. 4) Motor windings burned out. 5) Defective starting switch inside single-phase motor. 6) Disconnected or defective wiring. 7) Low voltage. 	<ol style="list-style-type: none"> 1) Reset GFCI (if optional heater is installed, be sure there are two GFCI circuits.) 2) Contact your electrician. 3) Contact Aquatic Industries, Inc. 4) Contact Aquatic Industries, Inc. 5) Contact Aquatic Industries, Inc. 6) Check and reconnect if needed. 7) Contact your electrician.
Motor does not reach full speed	<ol style="list-style-type: none"> 1) Low voltage. 2) Motor windings connected for wrong voltage. 3) Wiring too small. 	<ol style="list-style-type: none"> 1) Contact your electrician. 2) Contact Aquatic Industries, Inc. 3) Contact your electrician.
Low pump pressure	<ol style="list-style-type: none"> 1) Pump running at reduced speed. 	<ol style="list-style-type: none"> 1) See above.
Motor overheats (protector trips)	<ol style="list-style-type: none"> 1) Low voltage. 2) Motor windings connected for wrong voltage. 3) Inadequate ventilation. 4) Wiring too small. 	<ol style="list-style-type: none"> 1) Contact your electrician. 2) Contact Aquatic Industries, Inc. 3) Refer to installer/dealer. 4) Contact your electrician.
Mood light doesn't function	<ol style="list-style-type: none"> 1) Not plugged in. 2) Bulb burned out. 3) Air hose has come off switch. 	<ol style="list-style-type: none"> 1) Plug in. 2) Replace bulb. 3) Refer to installer/dealer.
Pump delivers no water	<ol style="list-style-type: none"> 1) Jets are closed. 2) Leakage of air into suction system. 3) Impeller clogged. 	<ol style="list-style-type: none"> 1) Open jets. 2) Check suction screen for clogs. 3) Clean and unplug.
Low pump capacity	<ol style="list-style-type: none"> 1) Suction or discharge line partly plugged. 2) Pump running at reduced speed. 3) Impeller clogged. 	<ol style="list-style-type: none"> 1) Clean and unplug. 2) See "Motor does not reach full speed." 3) Clean and unplug.
Noisy pump and motor	<ol style="list-style-type: none"> 1) Worn motor bearings. 2) Pumps touching a stationary object. 3) Suction line partly plugged. 4) Pump not supported properly. 	<ol style="list-style-type: none"> 1) Contact Aquatic Industries, Inc. 2) Refer to installer/dealer. 3) Clean and unplug. 4) Contact Aquatic Industries, Inc. (If you have a remote pump, refer to installer/dealer.)
Leakage of water at shaft	<ol style="list-style-type: none"> 1) Shaft seal requires replacement. 	<ol style="list-style-type: none"> 1) Contact Aquatic Industries, Inc.
Leaking unions	<ol style="list-style-type: none"> 1) O-ring missing or damaged. 2) Plumbing in a bind. 3) Loose unions. 	<ol style="list-style-type: none"> 1) Contact Aquatic Industries, Inc. 2) Contact Aquatic Industries, Inc. 3) Tighten unions.
Vibration noise	<ol style="list-style-type: none"> 1) Tub or tub plumbing is touching tile/wall. 2) Pump is touching framing. 	<ol style="list-style-type: none"> 1) Refer to installer/dealer. 2) Refer to installer/dealer.

Model Number & Serial Number Location

The tub model and serial numbers are located above the pump area on the backside of the bathtub. Your installer should have a service access panel in this location. Look for a label which resembles the one on the right.

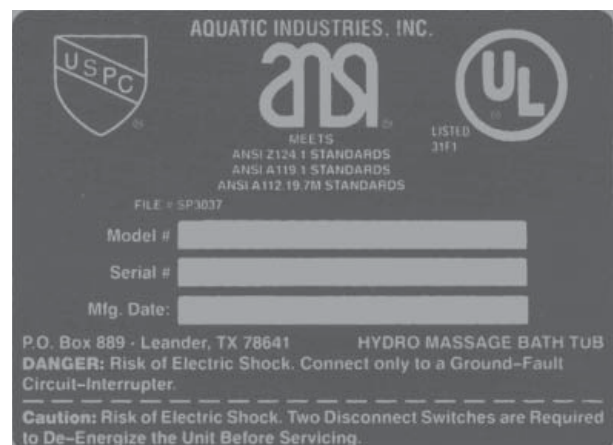



REPLACEMENT PARTS ORDER FORM

FOR LUXURY SERIES

How To Use:

1. Find your part on the map and make note of its number & letter.
2. Using map number and letter, choose part number and select color (or finish) on parts list provided on pages 29-30.
3. Fill out the form below with the selected information. Fax or send to Aquatic.
4. Call AQUATIC for parts pricing and shipping charges.

IMPORTANT!

The following information **MUST** accompany your order:

Serial Number, Model Number/Name, Purchase Date and Color

PLEASE FILL OUT COMPLETELY:

SHIP TO:

Name _____

Company _____

Address _____

City _____ State _____ Zip _____

Phone _____ Fax _____

BILL TO:

Name _____

Company _____

Address _____

City _____ State _____ Zip _____

Phone _____ Fax _____

Serial # (Invoice #) _____ Model Name _____

Model # _____ Color _____ Purchase Date _____

Quantity	Part No.	Description	Color/Finish	Price
_____	_____	_____	_____	_____
_____	_____	_____	_____	_____
_____	_____	_____	_____	_____
_____	_____	_____	_____	_____
_____	_____	_____	_____	_____

Mail orders to:

AQUATIC INDUSTRIES, INC.
P.O. Box 889 • Leander, TX 78646-0889
Phone (800) 928-3707 • Fax (888) 296-7450

LUXURY SERIES

REPLACEMENT PARTS ORDER MAP

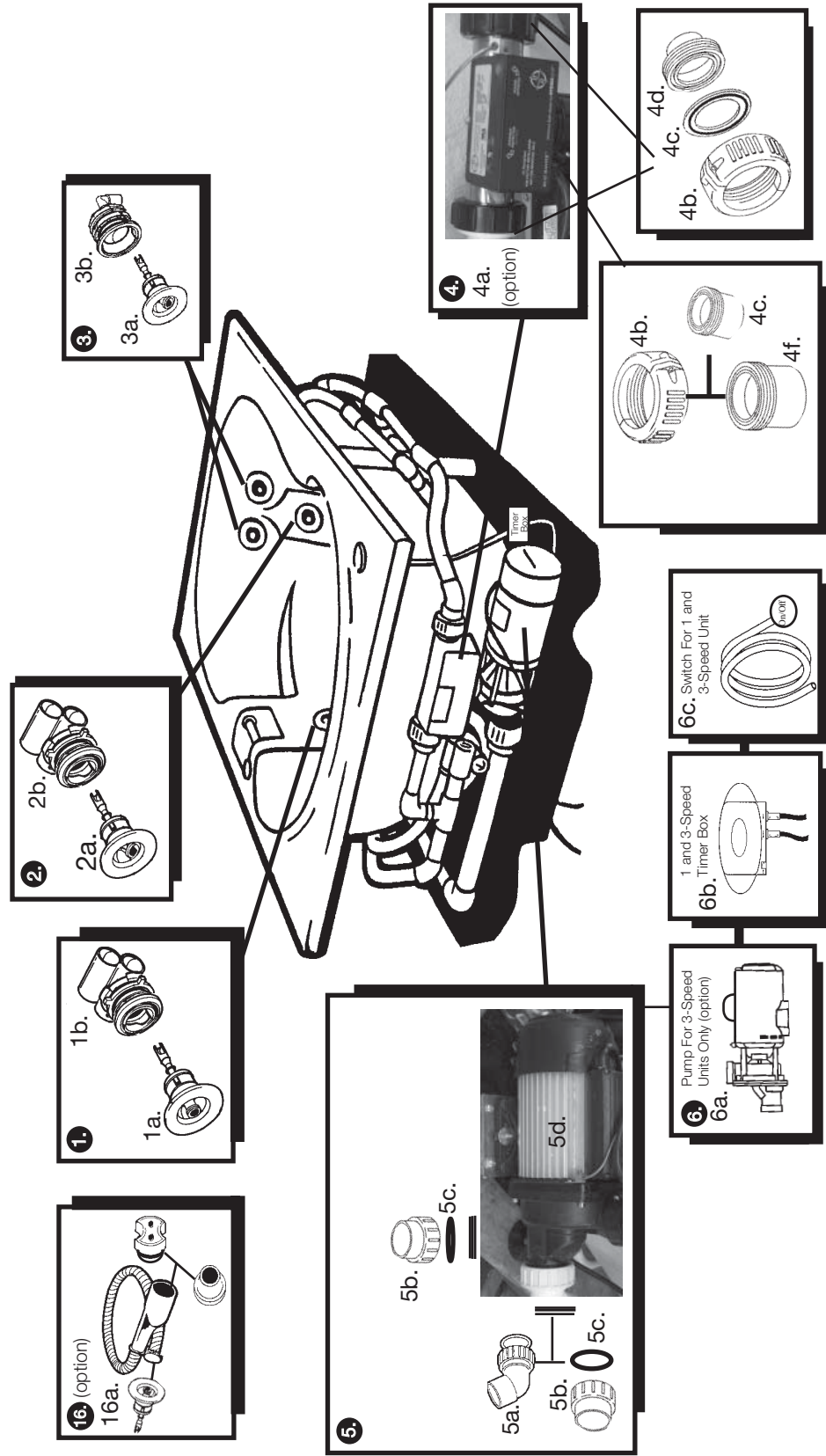

LUXURY SERIES

REPLACEMENT PARTS ORDER MAP/OVERVIEW

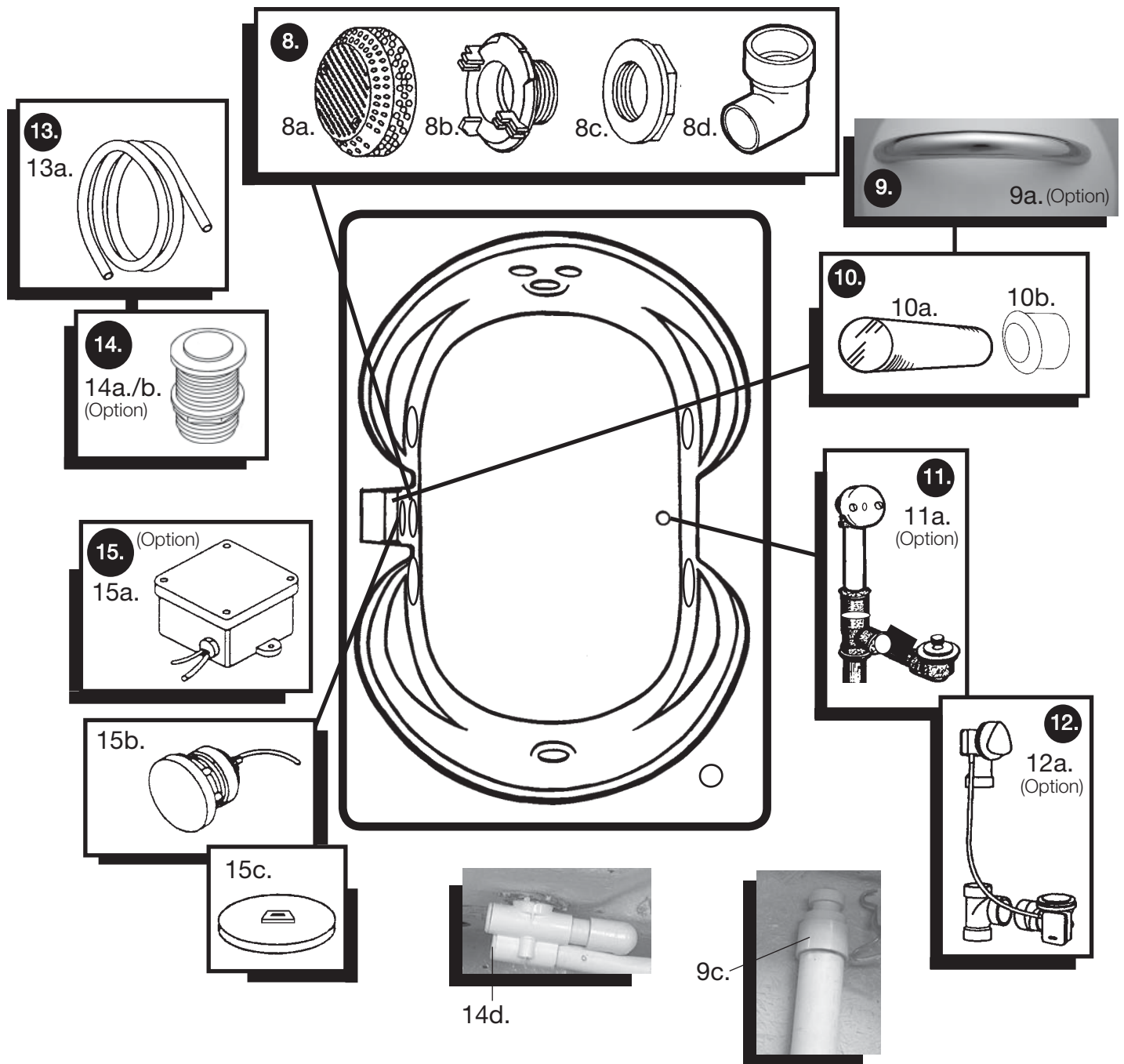

ASSORTED FITTINGS

FX101	FX102	FX103	FX104	FX105	FX106	FX107
Coupler	Y Fitting	Street 90°	90° fitting	T fitting	Street 45°	45° fitting
1" or 1 1/2"	1" only	1" or 1 1/2"	1" or 1 1/2"	1" or 1 1/2"	1" or 1 1/2"	1" or 1 1/2"

LUXURY BATH PARTS LIST

ILLUSTRATION NO.	DESCRIPTION	PART #	SPECIFY COLOR/FINISH/MODEL#
1a.	Full Size Directional Jet	87DIRECTXX	Specify Color
1b.	Full Size Directional Jet Fitting	87ASSYWH	White
	Full Size Directional Jet Fitting	87ASSYCL	Clear
2a.	Rotary Massage Jet	87SWIRLXX	Specify Color
2b.	Rotary Massage Jet Fitting	87ASSYWH	White
	Rotary Massage Jet Fitting	87ASSYCL	Clear
3a.	StressEaz Jet	85SWIRLXX	Specify Color
3b.	StressEaz Fitting	85ASSYWH	White
	StressEaz Fitting	85ASSYCL	Clear
4a. (option)	Maint. Heater (Stainless Heat Tube)	8095THEAT	---
4b.	2pc. Heater Split Nut	840055491FTG	---
4c.	Gasket / O-Ring	8722GASKET	---
4d.	1.5 in. x 1in. Tailpiece	8417SOCKET	---
4f.	1.5 in. Tailpiece	8417SPIGOT	---
5a.	65° Pump Union (incl O-ring)	8408FTG	---
5b.	1.5 in. Pump Union (incl O-ring)	8150UNION	---
5c.	Sweep "T"	8407FTG	---
5d.	1.5 HP-110V SS Pump	8108MOTOR	---
6a. (option)	2 HP-110V, 3-Speed Pump	8150MOTOR	---
6b.	1-Speed Timer Box	100820	---
(option)	3-Speed Timer Box	100390	---
6c.	On/Off Button	100667	---
8a.	Suction Cover	8152HVSUCVRXX	Specify Color/Finish
8b.	Suction Wall Fitting	8414FTG	White
	Suction Wall Fiting	8413FTC	Clear
8c.	Suction Nut	8411FTG	---
8d.	90 deg. (close fit)	8412FTG	---
9a. (option)	Bolt-On Grab Bar	901806GRAB	White
	Bolt-On Grab Bar	901807GRAB	Biscuit
	Bolt-On Grab Bar	901240GRAB	Chrome
	Bolt-On Grab Bar	901220GRAB	Brass
	Bolt-On Grab Bar	901210GRAB	Gold
	Bolt-On Grab Bar	901260GRAB	Satin Nickel
	Bolt-On Grab Bar	901270GRAB	Polished Nickel
	Bolt-On Grab Bar	901805GRAB	Oil Rubbed Bronze
9b.	1in. Check Valve Fitting	8441FTG	---
10a.	Grab Bar	9017WHGRAB	White
	Grab Bar	9017BIGRAB	Biscuit
	Grab Bar	901710GRAB	Chrome
	Grab Bar	901720GRAB	Brass
	Grab Bar	901740GRAB	Gold
	Grab Bar	901760GRAB	Satin Nickel
	Grab Bar	901770GRAB	Polished Nickel
	Grab Bar	901780GRAB	Oil Rubbed Bronze
	Grab Bar	4174ACROD	Clear Acrylic/Specify Model #
10b.	Grommet	4011GROMET	White
	Grommet	4013GROMET	Biscuit
	Grommet	4005GROMET	Clear
11a. (option)	Lift and Turn Waste & Overflow	93CPDWO	Chrome
	Lift and Turn Waste & Overflow	93PBDWO	Brass
	Lift and Turn Waste & Overflow	93SNDWO	Satin Nickel
	Lift and Turn Waste & Overflow	93PNDWO	Polished Nickel
	Lift and Turn Waste & Overflow	93PGDWO	Gold
	Lift and Turn Waste & Overflow	93ORBDWO	Oil Rubbed Bronze

LUXURY BATH PARTS LIST

<u>ILLUSTRATION NO.</u>	<u>DESCRIPTION</u>	<u>PART #</u>	<u>SPECIFY COLOR/FINISH/MODEL#</u>
12a. (option)	Geberit Cable Drive Waste & Overflow	---	Specify Color/Model #
13a.	Vinyl Tubing	8140HOSE	Specify Length
14a.	On/Off Air Button (Body)	8115BODY	
14b.	On/Off Air Button (Cap)	8115BUTTNXX	Specify Color
14d.	1in. Plug	8421FTG	---
15a. (option)	Light Transformer	8330LIGHT	---
15b. (option)	Light Wall Fitting (incl. socket)	8330LIGHT	---
15c. (option)	Lense Removal Tool	---	---
15d. (option)	Chromatherapy LED Light	1055	---
16a. (option)	Hand Held Jet	8AII5HHJET	Specify Color
FX101	1" Coupler	8429010FTG	---
FX101	1 1/2" Coupler	8429015FTG	---
FX102	1" Y Fitting	8415FTG	---
FX103	1" St. 90 degree Fitting	8406010FTG	---
FX103	1 1/2" St. 90 degree Fitting	8409015FTG	---
FX104	1" 90 degree Fitting	8406010FTG	---
FX104	1 1/2" 90 degree Fitting	8406015FTG	---
FX105	1" T Fitting	8401010FTG	---
FX105	1 1/2" T Fitting	8401015FTG	---
FX106	1" St. 45 degree Fitting	8411202FTG	---
FX106	1 1/2" St. 45 degree Fitting	8411404FTG	---
FX107	1" 45 degree Fitting	8417010FTG	---
FX107	1 1/2" 45 degree Fitting	8417015FTG	---

Aquatic Industries, Inc. Limited Lifetime Warranty

For Millennium, Infinity, Century, LuxeAir, and Luxury Series Whirlpools, Serenity Air Baths, Serenity Studio, HotSoak Series Baths and Restoration Series

Limited Warranty For Original Consumer For Household Usage

WHAT PRODUCTS ARE COVERED

Structures and surface finishes, pumps and blowers on the Millennium, Infinity, Century, LuxeAir, Luxury, Serenity Air Baths, Serenity Studio, HotSoak, and Restoration Series.

Warranty Periods for Specific Components

LIFETIME WARRANTY FOR WHIRLPOOL/AIR BATH/TUB SHELL, PUMP AND BLOWER

Aquatic Industries, Inc. extends to the original consumer purchaser of the acrylic, fiberglass reinforced shell, a non-transferable lifetime warranty that the shell will retain its structural integrity and configuration and be free of water loss due to a defect in the tub shell. The warranty covers the tub shell and the factory installed pump and blower against defects in material or workmanship. This warranty does not apply to all other components (attachments to the acrylic, fiberglass reinforced shell, such as plumbing, fittings and other apparatus) because these pieces are covered below under a 2 Year Warranty.

LIFETIME SURFACE WARRANTY FOR FACE OF WHIRLPOOL/AIR BATH/TUB

The interior surface is warranted against fading, blistering, cracking and delamination due to defects in the surface materials for life. This surface warranty extends to defects due to surface material mixing or molding. This surface warranty does not apply to fading, cracking, delamination or blistering due to *excessive wear, sun fading or scouring due to cleaning*.

2 YEAR EQUIPMENT WARRANTY FOR SUPPORT EQUIPMENT, COMPONENTS, CONTROLS & PLUMBING EQUIPMENT

All support equipment; components, controls and plumbing equipment are warranted for 2 years from date of purchase, but not more than 3 years from date of manufacture, against defects in workmanship and materials. Light bulbs, fuses and pillows are not included in this two-year period. However, these accessories are warranted to be free from defects in materials and workmanship at the time of delivery to the original purchaser. Limited labor is covered for 2 years from purchase, but never more than 3 years from date of manufacture, for limited labor on the support equipment, controls, and plumbing.

EXCLUSIVE REMEDY

Aquatic Industries, Inc. will, **at its option**, repair or replace (without removal or installation) the affected components of any defective Unit or System; repair or replace (without removal or installation) the entire defective Unit or System; or refund the then-current list price of the Whirlpool, Air Bath, or Tub. In all cases, a reasonable time period must be allowed for warranty repairs to be completed.

WHAT YOU MUST DO

In order to make a claim under these warranties:

1. You must be the original consumer purchaser of the Whirlpool, Air Bath, or Tub.
2. You must promptly notify us within the warranty period of any defect and provide us with any substantiation that we may reasonably request.
Write to: **Aquatic Industries, Inc. P.O. Box 889 Leander, TX 78646.**
3. The Whirlpools, Air Baths, and Tubs must have been installed and maintained in accordance with good industry practice and the specific Aquatic Industries, Inc. directions contained in the Owner's Manual and Installation Guide.

EXCLUSIONS

These warranties do **not** extend to or do **not** cover defects caused by:

1. Shipping damage by carriers or installation errors.
2. Accident, acts of God, abuse or misuse.
3. Unreasonable use (including any use for non-bathing purposes or failure to provide reasonable and necessary maintenance as specified in Aquatic Industries, Inc. Owner's Manual and Installation Guide supplied with the Whirlpool, Air Bath or Tub).
4. Any alteration, customization, or modification of the Whirlpool/Air Bath/Tub or its components.

LIMITATIONS

1. AQUATIC INDUSTRIES, INC. whirlpools and tubs sold for industrial, commercial and hotel use are warranted for two years, but not more than 3 years from date of manufacture, with a 2 year limited warranty that the shell will retain its structural integrity and configuration and be free of water loss due to a defect in the tub. The interior surface/face of the whirlpool/air bath/tub is warranted against fading, blistering, cracking and delamination due to defects in the surface materials for 2 years as well. All support equipment, components, controls and plumbing equipment and limited labor on the support equipment, controls, or plumbing are warranted for 1 year from date of purchase, but not more than 2 years from date of manufacture. Pump seals, "O" rings, light bulbs, fuses and pillows are not included in this two-year period. However, these accessories are warranted to be free from defects in materials and workmanship at the time of delivery to the original purchaser.
2. **In all cases, AQUATIC INDUSTRIES, INC. reserves the right to fully satisfy its obligations under the Limited Warranties by refunding the then-current list price of the defective Whirlpool, Air Bath, or Tub (or, if the Whirlpool, Air Bath, or Tub has been discontinued, of the most nearly comparable current product).**
3. THESE WARRANTIES ARE NON-TRANSFERABLE TO ANY OTHER PURCHASER OR PARTY OTHER THAN THE ORIGINAL CONSUMER. NO OTHER AGENT OR PARTY CAN GIVE ANY OTHER WARRANTY OR PROMISE. THIS IS THE SOLE WARRANTY FOR YOUR AQUATIC INDUSTRIES, INC. PRODUCT.
4. AQUATIC INDUSTRIES, INC. will not cover any installation or reinstallation costs related to this warranty, except under the limited labor allowance under the 2 Year Equipment Warranty above.

GENERAL

This warranty gives you specific legal rights; you may also have other rights, which vary from state to state. THE DURATION OF ANY IMPLIED WARRANTIES, INCLUDING THE IMPLIED WARRANTIES OF MERCHANTABILITY AND FITNESS FOR A PARTICULAR PURPOSE, ARE LIMITED TO THE DURATION OF THE EXPRESS WARRANTIES HEREIN. AQUATIC INDUSTRIES, INC. EXPRESSLY EXCLUDES INCIDENTAL AND CONSEQUENTIAL DAMAGES, TO INCLUDE LOSS OF TIME, INCONVENIENCE, OR LOSS OF USE OF RESIDENCE, FOR ANY BREACH OF THE EXPRESS OR IMPLIED WARRANTY, INCLUDING THE IMPLIED WARRANTIES OF MERCHANTABILITY OR FITNESS FOR A PARTICULAR PURPOSE.

SOME STATES DO NOT ALLOW ANY LIMITATION ON HOW LONG AN IMPLIED WARRANTY LASTS, OR THE EXCLUSION OR LIMITATION OF INCIDENTAL OR CONSEQUENTIAL DAMAGES; SO THE ABOVE EXCLUSION MAY NOT APPLY TO YOU.

AQUATIC

P.O. Box 889 Leander, Texas 78646-0889 • 11880 RR 2243 W Leander, Texas 78641
(800) 555-5324 FAX: (800) 421-3633 Fax-On-Demand: (877) 618-7024
www.aquaticwhirlpools.com

Revision #14 12/07