



Ceramic/Impressions®

Vitreous Top and Basin Bathroom Sink
K-2891-8

Features

- Vitreous China
- Integrated top and bowl
- With overflow
- 8" (203mm) widespread faucet holes
- 49" (1245 mm) x 22-3/8" (568 mm)



Codes/Standards

ASME A112.19.2/CSA B45.1

KOHLER® One-Year Limited Warranty

See website for detailed warranty information.

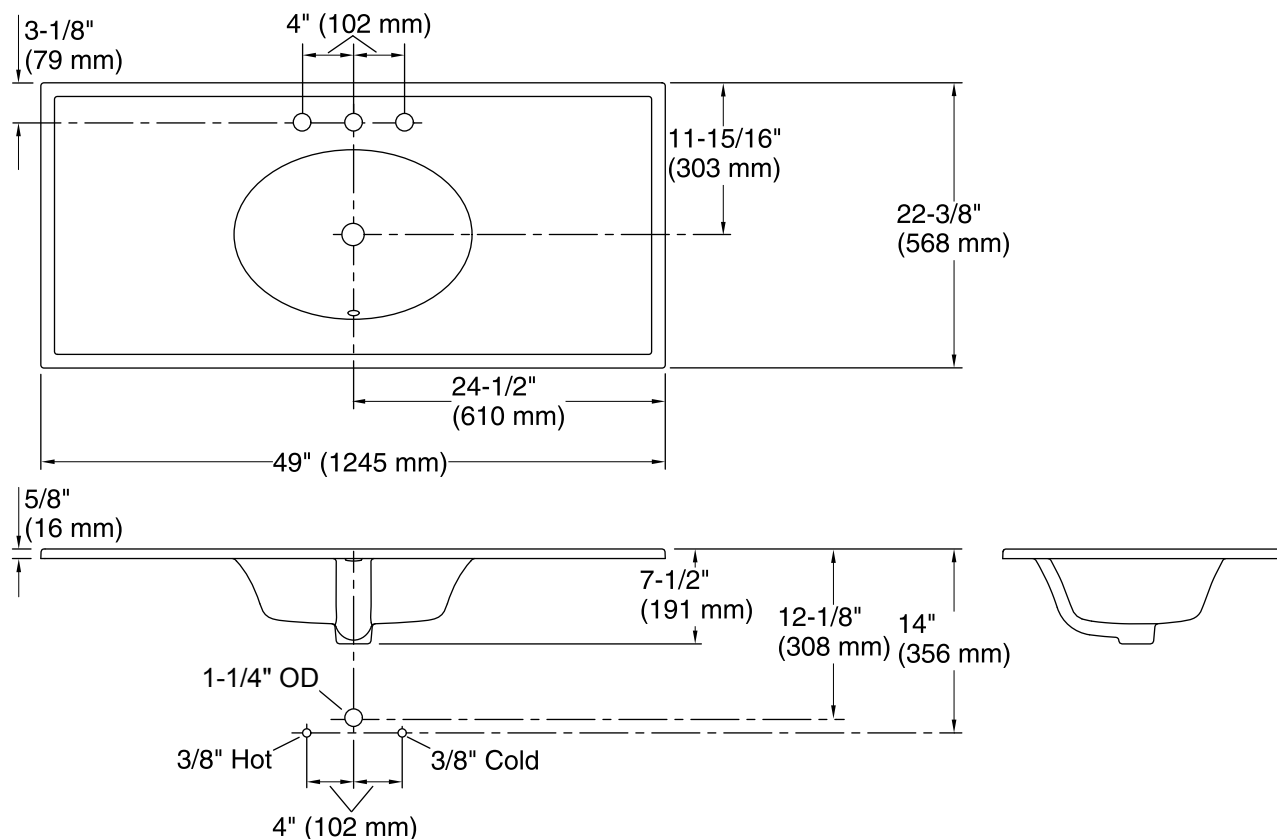

Technical Information

All product dimensions are nominal.

Bowl configuration: Single

Installation: Vanity top

Bowl area (Only) Length: 19" (483 mm)
Width: 13-3/8" (340 mm)
Bowl depth: 5-1/2" (140 mm)
Water depth: 4" (102 mm)

Number of deck holes: 3

Faucet hole(s): 1-3/8" (35 mm)

Drain hole: 1-3/4" (44 mm)

Notes

Install this product according to the installation guide.

This sink is designed to be installed as an integrated vanity top to a KOHLER or standard vanity.