



## Horizontal Conversion Kit

Kits used to convert 4PXC\*U dedicated Upflow coil to Horizontal Left or convert 4PXC\*D dedicated Downflow coil to Horizontal Right

**BAYCONV18A**

**BAYCONV23A**

**BAYCONV27A**

**BAYCONV30A**

**ALL phases of this installation must comply with NATIONAL, STATE AND LOCAL CODES**

**IMPORTANT**—This Document is **customer property** and is to remain with this unit. Please return to service information pack upon completion of work.

### ⚠ WARNING

**WARNING (Medium/high pressure)**

**Contains Refrigerant!**

System contains oil and refrigerant under high pressure. Recover refrigerant to relieve pressure before opening the system. See unit nameplate for refrigerant type. Do not use non-approved refrigerants, refrigerant substitutes, or refrigerant additives.

Failure to follow proper procedures or the use of non-approved refrigerants, substitutes, or refrigerant additives could result in death, serious injury, or equipment damage.

### ⚠ CAUTION

*Caution: This coil is pressurized with 8-12 psig of dry air. Do not stand directly in front of the coil connections when removing sealing plugs. If no pressure is released, check for leaks.*

#### **IMPORTANT:**

*To ensure maximum performance, make sure the arrow label on the coil cabinet matches the furnace airflow.*

### A. GENERAL

These kits are designed for use in combination with a 4PXC coil to convert the coil for horizontal use. Dedicated upflow coils may only be converted to horizontal left and dedicated downflow coils may only be converted to horizontal right.

The 4PXC equipment has been evaluated in accordance with the Code of Federal Regulations, Chapter XX, Part 3280 or the equivalent. "Suitable for Mobile Home use" The height of the Furnace, Coil and discharge duct work must be 7 ft. or less.

Inspect the kit components for shipping damage. Notify the transportation company immediately if the coil is damaged.

### B. KIT COMPONENTS

Item	Qty	Description
1	1	Horizontal Drain Pan
2	2	Condensate Drain Plugs
3	1	Splash Guard
4	1	Channel for Splash Guard

**NOTE:** All items are used for horizontal left conversion. Only items 1 and 2 are used for horizontal right conversion.

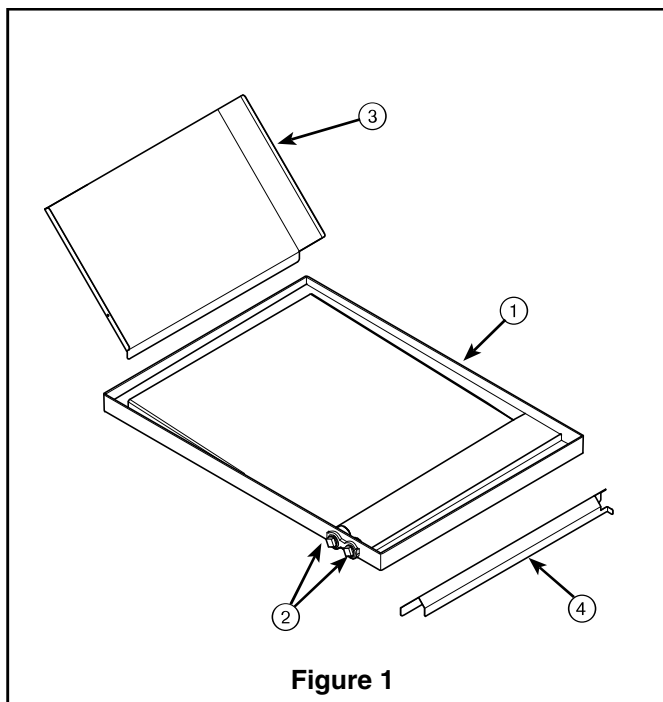

# Installer's Guide

## C. APPLICATION INFORMATION

### 1. FURNACE AND COIL

The coil **MUST BE** installed downstream (in the outlet air) of the furnace. The coil apex can face into or away from the direction of the airflow, depending on horizontal left or right application.

See the table below to verify the coil and kit match. The application specific sections will show what changes are needed for the coils.

Model Number	Horizontal Kit No.
4PXCAU18AC3HAA 4PXCBU18AC3HAA 4PXCAU24AC3HAA 4PXCBU24AC3HAA 4PXCBU30AC3HAA 4PXCCU30AC3HAA	BAYCONV18A
4PXCAD18AC3HDA 4PXCBD18AC3HDA 4PXCAD24AC3HDA 4PXCBD24AC3HDA 4PXCBD30AC3HDA 4PXCCD30AC3HDA	
4PXCBU36AC3HAA 4PXCCU36AC3HAA	
4PXCBD36AC3HDA 4PXCCD36AC3HDA	
4PXCBU42AC3HAA 4PXCCU42AC3HAA 4PXCBU48AC3HAA 4PXCCU48AC3HAA 4PXCDD48AC3HAA	
4PXCBD42AC3HDA 4PXCCD42AC3HDA 4PXCBD48AC3HDA 4PXCCD48AC3HDA 4PXCDD48AC3HDA	
4PXCCU60AC3HAA 4PXCDD60AC3HDA	
4PXCDD60AC3HDA	BAYCONV23A
4PXCDD60AC3HDA	BAYCONV27A
4PXCDD60AC3HDA	BAYCONV30A

## D. RECOMMENDATION

Use the Installer's Guide packaged with the coil for the physical installation of the coil.

If a coil is part of the total system installation, use the Installer's Guide packaged with the furnace, outdoor section, and thermostat for physically installing those components.



## CAUTION

**Caution:** This coil is pressurized with 8-12 psig of dry air. Do not stand directly in front of the coil connections when removing sealing plugs. If no pressure is released, check for leaks.

## IMPORTANT:

To ensure proper operation, make sure the arrow label on the coil cabinet matches the furnace airflow.

## E. CONVERSION OF THE DEDICATED UPFLOW COIL FOR HORIZONTAL LEFT AIRFLOW APPLICATIONS.



## CAUTION

Both the coil and furnace must be fully supported. Do not attempt to suspend the coil using the alignment brackets.

1. HORIZONTAL LEFT COIL CONVERSION (All coils)
  - a. Remove coil front panels.
  - b. Slide out the coil assembly.
  - c. Remove the coil retainer bracket.

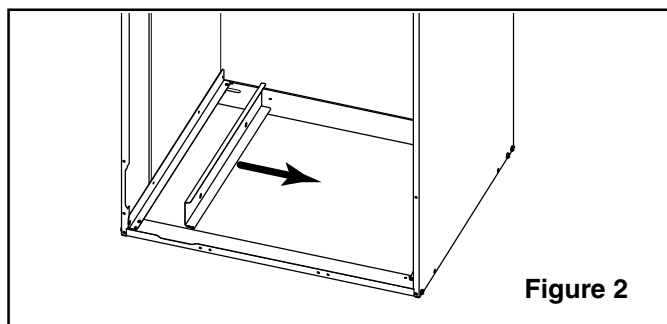

Figure 2

- d. Place U-channel into drain pan. See Figure 3.

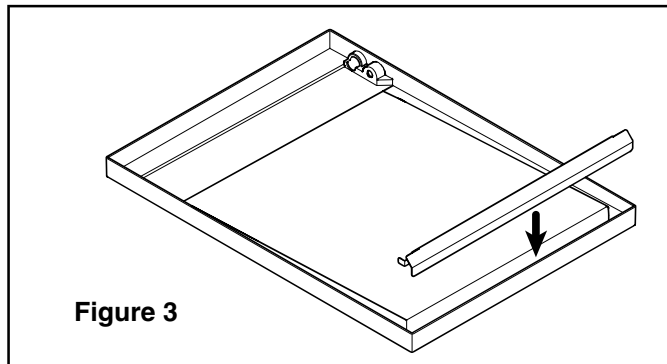

Figure 3

- e. Slide the new horizontal drain pan onto the coil and slide back into the coil cabinet. See Figure 4.

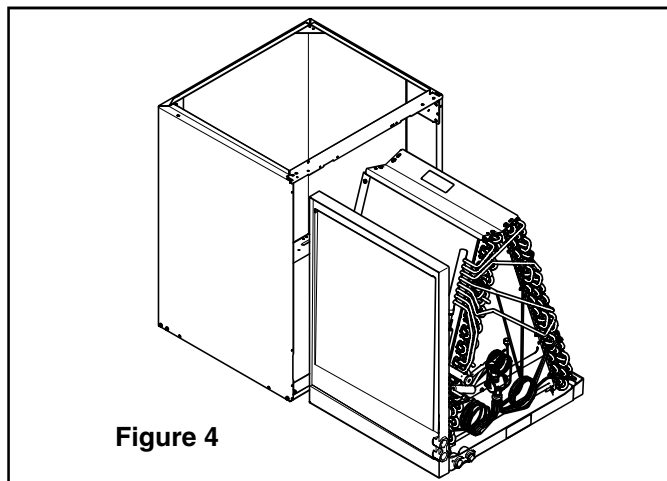
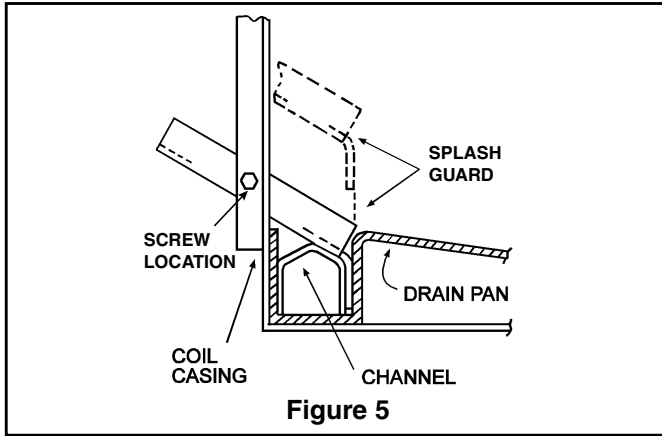

Figure 4

f. The splash guard packaged with the coil is for horizontal left coil installation only. The guard has a bend which is inserted into the front channel of the horizontal drain pan on the outlet air side of the coil case. The guard is then rotated downward until it rests in the drain pan. One field supplied sheet metal screw is driven through the coil case duct flange on the front side and into the splash guard side hole. See Figure 5.



**NOTE:** In horizontal left, the 4PXC coil case is rotated so the apex of the coil is away from the furnace.

**NOTE:** The two piece baffle ships installed on the coil and is required for horizontal left applications.

g. Attach the coil to the furnace. Horizontal right furnaces will require connection brackets if no furnace flange is present. See Figure 6.

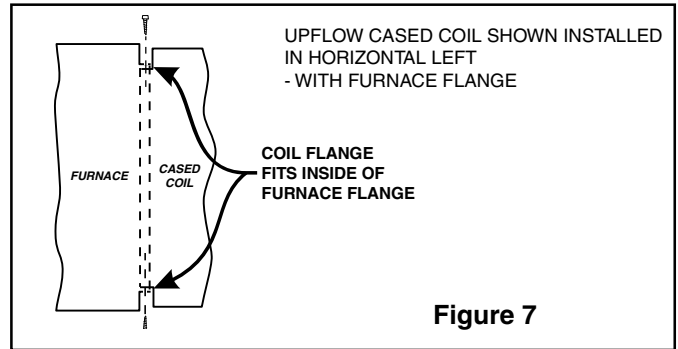
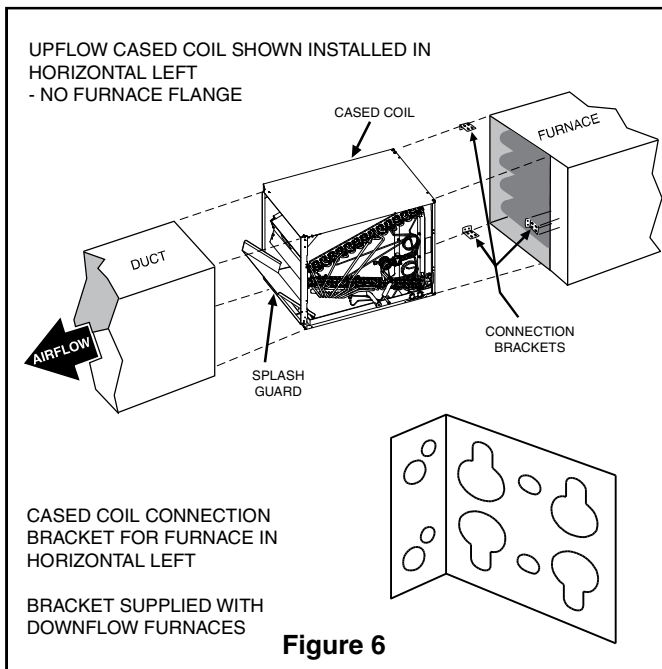

## CAUTION

**Both the coil and furnace must be fully supported. Do not attempt to suspend the coil using the alignment brackets.**

- h. Cut insulation on the panel for horizontal drain pan. Remove the cap.
- i. Remove the plugs from the horizontal drain pan.
- j. Install plugs into the upflow drain pan.

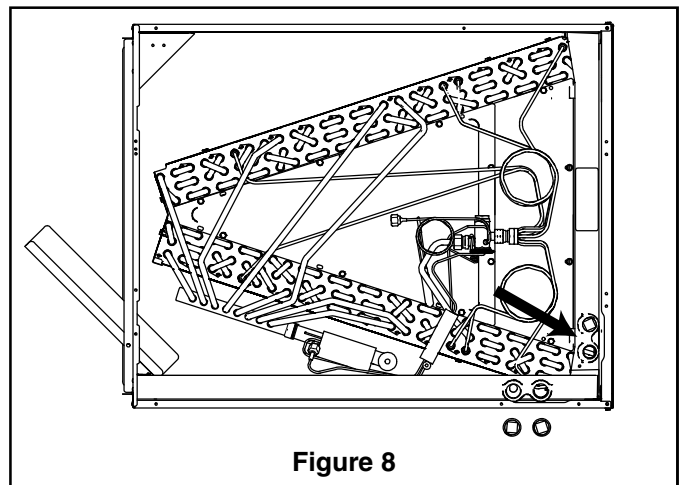

## F. MAXIMUM AIRFLOW SETTING, CFM, UPFLOW

**NOTE:** Water blow-off could occur in certain installation positions if the airflow setting exceeds the maximum values listed.

Maximum airflow setting, CFM		
Coil	Upflow	Horizontal Left
4PX*U18AC3HAA	675	600
4PX*U24AC3HAA	900	800
4PX*U30AC3HAA	1125	1000
4PX*U36AC3HAA	1350	1200
4PX*U42AC3HAA	1575	1400
4PX*U48AC3HAA	1800	1600
4PX*U60AC3HAA	2250	2000
* May be "A", "B", "C", or "D"		

## G. CONVERSION OF THE DEDICATED DOWNFLOW COIL FOR HORIZONTAL RIGHT APPLICATIONS.

### ⚠ CAUTION

**Both the coil and furnace must be fully supported.**

1. HORIZONTAL RIGHT COIL CONVERSION (All coils)
  - a. Remove coil front panels.
  - b. Slide out the coil assembly.
  - c. Remove the coil retainer bracket.
  - d. For the 4PXCCD060 and 4PXCDD060 Coils Only, the (2) outer water diverter baffles should be removed for maximum efficiency. See Figure 9.

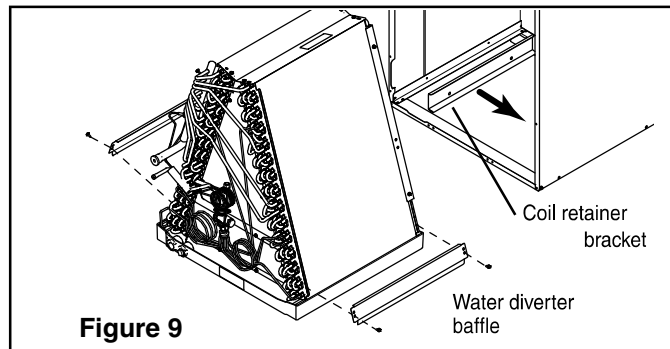
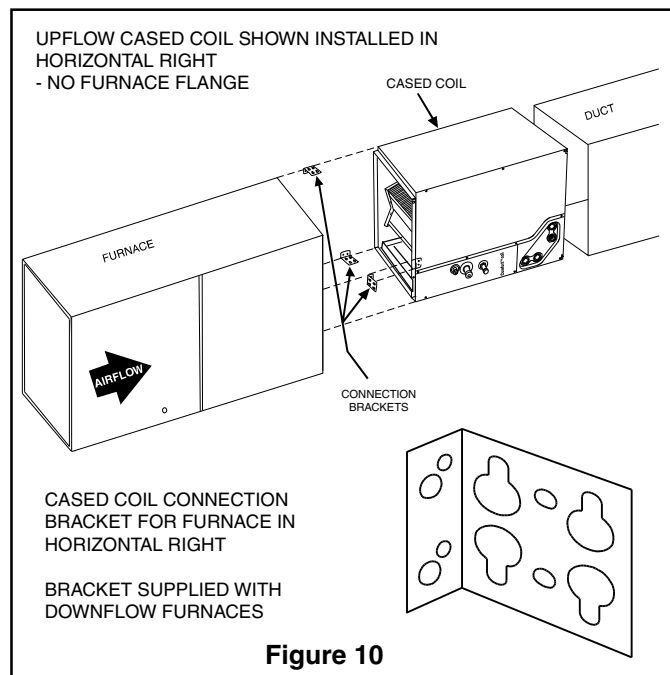

**Figure 9**

- e. Slide the new horizontal drain pan onto the coil and slide back into the coil cabinet.

**NOTE: In horizontal right, the 4PXC coil case is rotated so the apex of the coil will point toward the furnace airflow. The auxiliary drain pan is now on the lower side.**

- f. Attach the coil to the furnace. Horizontal left furnaces will require connection brackets if no flange is present. See Figure 10.



Trane Inc.  
6200 Troup Highway  
Tyler, TX 75707

For more information contact  
your local dealer (distributor)

UPFLOW CASED COIL SHOWN INSTALLED  
IN HORIZONTAL RIGHT  
- WITH FURNACE FLANGE

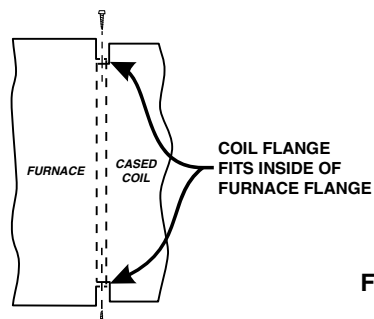
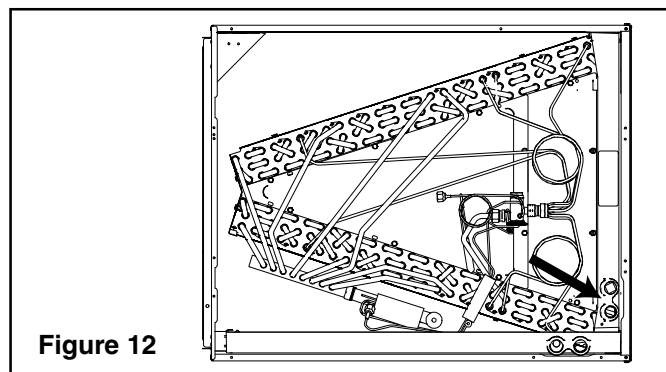

**Figure 11**

### ⚠ CAUTION

**Both the coil and furnace must be fully supported. Do not attempt to suspend the coil using the alignment brackets.**

- g. Cut insulation on door for horizontal drain pan. Remove the cap.
- h. Remove the plugs from the horizontal drain pan.
- i. Install plugs into the downflow drain pan.



### ⚠ CAUTION

**Caution: This coil is pressurized with 8-12 psig of dry air. Do not stand directly in front of the coil connections when removing sealing plugs. If no pressure is released, check for leaks.**

## H. MAXIMUM AIRFLOW SETTING, CFM, DOWNFLOW

**NOTE: Water blow-off could occur in certain installation positions if the airflow setting exceeds the maximum values listed.**

Maximum airflow setting, CFM		
Coil	Downflow	Horizontal Right
4PX*D18AC3HDA	550	675
4PX*D24AC3HDA	750	900
4PX*D30AC3HDA	925	1125
4PX*D36AC3HDA	1100	1350
4PX*D42AC3HDA	1300	1575
4PX*D48AC3HDA	1475	1800
4PX*D60AC3HDA	1850	2250

\* May be "A", "B", "C", or "D"

Since the manufacturer has a policy of continuous product and product data improvement, it reserves the right to change design and specifications without notice.