

1/4" x 1 3/8" Clevis Pin with Holes - CP-42

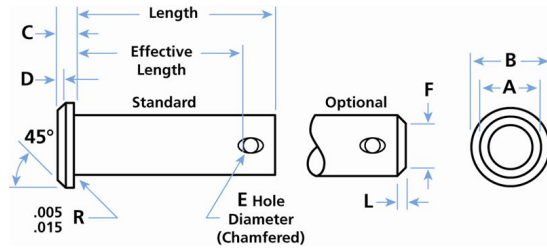

PRODUCT DETAILS

Basic Shank Diameter [in]	1/4
Length under Head: To Edge of Hole (Approx.) [in]	1.234
Length under Head: To Center of Hole (Approx.) [in]	1.281
Shank Diameter - A	0.243 to 0.248
Length [in]	1 3/8
Head Diameter - B [in]	0.370
Head Height - C [in]	0.090
Head Chamfer - D [in]	0.030
Pivot Point Std. Hole - E [in]	3/32
Optional Point Diameter - F [in]	0.200
Optional Point Length - L [in]	0.045
Weight per 100 Pieces (Approx.) [lb]	2.060
Material	Plain Finish Steel
Finish	Plain Finish
Note	Plating may add, up to, .001" to diameter of pin

Need pricing or samples? Just send this sheet to mail@pivotpins.com. We're happy to help!



761 Industrial Lane
P.O. Box 488
Hustisford, WI 53034

[f](#) [t](#) [g+](#) [in](#)

(800) 222-2231
(920) 349-3251 Int.
(920) 349-3253 Fax
mail@pivotpins.com