

# GUTTER DRAINS

**FUNCTION:** Used in gutters where a drain is required for connecting to the downspout leader. Flashing arrangement design permits removal of dome or flat strainer without disturbing flashing clamp and gutter liner.

<b>FLAT STRAINER</b> Does not obstruct traffic	<b>LOW DOME</b> Intercepts debris and allows adequate drainage in gutters and valleys	<b>HIGH DOME</b> Used where an abnormal amount of debris is anticipated
---	--	--

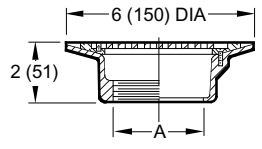

Fig. 1610T  
Free Area: 7 SQ IN (45) SQ CM

## BOTTOM OUTLET

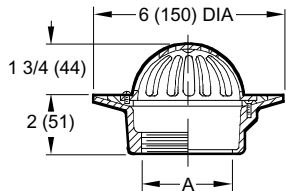

Fig. 1620T  
Free Area: 8 SQ IN (52) SQ CM

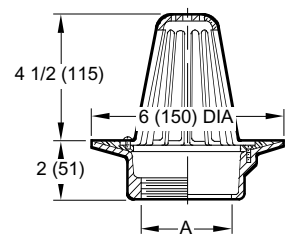

Fig. 1630T  
Free Area: 24.5 SQ IN (158) SQ CM

A SIZE	02 (50)	02 (50)	03 (75)	04 (100)
OUTLET	Thread	Caulk	Thread	Thread
2"(51) Deep Body	✓	✓	✓	-
4"(100) Deep Body	✓	✓	✓	✓

**REGULARLY FURNISHED:**  
 2" (51) Deep Body  
 Threaded Outlet

## 45° OUTLET

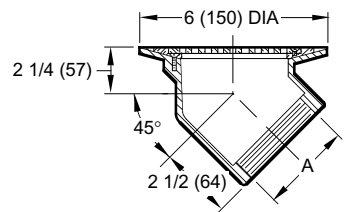

Fig. 1640T  
Free Area: 7 SQ IN (45) SQ CM

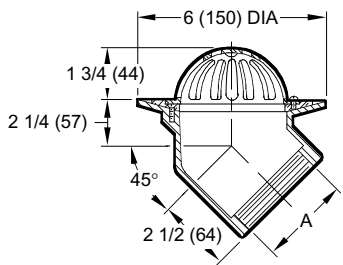

Fig. 1650T  
Free Area: 8 SQ IN (52) SQ CM

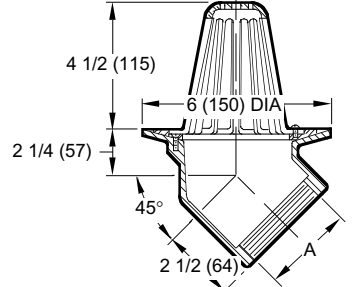

Fig. 1660T  
Free Area: 24.5 SQ IN (158) SQ CM

Available In Threaded Outlet Only  
 A (Pipe Size) = 02(50), 03(75) or 04(100)

## SIDE OUTLET

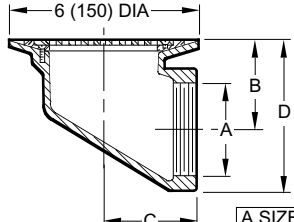

Fig. 1670T  
Free Area: 7 SQ IN (45) SQ CM

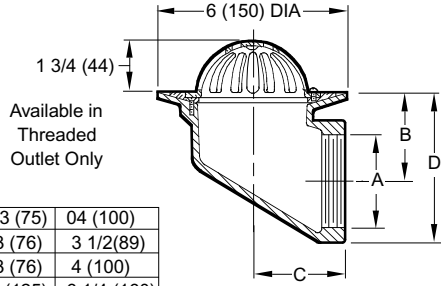

Fig. 1680T  
Free Area: 8 SQ IN (52) SQ CM

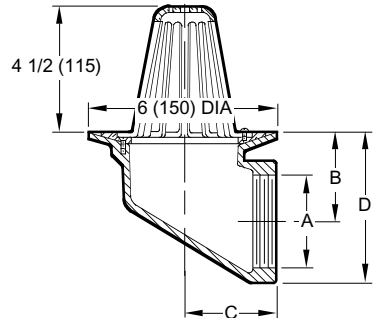

Fig. 1690T  
Free Area: 24.5 SQ IN (158) SQ CM

**REGULARLY FURNISHED:**  
 Duct Cast Iron Body with Bronze Flashing Clamp and Bronze Top Secured with Brass Screws.

**VARIATIONS:**  
 4" (100) Deep Body -B4 (Fig. 1610, 1620, 1630 only)  
 Vandal Proof Screws -U

**OPTIONAL MATERIALS:**  
 Galvanized Cast Iron Body -G  
 Nickel Bronze Top -NB  
 Polished Bronze Top -PB  
 Bronze Body -BB

**NOTE:** Dimensions shown in parentheses are in millimeters.

**1600 Series**  
 DRAWING NUMBER: S1600  
 SIZE: A  
 SCALE: NONE  
 DATE: 5-24-85  
 APPROVED BY: TD  
 CHECKED BY: TD  
 DRAWN BY: CR  
 DIMENSIONS ARE SUBJECT TO MANUFACTURERS TOLERANCE AND CHANGE WITHOUT NOTICE  
 WE CAN ASSUME NO RESPONSIBILITY FOR USE OF SUPERSEDED OR VOID DATA

F	7-14-05	Revised Function	RN	CL	WEIGHT POUNDS	VOLUME CUBIC FEET	FIGURE NUMBER <b>1600 Series</b>
E	6-16-99	Revised Millimeters	CMD	BS			
D	1-20-97	Rev Table & chg'd Opt Mat	EMB	BS			
C	6-13-95	Added Millimeters	EMB	BS			
B	6-30-94	Revised	EMB	BS			
REV.	DATE	DESCRIPTION	BY	CKD. BY			