

DAYTON SPECIFICATIONS

Dayton® Hospitality Sinks and Sink Package Models D11515, D11516 and DP211515C

GENERAL

Sink bowl seamlessly formed of #23 gauge, nickel bearing stainless steel. Self-rimming.

DESIGN FEATURES

Bowl Depth: 5-1/8".

Coved Corners: 2-1/4" vertical and horizontal radius.

Bowl and Faucet Deck Recess: 3/16" total recess below outside edge of sink.

Finish: Exposed surfaces are polished to a satin finish with highshine bowl radius.

Underside: Undercoated as described below.

Self-rimming: Sink is furnished with appropriate number of clips and screws to provide a secure installation.

SINK PACKAGE

DP211515C Package includes:

- (1) **D11515** sink.
- (1) **LKA2475** gooseneck faucet. Overall height, 7-9/16".
- (1) **D5018A** drain with basket strainer.

OTHER

Drain Opening: 2" (D11515, D611515 and DP211515C), 3-1/2" (D11516).

NOTE: Unless otherwise specified, sink is furnished with 2 faucet holes as shown.

These sinks comply with ANSI Standard A112.19.3.



These sinks are listed by the International Association of Plumbing and Mechanical Officials as meeting the requirements of the Uniform Plumbing Code.



These sinks are listed with the Canadian Standards Association.



This faucet is classified by Underwriters Laboratories Inc. to NSF/ANSI61 for residential use.

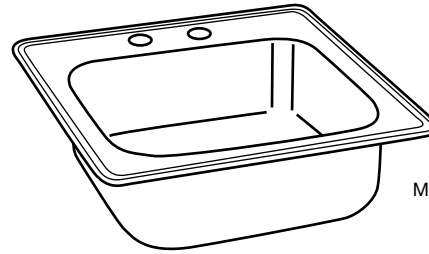

Model D115152

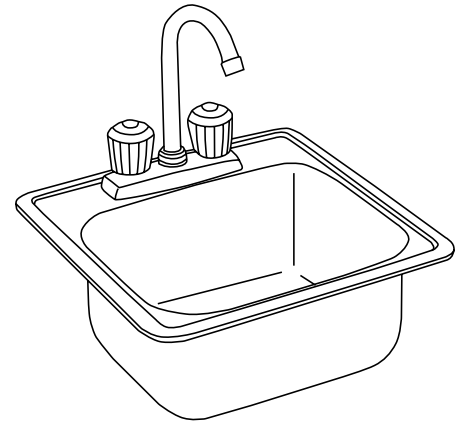

Model DP211515C

SINK DIMENSIONS (INCHES)*

Model Number	Overall		Inside Bowl			Cutout in Countertop 1 1/2" Radius Corners		No. of Faucet Holes 1 1/4" or 1 1/2" Dia. 4" Center	Minimum Cabinet Size
	L	W	L	W	D	L	W		
DP211515C	15	15	12	10	5 1/8	14 3/8	14 3/8	2	18
D11515	15	15	12	10	5 1/8	14 3/8	14 3/8	1, 2 or 3	18
D11516	15	15	12	10	5 1/8	14 3/8	14 3/8	1, 2 or 3	18
D611515	15	15	12	10	5 1/8	14 3/8	14 3/8	1 or 2	18

*Length is left to right. Width is front to back.

D-Prefix sinks are packed one per shipping carton. Sink bowl is fully undercoated to dampen sound and prevent condensation.

D6-Prefix sinks are nested 6 units per shipping carton. Sink bowls are sound deadened on bottom only.

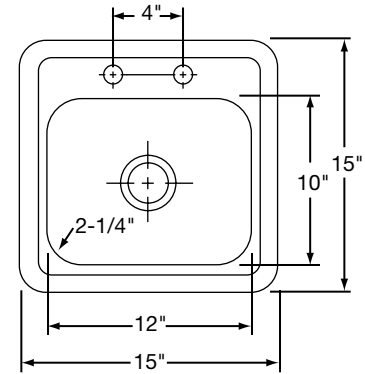

Bowl Depth is 5-1/8"
Model D115152 Illustrated

HOLE DRILLING CONFIGURATIONS

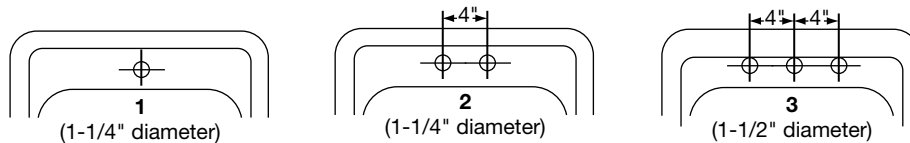

ALL DIMENSIONS IN INCHES, TO CONVERT TO MILLIMETERS MULTIPLY BY 25.4.

In keeping with our policy of continuing product improvement, Elkay reserves the right to change product specifications without notice.

This specification describes an Elkay product with design, quality and functional benefits to the user. When making a comparison of other producers' offerings, be certain these features are not overlooked.

Elkay

elkayusa.com

2222 Camden Court
Oak Brook, IL 60523

Printed in U.S.A.
©2006 Elkay

(Rev. 5/06)

2-3G