



HYMAX[®] GRIP

COUPLING RESTRAINT (1.5"-12")

HYMAX[®]
Repair the past. Connect the future.

INSTALLATION INSTRUCTIONS

DO NOT DISASSEMBLE THE COUPLING. DO NOT LUBRICATE THE BOLTS.

GENERAL INSTRUCTIONS:

THE HYMAX GRIP COUPLING IS A STAB-ON TYPE RESTRAINT THAT IS APPROVED FOR USE WITH METAL AND PLASTIC PIPES.

WARNING: DO NOT ATTEMPT TO USE THE HYMAX GRIP ON AC OR FRP PIPE!

PRECAUTIONS FOR HDPE PIPE: THE USE OF FULL CIRCLE STIFFENERS IS REQUIRED WHEN USING THE HYMAX GRIP ON HDPE PIPE.

FOR OTHER MATERIALS, PLEASE CONTACT KRAUSZ USA OR YOUR KRAUSZ DEALER.

NOTE: This is a unique SLIP-ON product. Pipe can slide all the way through the product without stoppage (as long as the pipe is within the indicated size range.)

STEP 1

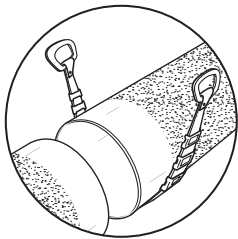

Prepare both pipe ends of the pipe by de-scaling if required. Clean the pipe as required with water. Make sure that the pipe is clean from debris and defects that interfere with HYMAX's proper seal.

NOTE: Except steel, PVC, and PE pipes, all rough-surfaced pipes must be lubricated with a water-based gasket lubricant in order to achieve a proper seal.

STEP 2

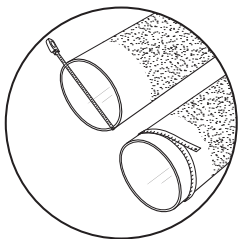

Measure the pipe's outer diameter and make sure the coupling's size fits properly.

NOTE: Each coupling's size range is shown on the product's label. Make sure that the pipe is not out of round! The pipe should be free of scratches, dents, flats or other defects which may interfere with the coupling's proper seal. The coupling may not fit well or function properly on a pipe which is damaged or is out of round.

STEP 3

Unpack the coupling. Carefully remove the coupling from its packaging. Inspect the coupling and end rings for shipping damage and assure all parts are present. Inspect the end rings. If they are not centered on the coupling - DO NOT USE! Contact your distributor for return and replacement.

NOTE: HYMAX GRIP is a stab-on type coupling. Do not loosen or remove the end ring bolts.

NOTE: Bolts are pre-lubricated with a MAG coating. This embedded zinc lubrication will prevent cold weld. Do not lubricate the bolts and nuts. Greasing or lubricating bolts or nuts voids the manufacturer's warranty.

INSTALLATION INSTRUCTIONS

HYMAX® GRIP COUPLING RESTRAINT (1.5"-12")

HYMAX®
Repair the past. Connect the future.

STEP 4

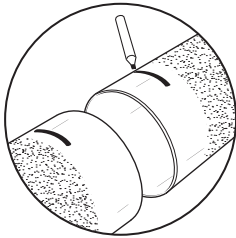

Mark each pipe end to a minimum required stab depth as indicated on the product label. These marks indicate the required stab depth of the pipe on the coupling.

STEP 5

The HYMAX GRIP fits a wide range of pipe sizes. Each coupling's range is shown on the product's label.

For size 3" only: The coupling has two gaskets in this size: a removable inner gasket and a hydraulically-assisted outer gasket. The inner gasket can be removed to accommodate larger OD pipes. **DO NOT** remove the inner gasket unless the OD falls within the upper range of the GRIP. The proper range sizes are shown on the product label. If the inner layer of the gasket must be removed, fold the inner layer and separate the two gaskets by inserting a screwdriver between the two layers, and pull the layer out of the GRIP.

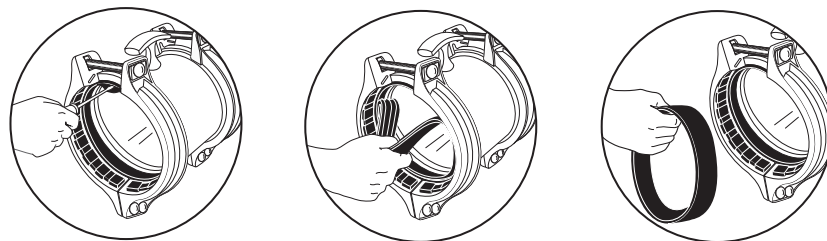
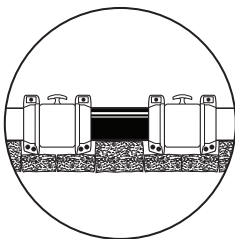

Make sure that the pipes are properly supported. The HYMAX GRIP is not designed to carry the weight of the pipes.

STEP 6

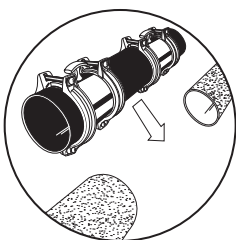

Slide the two HYMAX GRIPs on both sides the replacement pipe. (according to the application - for example, one HYMAX Grip Flange adaptor and one HYMAX Grip coupling) Lower the replacement pipe and the two grips positioned on it into the ditch.

INSTALLATION INSTRUCTIONS

HYMAX® GRIP COUPLING RESTRAINT (1.5"-12")

HYMAX®
Repair the past. Connect the future.

STEP 7

Slide the two HYMAX GRIPs from the replacement pipe in the direction of the two old pipes until they reach the pipe marks shown in step 4.

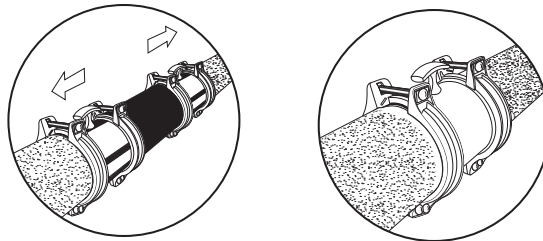

STEP 8





Tighten the end rings using a torque wrench, to the correct torque shown on the product's label. By tightening bolts the couplings are steadily stabbed on the pipe.

NOTE: Use a torque wrench to tighten the bolts - this is required. A torque wrench will assure a proper torque has been applied to the coupling.

STEP 9

Recharge the line and check for leaks. If any leakage is evident, reduce the pressure in the line and increase bolt's torque by up to 50%. For sizes 1.5"-3" increase bolt's torque by up to 30%. Verify again no leaks are evident along the seal.

 WARNING	Caution: This product is not intended for use on natural gas piping, or any other type of gas piping. To do so could result in escaping gas that could ignite and cause property damage, serious injury or death.
	

HYMAX[®]

Repair the past. Connect the future.

 **KRAUSZ** is the creator of HYMAX

331SW 57TH AVENUE, OCALA, FLORIDA 34474

TEL: 855-457-2879 | 855-4KRAUSZ

FAX: 352-304-5787

info@krauszusa.com | www.krauszusa.com