

Submittal Data Information

00e™ Series

VR1816 ECM Circulator

101-167

Effective: June 3, 2016

Supersedes: February 23, 2016

Job: _____ Engineer: _____ Contractor: _____ Rep: _____

ITEM NO.	MODEL NO.	

Specifications

- Maximum Shut-off Head: 18 feet
- Maximum Flow: 16 gpm
- Maximum Operating Pressure: 125 psi (8.6 bar)
- Maximum Water Temp: 230°F (110°C)
- Minimum Water Temp: 36°F (2°C)
- Electrical specifications:
 - Voltage: 120V, 60 Hz
 - Single phase
 - Operating Power: 4W - 44W
 - Max. AMP Rating: 0.54
- Equipped with a cast iron casing and should be used for closed loop systems only
- Taco circulator pumps are for indoor use only
- Acceptable for use with water or maximum of 50% water/glycol solution

Applications

The VR1816 circulator is a variable speed, high-efficiency wet rotor circulator with an ECM permanent magnet motor. Operating modes include infinitely variable fixed speed to fine tune any zone, self-adjusting constant pressure for zone valve applications and self-adjusting proportional pressure for panel radiators with thermostatic radiator valves. The VR1816 is not suitable for chilled water or open loop potable water applications.

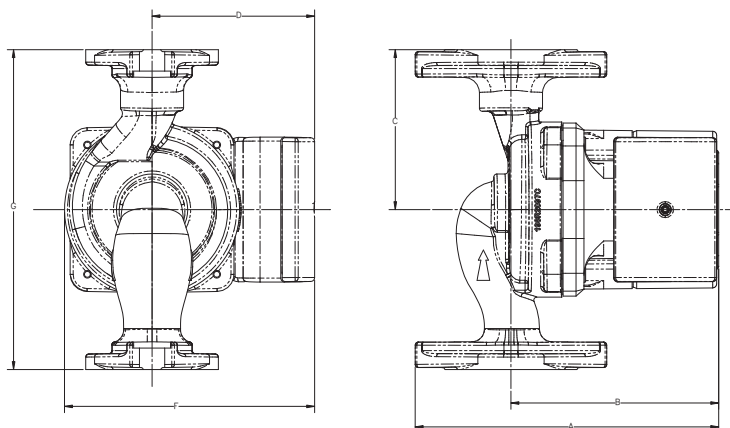

Pump Dimensions & Weights

Part Number	Flange Code	A		B		C		D		F		G		Ship Wt.	
		in.	mm	in.	mm	in.	mm	in.	mm	in.	mm	in.	mm	lbs.	Kg
VR1816-HYI-FC2A00	S	6	152	4-1/8	104	3-3/16	80	3-1/4	82	5	126	6-3/8	161	5.8	2.6
VR1816-HYI-4C2A00	U	6	152	4-1/8	104	3-3/16	80	3-1/4	82	5-1/8	130	6-3/8	161	6	2.7

Materials of Construction:

Casing:Cast Iron
 Stator Housing:Composite
 Cartridge:Composite
 Impeller:Composite
 Shaft:Ceramic
 Bearings:Carbon
 Thrust Bearing:Ceramic
 O-Ring & Gaskets:EPDM
 Integral Flow Check (IFC*):
 Body, PlungerAcetal
 O-ring SealEPDM
 SpringStainless Steel

Mounting Positions



Flange Orientation

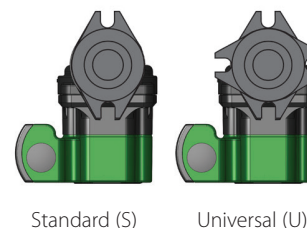

Electrical Data

Model	Volts	Hz	Ph	Max. Amps	Max. Watts	RPM
All Models	120	60	1	.54	44	1590 - 4830
Motor Type	ECM, Permanent Magnet, Thermally Protected					

