

# MBOFSX6636

66" x 36.75" x 21.75"

## GENERAL SPECIFICATIONS:

Installation: Freestanding

Material: Acrylic

Soaker Weight: 130 lbs / 58.97 kg

Maximum Fill: 71 gal to overflow

**NOTE:** Filling this tub to the maximum may require an above average size or dedicated water heater.

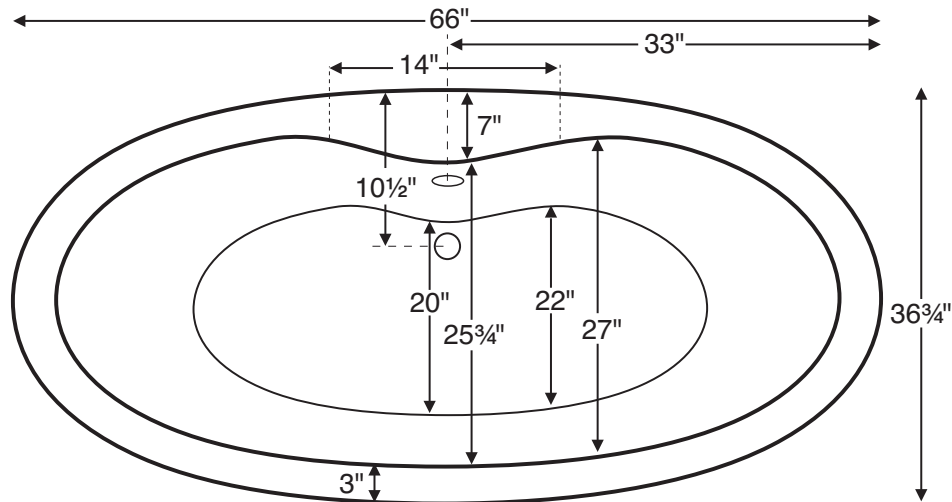

Features a 7" wide flat deck surface on the drain side for mounting faucetry.

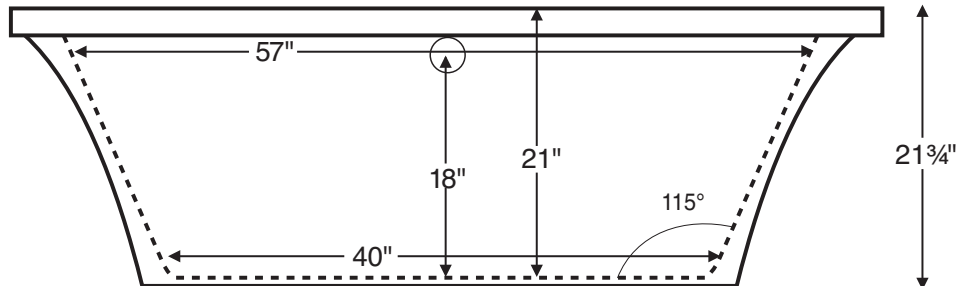

## IMPORTANT ORDERING & INSTALLATION INFORMATION:

- Before ordering or installing, please consider future access to all equipment.
- Please measure tub on-site before building tub decking.
- Add bedding compound to fully level and support bottom of tub.
- The drain and overflow assembly is concealed between the walls of the tub, eliminating the need for an exposed drain kit.
- Tub includes an access panel (standard), for drain or Virtual Spout installation. Access panel can be eliminated by request, which will increase installation difficulty. Must specify on order.
- The Virtual Spout is installed below the water level of the tub. MTI supplies a Wilkins dual check valve and an Acme in-wall atmospheric vent to prevent backflow into the potable water supply. However, some areas of the country require additional backflow prevention when water is introduced to the bath below the water level. Please check local codes.
- Options listed cannot be combined with Designer Collection options.
- Specifications and configurations are subject to change without notice.
- Measurements are +1/2" and are subject to change without notice.
- Measurements herein supersede all others published prior to publication date shown below.

PACKAGE	PACKAGE CONTENTS	PART #
Soaker	Soaking bath - No jets. Includes pre-leveled foam base.	MBSOFSX6636
Soaker With Virtual Spout	Soaking bath - No jets. Includes Virtual Spout integrated high-flow tub filler (see important information below), pre-leveled foam base.	MBSOFSX6636VS

**COLOR AND FINISH OPTIONS**

NOTE: Part codes for all options listed in parenthesis.

Color Upgrade: Biscuit (MTISCOLOR)

**STANDARD OPTIONS**

NOTE: Part codes for all options listed in parenthesis.

**Quick Ship / Priority**

Soaker &amp; Whirlpool (QSHIPMTIS)

Airbath (QSHIPMTISA)

**Lift and Turn Drain & Overflow**

Chrome (MBWOC)

Brushed Nickel (MBWOBN)

White (MBWOW)

