

# SUBMITTAL DATA SHEET

NL Ball Style Corporation Stop – 73131B

MNPT x MNPT

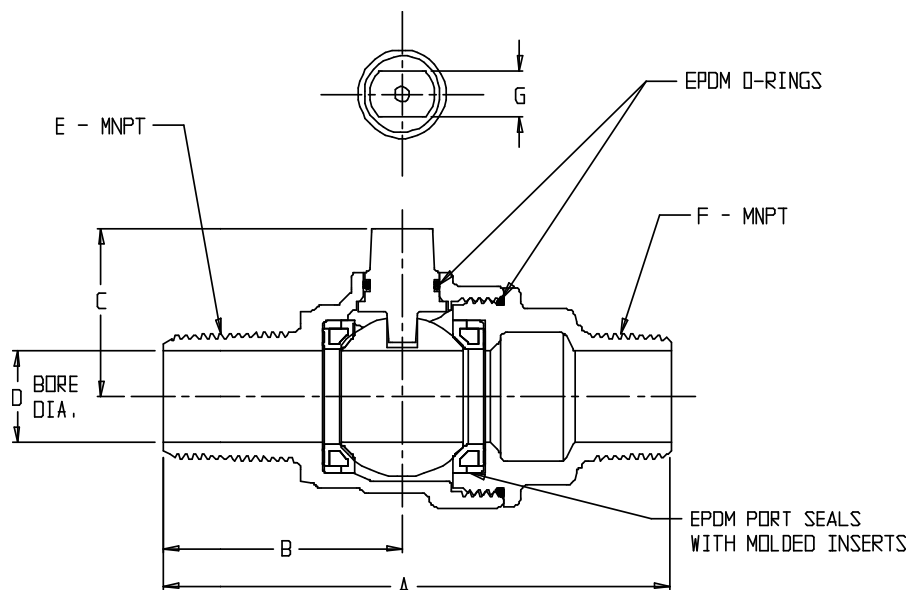
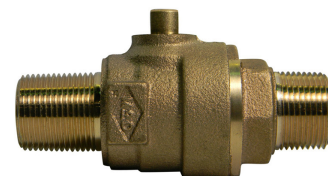

| MODEL  | SIZE  | A    | B    | C    | D    | E     | F     | G   |
|--------|-------|------|------|------|------|-------|-------|-----|
| 73131B | 3/4   | 4.16 | 1.96 | 1.39 | .75  | 3/4   | 3/4   | .38 |
| 73131B | 1     | 4.59 | 2.11 | 1.50 | 1.00 | 1     | 1     | .28 |
| 73131B | 1 1/4 | 6.03 | 2.41 | 1.88 | 1.25 | 1 1/4 | 1 1/4 | .42 |
| 73131B | 1 1/2 | 6.42 | 3.05 | 2.15 | 1.50 | 1 1/2 | 1 1/2 | .42 |
| 73131B | 2     | 6.75 | 3.21 | 2.46 | 2.00 | 2     | 2     | .42 |

## SUBMITTAL INFORMATION

- Manufactured in compliance with ANSI/AWWA C800 (latest revision)
- Brass components in contact with potable water conform to ASTM B584, UNS C89833 (latest revision) and identified with “NL”
- Certified to NSF/ANSI 61 and NSF/ANSI 372
- Brass components not in contact with potable water conform to ASTM B62 and ASTM B584, UNS C83600 -85-5-5-5 (latest revision)
- PTFE coated brass ball rotates 360°
- Rated for 300 PSIG water pressure
- Blow out proof EPDM port seals
- End piece joint sealed with an EPDM o-ring and thread locker



**A.Y. McDonald Mfg. Co.**  
P.O. Box 508  
Dubuque, IA 52004-508

**Toll Free:** 1-800-292-2737

**Fax:** 1-800-832-9296

**Hours:** 7:00 a.m. – 5:00 p.m., CST

[sales@aymcdonald.com](mailto:sales@aymcdonald.com)

[www.aymcdonald.com](http://www.aymcdonald.com)

A.Y. McDonald considers the information on this assembly drawing correct when published. Item and option availability, including specifications, are subject to change without notice.

**Submitted by:**