

400CAR3

PerforMAX®

Toilet Fill Valve and 3" Flapper Kit

**A powerful and durable combination
to fix and upgrade toilets with
3" flush valves**



3" Adjustable Flapper:

- Adjusts to fit most 3" flush valves
- Features silicone seal - lasts 10X longer than standard flappers
- Adjusts to match manufacturer's performance settings
- Solid frame for ultimate reliability - no twisting
- Chlorine and hard water resistant

PerforMAX® Fill Valve:

- The quietest and most powerful fill valve
- Adjusts to optimize performance

**Fix Toilet!
Optimize Performance!
Save Water & Money!**



**Fits These Brands
and More:**

American Standard® / Eljer®



Glacier Bay®

Kohler®

Toto®



Fluidmaster®

PERFORMAX® FILL VALVE & 3" FLAPPER KIT

PerforMAX® Fill Valve



2X greater refill rate than standard fill valves

Water Saving Roller Clamp lets you optimize the fill level in the bowl



Protects critical components

EZ-Twist height adjusts from 10" - 15" to fit most tanks

3" Water-Saving Flapper

Adjustable Arms to Fit Kohler® Cimmaron Toilets



Long Lasting Silicone Seal

Easily adjust to optimize performance and fine-tune how much water you flush

Quick, Easy Installation

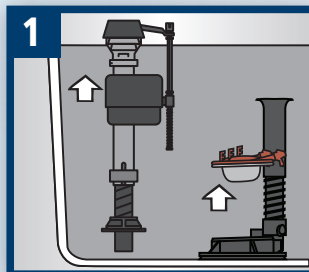

Remove

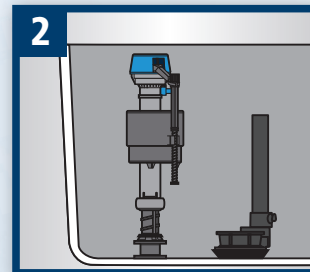

Install Fill Valve

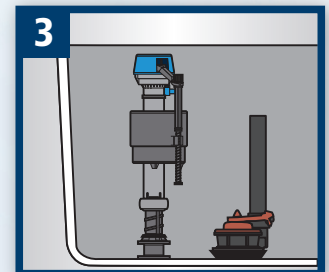

Install Flapper

MODEL NUMBER	DESCRIPTION	PACKAGED	CASE QTY	PROD. DIMENSIONS W/D/H (INCHES)	CASE DIMENSIONS W/D/H (INCHES)	CASE WEIGHT (LBS)	UPC	SCCI 2 of 5
400CAR3P5	PERFORMAX® FILL VALVE & 3" FLAPPER KIT	Blister	5	15" x 7.125" x 3.375"	15.5" x 7.25" x 20.625	5.25 lbs	0 39961 01422 1	100 39961 01422 8

