

---

## INSTALLATION INSTRUCTIONS

P22731, P24031, P24600,  
P24601

## INSTALLATION INSTRUCTIONS

## THANK YOU FOR CHOOSING KALLISTA

We appreciate your commitment to KALLISTA quality products. Please take a moment to review this manual before you install your KALLISTA product. If you encounter any installation or performance problems, please do not hesitate to contact us at the phone number listed at the bottom of the page.

## IMPORTANT INFORMATION

- ☐ Prior to installation, unpack the new faucet and inspect it for damage. Return the faucet to its protective carton until you are ready to install it.
- ☐ Observe all local plumbing and building codes.
- ☐ Shut off the water supply.
- ☐ Inspect the drain and supply tubing. Replace if necessary.
- ☐ If possible, assemble the faucet to the lavatory before installing the lavatory.
- ☐ The appearance of your product may differ from what is shown in these instructions, however, the installation procedure is the same.
- ☐ KALLISTA reserves the right to make revisions in the design of products without notice, as specified in the Price Book.

## TOOLS AND MATERIALS



Adjustable  
Wrench

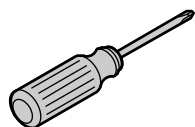

Phillips  
Screwdriver

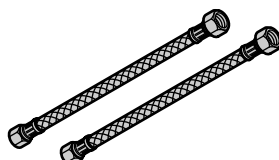

Supply  
Hoses



Thread  
Sealant



Plumbers  
Putty

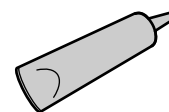

Silicone  
Sealant

## INSTALLATION INSTRUCTIONS

## 1. INSTALL THE SPOUT AND HANDLES

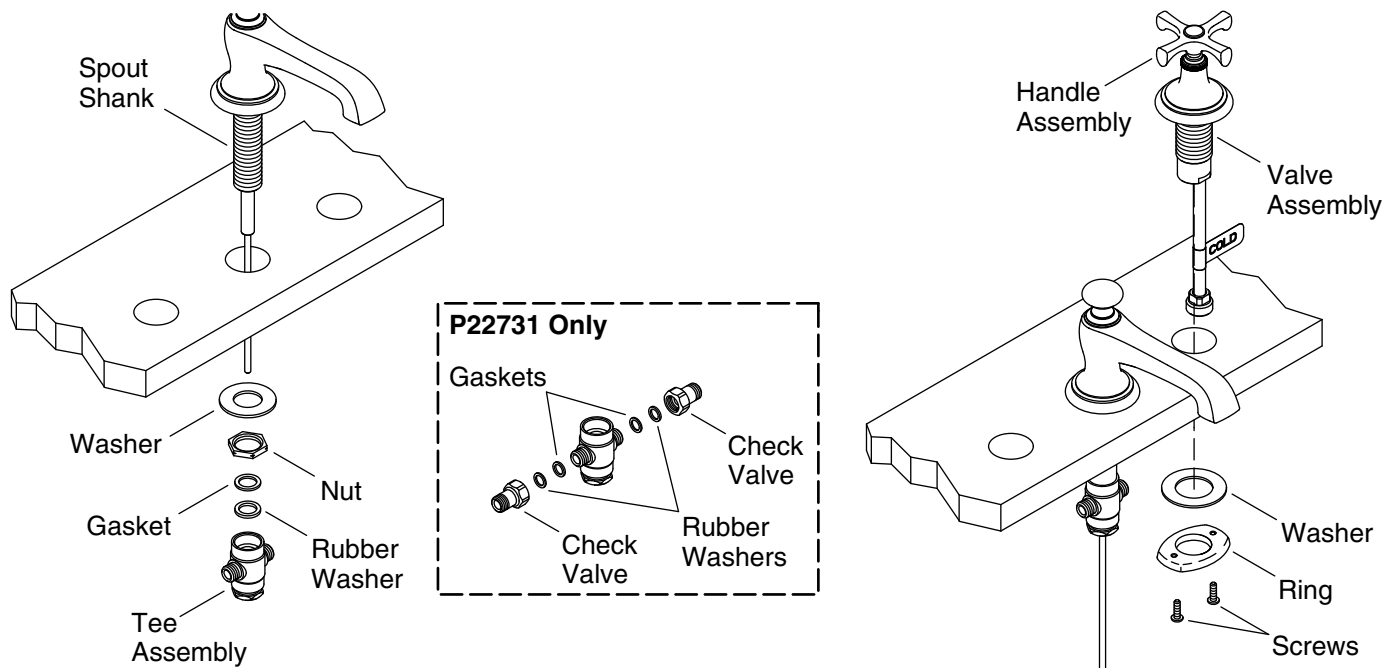

### Install the Spout

- ☐ Remove the tee assembly, nut, and washer from the spout shank.
- ☐ Ensure that the O-ring is installed to the underside of the spout.
- ☐ Fit the spout shank through the top of the lavatory.
- ☐ Install the washer and nut onto the spout shank. Securely wrench tighten the nut.
- ☐ Insert the rubber washer and gasket into the tee. Thread the tee onto the spout shank.
- ☐ Hold the spout in position and tighten the tee securely. Do not overtighten.
- ☐ **For P22731 only:** Install the rubber washers, gaskets, and check valves onto the tee assembly.
- ☐ If desired, apply a bead of silicone sealant or caulk around the base of the spout.

### Install the Handle Assemblies

- ☐ Partially thread the screws into the ring.
- ☐ Ensure that the O-ring is installed to the underside of the COLD handle assembly.
- ☐ Fit the valve assembly through the top of the lavatory.
- ☐ Install the washer and ring onto the valve assembly. Thread the ring most of the way up the valve assembly.
- ☐ Tighten the screws. **Do not overtighten.**
- ☐ If desired, apply a bead of silicone sealant or caulk around the base of the handle assembly.
- ☐ Repeat the procedure to install the HOT handle assembly.

## INSTALLATION INSTRUCTIONS

### 2. CONNECT THE HOSES

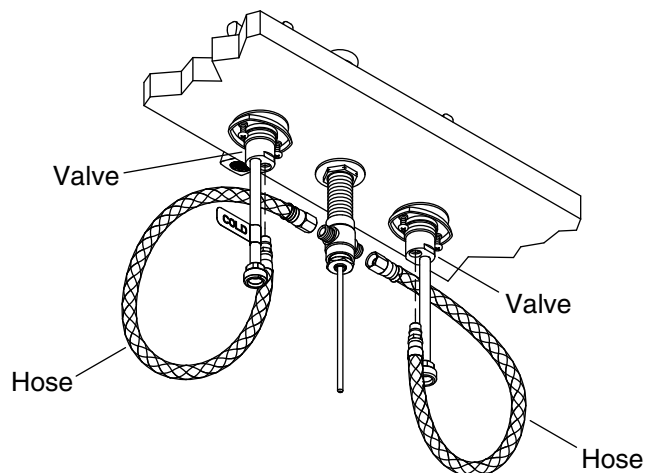

- ☐ Thread the male ends of the hoses into the valves. **Do not overtighten.**
- ☐ Thread the female ends of the hoses onto the tee.

### 3. INSTALL THE DRAIN

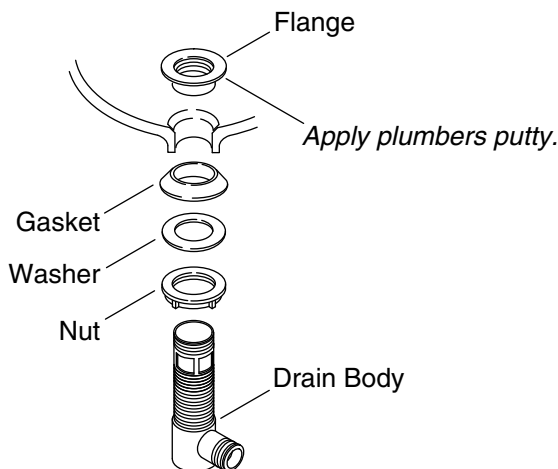

- ☐ Remove the protective cover from the flange.
- ☐ Apply a ring of plumbers putty or other sealant to the underside of the flange according to the manufacturer's instructions.
- ☐ Assemble the nut, flat washer, and tapered gasket (tapered side up) fully onto the drain body.
- ☐ From the underside of the fixture, insert the drain body up into the drain hole.
- ☐ From the top of the fixture, securely handtighten the flange onto the drain body.
- ☐ Make sure the drain body seal hole is facing the back of the fixture, and securely tighten the nut.
- ☐ Remove any excess putty or sealant.

## INSTALLATION INSTRUCTIONS

### 4. COMPLETE THE DRAIN INSTALLATION

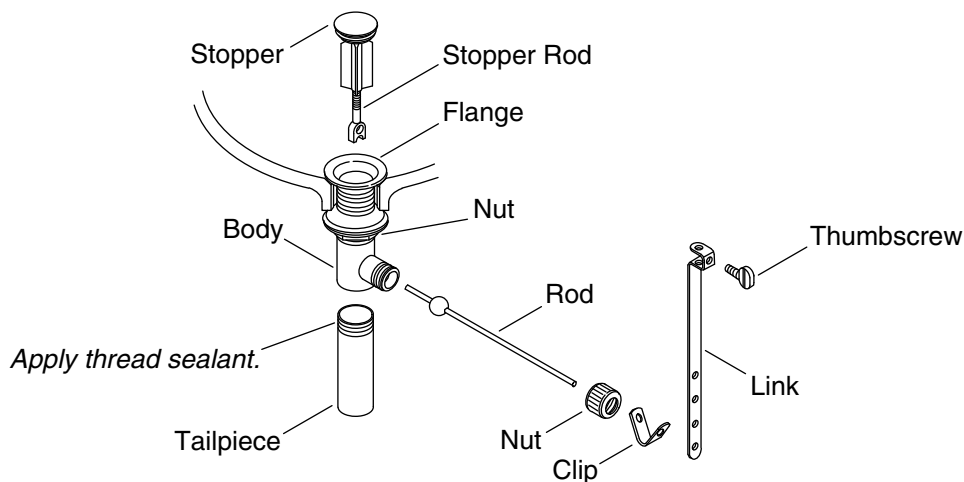

- ☐ Insert the stopper into the flange.
- ☐ For regular installations, insert the short end of the rod into the body seal hole and under the stopper.
- ☐ For vandal-resistant installations, fit the rod through the hole in the stopper.
- ☐ Handtighten the body nut.
- ☐ Remove and adjust the stopper as needed so it lifts about 3/8" (10 mm) when opened. To adjust, rotate the threaded stopper rod in or out as needed. Retighten the stopper nut.
- ☐ Apply thread sealant tape to the tailpiece threads, and thread the tailpiece to the body. Tighten the tailpiece securely. Slide one end of the clip onto the rod. Slide the link onto the rod with the thumbscrew facing the back of the fixture.

### 5. COMPLETE THE CONNECTIONS

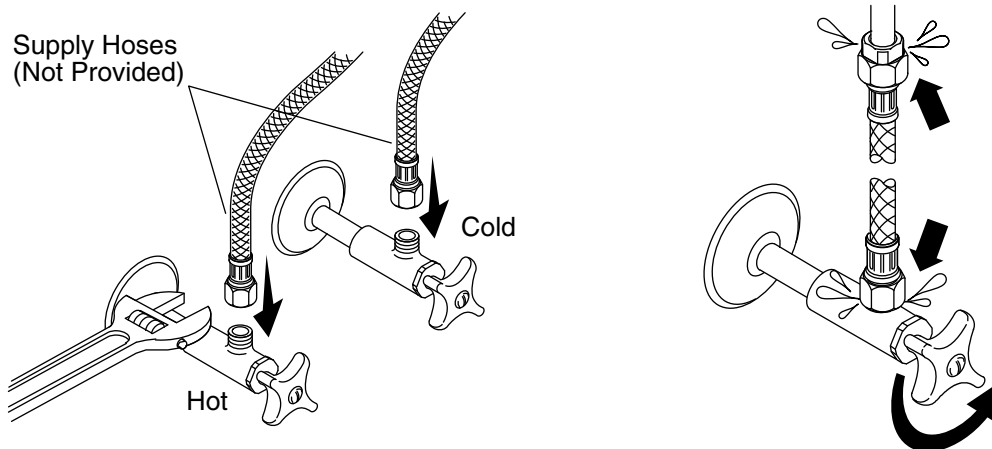

- ☐ Install the lavatory according to the lavatory manufacturer's instructions.
- ☐ Connect the supply hoses (not provided) to the supply stops. (Left is hot; right is cold.)
- ☐ Tighten all connections with an adjustable wrench.

## INSTALLATION INSTRUCTIONS

## 6. COMPLETE THE INSTALLATION

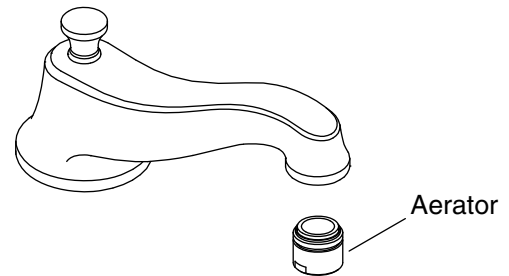
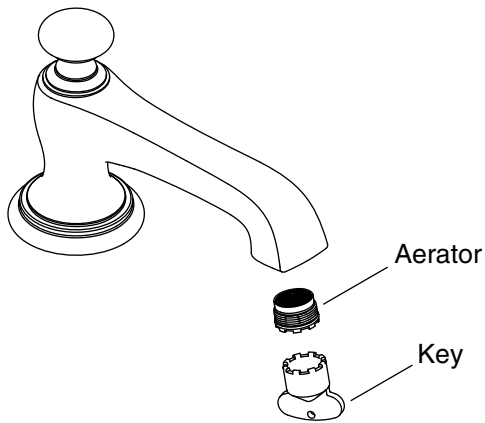

- ☐ Connect the P-trap (not supplied) to the tailpiece.
- ☐ Ensure all connections are watertight.
- ☐ Remove the aerator by turning it counterclockwise. Use the supplied key if required for removal of your aerator.
- ☐ Open the drain. Turn on the water supply and check for leaks. Repair as needed.
- ☐ Open both the hot and cold valves.
- ☐ Run water through the spout for 1 minute to remove any debris.
- ☐ Turn off the valves.
- ☐ Reinstall the aerator. Retain the key for future use.