

### CONSERVATIONIST® POWER DIRECT VENT

The BPD-80 tank-type commercial gas water heater is intended for light-duty applications such as small office buildings and duplex apartment homes. The BPD-80 features a power direct-vent design, with a factory-installed blower. The blower permits sealed combustion direct-vent operation, with separate venting and air intake runs from outside the structure. The BPD-80 offers installation versatility by allowing venting and intake runs up to 50 equivalent feet, using 3" Schedule 40 PVC pipe.

The power direct-vent design also eliminates the potential for performance and safety problems caused by negative air pressure, a problem found in many commercial applications with inadequate indoor ventilation.

#### DYNACLEAN™ DIFFUSER DIP TUBE

- Helps reduce lime and sediment buildup and maximizes hot water output. Made from long-lasting PEX cross-linked polymer

#### BLUE DIAMOND® GLASS COATING

- Provides superior corrosion resistance compared to the industry-standard glasslining.

#### HOT SURFACE IGNITION

- Has a solid state ignition surface that does not flutter or blow out.
- Provides increased reliability and efficiency over spark ignition systems. Eliminates the pilot and saves energy.

#### ENHANCED-FLOW BRASS DRAIN VALVE

- Have a solid brass, tamper resistant, enhanced flow, ball type, drain valve.
- Uses a standard female hose fitting that allows for fast and easy draining during maintenance.
- Designed for easy operation, this valve includes an integral screwdriver slot that features a ¼ turn (open/close) radius, which not only permits full straight through water flow but also a quick and positive shut off.

#### CSA CERTIFIED AND ASME RATED T&P RELIEF VALVE

#### MAXIMUM HYDROSTATIC WORKING PRESSURE 150 PSI

#### STANDARDS

- Design-certified by CSA International, according to ANZI Z21.10.3 - CSA 4.3 standards governing storage-type water heaters.
- Meets the thermal efficiency and standby loss requirements of the U.S. Department of Energy and current edition of ASHRAE/IESNA 90.1.

#### POWERED DIRECT VENTING

- Provides more venting flexibility.
- Roof or sidewall venting with 3" or 4" PVC, CPVC, ABS or polypropylene.
- Allowable vent lengths of up to 125 equivalent feet make installation easy in any situation.

#### QUIET MODULAR BLOWER

- Built-in safety device prevents pilot or main burner operation if blower is not operating.
- Blower has 100/120V electrical system, with maximum 2-amp draw.

#### 3-YEAR LIMITED TANK / 1-YEAR LIMITED PARTS WARRANTY

- For complete warranty information, consult written warranty or contact A. O. Smith.



**BPD-80  
SERIES 210/211**



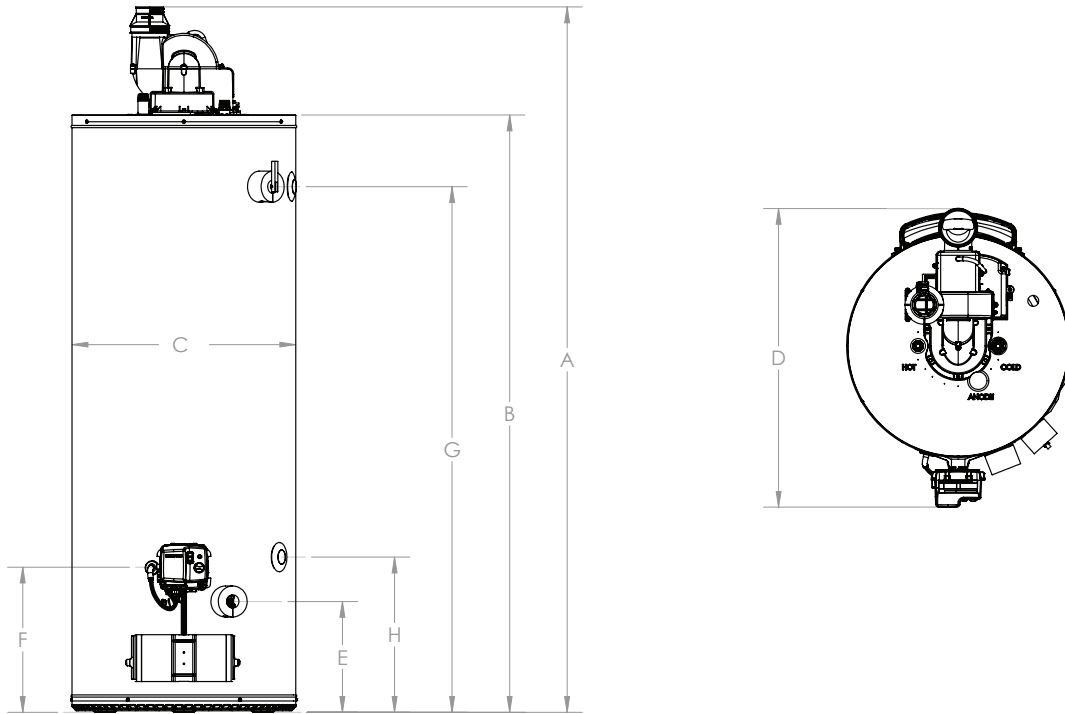

### DIMENSIONS

| Model Number | Units  | A      | B      | C  | D      | E  | F      | G   | H      | Water Connections | Gas Connection | Approx. Shipping Weight |
|--------------|--------|--------|--------|----|--------|----|--------|-----|--------|-------------------|----------------|-------------------------|
| BPD-80       | Inches | 70-5/8 | 61-1/2 | 26 | 33-7/8 | 11 | 13-1/4 | 53  | 15-1/4 | 3/4" NPT          | 1/2" NPT       | 277 lbs                 |
|              | cm     | 179    | 156    | 66 | 86     | 28 | 36     | 135 | 39     |                   |                | 126 kg                  |

Dimensions and specifications subject to change without notice in accordance with our policy of continuous product improvement.

### RECOVERY CAPACITIES

U.S. GALLONS/HRS. AND LITRES/HR. AT TEMPERATURE RISE INDICATED

| Model Number | Input  |      | Approx. Capacity |        | °F  | 30°F | 40°F | 50°F | 60°F | 70°F | 80°F | 90°F | 100°F | 110°F | 120°F | 130°F | 140°F |
|--------------|--------|------|------------------|--------|-----|------|------|------|------|------|------|------|-------|-------|-------|-------|-------|
|              | Btuh   | kW   | U.S. Gals.       | Litres | °C  | 17°C | 22°C | 28°C | 33°C | 39°C | 44°C | 50°C | 56°C  | 61°C  | 67°C  | 72°C  | 78°C  |
| BPD-80       | 76,000 |      | 75               |        | GPH | 246  | 185  | 148  | 123  | 106  | 92   | 82   | 74    | 67    | 62    | 57    | 53    |
|              |        | 22.3 |                  | 280    | LPH | 932  | 699  | 559  | 466  | 400  | 350  | 311  | 280   | 254   | 233   | 215   | 200   |
|              |        |      |                  |        |     |      |      |      |      |      |      |      |       |       |       |       |       |

Available in LP (Propane) gas

Can be installed up to 10,100 feet without alteration.

### SAMPLE SPECIFICATION

Water Heater(s) shall be model BPD-80 AS MANUFACTURED BY A. O. Smith shall be of glasslined design, and gas-fired, equipped to burn \_\_\_\_\_ gas and design certified by Underwriters Laboratories under Volume III tests for commercial heaters for delivery of 180°F water, and meets the thermal efficiency and standby loss requirements of the U. S. Department of Energy and current edition of ASHRAE/IESNA 90.1. Heaters shall have an input rating of \_\_\_\_\_ and a recovery rating of \_\_\_\_\_ GPH at a temperature rise of 100°F with a storage capacity of 75 gallons.

Unit(s) shall be direct-vent design, with an automatic blower-powered, two-pipe air intake and exhaust system communicating directly with the outside of the building. The blower shall have a safety device that will not allow the operation of the main burners unless the blower is in operation. Unit(s) shall have a combustion air passage that is internal to the outer jacket of the water heater other than the intake and exhaust connections at the top of the water heater.

Heater tank shall have a 3-year limited warranty against corrosion or sediment buildup as outlined in the written warranty. Fully illustrated instruction manual to be included.

For technical information, call 800-527-1953. A. O. Smith Corporation reserves the right to make product changes or improvements without prior notice.