

G16-3MFC Finish(C) ☐

G16-3MFK Finish(K) ☐

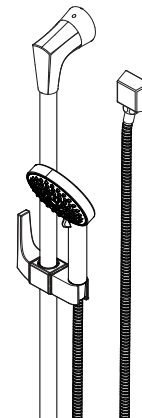

Specifications

Features

- 2.0 GPM Flow Rate
- 60" Metal Hose
- All Metal Construction
- Mounting Hardware Included
- Multi-Function Handshower (Full Spray, Massage, and Full Spray/Massage Combo)
- Pforever Warranty®

Code Compliance

Pfister products are designed and manufactured in compliance with the following standards and codes:

- IAPMO Certified
- CSA B125 Certified
- ASME A112.18.1
- ADA Compliant-ANSI A117.1 (Lever handles only)



Dimensions

