



**Dearborn®
Brass**

4675 W. 160th St.
Cleveland, Ohio 44135
Ph: (800) 321-9532
Fax: (800) 321-9535
www.dearbornbrass.com

SUBMITTAL SPECIFICATION

**BRASS TUBULAR
1-¼" P-TRAP WITH CLEANOUT**

Engineering Specification: Dearborn Brass 1-¼" Brass Tubular P-Trap with Cleanout are designed for use in tubular drain applications. Available in 17 or 20 Gauge Brass. Options include Brass Nuts, Deep Flange and Extended Wall Tube.

Job Reference

DESCRIPTION

- Chrome Finish
- 1-¼" P-Trap With Cleanout
 - (1) Metal Flange
 - (1) Quarter Bend
 - (1) J-Bend
 - (1) Cleanout Plug
 - (1) Fiber Cleanout Washer
 - (2) Rubber Washers
 - (2) Nuts

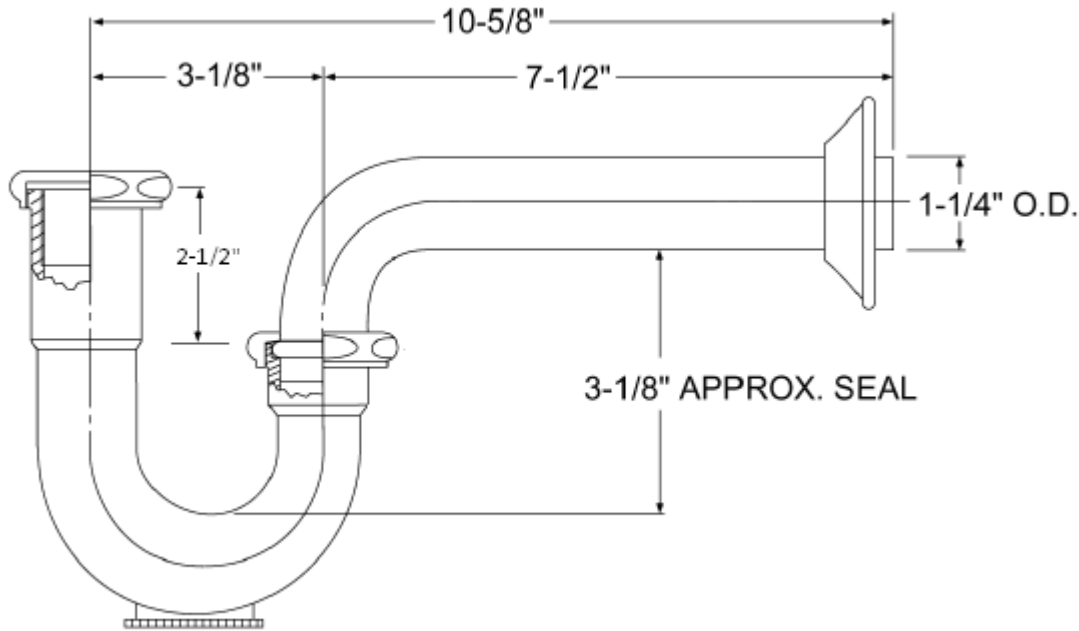

✓	Product No.	Description	Carton Quantity	Carton Weight (lbs)
	706-1	1-¼" P-Trap with Cleanout – 20 Ga.	10	11
	707-1	1-¼" P-Trap with Cleanout – 17 Ga.	10	13
	707DF-1	1-¼" P-Trap with Cleanout – 17 Ga. w/ Deep Flange	10	13
	707A-1	1-¼" P-Trap with Cleanout – 17 Ga. w/ 10" Wall Tube	10	13
	707BN-1	1-¼" P-Trap with Cleanout – 17 Ga. w/ Brass Nuts	10	13

Data is subject to manufacturing tolerances.