

BILL OF MATERIAL (CURRENT LEVEL)

ITEM	PT/ASSY	DESCRIPTION	TYPE	QTY.
1	50332	STOPPER (320)	PART	1
2	50333	FLANGE (320)	PART	1
3	50334	POST (320)	PART	1
4	50335	TLPP 1.25" OD X 7" (320)	PART	1
5	91195	O-RING - METRIC	PART	1
6	92072	SCREW - BRS PAN HD	PART	1
7	5-032	MTG HDWR KIT	ASSEMBLY	1

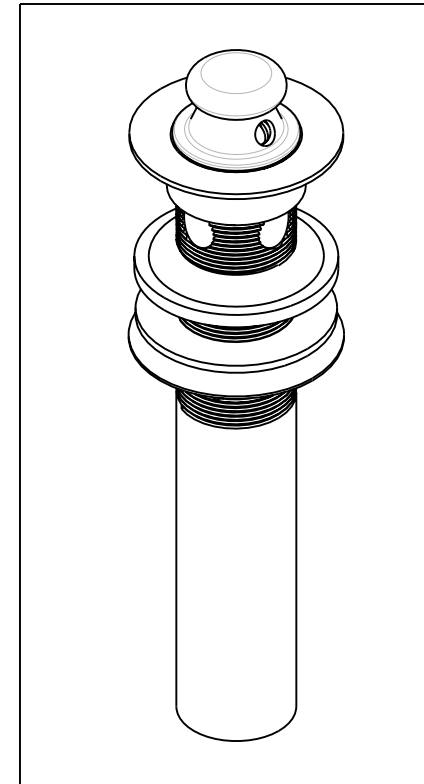

COPYRIGHT 2003 BRASSTECH, INC. THESE DRAWINGS AND THE DESIGNS DEPICTED HEREIN ARE THE PROPRIETARY PROPERTY OF BRASSTECH. ANY USE OR REPRODUCTION IS SUBJECT TO THE EXPRESS APPROVAL OF BRASSTECH. UNAUTHORIZED USE IS STRICTLY PROHIBITED. ALL RIGHTS RESERVED.

BRASSTECH
INCORPORATED

2001 E. CARNEGIE AVE.
SANTA ANA, CA 92705
(949) 417-5207

DRAIN - LIFT & TURN

ASSY. NO. 320				
SCALE 0.325	REF. -	SHEET 1 OF 2	REV	REV DESC
				DATE

RELEASED PRE '95

SPECIFICATION DWG

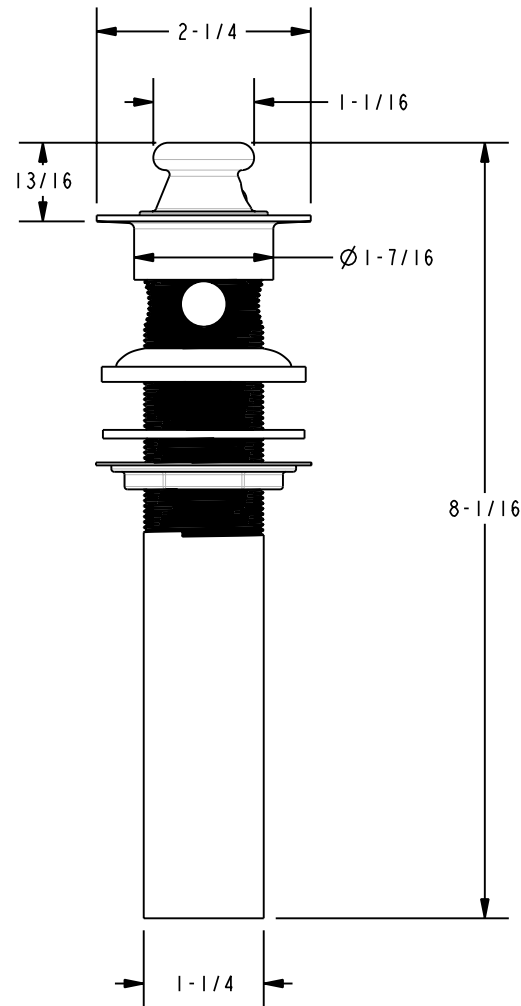

DIMENSIONS ARE IN INCHES AND AN APPROXIMATION OF A TYPICAL INSTALLATION

COPYRIGHT 2004 BRASSTECH, INC. THESE DRAWINGS AND THE DESIGNS DEPICTED HEREIN ARE THE PROPRIETARY PROPERTY OF BRASSTECH. ANY USE OR REPRODUCTION IS SUBJECT TO THE EXPRESS APPROVAL OF BRASSTECH. UNAUTHORIZED USE IS STRICTLY PROHIBITED. ALL RIGHTS RESERVED.

BRASSTECH		2001 E. CARNEGIE AVE. SANTA ANA, CA 92705 (949) 417-5207	
INCORPORATED			
DWG NO.	320	REF.	REV -
SCALE	0.500	SHEET	2 OF 2