

D301355



D301355

SPECIFICATIONS

SHERIDAN™ TWO HANDLE CENTERSET LAVATORY FAUCET

Model

D301355

Description

- Ceramic disc valves
- 7 1/4" high swivel spout, 4 5/8" spout length
- 360° spout swivel
- Includes 50/50 pop-up drain DA605254 with color-matching flange and cap and black tailpiece
- 3 hole mount
- 1.2gpm (4.5L/min) maximum flow rate @60 psi
- Meets CEC Requirement

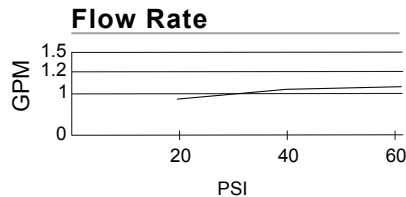

Standards



NSF/ANSI 372

• NSF/ANSI 372



• ASME A112.18.1M/A112.18.1



• ADA Accessibility Guidelines for
Buildings and Facilities -
309.4 Operation for Operable Parts

Warranty

Danze products are covered by a manufacturer's
limited "lifetime" warranty for manufacturing defects.

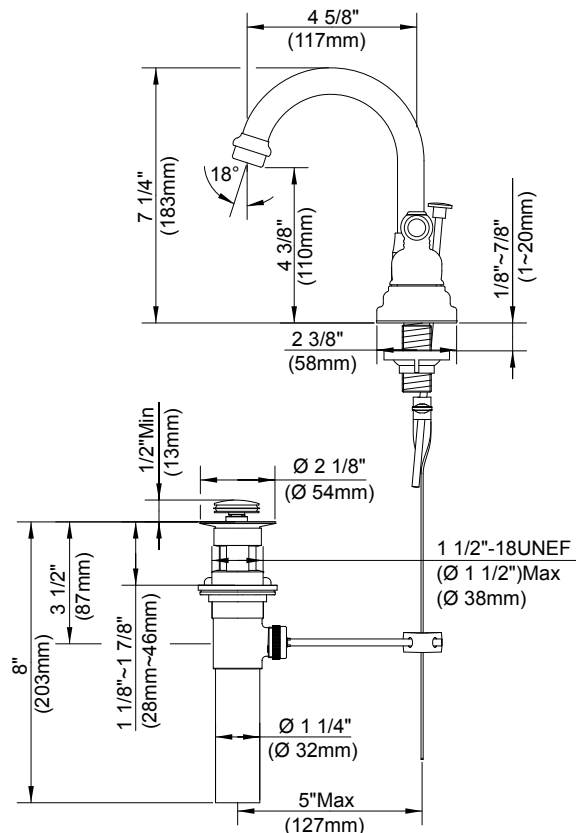
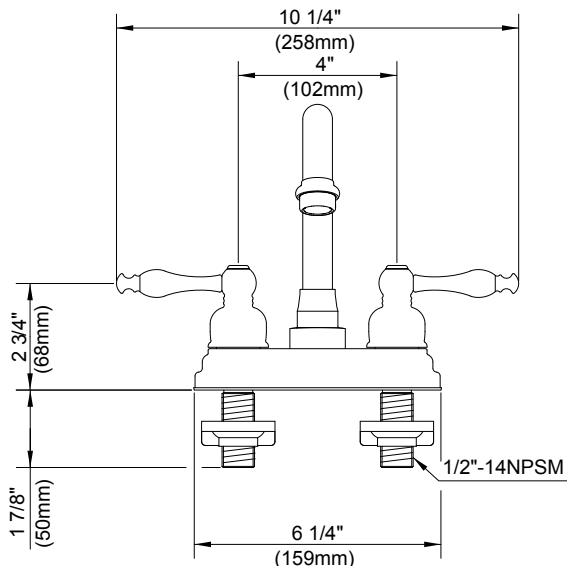

Finishes Available

- Chrome
- Other: Refer to Price List for additional finish

Submittal Information:

Job Name: _____

Location: _____

Contractor: _____

Contact #: _____