



PARTS LIST FOR HUMIDIFIER

HE12MB Models shipped to Canada, also contain (Not shown on diagram):

- HEP-1042-28 Bypass Kit (Includes flex duct, start collar and 15' drain hose)
- HEP-747-38 Water Supply Tubing Kit (Includes water hose, Compression Nuts, 2 Compression Sleeves and 2 Brass Tube Inserts)
- HEP-1042-40 Extra Die Cut
- HEP-1040-13 Ring Flange
- HEP-990-31 15' Drain Tube
- HEP-570-80 Hardware
- MHX3 Wall Mount Humidistat (allows mounting on wall or in duct)

Humidistats (Not Shown):

HE12 "A" Models = HEP-GFX3

HE12 "M" Models = HEP-MHX3

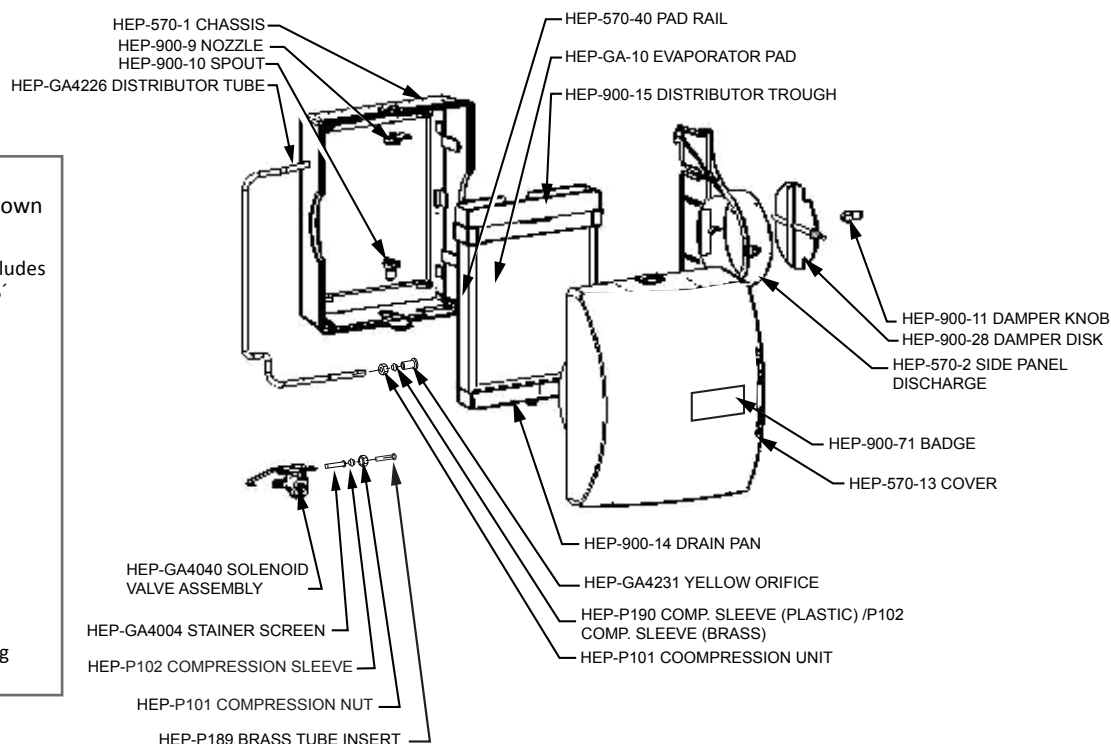

CARE AND MAINTENANCE

Your humidifier is engineered to give helpful and trouble-free humidification. For maximum efficiency the following cleaning procedures should be carried out at the end of each heating season:

1. Turn off water supply and turn humidistat setting to the "OFF" position.
2. Remove humidifier's front cover, distributor trough, evaporator pad and drain pan. Clean excessive mineral deposits from the distributor trough, drain pan, pad rails, and humidifier cover and chassis. A solution of 1/2 vinegar & 1/2 water will help loosen mineral deposits, or you may use a common household de-scaler.
3. Replace evaporator pad part number HEP-GA19 seasonally. (Some instances require 2 pad replacements per heating season, depending on water hardness.) Install trough and drain pan. Replace cover. For peak performance do not attempt to clean evaporator pads, or use longer than one heating season.
4. In areas where the supply water for the humidifier contains a high mineral content, OR if the solenoid valve fails to operate, the solenoid and the strainer screen should be inspected and descaled. To do this disconnect the 1/4" water supply line from the solenoid valve. Carefully pull the strainer screen (part number HEP-GA19) from the valve

body (part number HEP-900-6). Clean the mineral deposits from all parts. If the orifice is clogged, it may be opened by inserting a small pin. Reassemble the brass fittings, ensuring the strainer screen has been fully seated.

5. Reconnect the 1/4" water line to the solenoid valve if necessary. Turn on the water supply and check all points for leakage. The operation of the unit may be checked by starting the furnace. The humidifier operates only when the furnace blower is running or the burner circuit is energized. The humidifier is now ready for operation.
6. During the summer, turn off water supply and turn the humidistat setting to the "OFF" position. Close air damper disk on the humidifier.

At Outside Temperature	Recommended Setting
-20° F -29° C	15%
-10° F -23° C	20%
0° F -18° C	25%
+10° F -12° C	30%
+20° F -7° C	35%
+30° F -1° C	40%