



Job Name:	
Job Location:	
Engineer:	
Contractor:	
Tag:	
PO#:	
Rep:	
Wholesale Dist.:	

DESCRIPTION

The **Apollo International™** YCF Strainers are designed to protect piping systems and process equipment from unwanted foreign particles with minimum pressure loss.

FEATURES

- Iron Strainer with Flat Face Flanges Conforms to ASME/ANSI 16.1 Class 125
- One-Piece Cast Body Meets ASME Standard
- NSF/ANSI 372 - Lead Free
- All Models Epoxy Coating (FDA CFR21, Section 175.300)
- Equipped with Bolted Cover Employing Flat Gasket Seal
- Upper and Lower Machined Seats for Screen for Self-Aligning Screen Design
- 304 SS Perforated Screens are Standard (P045 STD 2"-3", P125 STD 4"-12")
- Tapped Blow-Off Connection with Plug
- 100% Factory Pressure Tested

PERFORMANCE RATING

- Working Pressure (non-shock): CWP 200 PSIG @ 150°F
- Not for steam service**

OPTIONS

- (M20) - 20 Mesh
- (M40) - 40 Mesh
- (M80) - 80 Mesh
- (M100) - 100 Mesh
- (P045) - .045" Perf (Standard 2"-3")
- (P125) - 1/8" Perf (Standard 4"-12")

NOTES:

All screens not available for all sizes.

For wire mesh screens, a P045 perf. liner is added to support the mesh screen.

STANDARD MATERIALS LIST

BODY	Cast Iron, ASTM A126-B
CAP/COVER	Cast Iron, ASTM A126-B
PLUG	Carbon Steel, ASTM A307
BOLT/STUD/NUT	Carbon Steel, ASTM A307
SCREEN	304 Stainless Steel
GASKET	Graphite
COATING	Epoxy, FDA Approved

DIMENSIONS

PART NUMBER	SIZE/DN		A		B		C		D		E		F		DRAIN PLUG		WEIGHT	
	IN	MM	IN	MM	IN	MM	IN	MM	IN	MM	IN	MM	IN	MM	IN	MM	LB.	KG.
YCF02P045E	2"	50	8.86	255	0.63	16	5.98	152	4.75	121	0.75	19	6.30	160	1/2"	4	23	11
YCF25P045E	2-1/2"	65	10.75	273	0.69	18	7.01	178	5.50	140	0.75	19	7.64	194	1"	4	34	15
YCF03P045E	3"	80	11.50	292	0.75	19	7.48	190	6.00	153	0.75	19	8.86	225	1"	4	47	21
YCF04P125E	4"	100	13.86	352	0.94	24	8.98	228	7.50	191	0.75	19	10.63	270	1-1/4"	8	72	33
YCF05P125E	5"	125	16.38	416	0.94	24	10.00	254	8.50	216	0.88	22	12.60	320	1-1/4"	8	111	50
YCF06P125E	6"	150	18.50	470	1.00	25	10.98	279	9.50	242	0.88	22	14.69	373	1-1/2"	8	150	68
YCF08P125E	8"	200	21.38	543	1.12	29	13.46	342	11.75	299	0.88	22	17.72	450	1-1/2"	8	235	107
YCF10P125E	10"	250	25.98	660	1.18	30	15.98	406	14.25	362	1.00	25	20.67	525	2"	12	369	168
YCF12P125E	12"	300	30.00	762	1.25	32	19.02	483	17.00	432	1.00	25	23.94	608	2"	12	552	250

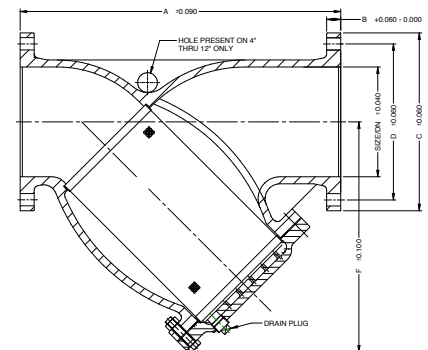

PART NUMBER MATRIX

YCF	XXX	XXX[X]	X
	CONNECTION SIZE	SCREEN TYPE	OPTION
YCF (FLAT FACE)	F02 - FLANGED 2"	M20 - 20 MESH	E - EPOXY COATING, FDA APPROVED
	F25 - FLANGED 2.5"	M40 - 40 MESH	LEAD FREE ONLY, NOT FOR STEAM
	F03 - FLANGED 3"	M80 - 80 MESH	
	F04 - FLANGED 4"	M100 - 100 MESH	
	F05 - FLANGED 5"	P045 - .045" PERF	
	F06 - FLANGED 6"	P125 - .125" PERF	
	F08 - FLANGED 8"		
	F10 - FLANGED 10"		
	F12 - FLANGED 12"		

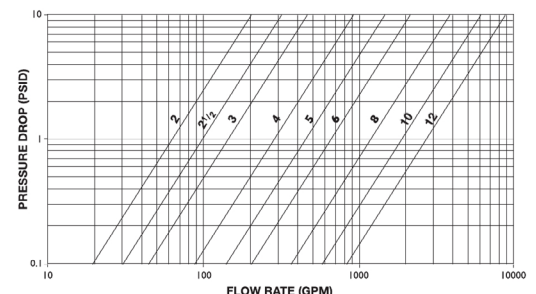

*LEAD FREE: The wetted surfaces of this product shall contain no more than 0.25% lead by weighted average. Complies with Federal Public Law 111-380. ANSI 3rd party approved and listed.