

NOTES:

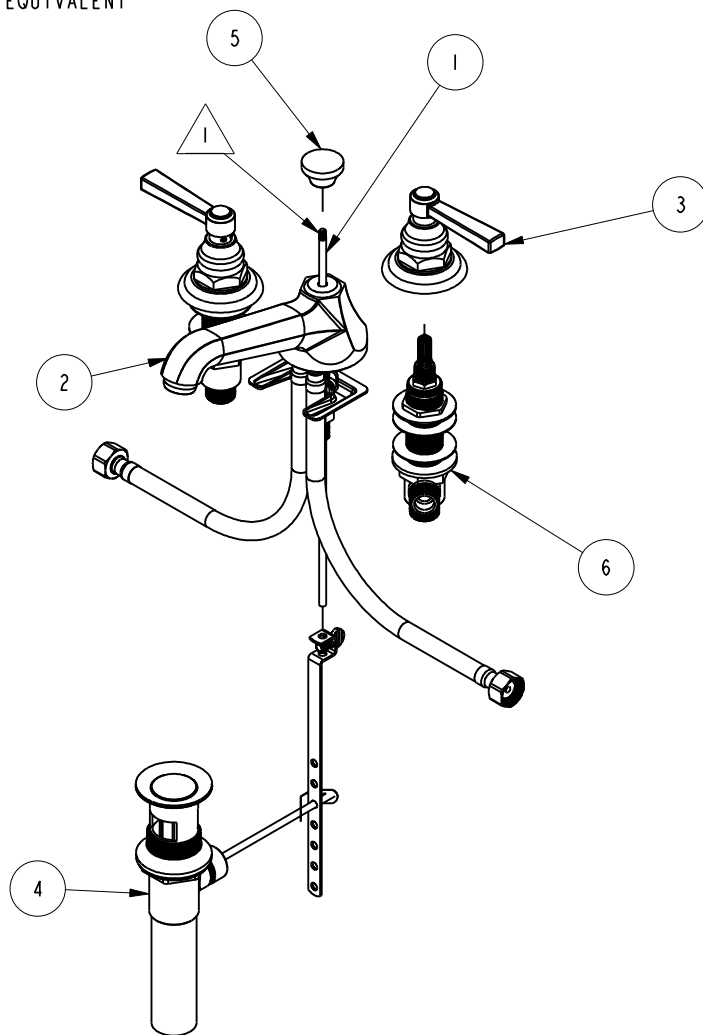

APPLY LOCTITE 680 OR EQUIVALENT



BILL OF MATERIAL (CURRENT LEVEL)

ITEM	PT/ASSY	DESCRIPTION	TYPE	QTY.
1	10288	3/16" POP UP ROD	PART	1
2	3-346	ASSY, SPOUT	ASSEMBLY	1
3	3-343	HANDLE ASM	ASSEMBLY	2
4	325	POP UP ASSEMBLY	ASSEMBLY	1
5	10961	SMOOTH POP - UP KNOB	PART	1
6	1-525	W/S VALVE INSTALLATION	ASSEMBLY	1

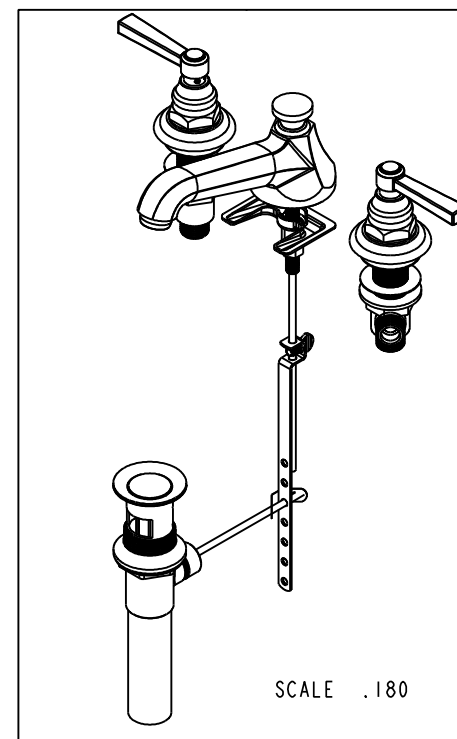

COPYRIGHT 2005 BRASSTECH, INC. THESE DRAWINGS AND THE DESIGNS DEPICTED HEREIN ARE THE PROPRIETARY PROPERTY OF BRASSTECH. ANY USE OR REPRODUCTION IS SUBJECT TO THE EXPRESS APPROVAL OF BRASSTECH. UNAUTHORIZED USE IS STRICTLY PROHIBITED. ALL RIGHTS RESERVED.

BRASSTECH
INCORPORATED

2001 E. CARNEGIE AVE.
SANTA ANA, CA 92705
(949) 417-5207

WIDESPREAD FAUCET

ASSY. NO.		-	-	-
910		-	EN-2621	11/21/13
SCALE .188	REF. -	SHEET 1 OF 2	REV	REV DESC DATE

SPECIFICATION DWG

The drawing illustrates the specifications for a faucet assembly. It includes a side view on the left and top and front views on the right. Dimensions are provided in inches.

Side View Dimensions:

- Spout height: $2\frac{3}{4}$
- Spout reach: $5\frac{5}{8}$
- Deck to base height: $10\frac{1}{8}$

Top View Dimensions:

- Spout width: $2\frac{7}{8}$
- Deck to base height: $2\frac{5}{8}$
- Base diameter: $\phi 1\frac{3}{4}$
- Spout diameter: $\phi 2\frac{1}{2}$
- Spout to base distance: $4\text{ TO }10$
- Base to stem distance: $2\frac{9}{16}$
- Stem diameter: $\phi 3/16$
- Stem length: $3\frac{11}{16}$

Front View Dimensions:

- Deck to base height: $2\frac{5}{16}$
- Base diameter: $\phi 1$
- Base to stem distance: $1\frac{11}{16}$
- Stem diameter: $\phi 3/16$
- Stem length: $3\frac{11}{16}$
- Stem to base distance: $4\text{ TO }10$
- Stem to base distance: $2\frac{5}{16}$ (AMOUNT OF STEM REQ. FROM DECK)
- Stem to base distance: $1/2\text{ NPSM}$

Dimensions are in inches and an approximation of a typical installation.

BRASSTECH INCORPORATED
2001 CARNEGIE AVE.
SANTA ANA, CA 92705
(949) 417-5207

DWG NO. 910

SCALE .375 REF. - SHEET 2 OF 2

COPYRIGHT 2005 BRASSTECH, INC. THESE DRAWINGS AND THE DESIGNS DEPICTED HEREIN ARE THE PROPRIETARY PROPERTY OF BRASSTECH, ANY USE OR REPRODUCTION IS SUBJECT TO THE EXPRESS APPROVAL OF BRASSTECH. UNAUTHORIZED USE IS STRICTLY PROHIBITED. ALL RIGHTS RESERVED.

COPYRIGHT 2005 BRASSTECH, INC. THESE DRAWINGS AND THE DESIGNS DEPICTED HEREIN ARE THE PROPRIETARY PROPERTY OF BRASSTECH. ANY USE OR REPRODUCTION IS SUBJECT TO THE EXPRESS APPROVAL OF BRASSTECH. UNAUTHORIZED USE IS STRICTLY PROHIBITED. ALL RIGHTS RESERVED.

2001 CARNEGIE AVE.
SANTA ANA, CA 92705
(949) 417-5207

910

SCALE .375

REF.	-
------	---

SHEET 2 OF 2