

Technical drawing showing two views of a faucet assembly. The top view is a perspective drawing of a single-lever faucet with a curved spout and a cylindrical handle. The bottom view is a perspective drawing of a separate component, likely a cartridge or stem, featuring a cylindrical body with a flared top section and a small circular feature on the side.

SCALE .200"

BRASSTECH
INCORPORATED

2001 E. CARNEGIE AVE.
SANTA ANA, CA 92705
(949) 417-5207

ASSY. NO.			-	-	-
1203			-	EN-1883	04/11/12
SCALE	.225	REF. -	SHEET 1 OF 2	REV	REV DESC
					DATE

SPECIFICATION DWG

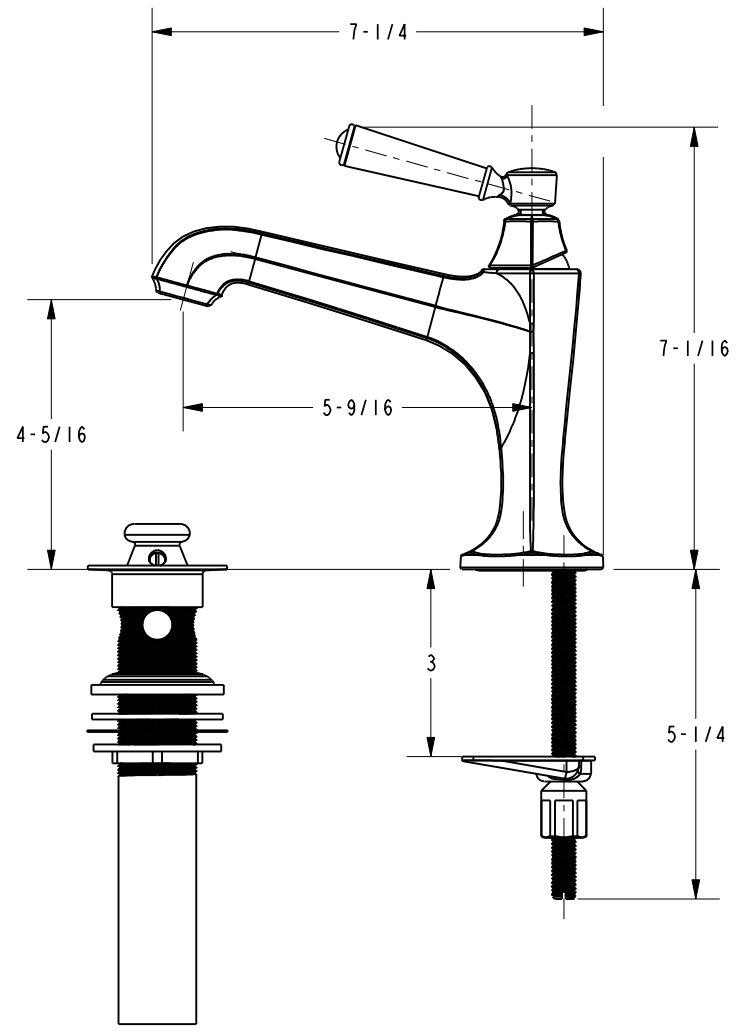
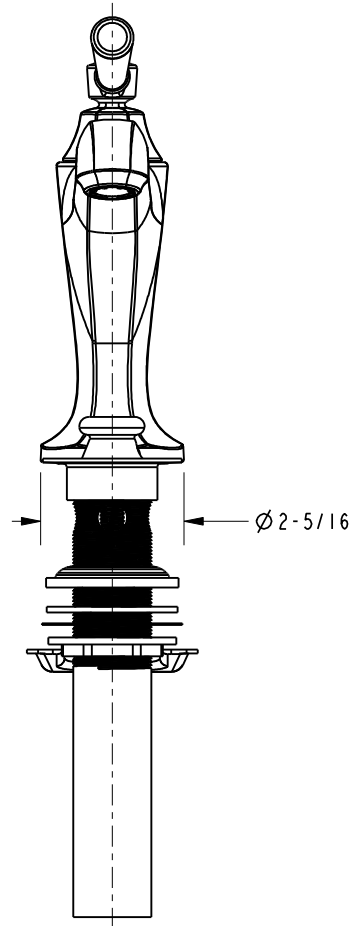

DIMENSIONS ARE IN INCHES AND AN APPROXIMATION OF A TYPICAL INSTALLATION

COPYRIGHT 2005 BRASSTECH, INC. THESE DRAWINGS AND THE DESIGNS DEPICTED HEREIN ARE THE PROPRIETARY PROPERTY OF BRASSTECH. ANY USE OR REPRODUCTION IS SUBJECT TO THE EXPRESS APPROVAL OF BRASSTECH. UNAUTHORIZED USE IS STRICTLY PROHIBITED. ALL RIGHTS RESERVED.

BRASSTECH
INCORPORATED

2001 CARNEGIE AVE.
SANTA ANA, CA 92705
(949) 417-5207

DWG NO.	1203	REV	-
SCALE	.325	REF.	-
SHEET	2	OF	2