

Trapeze Plus FR Range



The all-steel Trapeze Plus FR is supplied with stainless steel wire for the suspension of services where fire resistance is required

FEATURES / BENEFITS

- Reduced time working at height; pre-install into channel using the pre-fitted washer and channel nut supplied
- Fire Rated: BRE tested to F120 to the temperatures associated with BS476 Part 20 / DIN4102 Part 2. Independent test data available with load limits and exposure times
- Tool free setting; easy-to-use integral adjustment button
- Tighten the locking screw for ultimate security
- Channel can be multi-tiered to optimise space
- Supplied as a ready-to-use kit with Stainless Steel wire rope (No. 2 / No. 3) or Galvanised Mild Steel wire rope (No. 4)



INSTALLATION & ADJUSTMENT

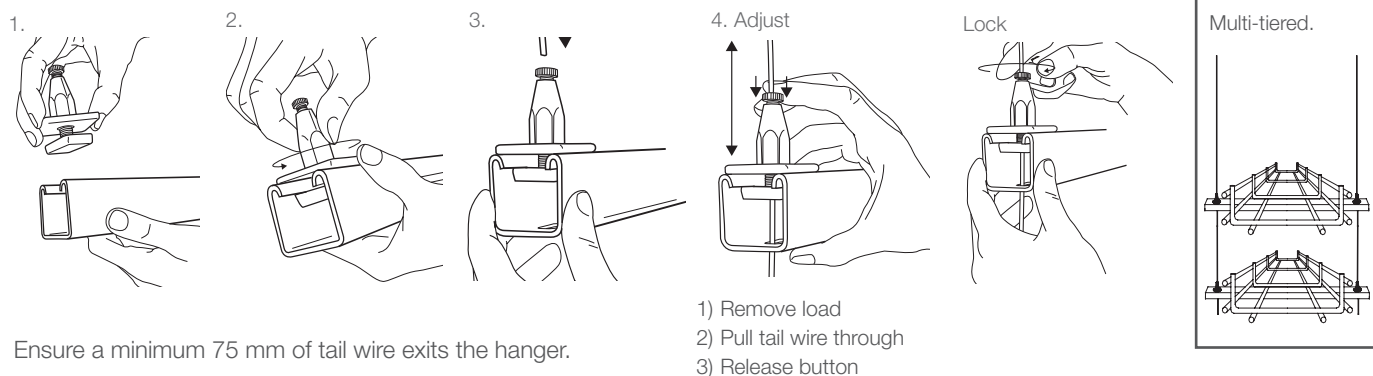

SPECIFICATION

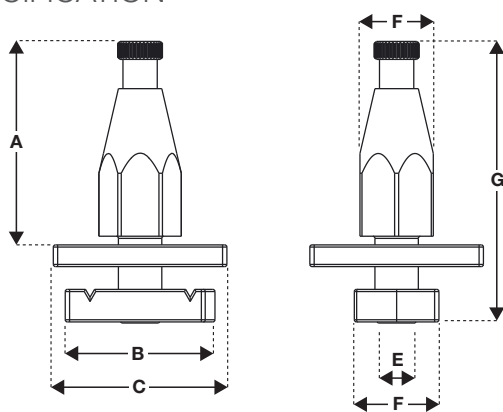

Also available with
M8, M10 and M12
(No.4) flange nut

Dimension	No.2 (mm)	No.3 (mm)	No.4 (mm)
A	38	45	55
B	35	35	35
C	40 x 40 max	40 x 40 max	40 x 40 max
D	15	17	22
E	M8	M10	M10
F	20	20	20
G	58	65	74

AVAILABLE END FIXINGS



For more options on available end fixings
please contact us or visit www.gripple.com

SUBMITTAL INFORMATION

Safe Working Load:

No.2 wire - 45 kg @ 3:1 safety factor
No.3 wire - 90 kg @ 3:1 safety factor
No.4 wire - 225 kg @ 3:1 safety factor

Material:

Carriage - Mild Steel (Type EN1A) - Bright Zinc Plated

Balls - Grade 40 Chrome Steel

Spring - Stainless Steel (Type 302)

Locking nut - (knurled) Mild Steel (Type EN1A) - Bright Zinc Plated

Threaded Adaptor - Mild Steel (Type EN1A) - Bright Zinc Plated

Housing - Mild Steel (Type EN1A) - Bright Zinc Plated

Nut - Mild Steel (Type EN1A) - Bright Zinc Plated

PI-TRAPEZEPLUSFR-ENG

www.gripple.com

Gripple's policy is one of continuous development and innovation.
We therefore reserve the right to alter specifications, etc. without notice.



Gripple Ltd | The Old West Gun Works | Savile Street East | Sheffield S4 7UQ
Tel 0800 018 4264 Fax 0114 275 1155 email info@gripple.com