



MULTI FITTINGS

LAYING LENGTH

ISSUE DATE: 2017 11 30
SUPERCEDES: 2005 08 05

TEE (BxBxB)

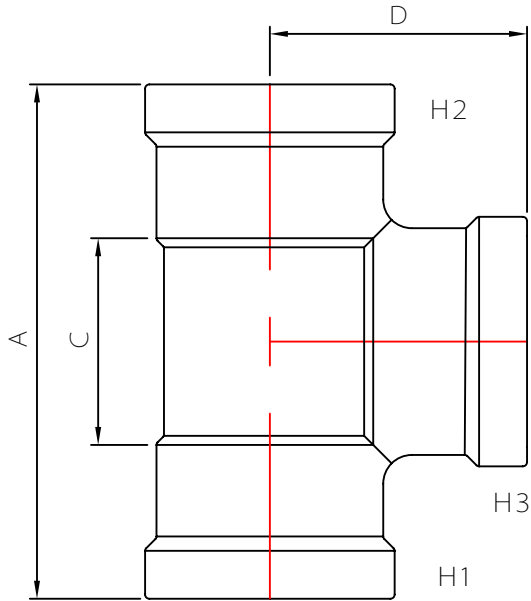

INJECTION MOLDED FITTING (M)

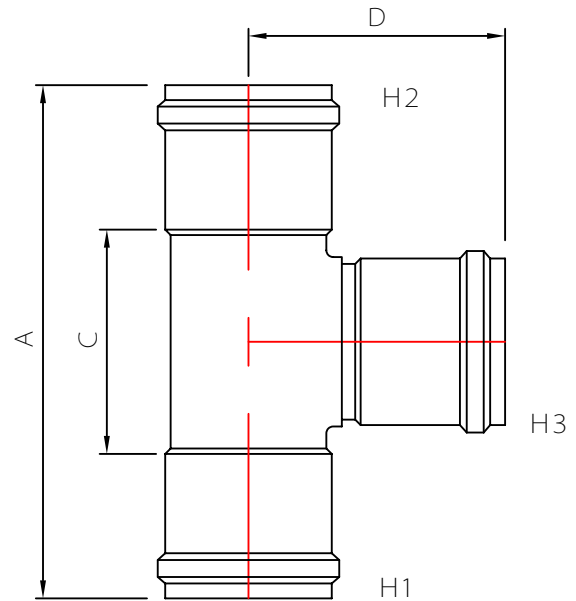

FABRICATED FITTING (F)

	SIZE H1xH2xH3	PART NUMBER	A REF	C REF	D REF
M=	4x4x4	274001	14.125	5.250	7.000
M=	6x6x4	274002	16.000	5.500	8.125
M=	6x6x6	274003	18.000	7.500	9.000
M=	8x8x4	274004	18.000	6.000	9.500
M=	8x8x6	274005	22.500	10.500	10.375
M=	8x8x8	274006	22.500	10.500	11.250
F@	10x10x4	532014	-	-	-
F@	10x10x6	532018	-	-	-
F@	10x10x8	532022	-	-	-
F@	10x10x10	531976	36.750	21.000	17.875
F@	12x12x4	532026	-	-	-
F@	12x12x6	532030	-	-	-
F@	12x12x8	532034	-	-	-
F@	12x12x10	532038	-	-	-
F@	12x12x12	531980	-	-	-

Note: = Refer to Page C9S4 for Hub Detail
@ Refer to Page C9S5 for Hub Detail