



Project: _____

Fixture Type: _____

Location: _____

Contact/Phone: _____

4" IC 600 LUMEN LED DOWNLIGHT NEW CONSTRUCTION

IC 1 LED (G4 06LM) RECESSED HOUSING

**OPEN TRIMS**

PRODUCT DESCRIPTION

Dedicated LED, Air-Loc® sealed new construction housing with integral light engine • Double wall, shallow housing construction allows for fit in 2 x 6 construction • Can be completely covered with insulation • Fully sealed housing stops infiltration and exfiltration of air, reducing heating and air cooling costs without the use of additional gaskets • LED housing is designed to provide 50,000 hours of life and is compatible with many standard Juno trims • 5 year limited warranty on LED components.

ENVIRONMENTALLY FRIENDLY, ENERGY EFFICIENT

- No harmful ultraviolet or infrared wavelengths
- No lead or mercury, RoHS compliant
- Comparable light output to 65W incandescent

PRODUCT SPECIFICATIONS

LED Light Engine LED array attached to high purity aluminum, thermally conductive inner housing provides superior heat transfer to ensure long life of the LED • Replaceable light engine mounts directly to inner housing assembly and incorporates the latest generation, high lumen output LED array • LEDs are binned within a 3-step MacAdam Ellipse exceeding ENERGY STAR® requirements for superior fixture to fixture color uniformity • 2700K, 3000K, 3500K, or 4000K color temperatures available • 90 CRI minimum.

Optical System Computer-optimized reflector design with high reflectance finish coupled with a high transmission diffusing lens conceals the LEDs and produces uniform aperture luminance.

Aesthetic Trim Selections Compatible with wide selection of existing Juno trims • Shadow free, knife edge design blends seamlessly into ceiling.

LED Driver Choice of dedicated 120 volt (120) driver or universal voltage (MVOLT) drivers that accommodate input voltages from 120-277 volts AC at 50/60Hz • Power factor > 0.9 at 120V input • 120 volt only driver is dimmable with the use of most incandescent, magnetic low voltage and electronic low voltage wall box dimmers • Universal voltage drivers are dimmable with the use of most 0-10V wall box dimmers • For a list of compatible dimmers, see [JUNOICLED-DIM](#) • Mounted inside housing for easy access from below ceiling.

Life Rated for 50,000 hours at 70% lumen maintenance.

Labels ENERGY STAR® Certified when used with select trims • Certified to the high efficacy requirements of California T24 JA8-2016 with select trims • UL listed for U.S. and Canada through-branch wiring, damp locations • Union made • UL and cUL.

Testing All reports are based on published industry procedures; field performance may differ from laboratory performance.

Specifications subject to change without notice.

HOUSING FEATURES

Housing Designed for use in IC (insulated ceiling) or non-IC construction • Aluminum housing sealed for Air-Loc® compliance • Housing is vertically adjustable to accommodate up to a 1 1/2" ceiling thickness.

Junction Box Pre-wired junction box provided with (6) 1/2" and (1) 3/4" knockouts, (4) knockouts for 12/2 or 14/2 NM cable and ground wire • UL listed and cUL listed for through-branch wiring, maximum 6 #12 branch circuit conductors • Junction box provided with removable access plates • Knockouts equipped with pryout slots • Quick connect electrical connectors supplied as standard for fast, secure installation.

Mounting Frame 22-gauge die-formed galvanized steel mounting frame • Rough-in section (junction box, mounting frame, housing and bar hangers) fully assembled for ease of installation.

Real Nail 3 Bar Hangers Telescoping Real Nail® 3 system permits quick placement of housing anywhere within 24" O.C. joists or suspended ceilings • Includes removable nail for repositioning of fixture in wood joist construction • Integral T-bar notch and clip for suspended ceilings • Design covered under US Patent D552,969.

* Nominal input wattage @ 120-volt operation with dedicated 120-volt driver under stable operating conditions.



DIMENSIONS

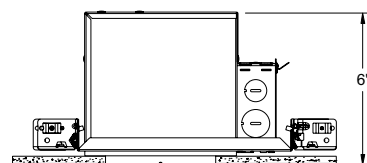
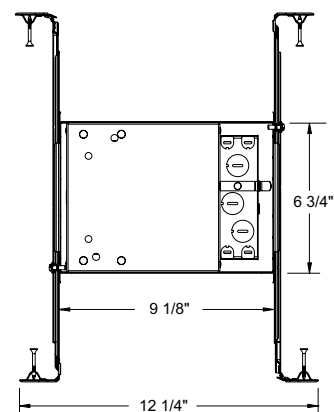

4 1/2" CEILING CUTOUT

4" IC 600 LUMEN LED DOWNLIGHT NEW CONSTRUCTION

IC1 LED (G4 06LM) RECESSED HOUSING
OPEN TRIMS

ELECTRICAL DATA

Dedicated 120V Only Driver Option (120 FRPC)

120V	
Input Power	8.6W (+/-5%)
Input Current	0.07A
Frequency	50/60Hz
EMI/RFI	FCC Title 47 CFR, Part 15, Class B (residential)
Minimum starting temp	-25°C

ELECTRICAL DATA

Universal Voltage

	MVOLT EZ10 and EZ1		MVOLT ZT10 and ZT1	
	120V	277V	120V	277V
Input Power	8.3W (+/-5%)	8.9W (+/-5%)	8.3W (+/-5%)	8.9W (+/-5%)
Input Current	0.07A	0.03A	0.07A	0.03A
Frequency	50/60Hz	50/60Hz	50/60Hz	50/60Hz
EMI/RFI	FCC Title 47 CFR, Part 15, Class B (residential)	FCC Title 47 CFR, Part 15, Class B (residential)	FCC Title 47 CFR, Part 15, Class B (residential)	FCC Title 47 CFR, Part 15, Class B (residential)
Minimum starting temp	-20°C	-20°C	-20°C	-20°C

ORDERING INFORMATION

Housing and trim can be ordered together or separate, but will always ship separately.

Example: IC1LED G4 06LM 27K 90CRI 120 FRPC

Series	Generation	Lumens	Color Temperature	CRI	Voltage/Driver
IC1LED 4" LED IC New Construction Downlight	G4 Generation 4	06LM 600 Nominal Lumens	27K 2700K 30K 3000K 35K 3500K 40K 4000K	90CRI 90+ CRI	120 FRPC 120V Forward/Reverse Phase Cut, 5% dim MVOLT ZT10 Multi-Volt (120-277), 0-10V, 10% dim MVOLT ZT1 Multi-Volt (120-277), 0-10V, 1% dim MVOLT EZ10 Multi-Volt (120-277), eidoLED 0-10V, 10% dim MVOLT EZ1 Multi-Volt (120-277), eidoLED 0-10V, 1% dim

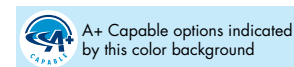

Trim/Description

	13 WH	4" Downlight Pinhole with Integral Shield Trim - White		4103 FROSTSC¹	4" Decorative Beveled Cylinder Trim - Frosted Glass, Satin Chrome Trim Ring
	14 BABZ¹	4" Downlight Baffle Trim - Black Baffle, Classic Aged Bronze Trim Ring		4103 FROSTWH¹	4" Decorative Beveled Cylinder Trim - Frosted Glass, White Trim Ring
	14 BBL¹	4" Downlight Baffle Trim - Black Baffle, Black Trim Ring		4104 HZSC	4" Decorative Beveled Cone Trim - Haze Cone, Satin Chrome Trim Ring
	14 BSC¹	4" Downlight Baffle Trim - Black Baffle, Satin Chrome Trim Ring		4104 WHZABZ	4" Decorative Beveled Cone Trim - Wheat Haze, Classic Aged Bronze Trim Ring
	14 BWH¹	4" Downlight Baffle Trim - Black Baffle, White Trim Ring		4150 MESHSC	4" Decorative Glass Cylinder Trim - Mesh Glass, Satin Chrome Trim Ring
	14 WWH	4" Downlight Baffle Trim - White Baffle, White Trim Ring			
	17 BWH	4" Downlight Cone Trim - Black Cone, White Trim Ring			
	17 CWH	4" Downlight Cone Trim - Clear Alzak® Cone, White Trim Ring			
	17 GWH	4" Downlight Cone Trim - Gold Cone, White Trim Ring			
	17 HZWH	4" Downlight Cone Trim - Haze Cone, White Trim Ring			
	17 PTSC	4" Downlight Cone Trim - Pewter Cone, Satin Chrome Trim Ring			
	17 WHZABZ	4" Downlight Cone Trim - Wheat Haze Cone, Classic Aged Bronze Trim Ring			
	17 WHZWH	4" Downlight Cone Trim - Wheat Haze Cone, White Trim Ring			
	17 WWH	4" Downlight Cone Trim - White Cone, White Trim Ring			

Trim Size: 5" O.D.

Alzak is a registered trademark of Alcoa Corp.

Note: In Canada when insulation is present, Type IC fixtures must be used.

¹ Multi-Volt: T24 @ 30K, 35K, 40K only

4" IC 600 LUMEN LED DOWNLIGHT NEW CONSTRUCTION

IC1LED (G4 06LM) RECESSED HOUSING
OPEN TRIMS

PHOTOMETRICS

PHOTOMETRIC REPORT

Test Report #: PT02141303R
Catalog No: IC1LED G4 06LM 35K
90CRI 120 with 14 WWH Trim

Luminaire Spacing Criterion: 0.72

Luminaire LPW: 77

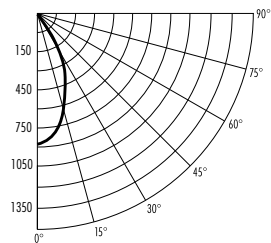

CANDLEPOWER DISTRIBUTION (Candelas)

Degrees	Candelas
Vertical	0°
0	1055
5	1026
15	791
25	425
35	146
45	38
55	16
65	7
75	5
85	0
90	0

Multiplier: 27K - 0.89
30K - 0.94
40K - 1.03

AVERAGE INITIAL FOOTCANDLES

Multiple Units (Square Array, 60'x60' room)
Ceiling 80% Wall 50% Floor 20%

Spacing	RCR1	RCR3	RCR5
4.0'	46	40	35
5.0'	29	26	23
6.0'	20	18	16
7.0'	17	14	13
8.0'	13	11	10
9.0'	10	9	8
10.0'	7	6	6

ZONAL LUMEN SUMMARY

Zone	Lumens	%Lamp	%Fixture
0-30°	507	N/A	76.5
0-40°	603	N/A	91.0
0-60°	649	N/A	98.0
0-90°	663	N/A	100.0

INITIAL FOOTCANDLES (One Unit, 8.6W, 44.2° Beam)

Distance to Illuminated Plane (Feet)	Footcandles Beam Center	Beam Diameter
4	65.9	3.2'
6	29.3	4.9'
8	16.5	6.5'
10	10.6	8.1'

LUMINANCE (Average cd/m²)

Degrees	Average Luminance
45	8859
55	4517
65	2855
75	2880
85	1425

PHOTOMETRIC REPORT

Test Report #: LTL26327R
Catalog No: IC1LED G4 06LM 35K
90CRI 120 with 17 CWH Trim

Luminaire Spacing Criterion: 0.70

Luminaire LPW: 81

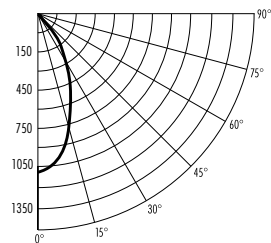

CANDLEPOWER DISTRIBUTION (Candelas)

Degrees	Candelas
Vertical	0°
0	1072
5	1054
15	785
25	441
35	181
45	59
55	18
65	0
75	0
85	0
90	0

Multiplier: 27K - 0.89
30K - 0.94
40K - 1.03

AVERAGE INITIAL FOOTCANDLES

Multiple Units (Square Array, 60'x60' room)
Ceiling 80% Wall 50% Floor 20%

Spacing	RCR1	RCR3	RCR5
4.0'	48	42	37
5.0'	31	27	24
6.0'	22	19	16
7.0'	17	15	13
8.0'	14	12	11
9.0'	11	9	8
10.0'	8	7	6

ZONAL LUMEN SUMMARY

Zone	Lumens	%Lamp	%Fixture
0-30°	516	N/A	73.9
0-40°	631	N/A	90.5
0-60°	695	N/A	99.6
0-90°	698	N/A	100.0

INITIAL FOOTCANDLES (One Unit, 8.6W, 43.9° Beam)

Distance to Illuminated Plane (Feet)	Footcandles Beam Center	Beam Diameter
4	67.0	3.2'
6	29.8	4.8'
8	16.8	6.4'
10	10.7	8.1'

LUMINANCE (Average cd/m²)

Degrees	Average Luminance
45	13321
55	5080
65	766
75	0
85	0

Fixtures tested to IES recommended standard for solid state lighting per LM-79-08. Photometric performance on a single unit represents a baseline of performance for the fixture. Results may vary in the field.