

WIRE ROPE SLING HARDWARE

Latchlok Eye Hooks

- Heavy-duty latch with lock prevents accidental opening.
- Drop forged alloy steel.
- Durable powder-coated finish.
- Design factor 5:1.

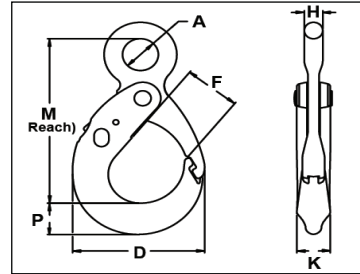

Part Number	¹Rated Capacity		Dimensions (in.)							Weight Each (lbs.)
	TONS	LBS	A	M	P	D	F	H	K	
932G10ELLH	1.7	3,400	1.09	537	0.88	3.77	1.64	0.47	0.91	2.50
38G10ELLH	3.5	7,000	1.36	6.65	1.07	4.74	2.27	0.59	1.15	4.74
12G10ELLH	6.0	12,000	1.57	8.79	1.58	6.26	2.91	0.80	1.47	10.00
58G10ELLH	9.0	18,000	2.00	10.37	1.97	7.37	3.22	1.03	1.85	16.00

Swivel Latchlok Hooks with Bushings

- Hook swivels beneath the eye.
- Heavy-duty latch with lock prevents accidental opening.
- Durable powder-coated finish.
- Positive locking hook.
- Design factor 5:1.

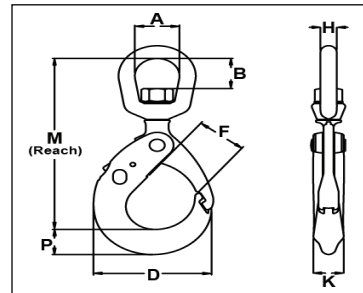

Part Number	Size	¹Rated Capacity		Dimensions (in.)								Weight Each (lbs.)
		TONS	LBS	H	M	P	D	F	A	B	K	
932G10SLLH	9/32	1.7	3,400	0.62	7.17	0.88	3.77	1.64	1.50	1.33	0.91	3.5
38G10SLLH	3/8	3.5	7,000	0.77	8.73	1.07	4.76	2.26	1.75	1.63	1.15	4.8
12G10SLLH	1/2	6.0	12,000	0.93	11.18	1.58	6.26	2.91	1.00	1.76	1.47	10.6
58G10SLLH	5/8	9.0	18,000	1.00	13.35	1.97	7.37	3.22	2.75	2.38	1.85	17.0

USING LATCHLOK™ HOOKS SAFELY

- △ Do not apply load unless latch and hook are completely closed and locked.
- △ Make certain that the latch does not support any part of the the load.
- △ When lifting, make certain that the load is firmly seated in the base (bowl) of the hook.
- △ Inspect hook and latch periodically. If the hook or latch is damaged or if the latch fails to interlock with the tip, the hook should be removed from service.
- △ Do not exceed the working load limit.
- △ Do not use if the hook is visibly distorted, damaged, or worn.
- △ Keep body and other objects clear of the latch when closing to avoid the pinch point.
- △ Do not side load or tip load hook.
- △ User should be properly trained and understand safe rigging practices.

¹Rated Capacity also referred to as "Working Load Limit"