

# Victaulic FireLock™ Innovative Groove System | IGS™ for 1"/DN25 Sprinkler Pipe



						
No. 142 Welded Outlet	Style 922 Outlet-T	Style 920N Mechanical-T Outlet	No. 101 Installation-Ready™ 90° Elbow	No. 102 Installation-Ready™ Tee	No. 103 Installation-Ready™ 45° Elbow	Style 108 Installation-Ready™ Rigid Coupling
						
Style 115 OGS x IGS Reducing Coupling	Style 118 1" Outlet Coupling	No. 65 OGS x IGS Grooved End of Run Fitting	No. 111 IGS Grooved End Elbow	No. 113 OGS x IGS x IGS Reduce on the Run and Outlet Tee	No. 114 IGS x IGS x IGS Grooved Tee	No. 117 IGS 45° Elbow
						
No. 143 Close Nipple	No. 144 OGS x IGS Grooved Concentric Reducer	No. 145 Female NPT or BSPT Threaded x Groove 90° Elbow	No. 147 Back-To-Back sprinkler tee	No. 148 Sprinkler Reducer, NPT or BSPT sprinkler outlet	No. 140 Male NPT or BSPT Threaded x Groove Adapter	No. 141 Female NPT or BSPT Threaded x Groove Adapter
						
No. 116 CPVC Female Socket x Brass IGS Groove Adapter (Refer to <a href="#">publication 10.85</a> and <a href="#">10.95</a> )	No. 146 Cap	WB-1 IGS Weld Plunger Cone	NAP-1 IGS Weld Plunger Cone	RG2910 Roll Grooving Tool	RG1 Manual Roll Grooving Tool (Refer to <a href="#">publication 24.01</a> )	VicFlex™ Series AH2-CC Braided Flexible Hose with Captured Coupling (Refer to <a href="#">publication 10.85</a> )
						
VicFlex™ Series AH1-CC Braided Flexible Hose with Captured Coupling (Refer to <a href="#">publication 10.95</a> )						

ALWAYS REFER TO ANY NOTIFICATIONS AT THE END OF THIS DOCUMENT REGARDING PRODUCT INSTALLATION, MAINTENANCE OR SUPPORT.

## 1.0 PRODUCT DESCRIPTION

### Pipe Material

- Carbon steel, Sch. 40, Sch. 10, light-wall/specialty pipe. For use with alternative materials please contact Victaulic.
- For exceptions reference section 6.0 Notifications

### Maximum Working Pressure

- Up to 365 psi/2517 kPa/25 bar

### Pipe Preparation

- Cut (Sch. 40) or roll (Sch. 40, Sch. 10, light-wall) grooved in accordance with publication 25.14: Victaulic *IGS* Groove Specifications

### RG2910 Grooving Capability

- Reference [publication 24.21](#)

## 2.0 CERTIFICATION/LISTINGS



LPS 1219: Issue 3.1

EN 10311  
CPR (EU)  
No. 305/2011

BS EN 10311  
CPR (UK)  
2019 No. 465

Cert/LPCB Ref. 104-1a/39, 104-1a/41, 104-1a/42, 104-1b/03, 104-1b/04, 104-1b/05, 104-1b/06, 104-1b/07, 104-1b/08, 104-1b/09, 104-1b/10, 104-1b/11

### NOTES

- Approvals listed above do not apply to the RG2910 Roll Grooving Tool.

## 3.0 SPECIFICATIONS – MATERIAL

**Housing:** Ductile iron conforming to ASTM A536, Grade 65-45-12

### Housing Coating: (specify choice)

Orange coating.

Red coating (standard for EMEA-I and Asia Pacific).

Optional: Hot dipped galvanized.

### Gasket:

#### Grade "E" EPDM (Type A) Vic-Plus™ Pre-lubricated Gasket

EPDM (Violet Color Code). Applicable for wet and dry (oil-free air) fire protection systems only. Listed/Approved for continuous use in wet and dry systems. Listed/Approved for dry systems at -40°F/-40°C and above. NOT COMPATIBLE FOR USE WITH HOT WATER SERVICES OR STEAM SERVICES.

### NOTES:

- Reference should always be made to [publication I-100](#), Victaulic Field Installation Handbook for gasket lubrication instructions.
- Services listed are General Service Guidelines only. It should be noted that there are services for which these gaskets are not compatible. Reference should always be made to [publication Q5.01](#), Victaulic Gasket Selection Guide for specific gasket service guidelines and for a listing of services which are not compatible.

### Bolts/Nuts:

Carbon steel oval neck track bolts meeting the mechanical property requirements of ASTM A449 (imperial) and ISO 898-1 Class 9.8 (M10-M16) Class 8.8 (M20 and greater). Carbon steel hex nuts meeting the mechanical property requirements of ASTM A563 Grade B (imperial - heavy hex nuts) and ASTM A563M Class 9 (metric - hex nuts). Track bolts and hex nuts are zinc electroplated per ASTM B633 Fe/Zn 5, finish Type III (imperial) or Type II (metric).

### 3.0 SPECIFICATIONS – MATERIAL (CONTINUED)

---

**Coupling Linkage:** High Strength Steel with comparable physical properties to that of the Track Bolt (ASTM A449).  
Linkage is zinc electroplated per ASTM B633 Fe/Zn 5, Type III Finish

**No. 140, 141, 142, 143, 144, 148:** Carbon steel meeting the chemical and mechanical property requirements of ASTM A53 Grade A, Type E or S

**No. 65, 111, 113, 114, 117, 145, 146, 147:** Ductile iron conforming to ASTM A536, Grade 65-45-12

**No. WB-1:** Steel Alloy

**No. NAP-1:** Aluminum Alloy

**RG2910 Roll Grooving Tool:** Reference [publication 24.21](#)

## 4.0 DIMENSIONS

### No. 142 Welded Outlet

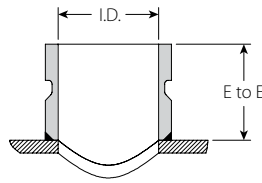

Nominal	Actual Outside Diameter	Inside Diameter	Weight	
inches DN	inches mm	I.D. inches mm	E to E inches mm	Approximate (Each) lb kg
Run x Branch	Run x Branch			
1 ¼ – 1 ½ DN32 – DN40	1.660 – 1.900 42.4 – 48.3	1.049 26.6	1.00 25.4	0.2 0.1
1 ½ – 2 DN40 – DN50	1.900 – 2.375 48.3 – 60.3	1.049 26.6	1.00 25.4	0.2 0.1
2 – 2 ½ DN50 – DN65	2.375 – 3.000 60.3 – 76.1	1.049 26.6	1.00 25.4	0.2 0.1
2 ½ – 3 DN65 – DN80	2.875 – 3.500 73.0 – 88.9	1.049 26.6	1.00 25.4	0.2 0.1
3 – 4 DN80 – DN100	3.500 – 4.500 88.9 – 114.3	1.049 26.6	1.00 25.4	0.2 0.1

## 4.1 DIMENSIONS

### Style 922 Outlet-T

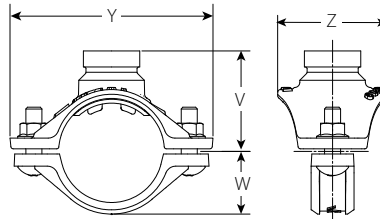

Size		Bolt/Nut		Dimensions						Weight
Nominal inches DN	Actual Outside Diameter inches mm	Qty.	Size inches mm	Minimum Hole Diameter/Hole Saw Size inches mm	Maximum Hole Diameter/ Hole Saw Size inches mm	Y inches mm	V inches mm	W inches mm	Z inches mm	Approximate (Each) lb kg
Run x Branch	Run x Branch									
1 ¼ DN32	1.660 42.4	2	¾ x 1 ¾	1 ⅜ 30.0	1 ¼ 32.0	4.13 105.0	1.98 50.3	1.10 27.9	2.70 68.6	1.1 0.5
1 ½ DN40	1.900 48.3	2	¾ x 1 ¾	1 ⅜ 30.0	1 ¼ 32.0	4.25 108.0	2.11 53.6	1.22 31.0	2.70 68.7	1.2 0.5
2 DN50	2.375 60.3	2	¾ x 1 ¾	1 ⅜ 30.0	1 ¼ 32.0	4.75 120.6	2.34 59.4	1.46 37.1	2.56 65.1	1.2 0.5
2 ½	2.875 73.0	2	¾ x 1 ¾	1 ⅜ 30.0	1 ¼ 32.0	5.50 139.7	2.67 67.8	1.71 43.4	2.56 65.1	1.6 0.7
DN65	3.000 76.1	2	¾ x 1 ¾	1 ⅜ 30.0	1 ¼ 32.0	5.52 140.3	2.75 69.8	1.71 43.4	2.56 65.1	1.7 0.8

## 4.2 DIMENSIONS

### Style 920N Mechanical-T Outlet

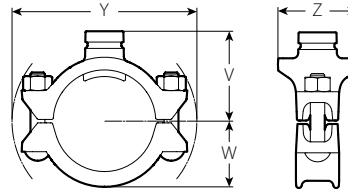

Size		Bolt/Nut		Dimensions						Weight	
Nominal inches DN	Actual Outside Diameter inches mm	Qty.	Size inches mm	Minimum Hole Diameter/Hole Saw Size inches mm	Maximum Hole Diameter/ Hole Saw Size inches mm	Y inches mm	V inches mm	W inches mm	Z inches mm	Approximate (Each) lb kg	
Run x Branch	Run x Branch										
3 DN80	1.315 88.9	2	1/2 x 2 3/4	1 1/2 38.1	1 5/8 41.0	6.42 163.0	3.12 79.2	2.28 57.9	2.75 69.9	2.7 1.2	
4 DN100	1.315 88.9	2	1/2 x 2 3/4	1 1/2 38.1	1 5/8 41.0	7.35 186.6	3.62 91.9	2.69 68.3	2.75 69.10	3.0 1.4	

## 4.3 DIMENSIONS

### No. 101 Installation-Ready 90° Elbow

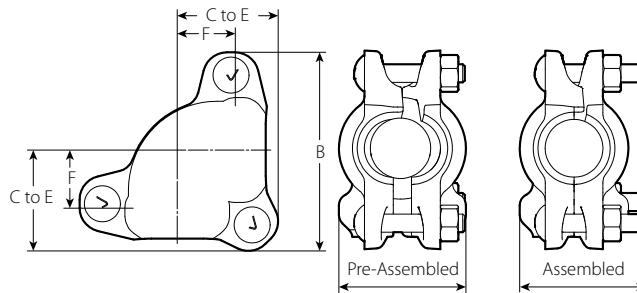

Size		Bolt/Nut		Dimensions					Weight	
Nominal inches DN	Actual Outside Diameter inches mm	Qty.	Size inches mm	F Take Out inches mm	C to E inches mm	B inches mm	Pre-Assembled inches mm	Assembled inches mm	Approximate (Each) lb kg	
1 DN25	1.315 33.7	3	3/8 x 2 M10 x 50	1.25 32	2.13 54	4.25 108	2.75 70	2.75 70	2.2 1.0	

#### NOTES

- Not for use with grooved sprinklers, for grooved sprinkler connections please refer to [publication 10.65](#) for the Style V9 sprinkler coupling.
- Contact Victaulic for torsional resistance information.

## 4.4 DIMENSIONS

### No. 102 Installation-Ready Tee

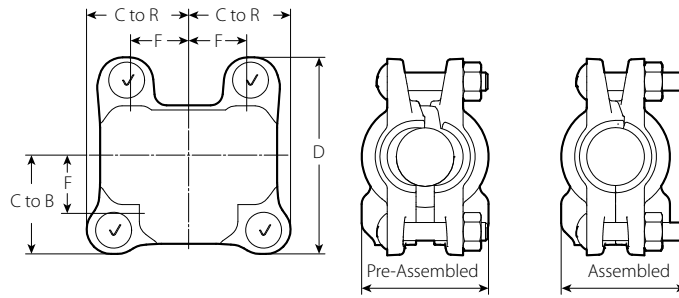

Size		Bolt/Nut		Dimensions						Weight
Nominal inches DN	Actual Outside Diameter inches mm	Qty.	Size inches mm	F Take Out inches mm	C to B inches mm	C to R inches mm	D inches mm	Pre-Assembled inches mm	Assembled inches mm	Approximate (Each) lb kg
1 DN25	1.315 33.7	4	<sup>3</sup> / <sub>8</sub> x 2 M10 x 50	1.25 32	2.13 54	2.13 54	4.13 105	2.75 70	2.75 70	3.0 1.4

#### NOTES

- Not for use with grooved sprinklers, for grooved sprinkler connections please refer to [publication 10.65](#) for the Style V9 sprinkler coupling.
- Contact Victaulic for torsional resistance information.

## 4.5 DIMENSIONS

### No. 103 Installation-Ready 45° Elbow

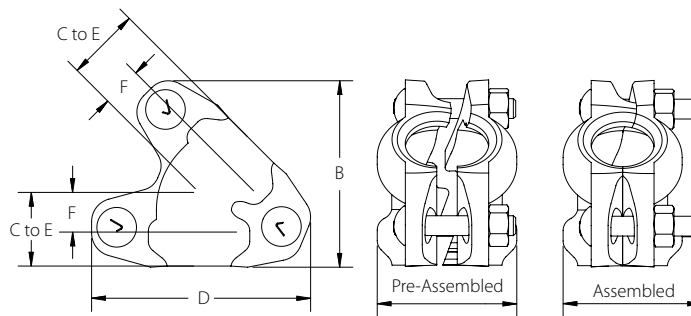

Size			Dimensions					Weight	
Nominal inches DN			F Take Out inches mm	C to E inches mm	B inches mm	D inches mm	Pre Assembled inches mm	Assembled inches mm	Approximate (Each) Lbs. kg
1 DN25	x	1 DN25	0.88 22	1.50 38	3.63 92	4.25 108	2.75 70	2.63 67	2.1 1.0

## 4.6 DIMENSIONS

### Style 108 Installation-Ready Rigid Coupling

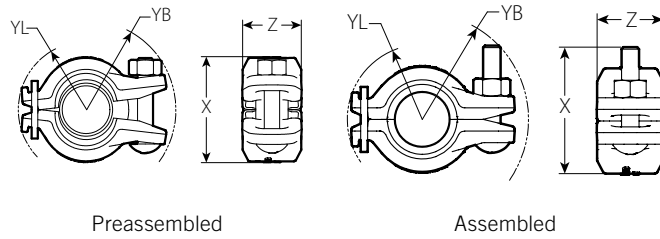

Size		Pipe End Separation <sup>1</sup>	Bolt/Nut		Dimensions								Weight
Nominal inches DN	Actual Outside Diameter inches mm	Allowable inches mm	Qty.	Size inches mm	Pre-Assembled				Assembled				Approx (Each) lb kg
					YL inches mm	YB inches mm	X inches mm	Z inches mm	YL inches mm	YB inches mm	X inches mm	Z inches mm	
1	1.315	0.14	1	3/8 x 2 M10 x 50	1.66	2.17	2.58	1.43	1.61	2.29	2.27	1.43	1.5
DN25	33.7	3.6			42.2	55.2	65.5	36.3	41.0	58.2	57.5	36.3	0.7

<sup>1</sup> The allowable pipe end separation dimension shown is for system layout purposes only. FireLock™ Style 108 rigid couplings are considered rigid connections and will not accommodate expansion or contraction of the piping system.

#### NOTES

- Not for use with grooved sprinklers, for grooved sprinkler connections please refer to [publication 10.65](#) for the Style V9 sprinkler coupling.
- Contact Victaulic for torsional resistance information.

## 4.7 DIMENSIONS

### Style 115 OGS x /GS Reducing Coupling

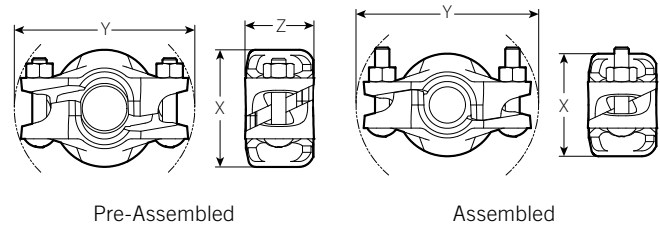

Size		Pipe End Separation <sup>2</sup>	Bolt/Nut		Dimensions						Weight
Nominal inches DN	Actual Outside Diameter inches mm	Allowable inches mm	Qty.	Size inches mm	Pre-Assembled			Assembled			Approximate (Each) lb kg
					X inches mm	Y inches mm	Z inches mm	X inches mm	Y inches mm	Z inches mm	
1 1/4 DN32	1 DN25	0.14 3.6	2	3/8 x 2 M10 x 50	3.13 79	4.75 121	1.75 44	2.63 67	4.75 121	1.75 44	1.9 0.9
1 1/2 DN40		0.14 3.6			3.25 83	4.88 124	1.75 44	2.88 73	4.88 124	1.75 44	2.1 0.9

<sup>2</sup> The allowable pipe end separation dimension shown is for system layout purposes only. FireLock™ Style 115 rigid couplings are considered rigid connections and will not accommodate expansion or contraction of the piping system.

#### NOTES

- Not for use with grooved sprinklers, for grooved sprinkler connections please refer to [publication 10.65](#) for the Style V9 sprinkler coupling.
- Contact Victaulic for torsional resistance information.

## 4.8 DIMENSIONS

### Style 118 1" Outlet Coupling

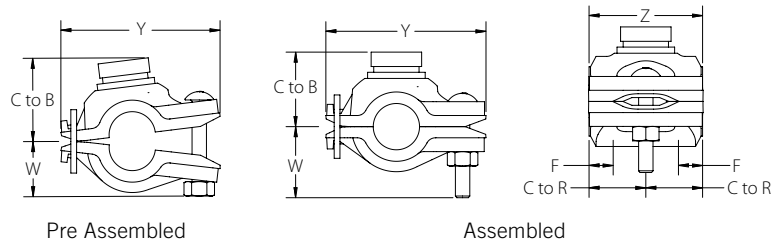

Size					Dimensions										Weight
Nominal inches DN					F Take Out inches mm	Z inches mm	C to R inches mm	Pre Assembled			Assembled			Approx. (Each) Lbs. kg	
								C to B inches mm	W inches mm	Y inches mm	C to B inches mm	W inches mm	Y inches mm		
1	X	1	X	1	0.75	3.00	1.50	2.25	1.50	4.25	2.00	1.88	4.25	2.4	
DN25		DN25		DN25	19	76	38	57	38	108	51	48	108	1.1	

## 4.9 DIMENSIONS

### No. 65 OGS x IGS Grooved End of Run Fitting

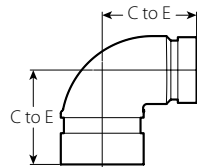

Size		Dimensions		Weight
Nominal inches DN	Actual Outside Diameter inches mm	C to E inches mm	Approximate (Each) lb kg	
1 ¼	1.660	1.88	0.7	
DN32	42.4	48	0.3	
1 ½	1.900	2.00	0.8	
DN40	48.3	51	0.4	
2	2.375	2.25	1.2	
DN50	60.3	57	0.5	
2 ½	2.875	2.50	1.6	
x 1	73.0	64	0.7	
DN25	33.7	2.50	1.7	
DN65	76.1	64	0.8	
3	3.500	2.75	2.6	
DN80	88.9	70	1.2	



## 4.10 DIMENSIONS

### No. 111 IGS Grooved End Elbow

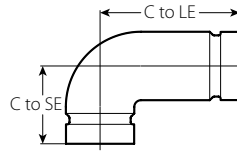

Size		Dimensions		Weight
Nominal inches DN	Actual Outside Diameter inches mm	C to LE inches mm	C to SE inches mm	Approximate (Each) lb kg
1 DN25	1.315 33.7	2.70 69	1.50 38	0.6 0.3

## 4.11 DIMENSIONS

### No. 113 OGS x IGS x IGS Reduce on the Run and Outlet Tee

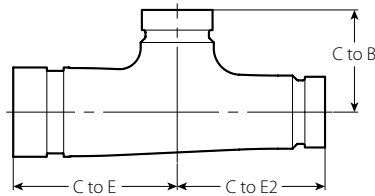

Size					Dimensions			Weight
Nominal inches DN					C to E inches mm	C to E2 inches mm	C to B inches mm	Approx. (Each) Lbs. kg
1 ¼ DN32	x	1 DN25	x	1 DN25	3.05 77	2.75 70	1.90 48	1.3 0.6
1 ½ DN40	x	1 DN25	x	1 DN25	3.05 77	2.75 70	2.03 52	1.3 0.6

## 4.12 DIMENSIONS

### No. 114 IGS x IGS x IGS Grooved Tee

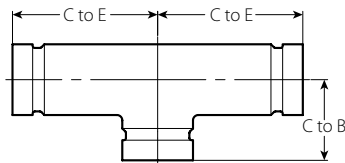

Size		Dimensions		Weight
Nominal inches DN	Actual Outside Diameter inches mm	C to E inches mm	C to B inches mm	Approx. (Each) lb kg
1 DN25	1.315 33.7	2.70 69	1.50 38	0.92 0.4

### 4.13 DIMENSIONS

#### No. 117 /GS 45° Elbow

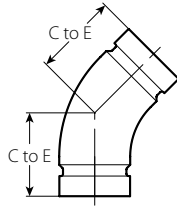

Size		Dimensions	Weight
Nominal inches DN	Actual Outside Diameter inches mm	C to E inches mm	Approx. (Each) lb kg
1 DN25	1.315 33.7	1.55 39	0.45 0.2

### 4.14 DIMENSIONS

#### No. 143 Close Nipple

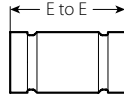

Size		Dimensions	Weight
Nominal inches DN	Actual Outside Diameter inches mm	E to E inches mm	Approximate (Each) lb kg
1 DN25	1.315 33.7	1.5 <sup>3</sup> 38	0.2 0.1
		2 51	0.3 0.1
		2.5 64	0.4 0.2
		3 76	0.4 0.2
		3.5 89	0.5 0.2
		4 102	0.6 0.3
		4.5 114	0.6 0.3
		5 127	0.7 0.3

<sup>3</sup> Bolt pad interferences may occur in some installation configurations.

### 4.15 DIMENSIONS

#### No. 144 OGS x IGS Grooved Concentric Reducer

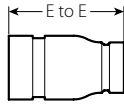

Size				Dimensions		Weight
Nominal inches DN		Actual Outside Diameter inches mm		E to E inches mm		Approximate (Each) lb kg
1 1/4 DN32	x	1.660 42.4	1.315 33.7	3.00 76	0.5 0.2	
1 1/2 DN40		1.900 48.3		3.00 76	0.6 0.2	

### 4.16 DIMENSIONS

#### No. 145 Female Threaded x Groove 90° Elbow

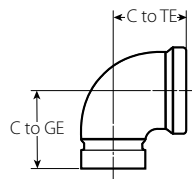

Size				Dimensions		Weight
Nominal inches DN		Actual Outside Diameter inches mm		C-TE	C-GE	Approximate (Each) lb kg
Threaded Outlet	Grooved Outlet	Threaded Outlet	Grooved Outlet	inches mm	inches mm	
1/2 DN15	x	0.840 21.3	1.315 33.7	1.45 36.8	1.60 40.6	0.5 0.2
3/4 DN20		1.050 26.9		1.45 36.8	1.60 40.6	0.5 0.2
1 DN25		1.315 33.7		1.50 38.1	1.60 40.6	0.5 0.2

### 4.17 DIMENSIONS

#### No. 147 Back-To-Back Sprinkler Tee

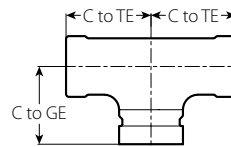

Size						Dimensions		Weight			
Nominal inches DN			Actual Outside Diameter inches mm			C-TE	C-GE	Approximate (Each) lb kg			
Threaded Outlet	Threaded Outlet	Grooved Outlet	Threaded Outlet	Threaded Outlet	Grooved Outlet	inches mm	inches mm				
1/2 DN15	x	1/2 DN15	x	0.840 21.3	x	0.840 21.3	x	1.315 33.7	1.75 44.5	1.60 40.6	0.7 0.3

**NOTE:**

- Approved for use with one or two 1/2" NPT Sprinklers threaded directly into outlet connection(s).

## 4.18 DIMENSIONS

### No. 148 Sprinkler Reducer



Length	Size		Threaded Outlet Size		Weight
	E to E inches mm	Nominal inches DN	Actual Outside Diameter inches mm	inches DN	Approximate (Each) lb kg
3 76	1 DN25	1.315 33.7	1/2 DN15	3/4 DN20	0.4 0.2
3.5 89	1 DN25	1.315 33.7	1/2 DN15	3/4 DN20	0.5 0.2
4 102	1 DN25	1.315 33.7	1/2 DN15	3/4 DN20	0.6 0.3
4.5 114	1 DN25	1.315 33.7	1/2 DN15	3/4 DN20	0.6 0.3
5 127	1 DN25	1.315 33.7	1/2 DN15	3/4 DN20	0.7 0.3
5.5 140	1 DN25	1.315 33.7	1/2 DN15	3/4 DN20	0.8 0.3
6 152	1 DN25	1.315 33.7	1/2 DN15	3/4 DN20	0.8 0.4
12 305	1 DN25	1.315 33.7	1/2 DN15	3/4 DN20	1.7 0.8
18 457	1 DN25	1.315 33.7	1/2 DN15	3/4 DN20	2.5 1.1
24 610	1 DN25	1.315 33.7	1/2 DN15	3/4 DN20	3.4 1.5
30 762	1 DN25	1.315 33.7	1/2 DN15	3/4 DN20	4.2 1.9

**NOTES**

- NPT or BSPT available
- It is acceptable to cut and groove any No. 148 longer than 6"/152mm. The minimum allowable cut length is 6"/152mm for a No. 148.

### No. 148 Double Ended Sprinkler Reducer

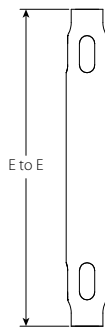

Length	Size		Threaded Outlet Size		Weight
	E to E inches mm	Nominal inches DN	Actual Outside Diameter inches mm	inches DN	Approximate (Each) lb kg
36 914	1 DN25	1.315 33.7	1/2 DN15	3/4 DN20	5.0 2.3

**NOTE**

- 36"/914mm size features sprinkler outlet on both ends for field fabrication.

### 4.19 DIMENSIONS

#### No. 140 Male Threaded x Groove Adapter

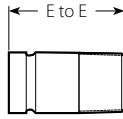

Size		Dimensions	Weight
Nominal	Actual Outside Diameter	E-E	Approximate (Each)
inches	inches	inches	lb
DN	mm	mm	kg
1	1.315	2.50	0.3
DN25	33.7	63.5	0.1

### 4.20 DIMENSIONS

#### No. 141 Female Threaded x Groove Adapter

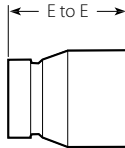

Size		Dimensions	Weight
Nominal	Actual Outside Diameter	E-E	Approximate (Each)
inches	inches	inches	lb
DN	mm	mm	kg
1	1.315	2.00	0.5
DN25	33.7	50.8	0.2

### 4.21 DIMENSIONS

#### No. 146 Cap

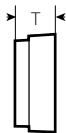

Size		Dimensions	Weight
Nominal	Actual Outside Diameter	T	Approximate (Each)
inches	inches	inches	lb
DN	mm	mm	kg
1	1.315	0.55	0.2
DN25	33.7	14.0	0.1

## 4.22 DIMENSIONS

### WB-1 Weld Plunger Cone

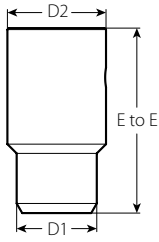

Dimensions			Weight
E to E	D1	D2	Approximate (Each)
inches	inches	inches	lb
mm	mm	mm	kg
3.75	1.63	2.00	2.2
95.3	41.3	50.8	51.0

**NOTE**

- WB-1 Weld Plunger Cones are for use with the No. 142 weld outlets and protect the groove during weld process.

## 4.23 DIMENSIONS

### NAP-1 Weld Plunger Cone

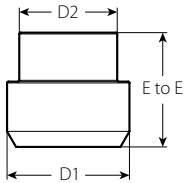

Dimensions			Weight
E to E	D1	D2	Approximate (Each)
inches	inches	inches	lb
mm	mm	mm	kg
1.75	1.88	1.50	0.3
44.5	47.6	38.0	0.2

**NOTE**

- NAP-1 Weld Plunger Cones are for use with the No. 142 weld outlets and protect the groove during weld process.

## 4.24 DIMENSIONS

### RG2910 Roll Grooving Tool

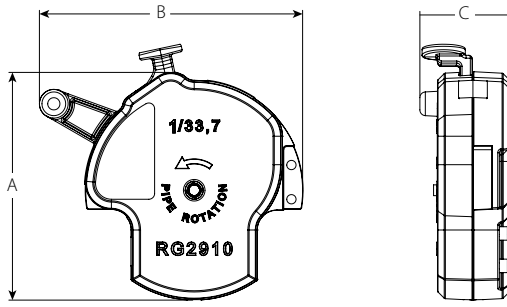

Dimensions			Weight
A Height	B Width	C Depth	Approximate (Each)
inches	inches	inches	lb
mm	mm	mm	kg
8.00	7.50	3.00	19
200	191	78	8.5

## 5.0 PERFORMANCE

### Friction Flow Data

Style/No	Size	Equivalent Length of 1" Sch. 40 Pipe (C=120)		
	Nominal inches DN	feet meters	Branch feet meters	Run feet meters
922		See <a href="#">publication 10.52</a>	–	–
920N		See <a href="#">publication 11.02</a>	–	–
101	1 DN25	2.0 0.61	–	–
102	1 DN25	–	5.0 1.52	2.7 0.82
103	1 x 1 DN25 x DN25	1 0.3	–	–
115	1 ¼ x 1 DN32 x DN25	5.7 1.74	–	–
	1 ½ x 1 DN40 x DN25	5.0 1.52	–	–
118	1 x 1 x 1 DN25 x DN25 x DN25	–	4.2 1.3	1.1 0.3
111	1 DN25	5.0 1.52	–	–
113	1 ¼ x 1 x 1 DN32 x DN25 x DN25	–	5.8 1.8	4.6 1.4
	1 ½ x 1 x 1 DN40 x DN25 x DN25	–	5.3 1.6	4.9 1.5
114	1 DN25	–	6.2 1.9	3.3 1.0
	1 DN25	3.5 1.1	–	–
144	1 ¼ x 1 x 1 DN32 x DN25 x DN25	3.9 1.19	–	–
	1 ½ x 1 x 1 DN40 x DN25 x DN25	4.3 1.31	–	–
148		See Note	–	–

- In accordance with NFPA 13, friction loss shall be excluded for fittings directly connected to a sprinkler. For hydraulic calculations, Victaulic recommends using the installed length (E-E or cut length) of the No. 148 Sprinkler Reducer as the equivalent length of 1"/DN25 Sch. 40 pipe.

Victaulic No. 148		
Length	½" DN15 outlet	¾" DN20 outlet
<b>E to E</b>	<b>Equivalent Length of 1" Sched. 40 Pipe (C=120)</b>	
inches	feet	
mm	meters	
≤6	6.6	3.8
152	2.0	1.2
6 – 12	5.5	3.8
152 – 305	1.7	1.2
12 – 18	6.2	4.3
305 – 457	1.9	1.3
18 – 24	6.7	4.7
457 – 610	2.0	1.4
24 – 30	7.1	5.2
610 – 762	2.2	1.6
30 – 36	7.4	5.4
762 – 914	2.3	1.6

**NOTE**

- When installed in pipe to pipe connections or it is required by the authority having jurisdiction, the equivalent length data in the table (left) may apply.



**5.0 PERFORMANCE (CONTINUED)**

**Maximum Working Pressure**

Style/No.	cULus psi kPa bar	FM psi kPa bar	LPCB psi kPa bar	VdS psi kPa bar
142 <sup>4</sup>	365 2517 25	365 2517 25	365 2517 25	232 1600 16
922 <sup>4,5</sup>	300 2100 21	300 2100 21	365 2517 25	232 1600 16
920N <sup>4,5</sup>	365 2517 25	300 2100 21	365 2517 25	232 1600 16
101 <sup>4,5</sup>	365 2517 25	365 2517 25	365 2517 25	232 1600 16
102 <sup>4,5</sup>	365 2517 25	365 2517 25	365 2517 25	232 1600 16
103 <sup>4,5</sup>	365 2517 25	365 2517 25	N/A	N/A
108 <sup>4,5</sup>	365 2517 25	365 2517 25	365 2517 25	232 1600 16
115 <sup>4,5</sup>	365 2517 25	365 2517 25	365 2517 25	232 1600 16
118 <sup>4,5</sup>	365 2517 25	N/A	N/A	N/A
65	365 2517 25	365 2517 25	365 2517 25	232 1600 16
111	365 2517 25	365 2517 25	N/A	N/A
113	365 2517 25	365 2517 25	N/A	N/A
	365 2517 25	365 2517 25	N/A	N/A
114	365 2517 25	365 2517 25	N/A	N/A
117	365 2517 25	365 2517 25	N/A	N/A

<sup>4</sup> Maximum pressure rating is 300 psi / 21 bar when installed on light-wall steel pipe. Please refer to the latest agency websites for the most up-to-date certification details.

<sup>5</sup> Accommodates full vacuum (29.9 in Hg/760 mm Hg.)

**5.0 PERFORMANCE (CONTINUED)**

**Maximum Working Pressure**

Style/No.	cULus psi kPa bar	FM psi kPa bar	LPCB psi kPa bar	VdS psi kPa bar
143	365 2517 25	365 2517 25	365 2517 25	232 1600 16
144	365 2517 25	365 2517 25	365 2517 25	232 1600 16
145	365 2517 25	365 2517 25	365 2517 25	232 1600 16
147	365 2517 25	365 2517 25	N/A	N/A
148	365 2517 25	365 2517 25	365 2517 25	232 1600 16
140	365 2517 25	365 2517 25	365 2517 25	232 1600 16
141	365 2517 25	365 2517 25	365 2517 25	232 1600 16
146	365 2517 25	365 2517 25	365 2517 25	232 1600 16

## 6.0 NOTIFICATIONS

### WARNING



- Read and understand all instructions before attempting to install any Victaulic products.
  - Always verify that the piping system has been completely depressurized and drained immediately prior to installation, removal, adjustment, or maintenance of any Victaulic products.
  - Wear safety glasses, hardhat, and foot protection.
- Failure to follow these instructions could result in death or serious personal injury and property damage.

- These products shall be used only in fire protection systems that are designed and installed in accordance with current, applicable National Fire Protection Association (NFPA 13, 13D, 13R, etc.) standards, or equivalent standards, and in accordance with applicable building and fire codes. These standards and codes contain important information regarding protection of systems from freezing temperatures, corrosion, mechanical damage, etc.
- The installer shall understand the use of this product and why it was specified for the particular application.
- The installer shall understand common industry safety standards and potential consequences of improper product installation.
- It is the system designer's responsibility to verify suitability of materials for use with the intended fluid media within the piping system and external environment.
- The material specifier shall evaluate the effect of chemical composition, pH level, operating temperature, chloride level, oxygen level, and flow rate on materials to confirm system life will be acceptable for the intended service.

Failure to follow installation requirements and local and national codes and standards could compromise system integrity or cause system failure, resulting in death or serious personal injury and property damage.

### WARNING



- Failure to follow instructions and warnings could result in serious personal injury, property damage, and/or product damage.
- Before operating or servicing any grooving tools, read all instructions in the manual and all warning labels on the tool.
- Wear safety glasses, hardhat, foot protection, and hearing protection while working around the tool.
- Save the operating and maintenance manual in a place accessible to all operators of the tool

If you need additional copies of any literature, or if you have questions concerning the safe and proper operation of the tool, contact Victaulic, P.O. Box 31, Easton, PA 18044-0031, Phone: 1-800-PICK VIC, E-Mail: pickvic@victaulic.com.

### NOTICE

- Victaulic does not recommend the use of any furnace butt-welded pipe with sizes 2"/DN50 and smaller Victaulic gasketed joint products. This includes, but is not limited to, ASTM A53 Type F pipe.

---

## 7.0 REFERENCE MATERIALS

---

- [10.06: FireLock Installation-Ready Fittings](#)
- [10.52: Style 922 Outlet Tee](#)
- [10.85: VicFlex Series AH2 ad AH2-CC Braided Hose](#)
- [11.02 Mechanical-T Bolted Branch Outlets](#)
- [24.21: Victaulic Roll Grooving Tool Model RG2910](#)
- [25.14: Victaulic IGS Groove Specification](#)
- [I-101-103: FireLock™ Installation-Ready™ Fittings Installation Instruction](#)
- [I-102: FireLock™ Installation-Ready™ Fittings Installation Instruction](#)
- [I-108: FireLock™ Installation-Ready™ Coupling](#)
- [I-115: FireLock EZ™ Installation-Ready™ Reducing Coupling Installation Instruction](#)
- [I-ENDCAP: Victaulic End Cap Installation Safety Instructions](#)
- [I-V9: Style V9 Victaulic FireLock™ IGS™ Installation-Ready™ Sprinkler Coupling](#)

---

### User Responsibility for Product Selection and Suitability

Each user bears final responsibility for making a determination as to the suitability of Victaulic products for a particular end-use application, in accordance with industry standards and project specifications, and the applicable building codes and related regulations as well as Victaulic performance, maintenance, safety, and warning instructions. Nothing in this or any other document, nor any verbal recommendation, advice, or opinion from any Victaulic employee, shall be deemed to alter, vary, supersede, or waive any provision of Victaulic Company's standard conditions of sale, installation guide, or this disclaimer.

### Intellectual Property Rights

No statement contained herein concerning a possible or suggested use of any material, product, service, or design is intended, or should be construed, to grant any license under any patent or other intellectual property right of Victaulic or any of its subsidiaries or affiliates covering such use or design, or as a recommendation for the use of such material, product, service, or design in the infringement of any patent or other intellectual property right. The terms "Patented" or "Patent Pending" refer to design or utility patents or patent applications for articles and/or methods of use in the United States and/or other countries.

### Note

This product shall be manufactured by Victaulic or to Victaulic specifications. All products to be installed in accordance with current Victaulic installation/assembly instructions. Victaulic reserves the right to change product specifications, designs and standard equipment without notice and without incurring obligations.

### Installation

Reference should always be made to the [Victaulic installation handbook](#) or installation instructions of the product you are installing. Handbooks are included with each shipment of Victaulic products, providing complete installation and assembly data, and are available in PDF format on our website at [www.victaulic.com](http://www.victaulic.com).

### Warranty

Refer to the Warranty section of the current Price List or contact Victaulic for details.

### Trademarks

*Victaulic* and all other Victaulic marks are the trademarks or registered trademarks of Victaulic Company, and/or its affiliated entities, in the U.S. and/or other countries.