

Single Basin Faucet

TECK®
COMMERCIAL

DELTA®

Specification: (example)

- **CAST BRASS** single basin faucet
- Polished chrome plated
- **TUF-TECK®** institutional structure
- Color indexed metal handle with vandal resistant screw
- Metal hold-down package and ...
- with ... (add outlet required)
- with ... (add handle required)



Engineer/Architect Approval









Model Specified:

Approval:

Date:

DESCRIPTION	PRODUCT NO.			
Single Basin Faucet	23T1	0		



NOT APPLICABLE	OUTLET	HANDLE
0 <input checked="" type="checkbox"/>	0 <input checked="" type="checkbox"/>	0 <input checked="" type="checkbox"/>
1 <input type="checkbox"/>	1 <input type="checkbox"/>	1 Five Flute Handle  <input type="checkbox"/>
2 <input type="checkbox"/>	2 Vandal Resistant 1.5 GPM (5.7 L/min.) Laminar w/Antimicrobial By Agion®  <input type="checkbox"/>	2 <input type="checkbox"/>
3 <input type="checkbox"/>	3 Vandal Resistant 1.5 GPM (5.7 L/min.) Flow Control Aerator  <input type="checkbox"/>	3 70mm (2-3/4") Lever Blade Handle  <input type="checkbox"/>
4 <input type="checkbox"/>	4 Standard 1.5 GPM (5.7 L/min.) Flow Control Aerator  <input type="checkbox"/>	4 <input type="checkbox"/>
5 <input type="checkbox"/>	5 Vandal Resistant 0.5 GPM (1.9 L/min) Flow Control Non-Aerating Spray Outlet  <input type="checkbox"/>	5 <input type="checkbox"/>
6 <input type="checkbox"/>	6 <input type="checkbox"/>	6 <input type="checkbox"/>
7 <input type="checkbox"/>	7 <input type="checkbox"/>	7 <input type="checkbox"/>
8 <input type="checkbox"/>	8 <input type="checkbox"/>	8 70mm (2-3/4") Self-closing Lever Blade Handle  <input type="checkbox"/>
9 <input type="checkbox"/>	9 <input type="checkbox"/>	9 Five Flute Self-closing Handle  <input type="checkbox"/>

Refer to www.specselect.com for individual models.

Flow Rates are at 60 PSI.
Note: Use this page front and back as product a submittal sheet.

Delta reserves the right (1) to make changes in specifications and materials, and (2) to change or discontinue models, both without notice or obligation. Dimensions are for reference only. See current full-line price book or www.specselect.com for finish options and product availability.

DSP-23T10 Rev. B

Approvals:

- CSA certified
- Complies to ASME A112.18.1/CSA B125.1
-  Handle No. 3 meets ADA compliance to ICC/ANSI A117.1/ADA
- Verified compliant with 0.25% weighted average Pb content regulations

(Contact Delta Representative for State and/or Local Approvals.)

FLOW RATE vs PRESSURE

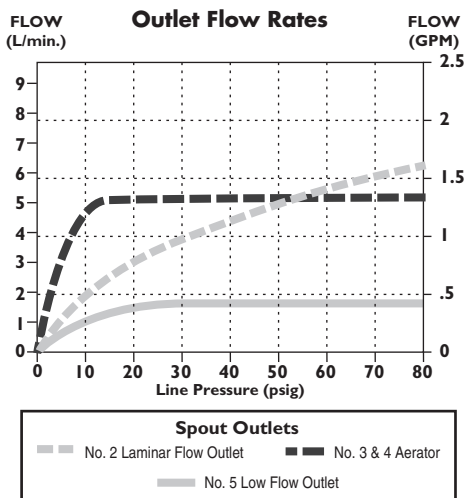

FRONT VIEW

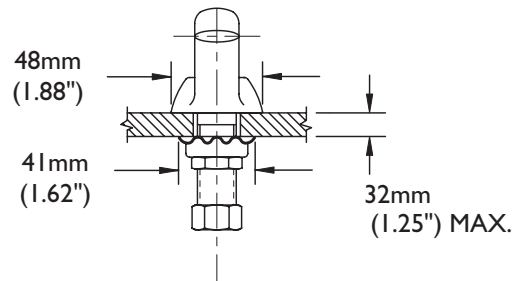

INLET FOR 3/8" OR 1/2" FLEXIBLE RISER
 OR 1/2-14 NPSM COUPLING NUT (SUPPLIED)

SIDE VIEW

Handle No. 1 and 9

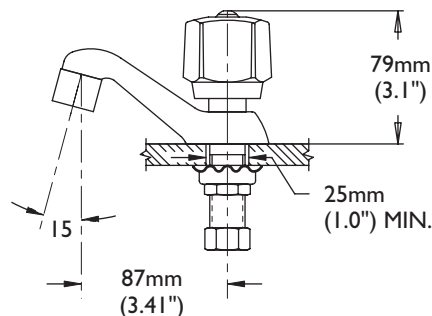

Handle No. 3 and 8

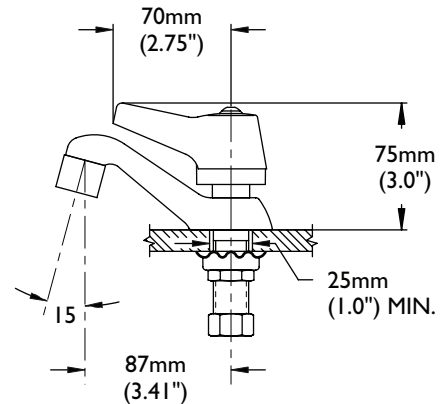

Specification: (Example)

23T101

Pair of single hole mount, cast brass, polished chrome plated finish, basin faucets, TUF-TECK® institutional structure, color indexed five flute metal handle with vandal resistant screw and 1.5 GPM (5.7 L/min) at 60 PSI aerator outlet. (2 x 23T1041)

23T24A

As above but with self-close handle. (2 x 23T1049)

INLETS - 1/2" MIP/Coupling Nuts

Note: Measurements may vary ± 6 mm (0.25")

Refer to www.specselect.com for individual models.