

Thank you for choosing Endura®.
If you have any questions please
contact us.

Components for 3925AX6

2 - 1/2" Sch 40 pipe x 8-3/4"
2 - 1/2" Sch 40 couplings
1 - Extension
10 - 1 1/4" screws

Equipment Required

• Silicone Sealant
• Level • Hammer
• Screwdriver • Pliers
• Saw • Nail Punch • Pencil

Multiple Extensions - Recommended MAX. QTY - 3 (18")

The Endura® Extension Risers were designed to be nested on top of one another. In the event that an installation is deeper than 6", follow the procedure described below and nest the extension riser sets into the flange of the previous extension.

Note: The 3" model flow control device can also be located in-floor with the use of the Flow Control extension kit. 3" flow control extension kit - Part # 392203W

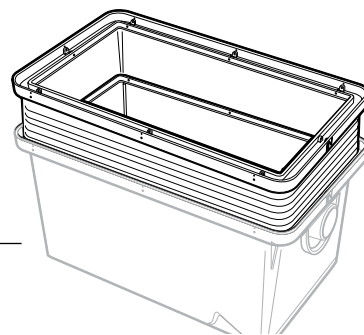

Step 1

Open the Quick Connect latches and remove the lid from the tank.

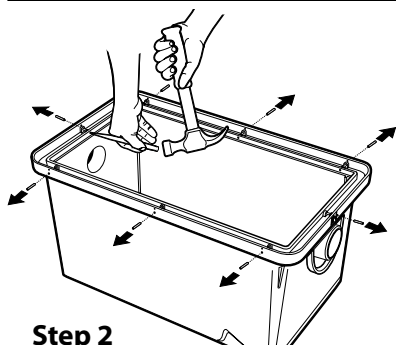

Step 2

With a hammer and a punch, disengage the dowel pin outward from the tank. Using a pair of pliers, remove the dowel pin. Repeat this procedure for all of the pins housed in the tank.

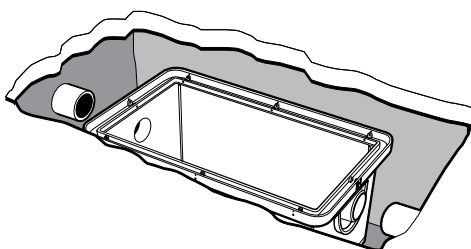

Step 3

Insert the tank into the excavated hole and locate the pipe connections to the desired height.

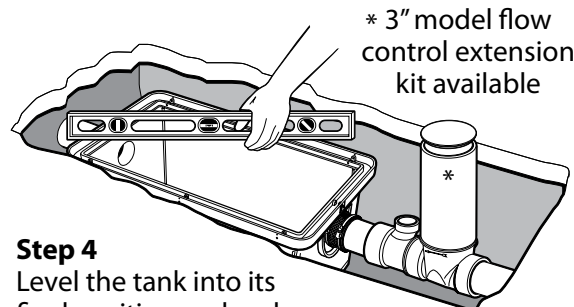

Step 4

Level the tank into its final position and make your connections to the tank using flexible mechanical connectors as per normal installation. Fill with water to bottom of pipe.

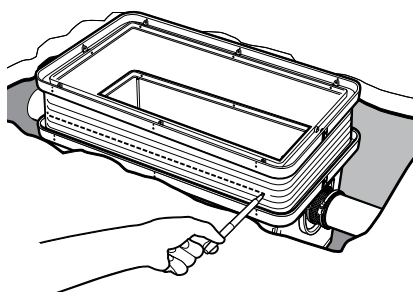

Step 5

Locate the extension on to the tank insuring that it is fully seated between the location points.

Determine if the extension assembly needs to be shortened and mark **GRADE LEVEL LINE** on extension.

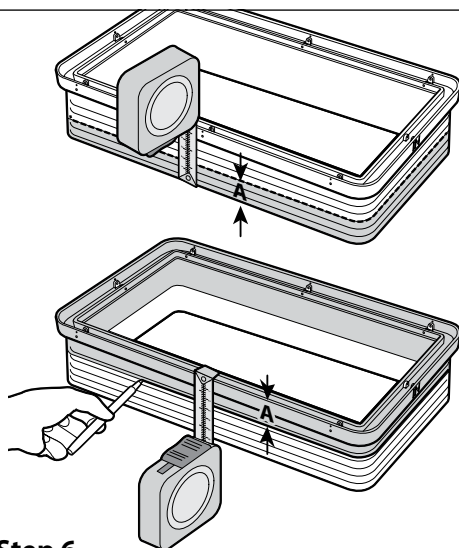

Step 6

Determine the height (A) from the bottom of the extension to the marked **GRADE LEVEL LINE**.

Take that (A) measurement the measure from the top of the extension down to mark the extensions **CUT LINE**.

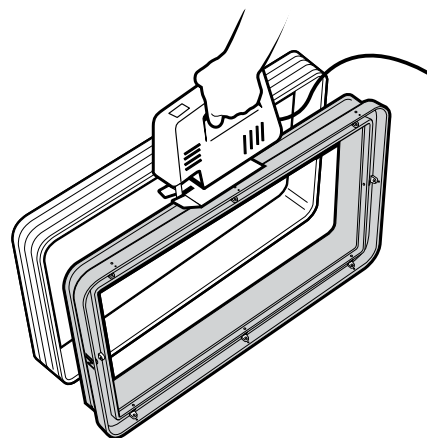

Step 7

Confirm the height required and cut the extension assembly using a suitable hand or power saw. Horizontal lines are provided as a guide to cutting only.

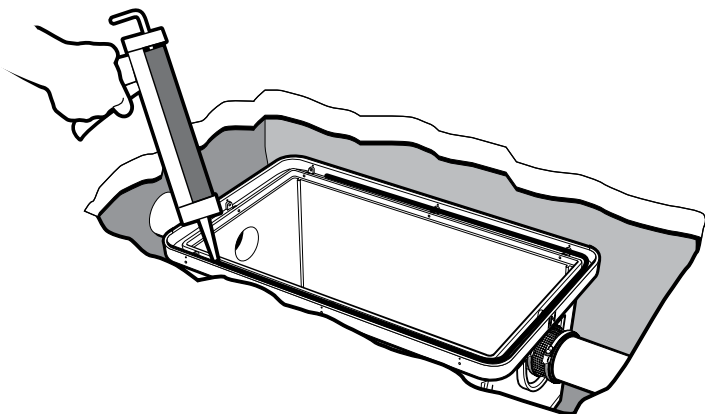

Step 8

Apply a generous bead of silicone to center of the flange on the tank. Insert the extension assembly in the center channel on the top of the tank.

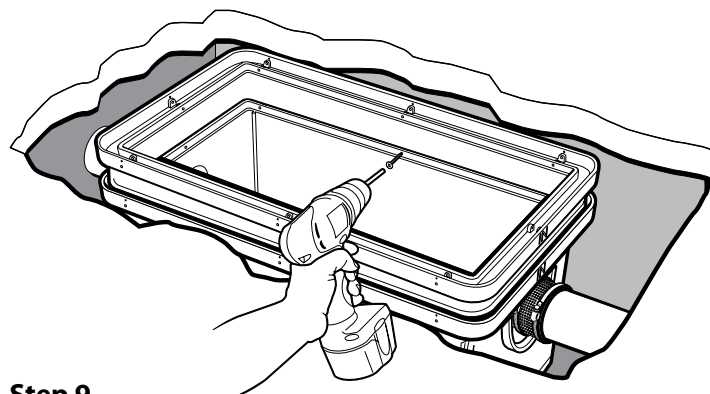

Step 9

Push the components together. Ensure the extension is firmly seated into the flange of the tank.

With the 1-1/4" screws provided, insert the screws through the existing dowel holes and secure the extension to the tank.

Step 10

If a large amount of extension riser height is left after cutting or if multiple extension risers are used, a extension baffle handle can be made to remove baffles more easily from Sch 40 pipe and couplings.

Insert a piece of 1/2" Sch 40 pipe into baffles as shown in Fig. A. and secure with screws.

Insert baffles back into the interceptor and mark the pipe 3/8" from the top of the interceptor and cut pipe at that mark.

Solvent weld a 1/2" coupling to the top of the pipe. This prevents upward movements of the baffles in operation and provides a positive grip for baffle removal.

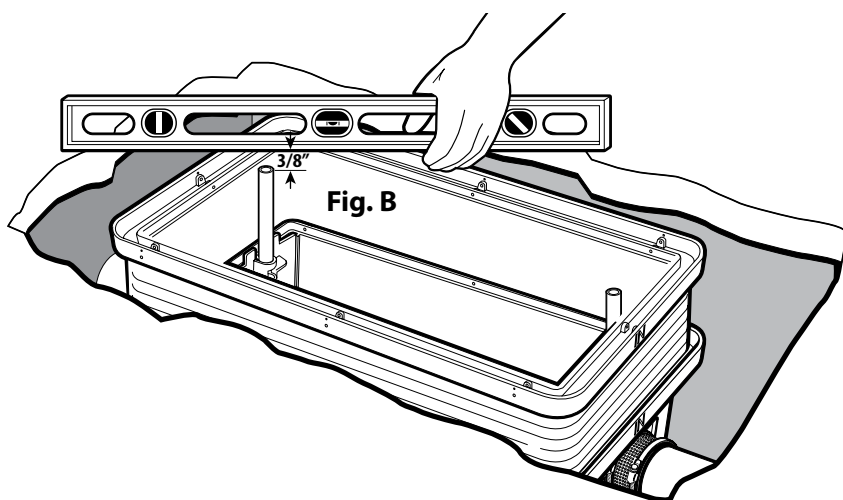
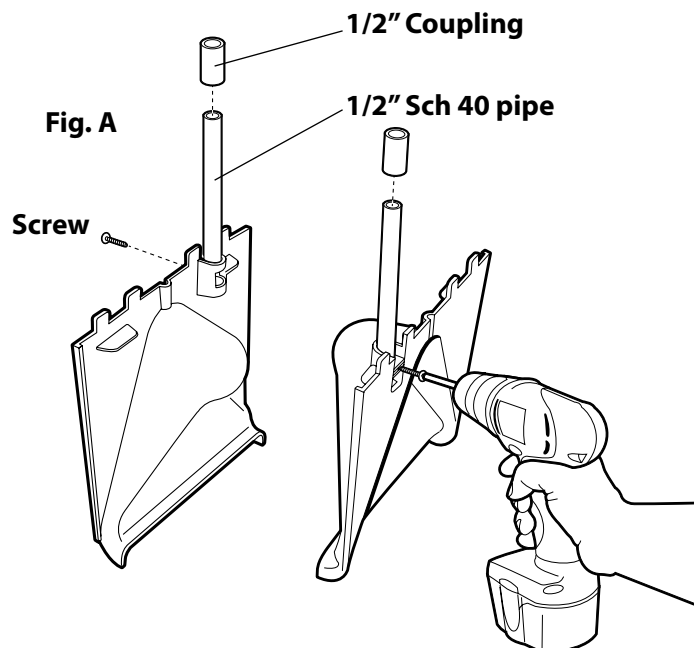

Step 11

Finish the floor. Note: Backfill should be hand tamped only. To minimize risk of distortion or movement the tank should be filled with water and the cover secured in place, during back filling and finishing.

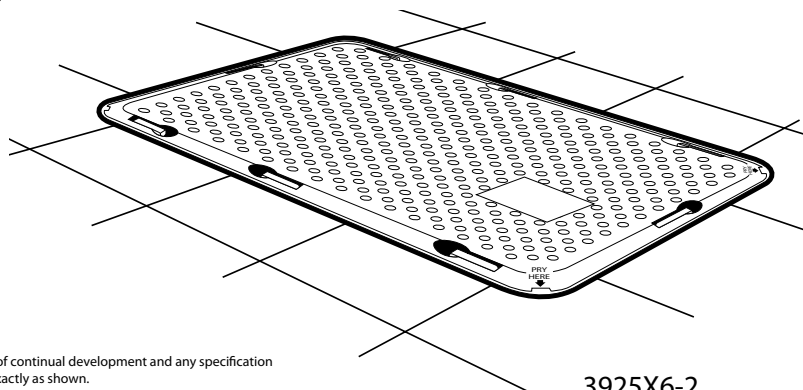

Canada

Tel: (705) 726-3361

1-800-461-1771

Fax: (705) 726-2186

U.S.A.

Tel: (303) 373-1918

1-888-461-5307

Fax: (303) 373-1923



Technical Support

tech-support@endurainterceptor.com