

American Standard

**SELECTRONIC®**  
**PROXIMITY TOILET**  
**CONCEALED FLUSH VALVE**  
**1.1, 1.28 & 1.6 GPF**

<b>MODEL NUMBERS</b>
<b>606B2XX</b>

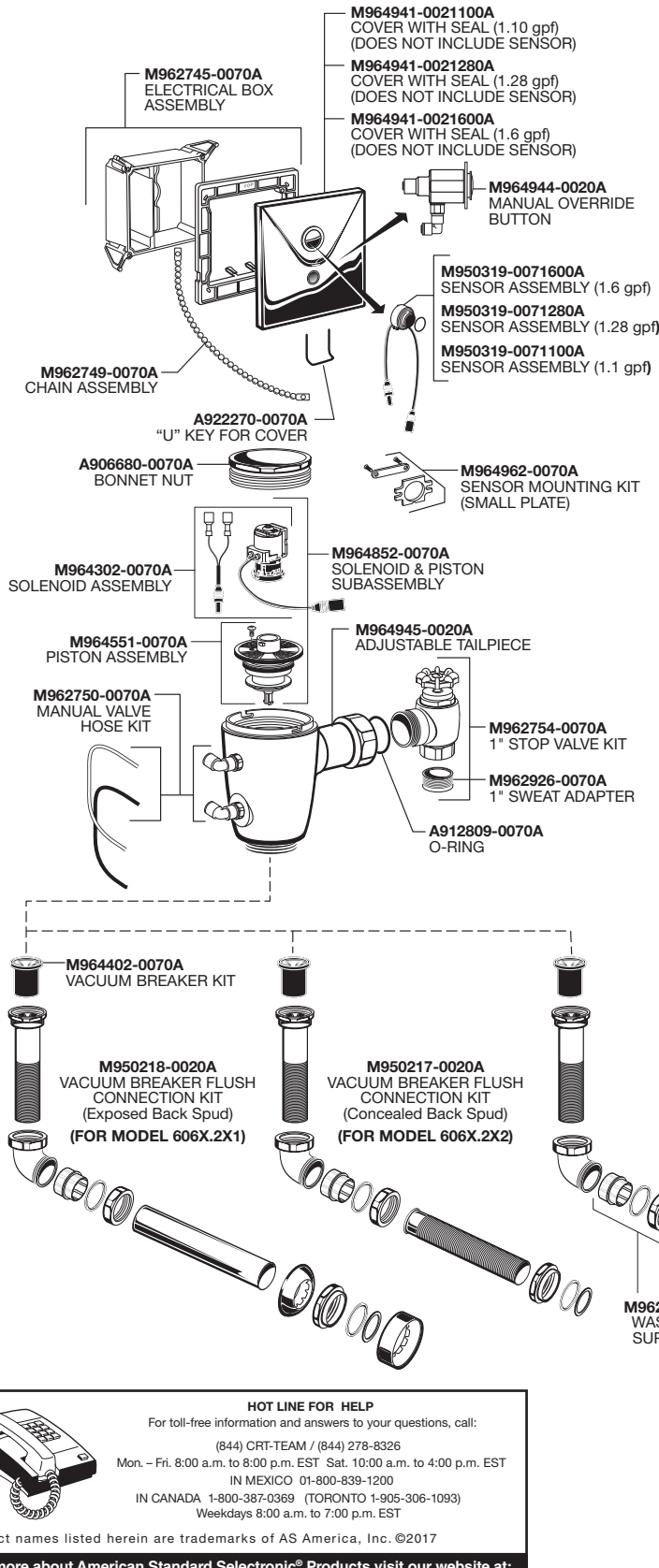

**PWRX Power Kit  
PK00.WRK**

M950361-0070A  
PWRX BATTERY PACK

M950360-0070A  
CONNECTOR  
LOCKING  
DEVICE

M964455-0070A  
BRACKET

**CR-P2 Lithium Battery  
7755 Series**

A923654-0070A  
BATTERY 6V CR-P2

**Plug-In AC  
Power Kit  
PK00.PAC**

M950338-0070A  
POWER SUPPLY

M950360-0070A  
CONNECTOR  
LOCKING DEVICE

M950399-0070A  
SINGLE AC ADAPTER

**Hard-Wired AC  
Power Kit  
PK00.HAC**

M950511-0070A  
10' EXTENSION

M950527-0070A  
POWER SUPPLY

M950360-0070A  
CONNECTOR  
LOCKING DEVICE

**Multi-AC  
Power Kit  
PK00.MAC**

M950511-0070A  
10' EXTENSION

M950512-0070A  
MULTI-AC ADAPTER

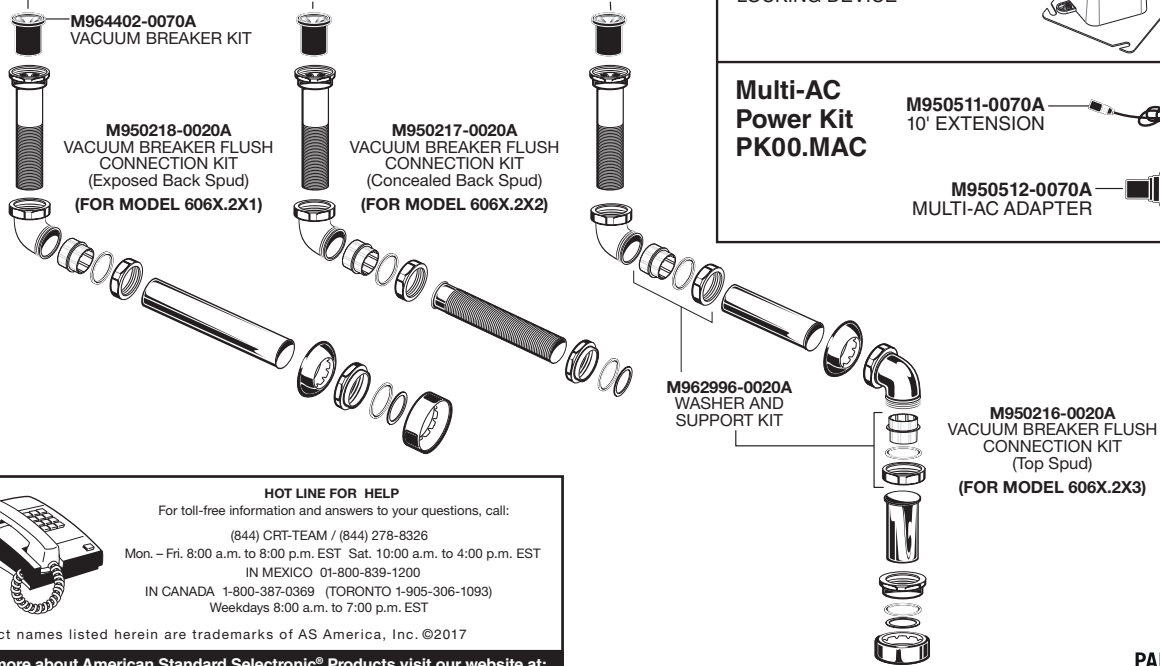

**HOT LINE FOR HELP**  
 For toll-free information and answers to your questions, call:  
 (844) CRT-TEAM / (844) 278-8326  
 Mon. - Fri. 8:00 a.m. to 8:00 p.m. EST Sat. 10:00 a.m. to 4:00 p.m. EST  
 IN MEXICO 01-800-839-1200  
 IN CANADA 1-800-387-0369 (TORONTO 1-905-306-1093)  
 Weekdays 8:00 a.m. to 7:00 p.m. EST

Product names listed herein are trademarks of AS America, Inc. ©2017

To learn more about American Standard Selectronic® Products visit our website at:  
[www.americanstandard-us.com](http://www.americanstandard-us.com) or e-mail us at: [CRTTEAM@americanstandard.com](mailto:CRTTEAM@americanstandard.com)

PART OF LIXIL