

# GTS21FGK

GE® 20.8 Cu. Ft. Top-Freezer Refrigerator

## DIMENSIONS AND INSTALLATION INFORMATION (IN INCHES)

OVERALL DIMENSIONS	Height to top of hinge (in.) <b>A</b>	67
	Height to top of case (in.) <b>B</b>	66-3/8
	Case depth without door (in.) <b>C</b>	28
	Case depth less door handle (in.) <b>D</b>	31-1/4
	Case depth with door handle (in.) <b>E</b>	33-7/8
	Depth with fresh food door open 90° (in.) <b>F</b>	60-1/2
	Width (in.) <b>G</b>	31-1/4
	Width with door open 90° with door handle (in.) <b>H</b>	32-1/2
AIR CLEARANCES	Each side (in.)	1
	Top (in.)	1
	Back (in.)	2

FRONT VIEW

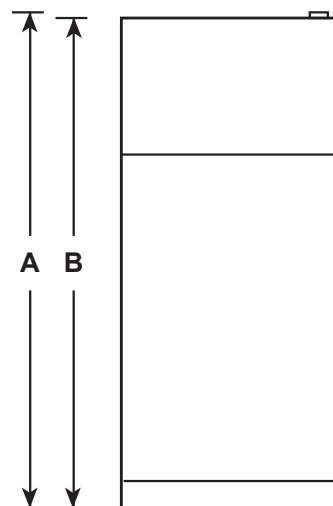

TOP VIEW

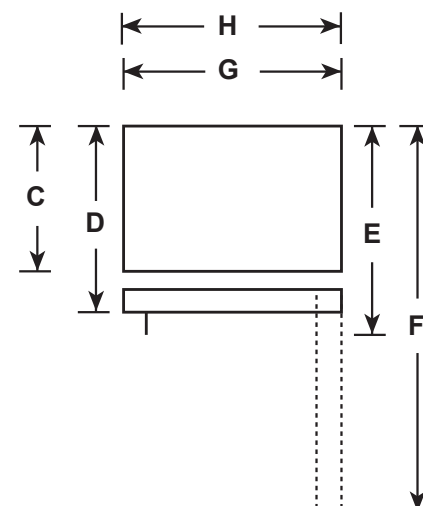

For answers to your Monogram, GE Café™ Series, GE Profile™ Series or GE Appliances product questions, visit our website at [geappliances.com](http://geappliances.com) or call GE Answer Center® Service, 800.626.2000.



Specification Revised 5/17

# GTS21FGK

## GE® 20.8 Cu. Ft. Top-Freezer Refrigerator

### FEATURES AND BENEFITS

LED interior lighting in fresh food section - Spotlights foods inside making them easy to see

Dairy bin - Provides convenient storage for dairy items

Spillproof glass shelves - Help contain spills for ease of cleaning

Gallon door storage - Deep bin handles large containers in the door and frees up valuable shelf space

Adjustable glass freezer shelf - Provides the flexibility to organize your frozen food items

Equipped for optional icemaker - Easily accommodates the installation of an icemaker

High-gloss finish - Enjoy a polished appearance that stands out in any kitchen

Model GTS21FGKWW - White

Model GTS21FGKBB - Black

