





SYMMONS[®] Dia[®]
the smart choice™

Location:

3532-B Series
Tub/Shower System
Specification Submittal



Model Numbers	Specification
<input type="checkbox"/> 3532-B <i>Dia Tub/Shower System</i>	Tub/shower system powered by the Temptrol [®] Pressure Balancing valve. Features diverter tub spout, 1 mode showerhead and standard 2.5 gpm (9.5 L/min) flow restrictor. Components made from metal and nonmetallic materials plated in standard polished chrome finish.
<p>Modifications</p> <input type="checkbox"/> -1.5  1.5 gpm (5.7 L/min) flow restrictor <input type="checkbox"/> -Delete Suffix B Chrome plastic escutcheon on valve with color graphics/indicators in place of standard brass escutcheon <input type="checkbox"/> -SH2 Round, 3 mode showerhead <input type="checkbox"/> -SH3 Round, 1 mode showerhead <input type="checkbox"/> -SH4 Square, 1 mode showerhead <input type="checkbox"/> -T2 Square, diverter tub spout <input type="checkbox"/> -L/HD Less showerhead <input type="checkbox"/> -TRM Trim only, valve not included	
	<p>Compliance</p> <p>-ASME A112.18.1/CSA B125.1</p> 
	<p>Warranty</p> <p>Limited Lifetime - to the original end purchaser in consumer/residential installations. 5 Years - for industrial/commercial installations. Refer to www.symmons.com/warranty for complete warranty information.</p>

Note: Append appropriate -suffix to model number.

Dimensions

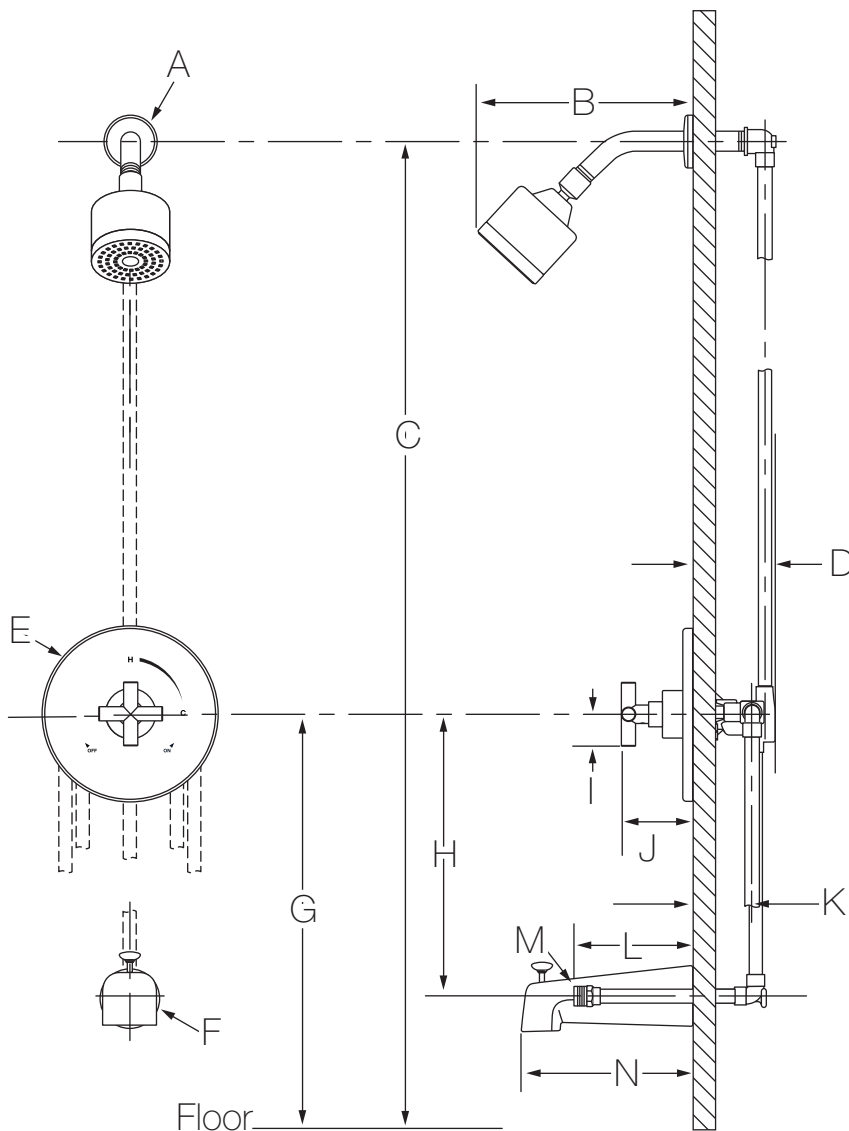

Measurements	
A	Ø 2 1/2", 64 mm
B	6 3/4", 171 mm
C	77", 1956 mm
D	3 1/2", 89 mm
E	Ø 7 1/2", 191 mm
F	Ø 2 1/2", 64 mm
G	32", 813 mm
H	12", 305 mm
I	1 3/8", 35 mm
J	2 7/8", 73 mm
K	Rough-in 2 3/8" ± 1/2", 60 mm ± 13 mm
L	5 1/2", 140 mm
M	Male 1/2-14 NPT fitting must protrude 5 1/2" (140 mm) from finished wall
N	7", 178 mm
O	6 3/4", 171 mm
P	6", 152 mm
Q	5 5/8", 143 mm
R	2 1/4", 57 mm
S	2 3/4", 70 mm
T	3/8", 10 mm
U	6 1/2", 165 mm
V	Female 1/2-14 NPSM fitting must be recessed 3/8" (10mm) from finished wall

-SH2

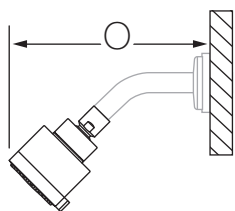

-SH3

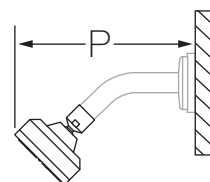

-SH4

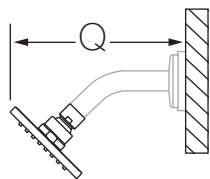
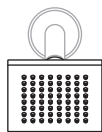

-T2

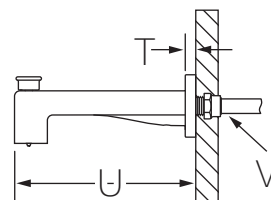
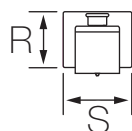

Notes:

- 1) All dimensions measured from nominal rough-in (see K as reference).
- 2) Dimensions are subject to change without notice.