

KING NIPPLE

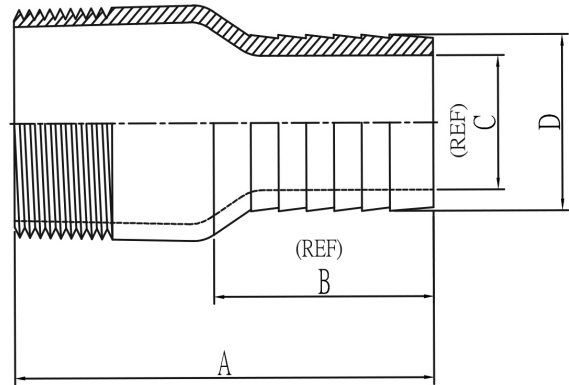

- Connection: MNPT x Hose
- Bevel x Hose
- Material: Stainless Steel - FNWKNSB, FNWKNST
- Unplated Carbon Steel - FNWKNUT, FNWKNUB
- Zinc-Plated Carbon Steel - FNWKNPT
- B designates beveled, T designates threaded
- Combination nipples are not recommended for steam



DIMENSIONS (INCHES)

Product Code	Size	A	B	C	D
FNWKNSTD	1/2"	2.76	1.42	0.30	0.54
FNWKNSTF	3/4"	3.03	1.46	0.55	0.78
FNWKNSTG	1"	3.19	1.46	0.77	1.02
FNWKNSTH *	1-1/4"	3.46	1.57	1.01	1.27
FNWKNSTJ *	1-1/2"	4.13	2.09	1.14	1.54
FNWKNSTK *	2"	4.69	2.36	1.74	2.03
FNWKNSTL *	2-1/2"	5.55	2.80	2.11	2.52
FNWKNSTM *	3"	5.98	3.15	2.67	3.03
FNWKNSTP *	4"	7.17	3.70	3.64	4.04
FNWKNSTU *	6"	10.08	5.94	5.63	6.04
FNWKNUTD	1/2"	2.95	1.34	0.30	0.53
FNWKNUTF	3/4"	3.03	1.46	0.55	0.78
FNWKNUTG	1"	3.19	1.46	0.77	1.02
FNWKNUTH *	1-1/4"	3.46	1.57	1.01	1.27
FNWKNUTJ *	1-1/2"	4.13	2.09	1.14	1.54
FNWKNUTK *	2"	4.69	2.36	1.74	2.03
FNWKNUTL *	2-1/2"	5.55	2.80	2.11	2.52
FNWKNUTM *	3"	5.98	3.15	2.68	3.03
FNWKNUTP *	4"	7.17	3.70	3.64	4.04
FNWKNUTU *	6"	10.00	5.98	5.51	6.06
FNWKNPTD	1/2"	2.95	1.34	0.30	0.53
FNWKNPTF	3/4"	3.03	1.46	0.55	0.78
FNWKNPTG	1"	3.19	1.46	0.77	1.02
FNWKNPTH *	1-1/4"	3.46	1.57	1.01	1.27
FNWKNPTJ *	1-1/2"	4.13	2.09	1.14	1.54
FNWKNPTK *	2"	4.69	2.36	1.74	2.03
FNWKNPTL *	2-1/2"	5.55	2.80	2.11	2.52
FNWKNPTM *	3"	5.98	3.15	2.68	3.03
FNWKNPTP *	4"	7.17	3.70	3.64	4.04
FNWKNPTU *	6"	10.00	5.94	5.51	6.06

Recommended for use in low pressure discharge and suction service for compatible liquids. * Size 1-1/4" and above are not recommended for compressible products such as air or nitrogen.